

# Lloyd's Register of Shipping.

## SURVEYS FOR FREEBOARD.

### (CONDITIONS OF ASSIGNMENT.)

Ship's Name "LEMBULUS" Port of Survey NEWCASTLE-ON-TYNE  
 Official Number 181848 Surveyor's Signature W. J. Pyle  
 Nationality and Port of Registry BRITISH. LONDON. Date of Survey DURING CONSTRUCTION.

Disposition and dimensions of superstructures, trunks, deckhouses and machinery casings to be inserted in the diagrams and tabular statement:—

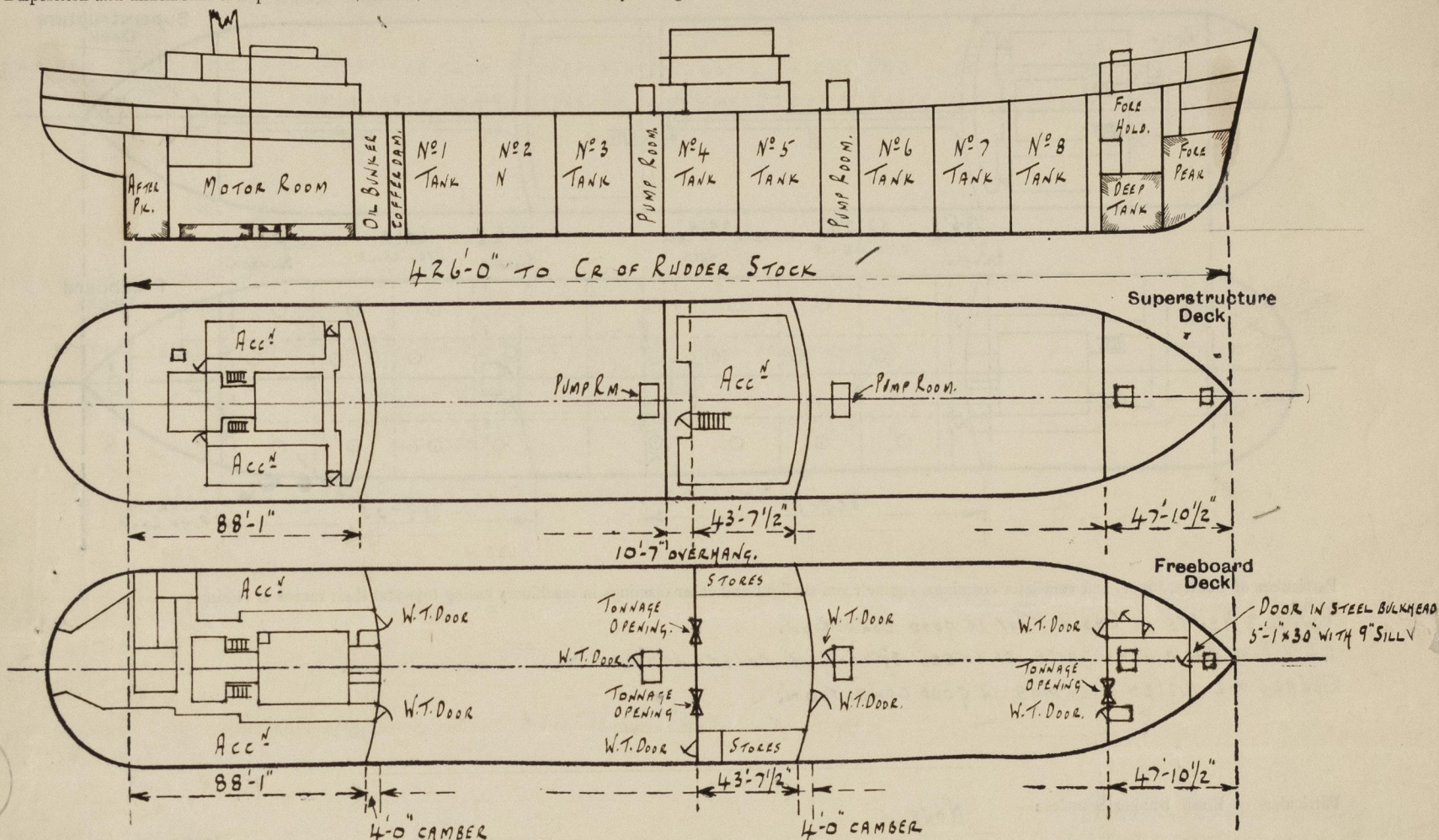

Particulars of Superstructures, Trunks, Casings, Deckhouses.

	Coaming	Plating	Stiffeners	Spacing	End Attachments of Stiffeners	Size of Openings	Height of Sills	Height of Casings
Poop Bulkhead ...	44 ✓	44 ✓	9" x 5.2 BULB PLATE	25"-31"	WELDED TOP & BOTTOM ✓	2 @ 5'-0" x 2'-0"	18" ✓	8'-0" ✓
Raised Quarter Deck Bulkhead ...			3" x 2 1/2" x 25"		WELDED TOP & BOTTOM ✓	1 @ 5'-0" x 2'-0"		
Bridge, After Bulkhead ...	30 ✓	30 ✓	ANGLES TOE ON ✓	27"-31"	WELDED TOP & BOTTOM ✓	2 @ 5'-1" x 3'-1"	18 ✓	7'-6" ✓
Bridge, Forward Bulkhead ...	44 ✓	44 ✓	9" x 5.6 BULB PLATE	32"-27"	WELDED TOP & BOTTOM ✓	1 @ 5'-0" x 2'-6"	18 ✓	7'-6" ✓
Forecastle Bulkhead ...	30 ✓	30 ✓	3" x 2 1/2" x 25" ✓ ANGLES TOE ON	24"-27"	NONE	1 @ 5'-0" x 1-9 1/2" 1 @ 5'-0" x 2'-0" 1 @ 5'-1" x 4'-1"	18 ✓	7'-6" ✓
Trunk, Aft ...								
Trunk, Forward ...								
Exposed Machinery Casings on Freeboard or Raised Quarter Decks ...								
Exposed Machinery Casings on Superstructure Decks ...								
Machinery Casings within Superstructures not fitted with Class I Closing Appliances ...								
2 Pump Rooms.								
Deckhouses on Flush Deck Ships ...	40	40	6" x 3" x 3.4 H TOE ON	28 3/4"	WELDED TOP & BOTTOM	1 @ 4'-6" x 2'-3" AT BOTH PUMP ROOMS	18"	7'-6"

Particulars of Closing Appliances (state if capable of being manipulated from both sides).

Poop Bulkhead ...	2 W.T. DOORS MANIPULATED FROM BOTH SIDES. ✓
Raised Quarter Deck Bulkhead ...	
Bridge, After Bulkhead ...	1 W.T. DOOR MANIPULATED FROM BOTH SIDES & 2 TONNAGE OPENINGS CLOSED BY PORTABLE PLATES SECURED BY HOOKBOLTS NOT PASSING THRO BULKHEAD. ✓
Bridge, Forward Bulkhead ...	1 W.T. DOOR MANIPULATED FROM BOTH SIDES. ✓
Forecastle Bulkhead ...	2 W.T. DOORS MANIPULATED FROM BOTH SIDES & 1 TONNAGE OPENING CLOSED BY PORTABLE PLATES SECURED BY HOOKBOLTS NOT PASSING THRO BULKHEAD. ✓
Exposed Machinery Casings on Freeboard or Raised Quarter Decks ...	
Exposed Machinery Casings on Superstructure Decks ...	
Machinery Casings within Superstructures not fitted with Class I Closing Appliances ...	
2 Pump Rooms.	
Deckhouses on Flush Deck Ships ...	1 W.T. DOOR IN AFTER END OF EACH PUMP ROOM MANIPULATED FROM BOTH SIDES. ✓



### PARTICULARS OF PROTECTION TO OPENINGS, ETC.

The following diagrams should be used to indicate the positions of cargo and coaling hatchways, gangway, cargo and coaling ports, ventilators, companionways, &c. which would affect the seaworthiness of the ship:—

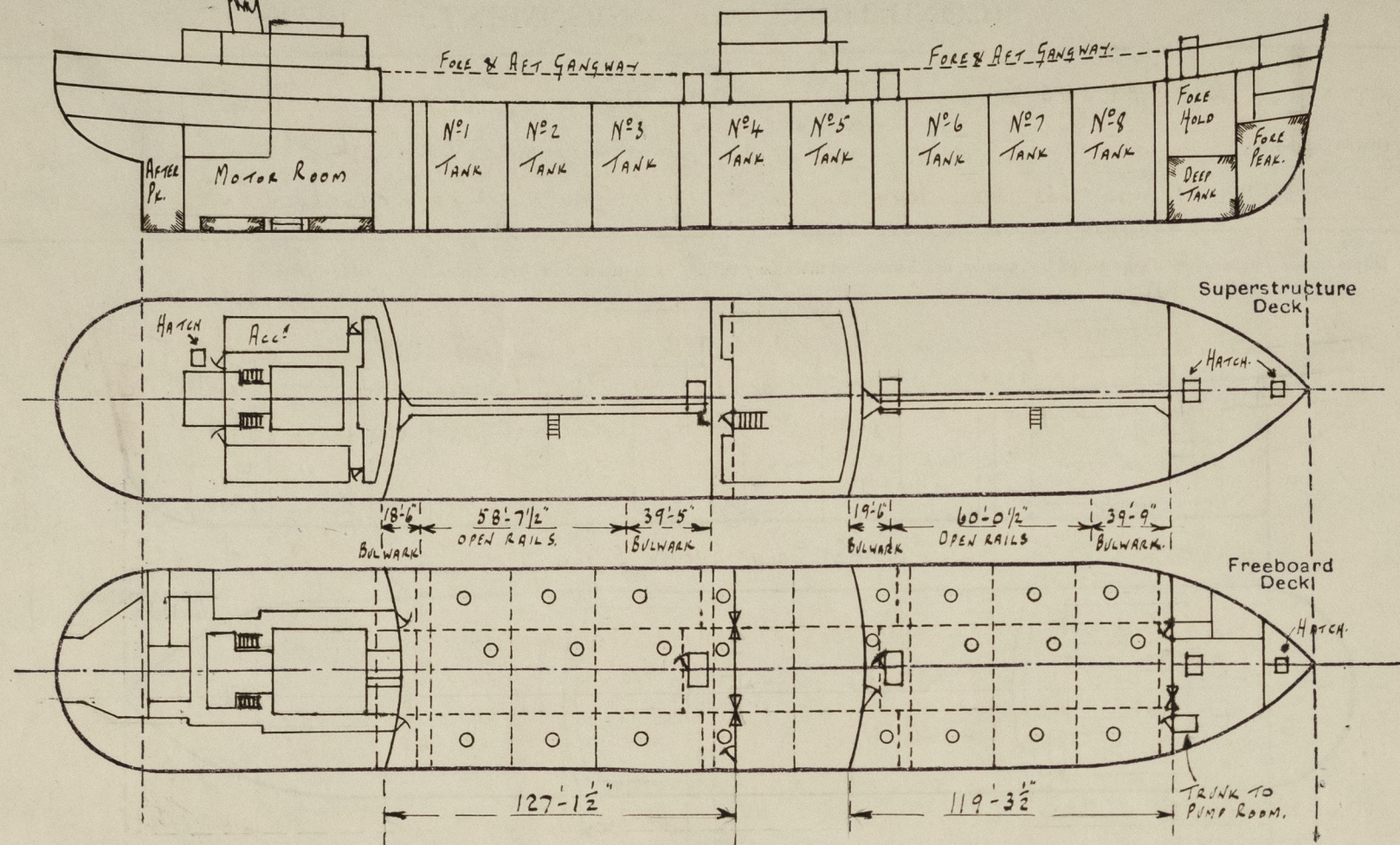

Particulars of fiddley, funnel and ventilator coamings, engine room skylight and other openings in machinery casing tops and their means of closing :—

FUNNEL & VENTS ON CASING TOP IN GOOD CONDITION. ✓  
ER & PUMP ROOM SKYLIGHTS OF STEEL STRONGLY CONSTRUCTED. ✓  
COVERS FOR FIDLEY OPENINGS IN GOOD CONDITION. ✓

Particulars of Flush Bunker Scuttles :—

NONE

Particulars of Companionways :—

ENTRANCE TO PUMP ROOM AT F'CLE FT:-  
W.T. STEEL DOOR 5'-0" X 1'-9" WITH 18" SILL TO  
ENCLOSED STEEL TRUNK INSIDE F'CLE FRONT  
LEADING DOWN TO PUMP ROOM. ✓

DECKHOUSE ON BRIDGE DK ENCLOSING

LADDERWAY TO BRIDGE T. DKS:- ENTRANCE TO  
LADDERWAY IN AFTER END OF HOUSE, ST<sup>o</sup> SIDE OF  
CR LINE, SOLID WOOD DOOR 5'-0" x 2'-0" WITH  
18" SILL ✓ ALL DOORS MANIPULATED

DECKHOUSE ON POOP DEK ENCLOSING LADDERWAYS

TO POOP. T. DKS:- 2 SOLID WOOD DOORS P&S  
5'-3" x 2'-0" WITH 18" SILLS. ✓

ALL DOORS MANIPULATED FROM BOTH SIDES. ✓

Particulars of Ventilators in exposed positions on freeboard and superstructure decks :

3 VENTS ON FLE DK 6" DIA, COMING 36"x30" TO FLE STORES. ✓  
2 " " " " 10" " " 36"x32" " " SPACES. ✓  
1 " " " " 12" " " 36"x34" " F.P. STORES. ✓  
2 " " " " 10" " " 36"x32" " FORE HOLD. ✓  
1 " " " " 10" " " 36"x32" " FORE PUMP ROOM ✓  
4 " " UPPER DK 2 1/2" DIA x 18'-0" HIGH (LOWER PART 1/2, REMAINDER  
25') & SUPPORTED TO MAIN PUMP ROOMS. ✓  
1 VENT ON POOP DK 11" DIA, COMING 36"x32" TO POOP T. DKS. ✓  
1 " " " " 10" " " 30"x32" " REFRIG COMP ✓  
1 " " " " 6" " " 33"x30" " POOP T. DKS. ✓

3 VENTS ON POOP DK 6" DIA, COAMING 36" x 30" TO POOP.T. DKS. ↓  
9 G.N. VENTS 5" DIA ON POOP DK TO ACC<sup>#</sup> IN POOP.T. DKS. ↓  
4 VENTS ON BOAT DK 11" DIA, COAMING 36" x 32" TO POOP.T. DKS. ↓  
1 " " " " 10" " " 30" x 32" = REFUG. SPACE. ↓  
1 Meshroom Vent " " " 8" " 27" x 30" TO PIPE TUNNEL ↓

ALL VENTILATORS CONSTRUCTED IN ACCORDANCE WITH THE RULES & COAMINGS CLOSED WITH WOOD PLUGS & CANVAS COVERS OR STEEL GAS TIGHT COVERS. ✓

Particulars of Air Pipes in exposed positions on freeboard, raised quarter, or superstructure decks:—

1	9. I	AIR PIPE	ON FOLE DK 18"	HIGH	4"	DIA FROM FORE PEAK	✓
2	"	"	"	18"	4"	" FW <sup>2</sup> DEEP TANK	✓
4	"	"	UPPER DK 7-0"	3"	"	" FW <sup>2</sup> COFFER DAM	✓
2	"	"	"	5-0"	3"	" AFT COFFER DAM	✓
2	"	"	"	9-0"	4"	" OIL BUNKERS	✓
2	"	"	"	9-0"	2"	" SETTLING TANKS	✓
2	"	"	POOP DK 18"	4"	"	" N <sup>o</sup> 2 D.B. TANK	✓
2	"	"	"	18"	2"	" D.B. COFFER DAM.	✓
- ALL FITTED WITH HINGED FLAPS.							

29. I AIR PIPES ON POOP DK 18" HIGH x 3" DIA FROM NO. 1 D.B. TANK ↓  
 4 " " " " " 18" " x 2 1/2" " " F.W. TANK ↓  
 1 " " " " " 18" " x 2 1/2" " " STERN COMPT. ↓  
 2 " " " " " 18" " x 3 1/2" " " AFTER P/TANK ↓  
 2 " " " " " BOAT DK 18" " x 2 1/2" " " LUB OIL TANKS ↓  
 1 " " " " " 18" " x 2 1/2" " " DISTILLED WATER TANK ↓

ALL AIR PIPES CLOSED BY WOOD PLUGS & CANVAS COVERS OR GAUZE.

Particulars of Gangway Cargo and Coaling Ports:— *NONE*

Lembus.

Particulars of Scuppers and Sanitary Discharge Pipes :—

UPPER DR SCUPPERS :- 10-6" DIA "COLLISON" TYPE FITTED. ✓

F'CLE SPACE:- 1-2 1/2 P85 LED OVERBOARD WITH STORM VALVE AT SHIPS SIDE & SCREWED PLUGS IN F'CLE FT.

BRIDGE SPACE :- SCREWED PLUGS P85 IN BRIDGE ENDS. ✓

POOP SPACE :- 2'2" x 2" SCUPPERS LED OVER BOARD ABOVE L.W.L. WITH STORM VALVES AT SHIPS SIDE & SCREWED PLUGS AT INNER ENDS. ✓

SANITARY DISCHARGES:- THESE ARE FROM DECKHOUSES ON POOP & BRIDGE DKS ALSO FROM POOP T. DKS & ARE LED OVERBOARD ABOVE UPPER DK IN WAY OF BRIDGE & ABOVE L.N.L. IN WAY OF POOP WITH STORM VALVES AT SHIPS SIDE. ✓

Particulars of Side Scuttles:—

12" BRASS SIDELIGHTS IN POOP SIDES & FRONT WITH CAST STEEL DEADLIGHTS. ✓

B " " " BRIDGE SIDES " " " "

B" " " " F'CLE SIDES & FRONT " " " "

REL SIDELIGHTS OF SUBSTANTIAL CONSTRUCTION.

Vertical distance of Sill of lowest Side Scuttle above top of keel NONE BELOW UPPER DECK.

Particulars of Guard Rails :—

Particulars of Guard Rails:—  
F&E BRIDGE & POOP:— STANCHIONS 3'-6" HIGH, SPACED 4'-6" TO 5'-0" APART WITH 3 RODS

UPPER DECK:-	"	3'-6"	"	"	4'-6"	"	"	3	"	✓
FORE & AFT GANGWAY	"	3'-6"	"	"	5'-0"	"	"	2	"	✓

Particulars of Gangways, Lifelines, etc.:— FORE & AFT GANGWAY AS PER SKETCH FROM POOP TO  
BRIDGE & BRIDGE TO F'CLE. ✓  
SUPPORTS 7'-0"-9'-6" APART WITH FORE & AFT TIES OF  
3 1/2" x 3 1/2" x 4.0 FITTED DIAGONALLY IN ALTERNATE SPACES. ✓

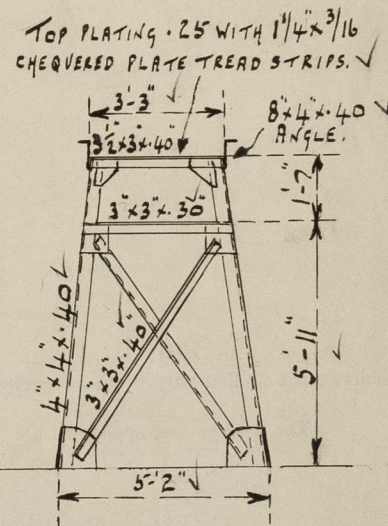

## Particulars of Freeing Arrangements.

	Length of Bulwark	Height of Bulwark	Size of Freeing Ports	Number each side	Area each side	Rule area each side
After Well ... ..	POOP FT 18'-6" BRIDGE END 39'-5"	3'-6"	36" x 15"	2	3.41 sq ft. + 50% open rails	} OVER 50% OPEN RAILS.
Forward Well ... ..	BRIDGE FT 19'-6" FLE FT. 39'-9"	3'-6"	36" x 15"	1	3.41 sq ft. + 50% open rails	

State position of each freeing port ... { After Well :— 18" AFT BRIDGE END & 17" FW<sup>2</sup> OF POOP FT. } 12" ABOVE UPPER Dk.  
(F. and A. position and height above deck edge) { Forward Well :— 18" FW<sup>2</sup> OF BRIDGE FT. }

State whether the freeing ports are fitted with shutters, bars, or rails, and give particulars of such:— **VERTICAL BARS 9" APART.** ✓

Additional area where sheer is less than standard.

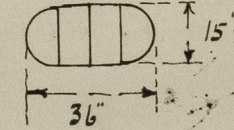



# PARTICULARS OF PROTECTION TO OPENINGS, ETC.

HATCHWAYS ON FREEBOARD AND SUPERSTRUCTURE DECKS.										
<div> <div>FREEBOARD DECK</div> <div>F'CLE DK.</div> <div>POOP DECK</div> </div>										
Description of Hatchway	...	...	CARGO OIL HATCHES	F'CLE SPACE	FW & AFT COFFERDAM	CROSS BUNKER	FORE HOLD.	F. PEAK STORES	TO POOP T. DKS.	TO ROPE STORES
Dimensions of Hatchway	...	...	24 OFF	2'-6" x 2'-6"	6 @ 23" x 18"	2 @ 23" x 18"	8'-0" x 8'-0"	1 @ 2'-6" x 2'-6"	1 @ 2'-6" x 2'-6"	2 OFF 15" DIA.
COAMINGS	Height above Deck	...	10" ✓	9" x 3 1/2" x 40	7" x 3 1/2" x 40	40 ANGLE	30" ✓	9" x 3 1/2" x 44	9" x 3 1/2" x 44	8" x 38 ✓
	Thickness	Sides	75" ✓	B.A.			44	B.A. ✓	B.A. ✓	BULB.
	Stiffeners	Ends					NONE		(6" ABOVE WOOD DK)	
	Brackets, Stays						NONE			
HATCH BEAMS	Number	...					STEEL			
	Spacing	...					TRUNK			
FORE AND AFTERS	Scantling and Sketch	...					TO			
		...					UPPER			
		...					DECK			
	Bearing Surface	...					.30"			
HATCH COVERS	Material	...	O.T. STEEL	W.T. STEEL	W.T. STEEL COVER	W.T. STEEL COVER	W.T. STEEL COVER	W.T. STEEL COVER	W.T. STEEL COVER	W.T. STEEL COVER
	Thickness	...	COVERS	COVER	.50	.40	.38	.38	.38	.38
	How fitted	...	40	38	BOLTED, W.T. PITCH.	2-6" x 3" x 38	TOGGLES	TOGGLES	TOGGLES	TOGGLES
	Bearing Surface	...	TOGGLES	TOGGLES		WELDED TOE ON	15" APART.	15" APART.	15" APART.	WITH STRONGBACK & BUTTERFLY ON UNDERSIDE OF COVER
Spacing of Cleats	...	...	SPACED 20" APART.	SPACED 15" APART.		SPACED 19" APART.				
Number of Tarpaulins	...	...								

\*Are wood fore and afters steel shod at all bearing surfaces? ✓  
 Are battens and wedges efficient and in good condition? ✓  
 Are tarpaulins in good condition and in accordance with rule requirements? ✓  
 Are lashings provided in accordance with rule requirements? ✓

Particulars of any special features:—

Endorsement at first survey and at surveys for renewal of Certificate:—

The fittings and appliances are in accordance with the particulars shown on this form (or as now modified) and are in good condition.



© 2020

Lloyd's Register Foundation