

Lloyd's Register of Shipping.

- 6 NOV 1941

Ship's Name *HARPENDEN*. (NAME MAY BE ALTERED).

Official No.

Memorandum of alterations reported since ship was surveyed for assignment of Load Lines in

OWNERS. - MINISTRY OF WAR TRANSPORT.

MANAGERS. - J. & C. HARRISON, L.D.

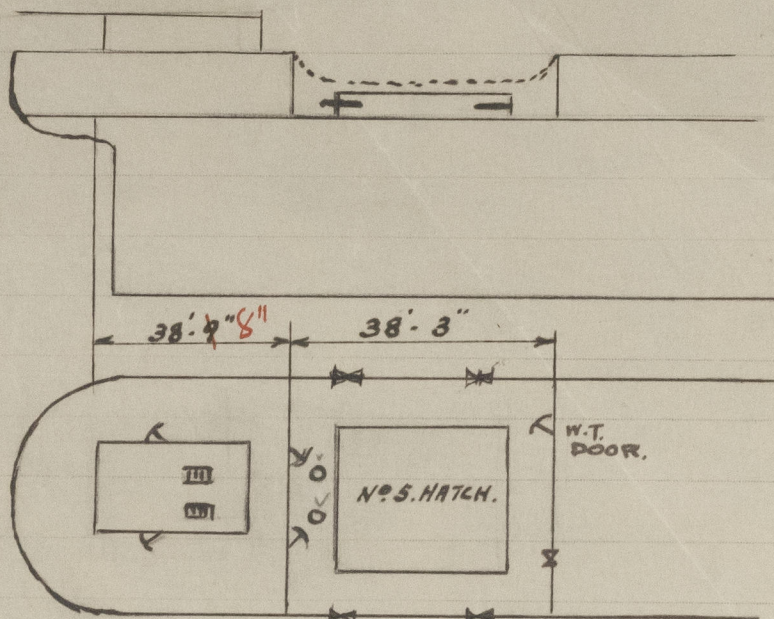

A new aft end, with cruiser stern has been fitted at this time, in lieu of elliptical stern.
Centre of Rudder stock 6'2" aft of A.P. Sheer no alteration made in sheer.

Displacement at 85% moulded depth. (23'02 ft) = 10914 tons.

Position of Poop front bulkhead has been moved ^{forward} aft, now fr. 18.

Position of Bridge end is as before.

POOP FRONT BHD. - Plating. 38. Stiffeners. 6' x 3' x 40. spaced 27" to 30" lugs to deck top & bottom.

" " OPENINGS. - 2 hinged steel doors. 5'-6" x 23 1/2", sills 18". Operated from both sides.

BRIDGE END. as before except that a w.t. hinged steel door 5'-0" x 2'-0" has been fitted
on port side opening, as a temporary measure - entrance to gunners.
accommodation.

Nº5. HATCH. - 29'-3" x 20'-0". COAMING 42" x 44. BEAMS. 5. plates 17 1/2" x 36.

top & bottom angles. 5" x 3' x 40. CLEATS. spaced 24" apart, battens & lashing fitted.
stays fitted to coaming stiffeners.

BULWARKS. 3'-9". Trussing ports. 2.p & 2.s. each. 7'-6" x 9" bottom of opening 14" above
steel deck.

VENTILATORS IN WELL. 2 vents coamings - 21" dia. 36" high x 40.