

"RHODESIA CASTLE" "KENYA CASTLE" "BRAEMAR CASTLE"

NEW FLAT IN TUNNEL

FOR REFRIG ~ MACHINERY

SCALE 1/4" = 1 FOOT

10 JUN 1960
Register & Reg. Wm
LIVERPOOL

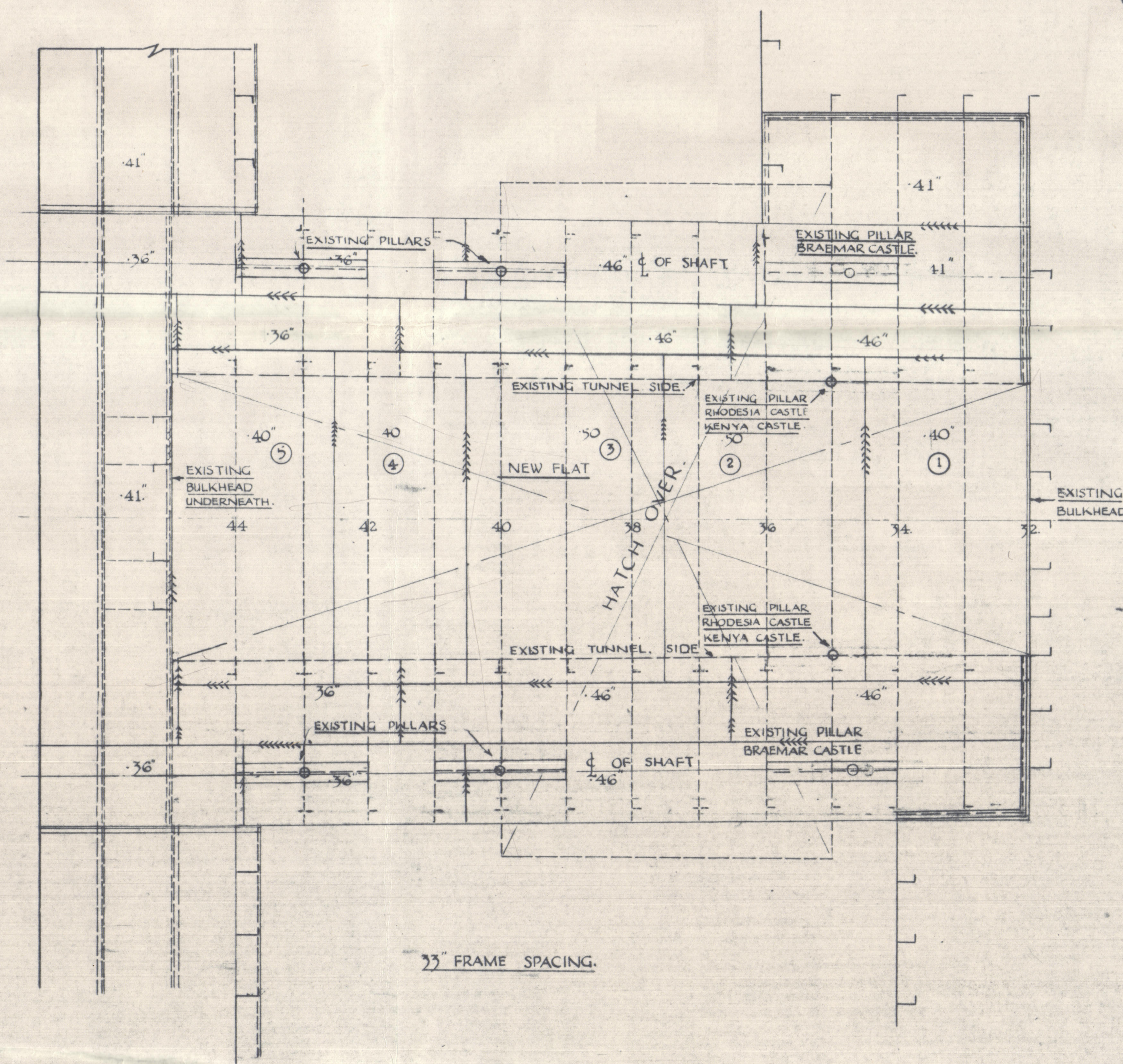
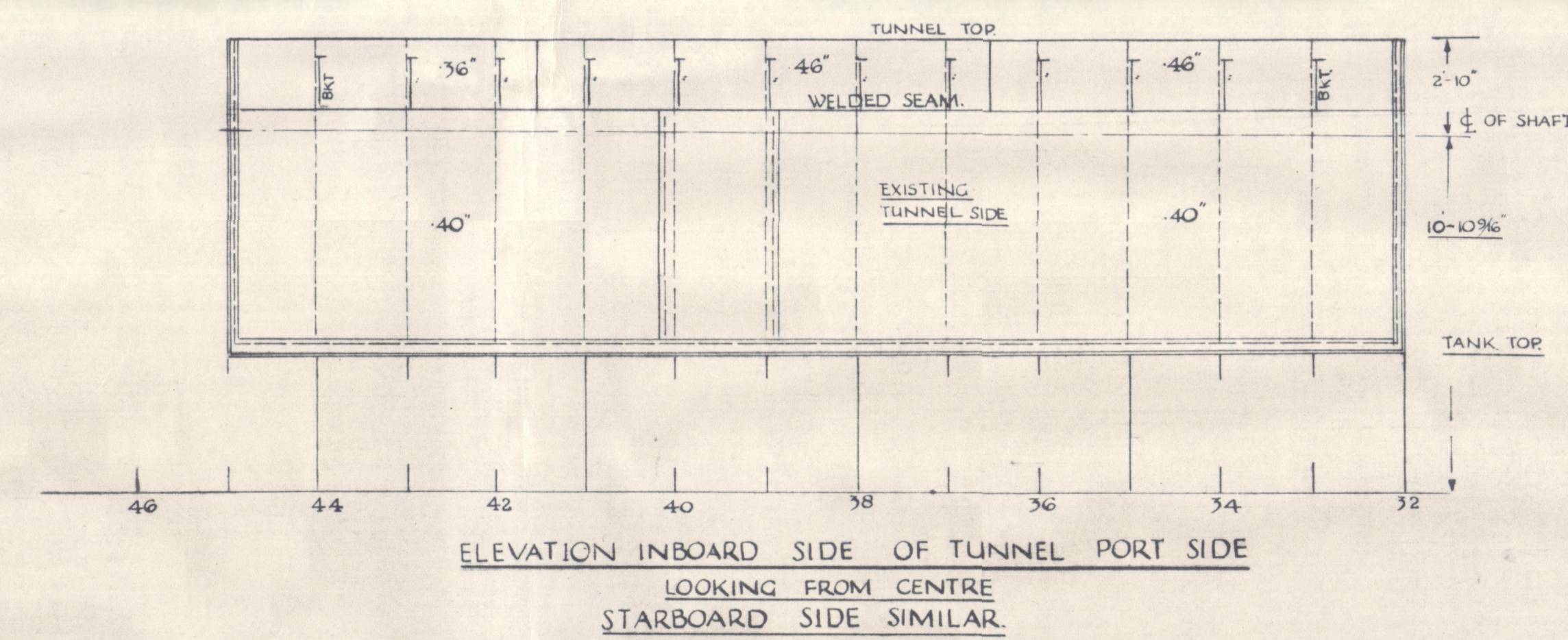

PLAN VIEW AT TUNNEL DECK

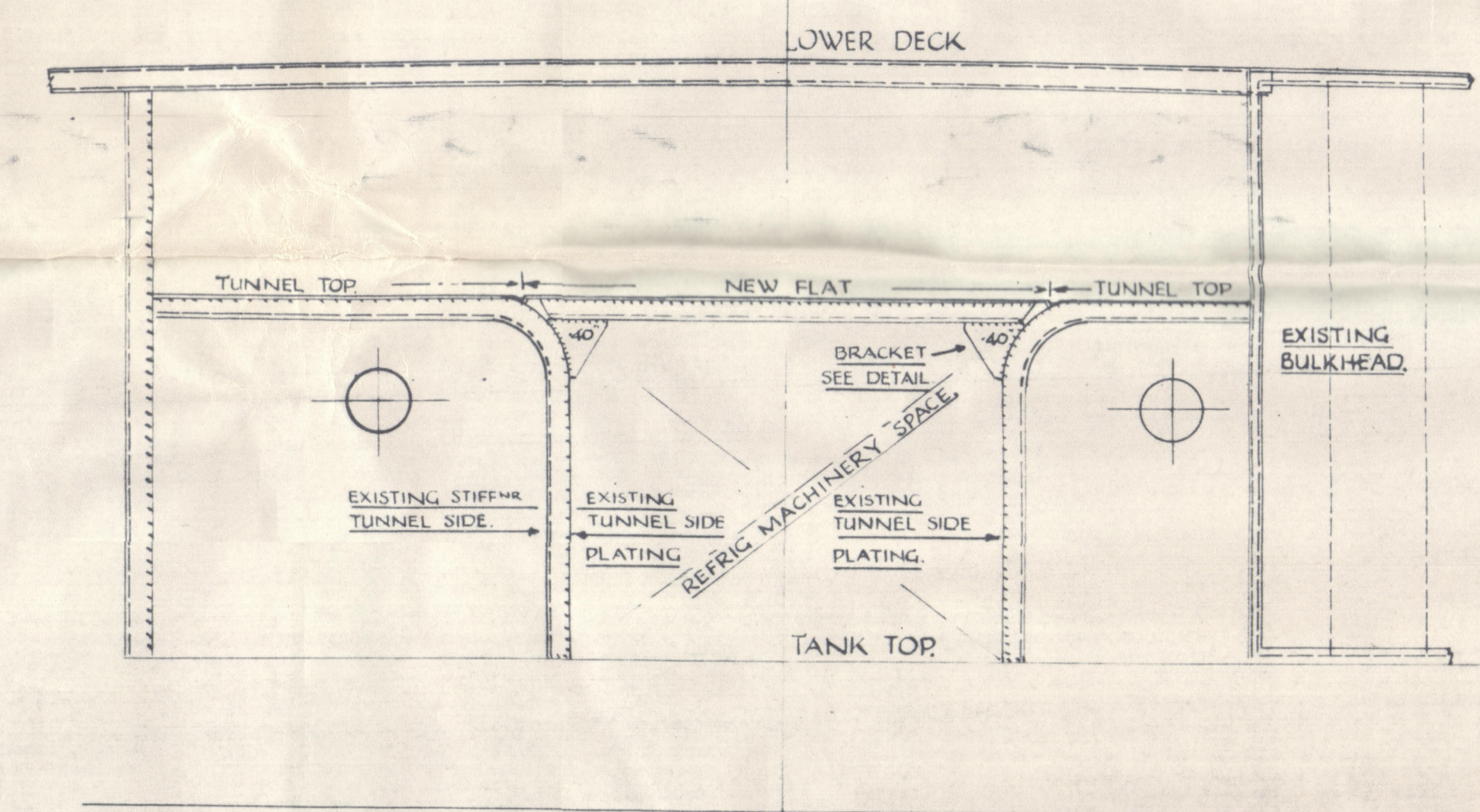

SECTION AT FR 34 LOOKING FORD

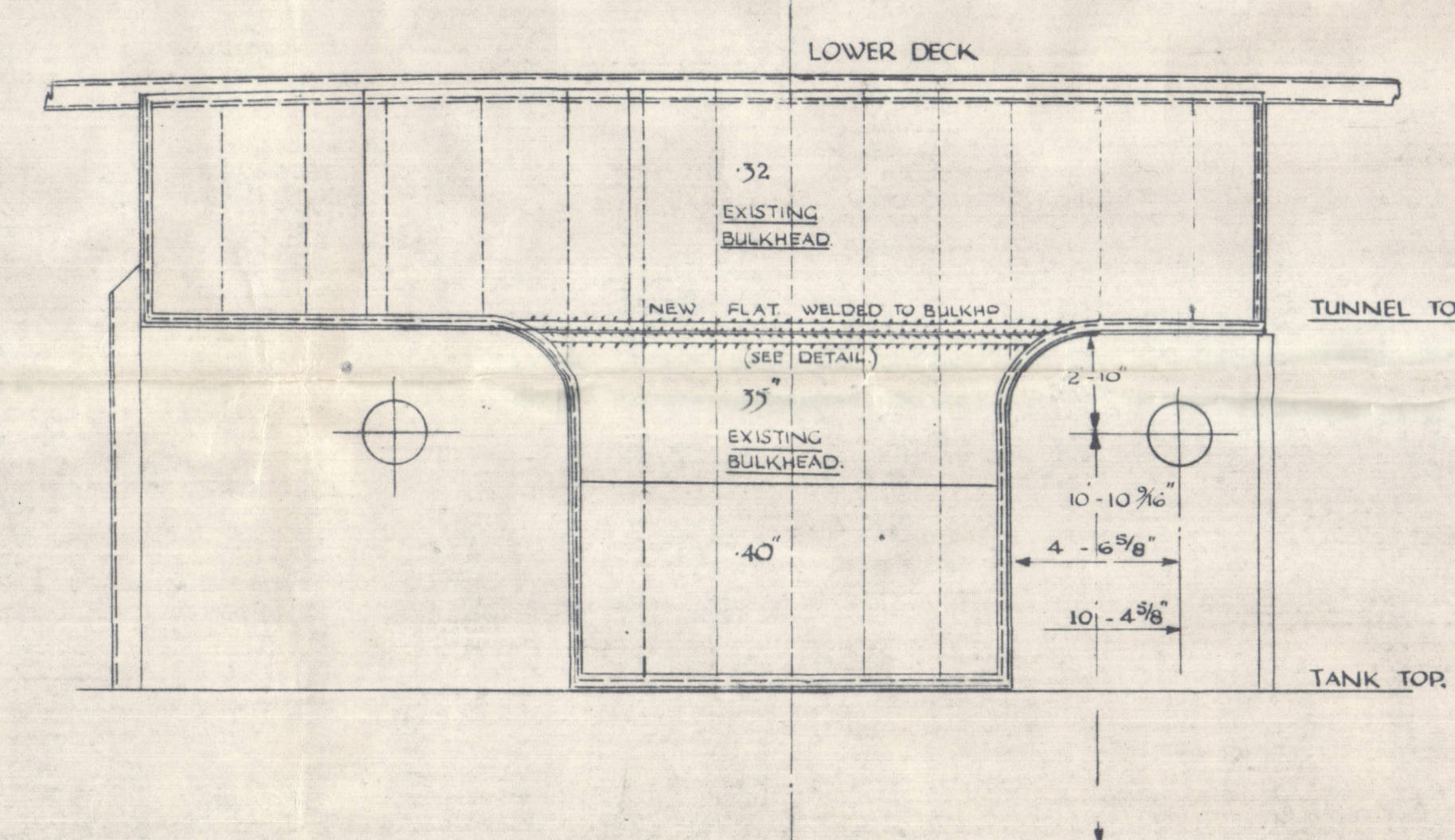

BULKHEAD FR 32 LOOKING FOR

MATERIAL ORDER.				
NO	MARK	LENGTH	BREADTH	GAUGE
1 PLT	T/1	15 - 3	85% "	40"
1 "	"	2 15 - 6	87% "	50"
1 "	"	3 15 - 8	87% "	50"
1 "	"	4 15 - 10	86% "	40"
1 -	"	5 16 - 0	84 "	40"
1 *	"	6 15 - 0	79 "	40"
SECTIONS D ^o				
6 BARS	T/1	28 - 0 "	7 x 3/2 x .46 "	
2 F.B.	2	15 - 6 "	5 x 1/2 F.B.	

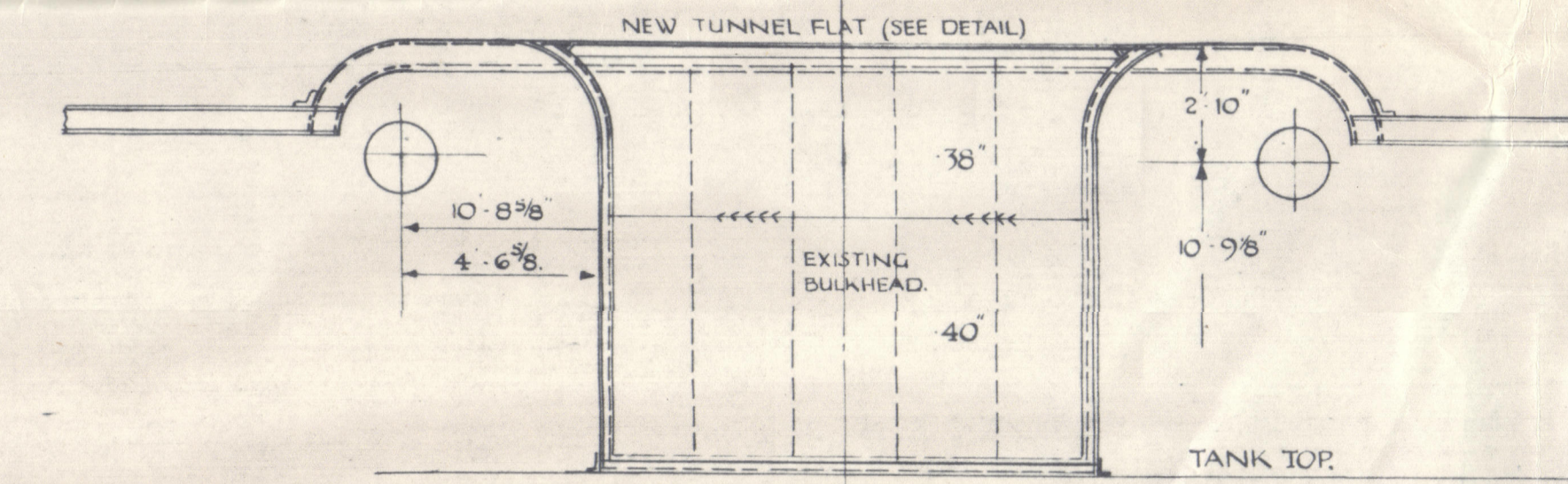

SECTION AT FR 45

LOOKING AFT.

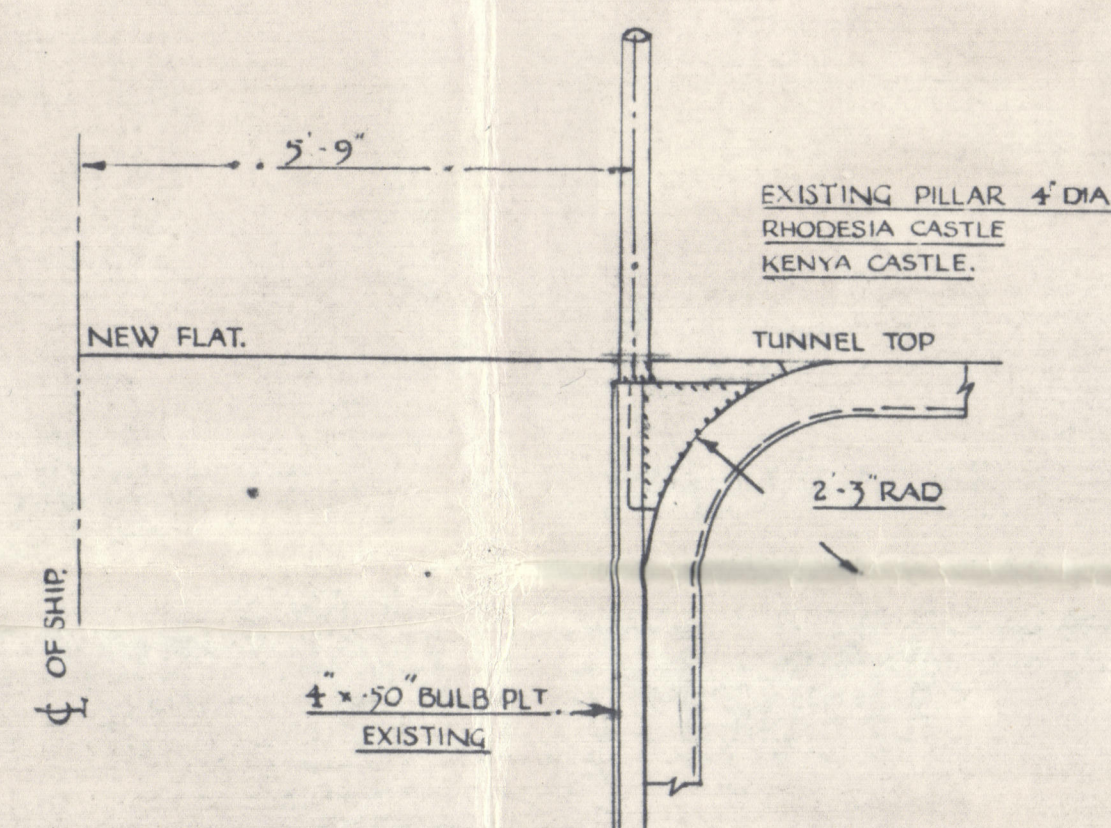

DETAIL OF PILLAR FOOT FR 35
RHODESIA CASTLE | KENYA CASTLE
SCALE $\frac{1}{2}$ " = 1FOOT.

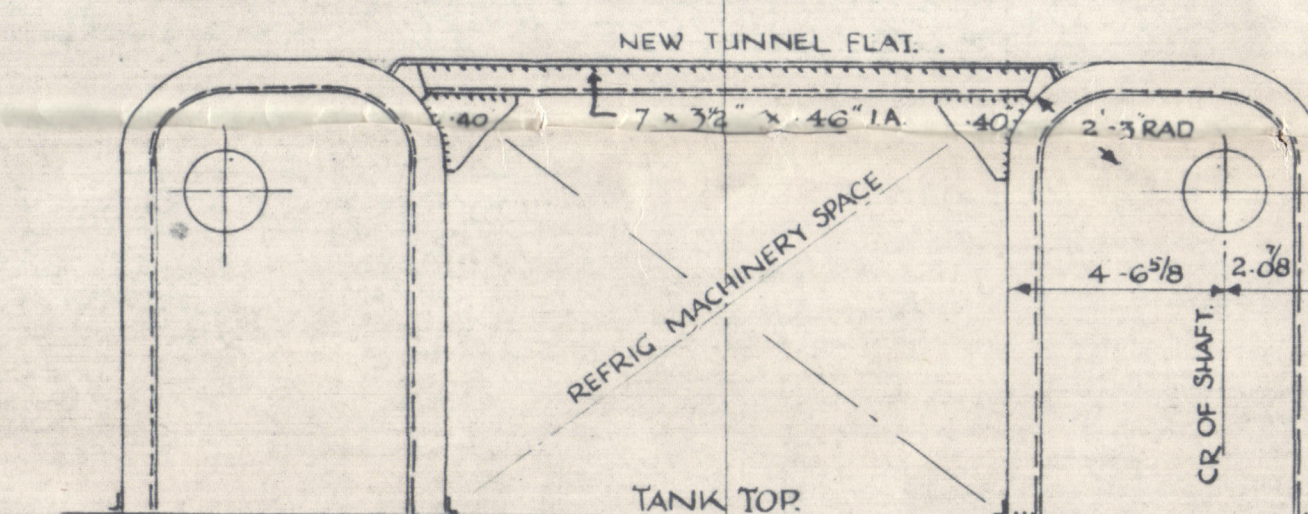

TYPICAL SECTION 37-41.
LOOKING FORP

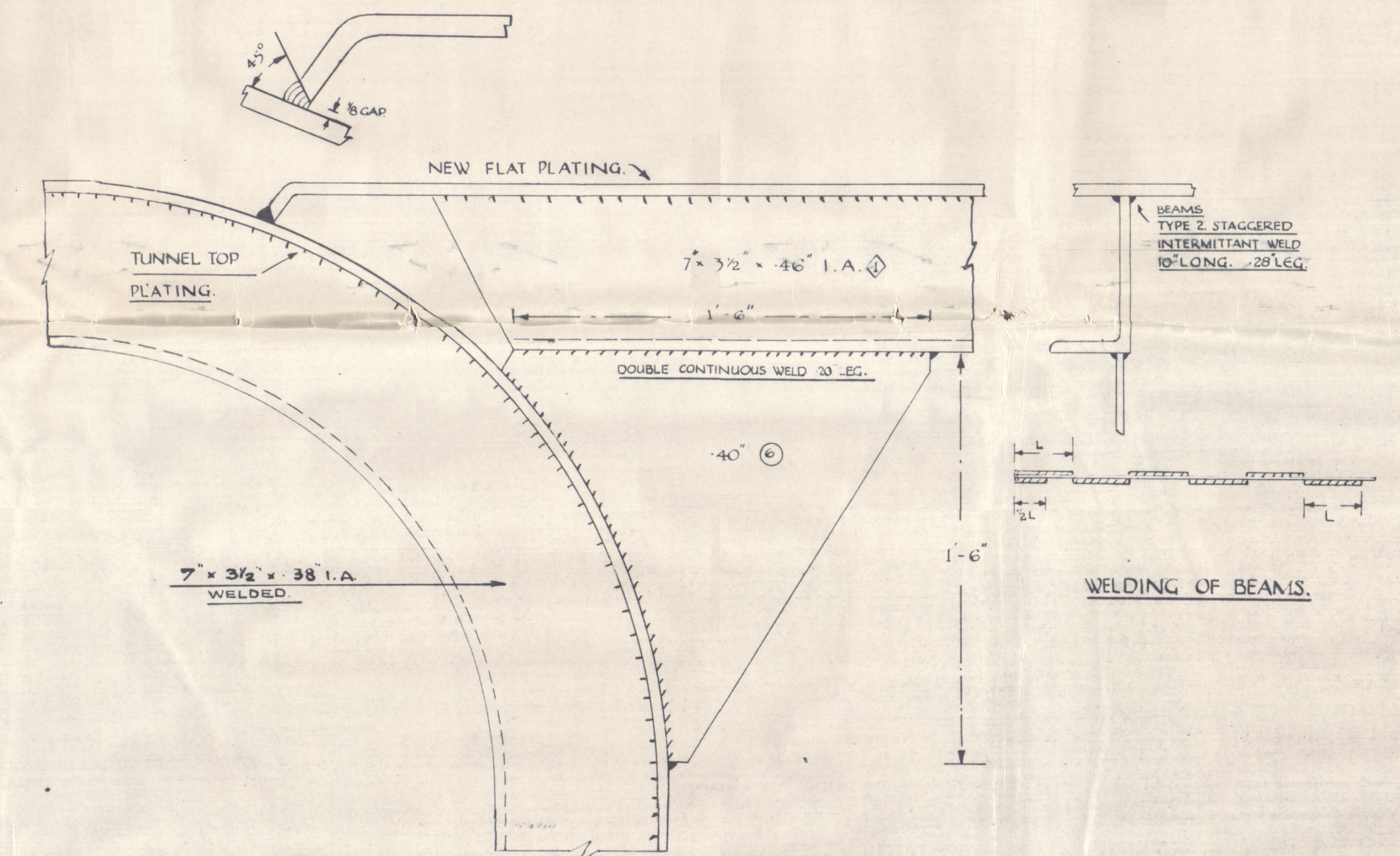

TYPICAL SECTION

SCALE ¼ FULL SIZE.

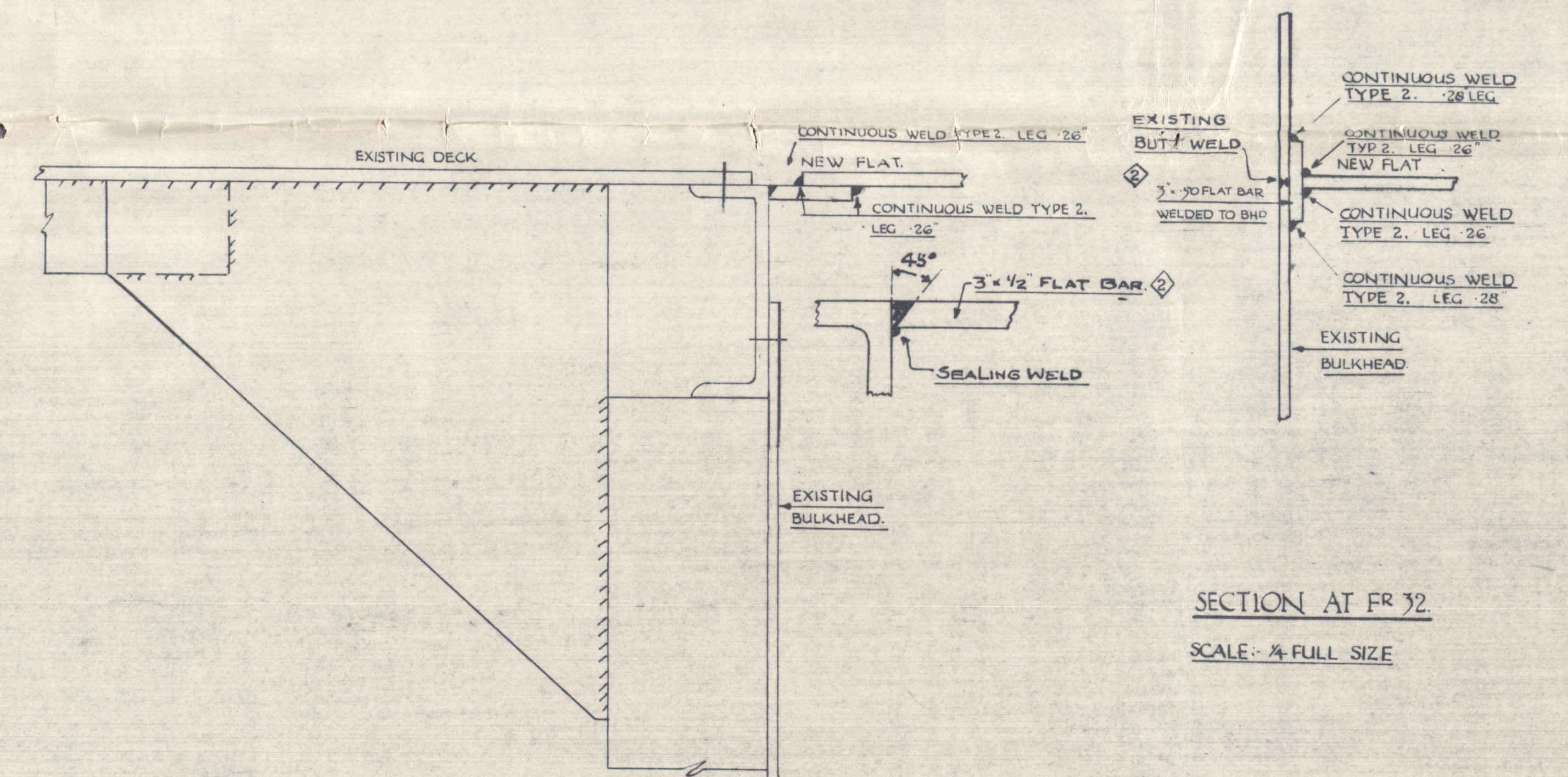

SECTION AT FR 32.
SCALE: 1/4" = 1' FULL SIZE

SECTION AT FR 45.

SCALE : ¼ FULL SIZE

Liverpool Works.
HARLAND & WOLFF
LIMITED
8 JUN 1960
Shipbuilders & Engineers
LIVERPOOL

"RHODESIA CASTLE"

NEW FLAT IN TUNNEL FOR
REFRIG. MACHINERY.

Attached to Liverpool Report 155577



© 2020

Lloyd's Register
Foundation

005353-005357-0090