

13 JAN 1956

Rpt. C. 11 (Contd.)

Index No.

264619  
(For London Office use)

## LLOYD'S REGISTER OF SHIPPING

UNITED WITH THE BRITISH CORPORATION REGISTER

28376

## ALTERATIONS TO CONDITIONS OF ASSIGNMENT OF LOADLINES

Ship's Name "HOLDERVINE" (ex 'Afon Gwili') Official No. 130057Port of Registry Hull.This ship has been under survey at Hull.on 16th December, 1955 and the following alterations to the conditions of assignment of loadlines have now been effected/~~found~~:—ADDITIONAL SANITARY DISCHARGES.

Draining screws W.C. (Originally lamplocker) 4" Pipe leading overboard below freeboard deck.

1 P.S. amidships accommodation 2" pipe leading overboard.

1 P.S. aft. from 2nd Engineers cabin 1½" pipe leading overboard.

The above fitted with G.M. non-return valves.

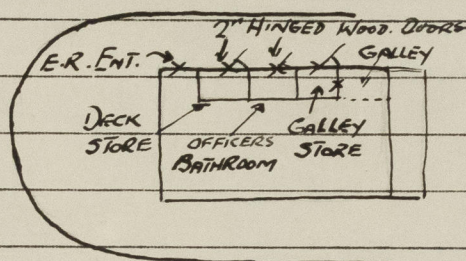
ALTERATIONS TO MACHINERY CASING ON R.Q.DECK. (No additional openings to E.R.).

*E. B. Fraser*  
 SURVEYOR TO LLOYD'S REGISTER  
 OF SHIPPING. HULL. 12/1/56.

*Copy placed on ship**DR* 16 JAN 1956

A copy of this Report has been placed on board.



F.B.



© 2020

Lloyd's Register  
Foundation