



NO 1686.

STERN FRAME & RUDDER.

SCALE 1" = 1 FOOT UNLESS OTHERWISE STATED.

RUDDER FRAME & STERN FRAME TO BE OF MILD FORGED STEEL TO LLOYDS REQUIREMENTS.
ALL DIMENSIONS GIVEN ARE FINISHED SIZES.
AREA OF RUDDER = 52.25 SQUARE FEET.
SPEED OF VESSEL = 11 1/2 KNOTS.
CG OF RUDDER AHEAD CENTRE LINE OF PINTLES = 2.35 FEET.
A x D = 122.79 = 5 1/2 DIA OF STOCK.

FORGINGS TO BE OF A PERFECTLY FAIR & SMOOTH FINISH

SUITABLE FOR A FIRST CLASS YACHT.

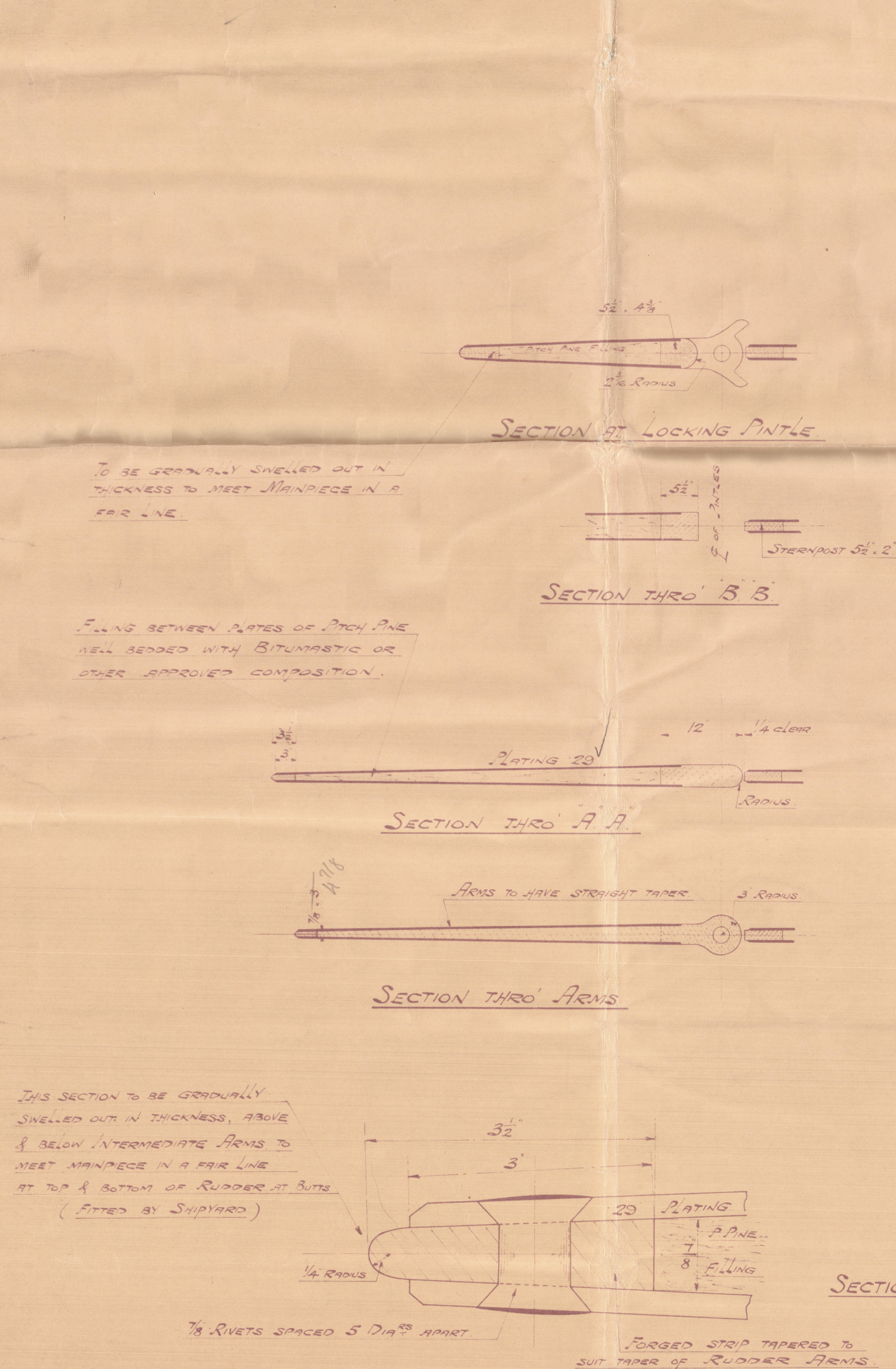

FULL SIZE SECTION OF AFT EDGE OF RUDDER
IN WAY OF INTERMEDIATE ARMS.

DRAWING NO 3.

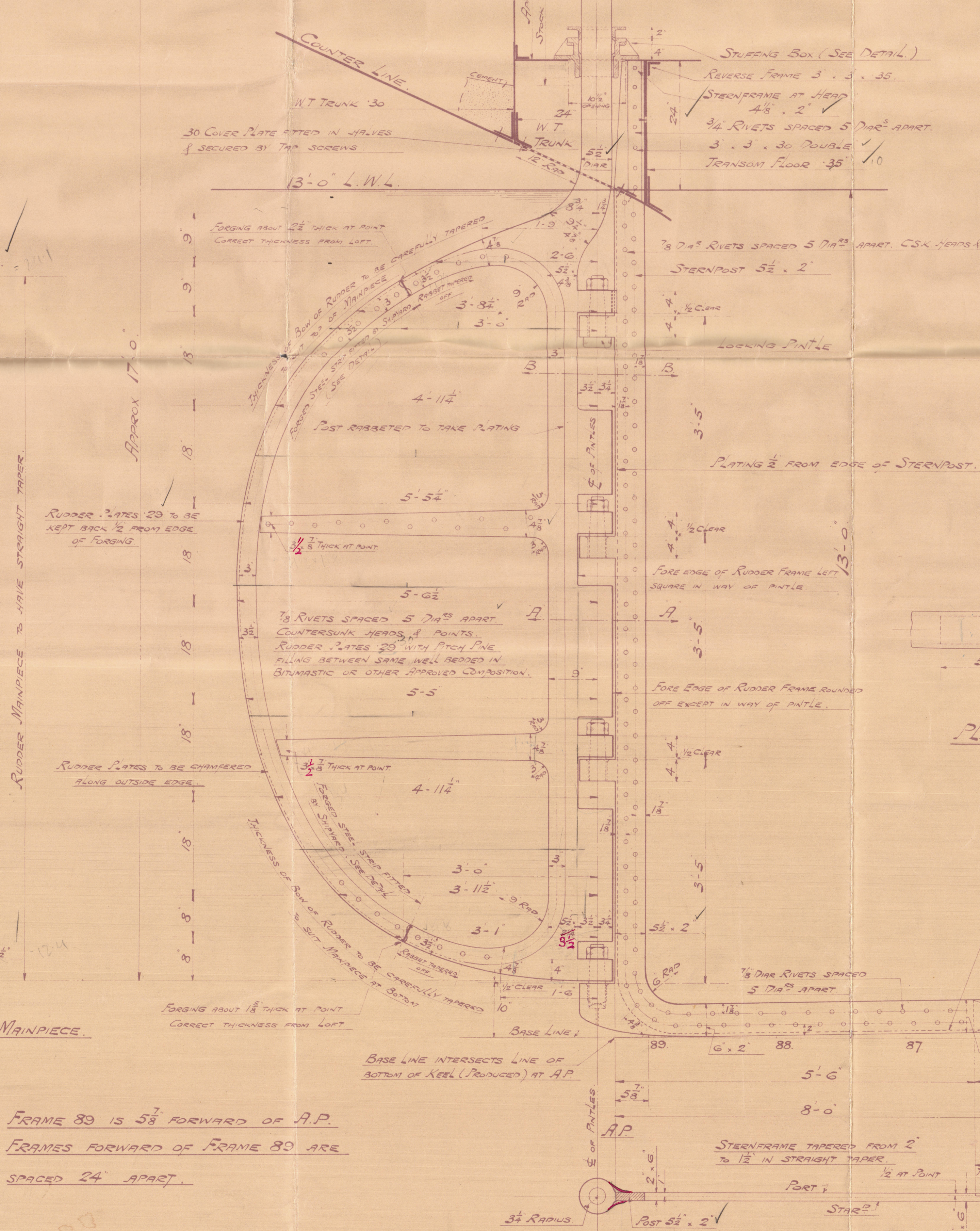

DETAIL OF LOCKING PINTLE
SCALE 3" = 1 FOOT.
MILD STEEL 1 OFF.

ELEVATION.

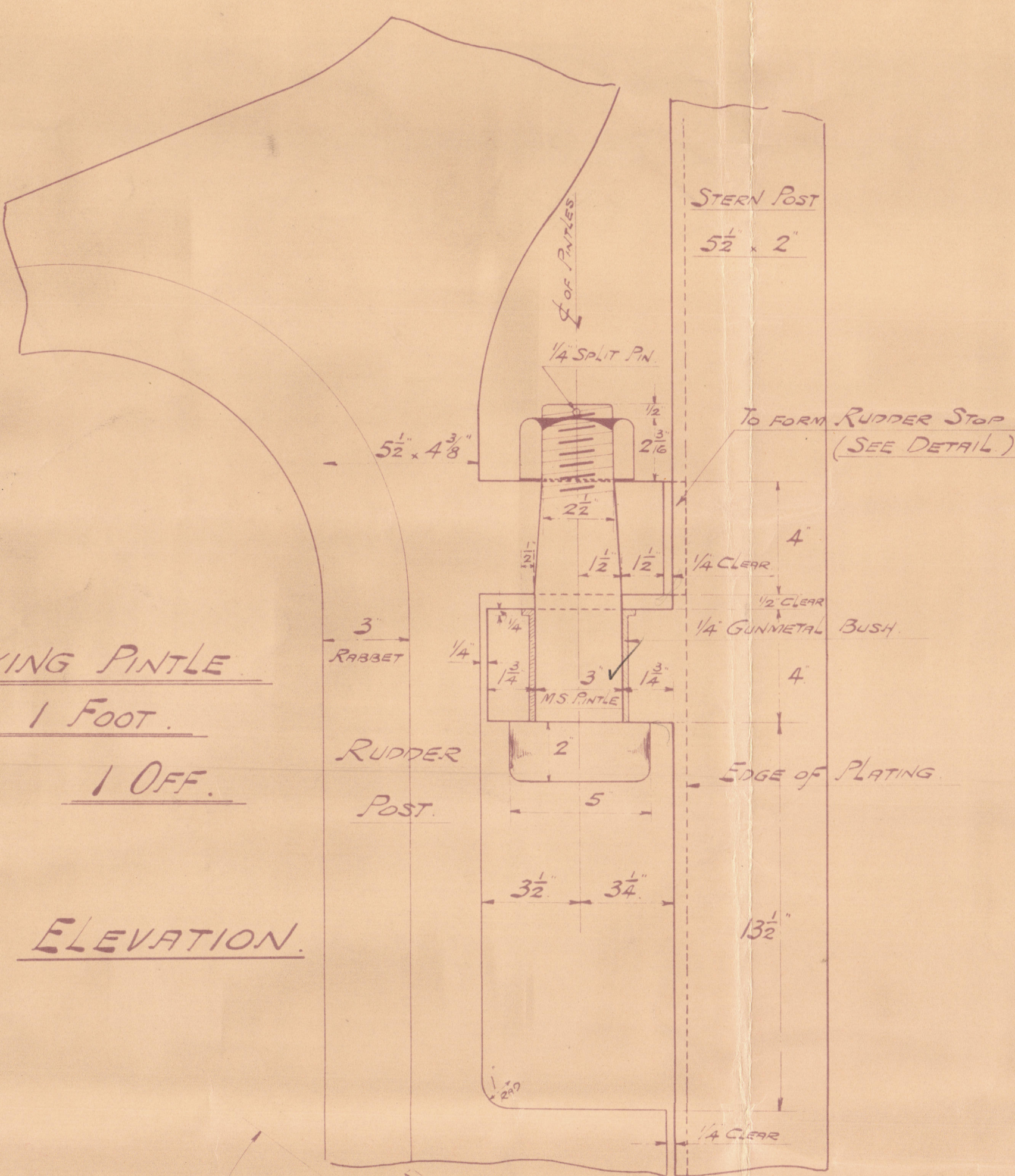

PLAN VIEW.

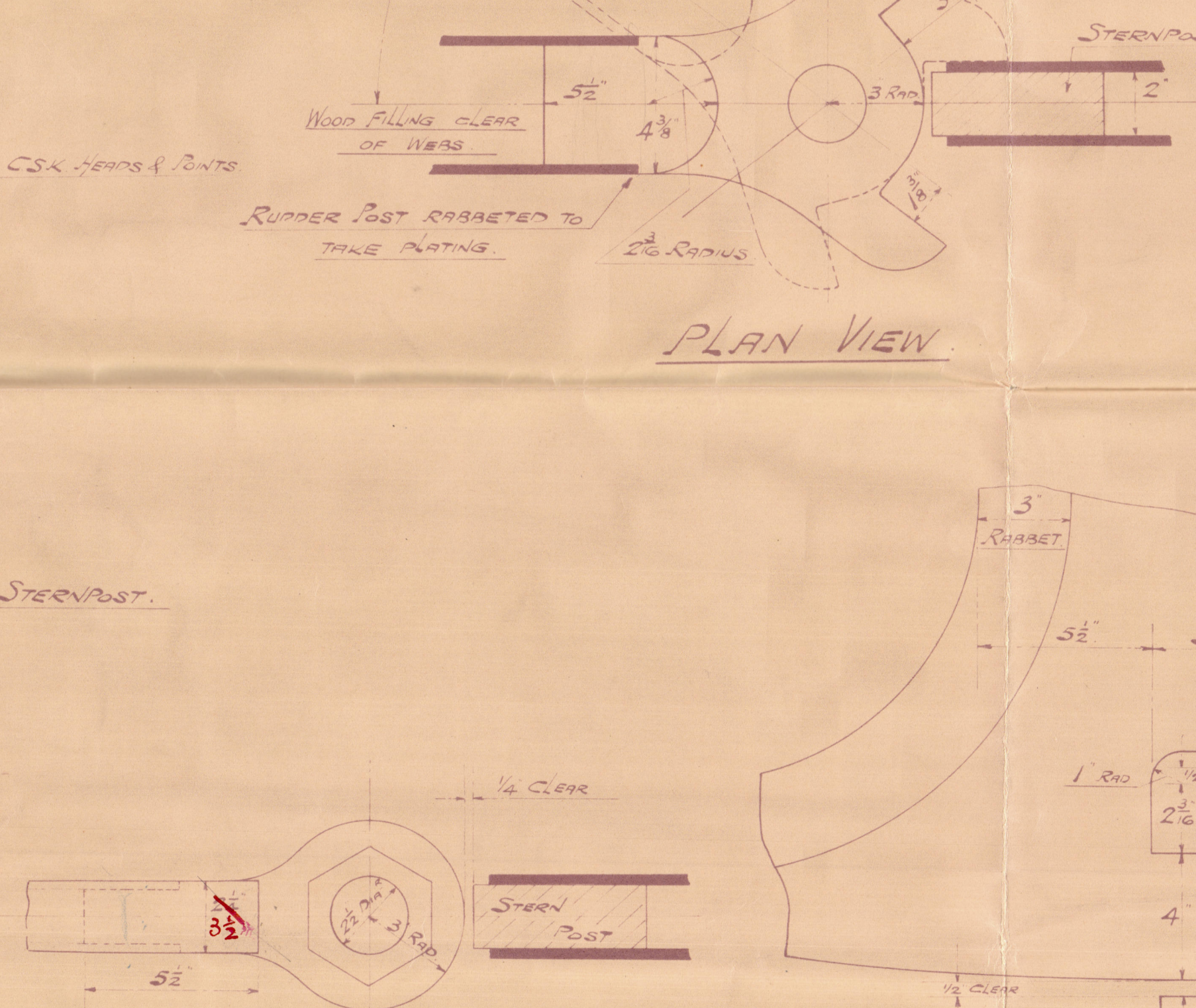

PLAN VIEW AT HEEL PINTLE.
SCALE 3" = 1 FOOT.



ELEVATION.

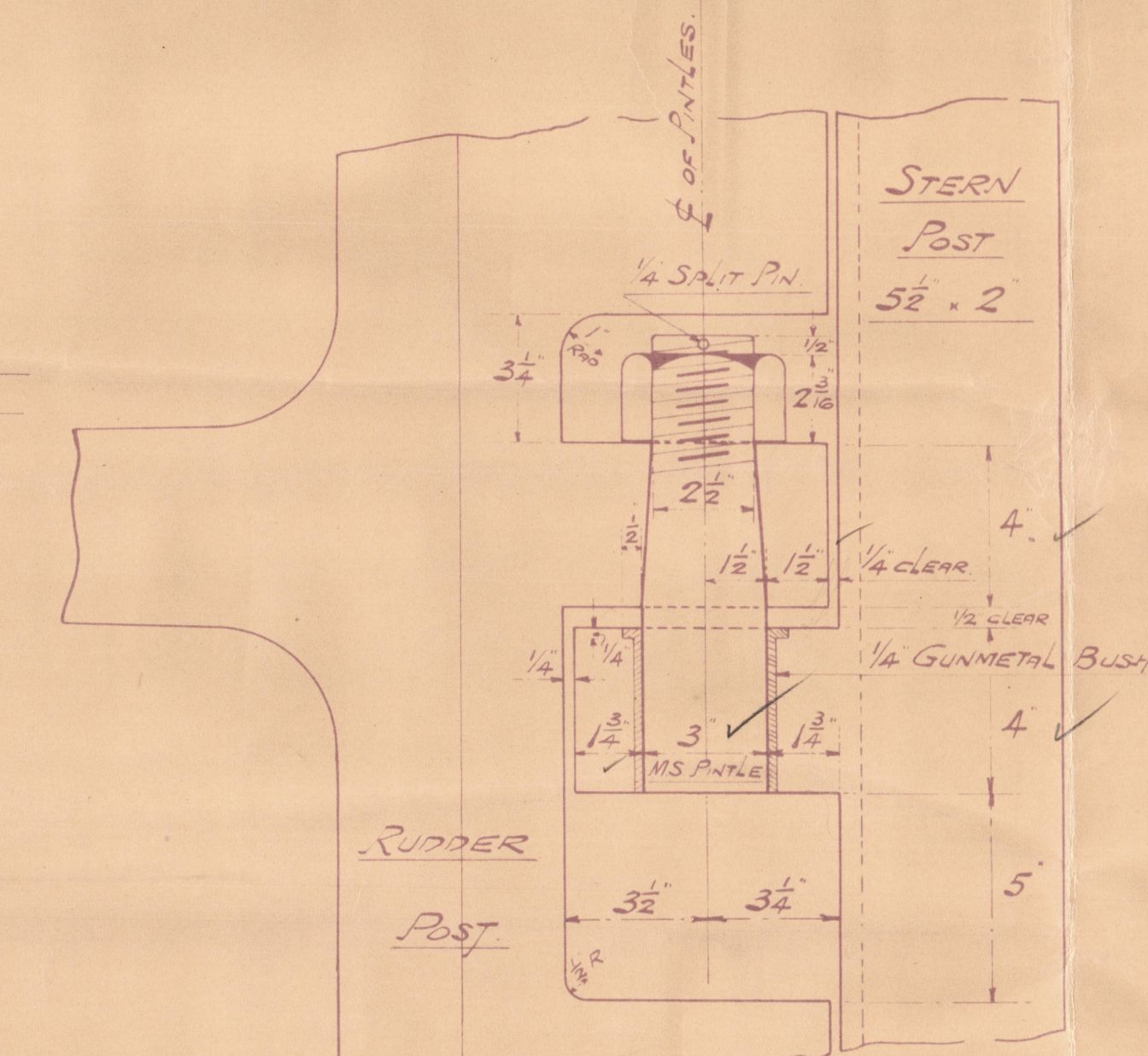

PLAN VIEW.

DETAIL OF INTERMEDIATE PINTLES
SCALE 3" = 1 FOOT.
MILD STEEL 2 OFF.

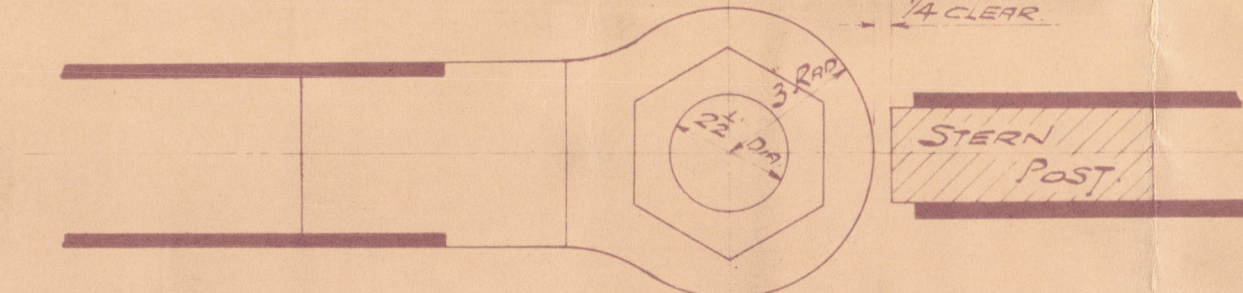

EDGE OF SHELL PLATING.

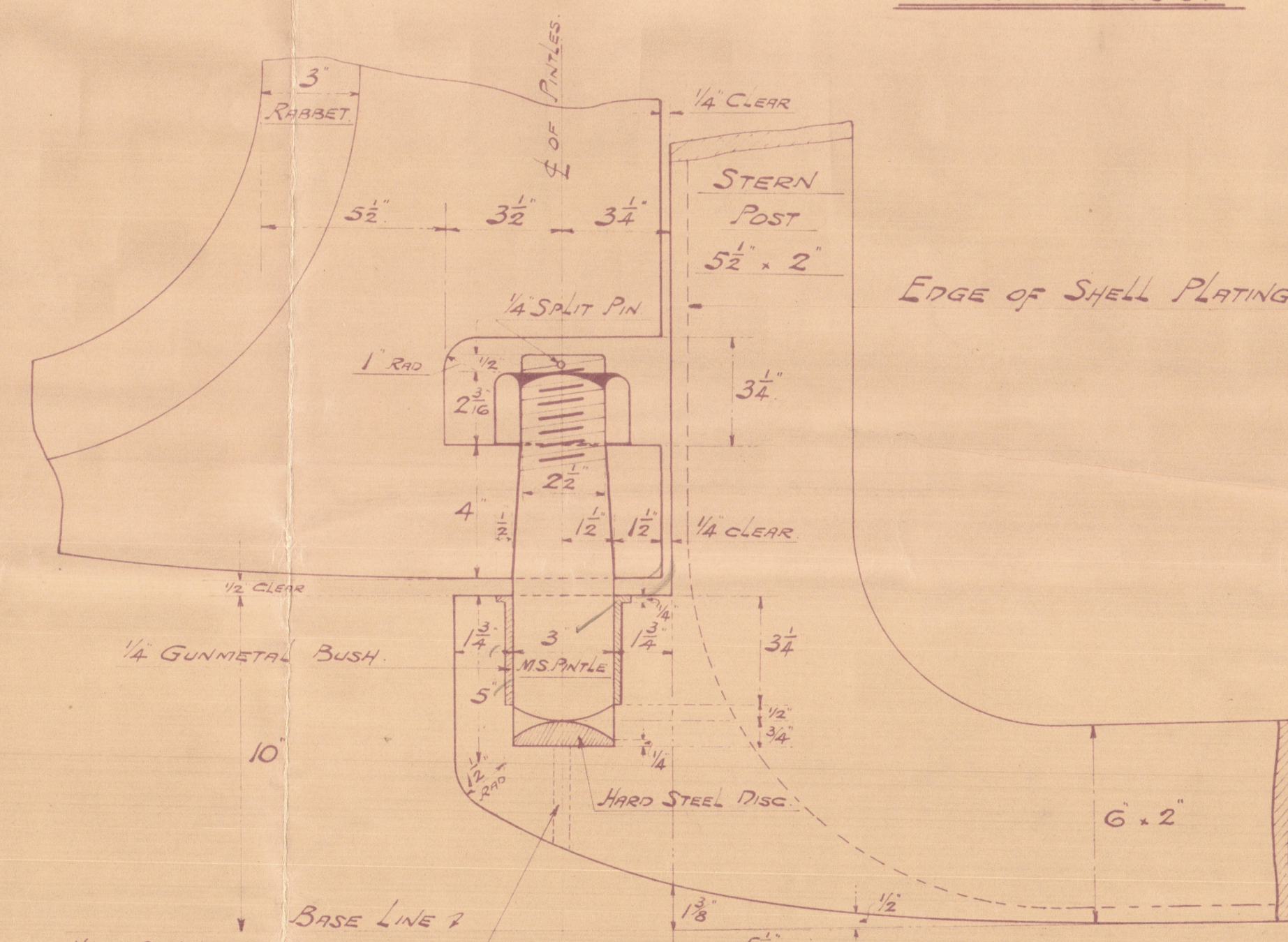

DETAIL OF HEEL PINTLE.
SCALE 3" = 1 FOOT.
MILD STEEL 1 OFF.

NOTE: SCARPH OF STERNFRAME
TO BE LEFT BLANK.

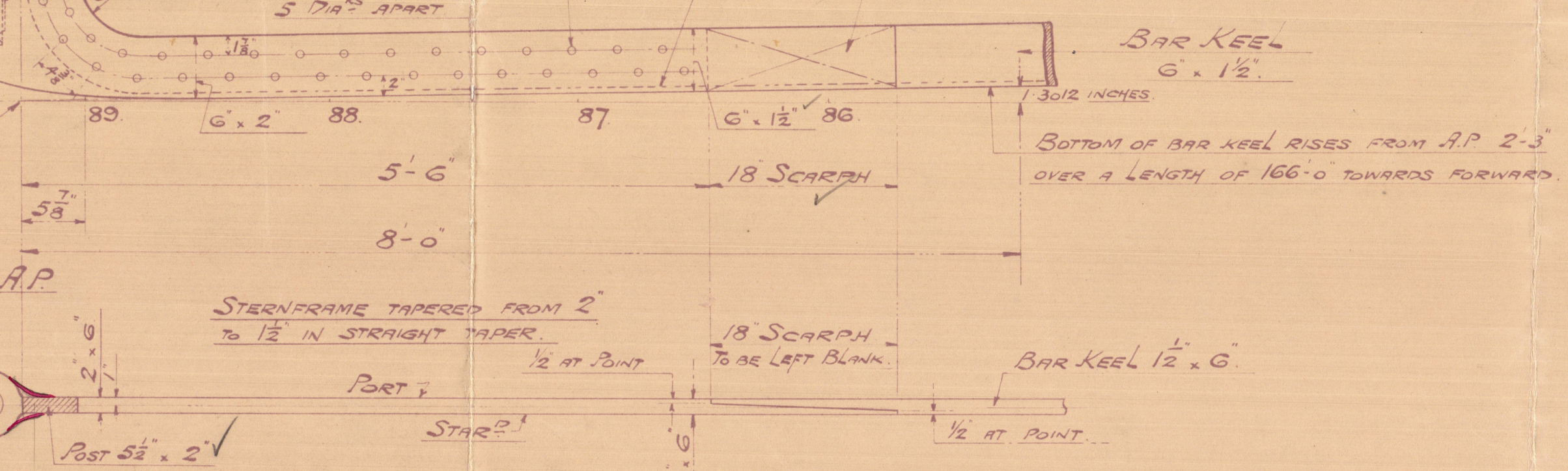

005082-005088-0066

XARIFA

CAYMANIA

Nº 1686

T.S. Yacht.

J.S. White & Co. Ltd.
Cowe.

STERN FRAME

✓
RUDER

App'd. plan.

11/6/29.

Caymania

005082-005088-0066



© 2020

Lloyd's Register
Foundation