

14 JAN 1922

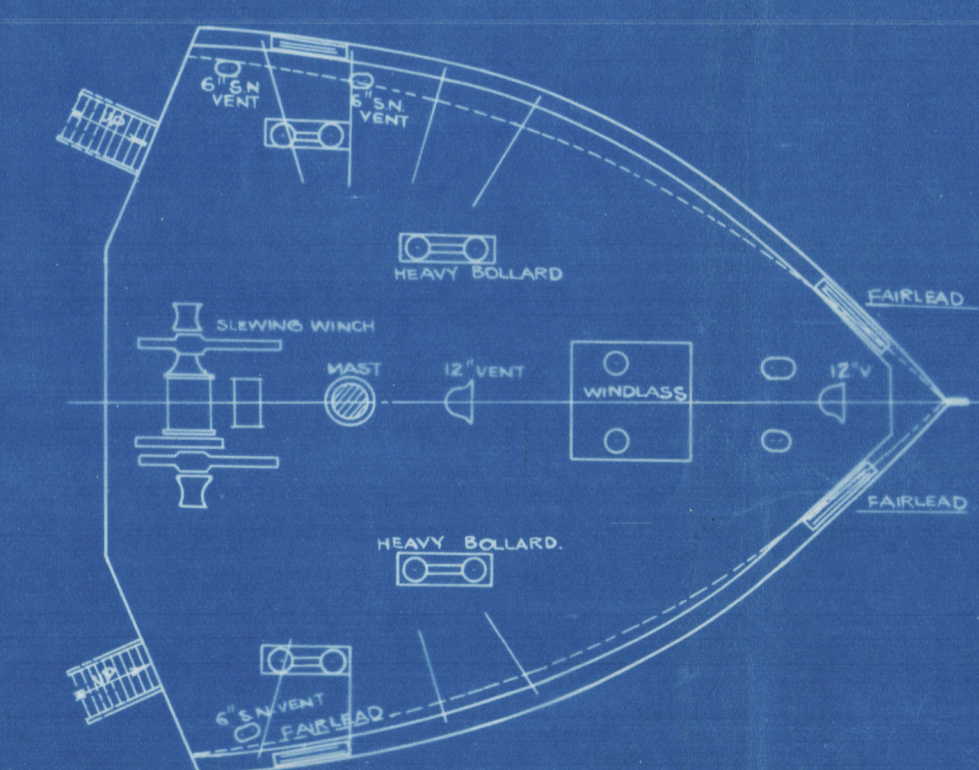

DIMENSIONS
 LENGTH = 200 FT.
 BREADTH = 33 FT.
 DEPTH MLD = 13 FT. 6 INS.

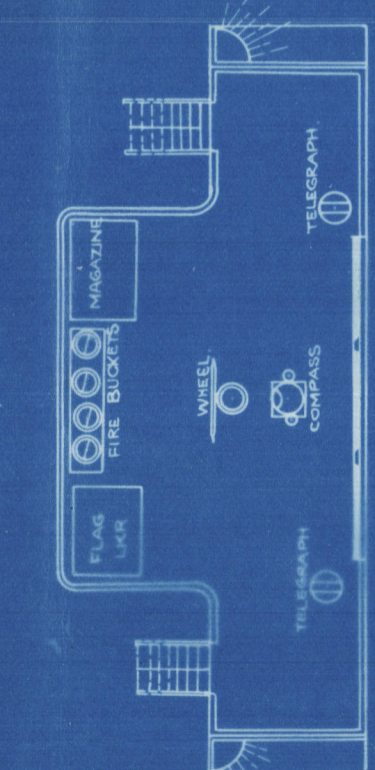
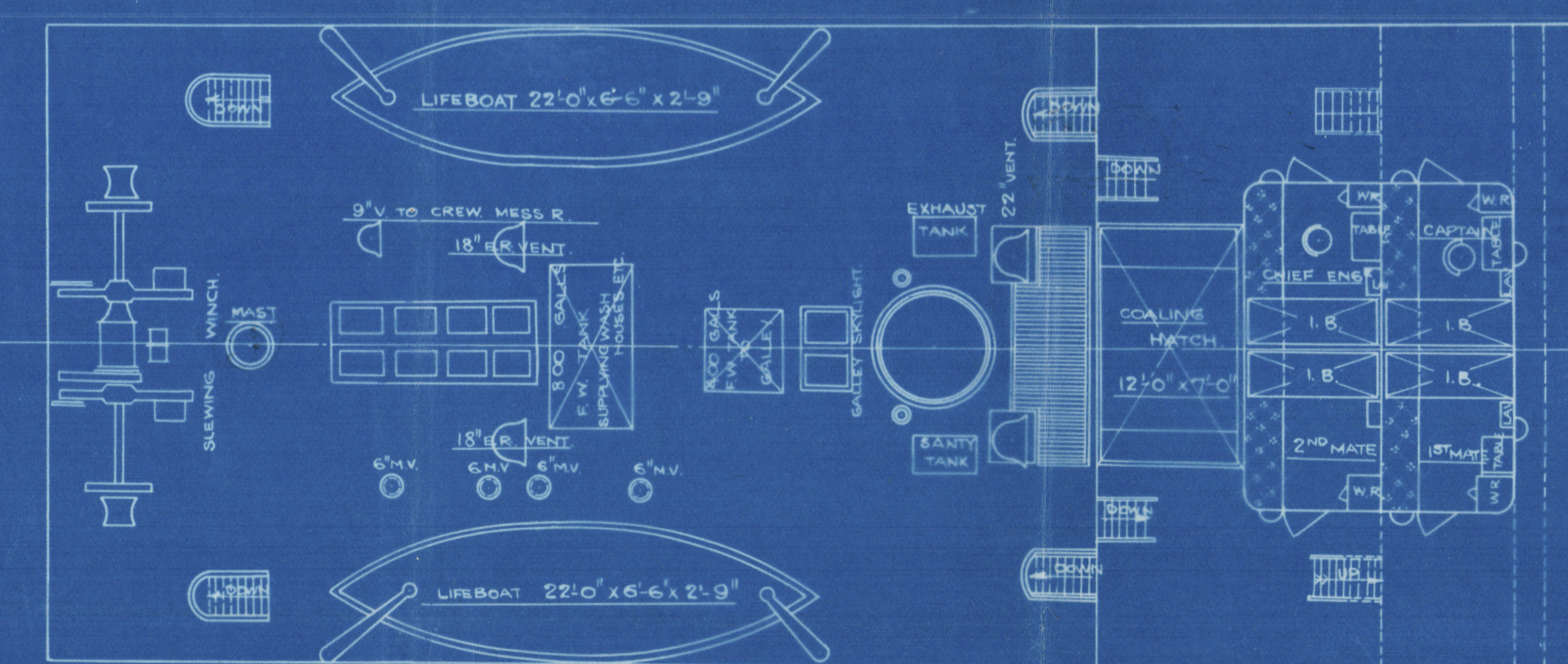
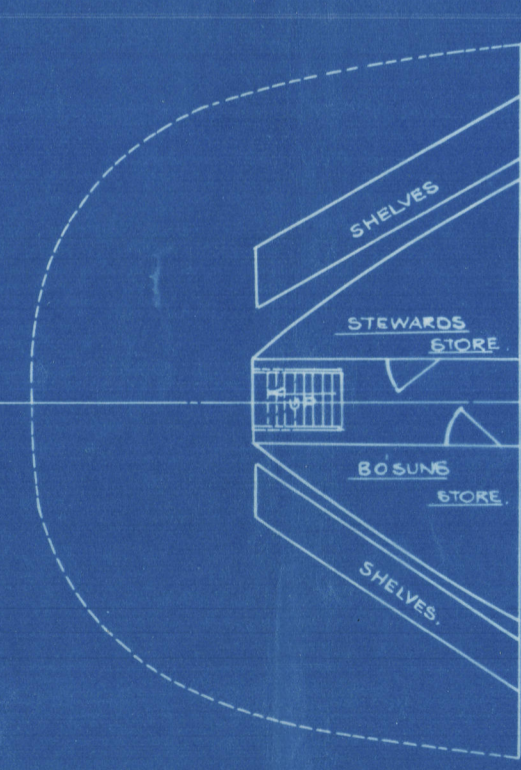
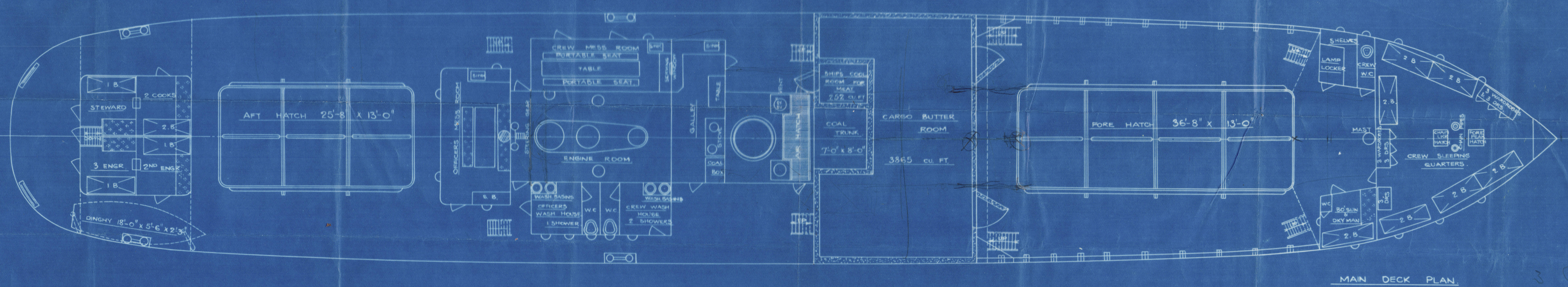
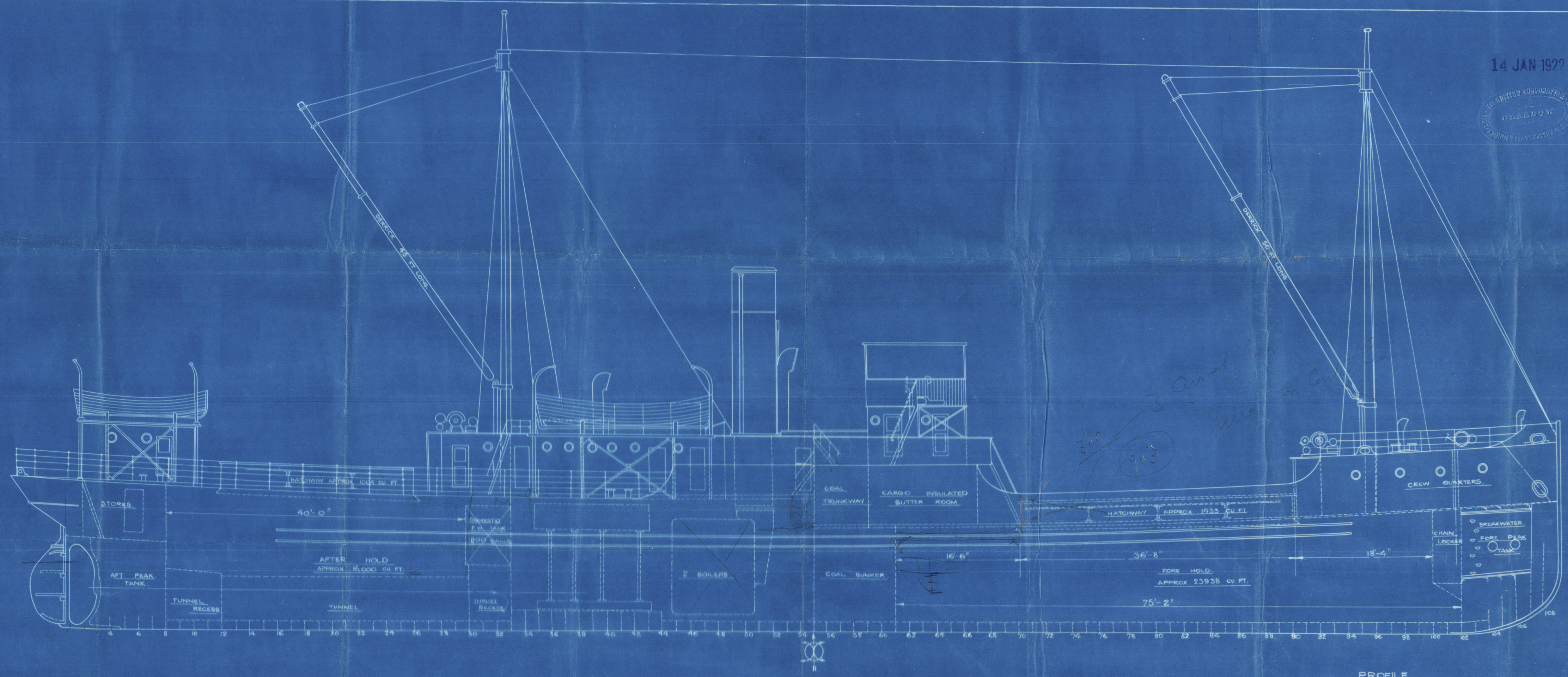
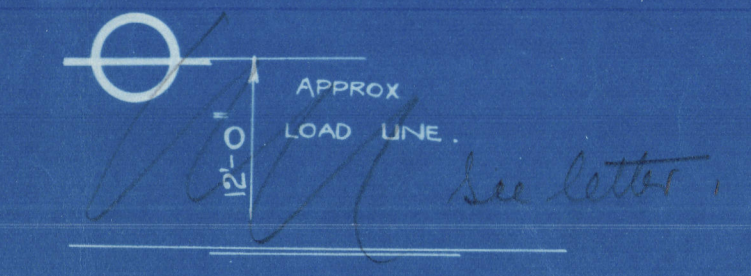

PROFILE & DECK PLANS
 OF
PROPOSED CARGO VESSEL
 TO BE BUILT FOR
NORTH COAST S. N. COY. LTD.
 FOR
COASTAL & RIVER SERVICE IN N.S.W.
 TO MEET REQUIREMENTS OF CLASS *
 22ND. NOV. '21.

SCALE 1/8" = 1 FOOT

R. D. HENDRY & SONS
 140 ST. VINCENT STREET
 GLASGOW.

Now 751

RETAIN

P. D. Hendry & Co.
Proposed Vessel for
North Coast Steam Navigation Co.
General Arrangement
200 x 33 x 13'6"

004982 - 004987 - 0130



© 2020

Lloyd's Register
Foundation

P. D. Hendry & Co

Pro N. C. Steam Navⁿ Coy^{ys}

lessee 700' long $\times 33 + 13' 6$.

Seal Arrang^t.



© 2020

Lloyd's Register
Foundation