

LLOYD'S REGISTER OF SHIPPING

GLASGOW REPORT No. 48319.

SURVEYS FOR FREEBOARD

(CONDITIONS OF ASSIGNMENT)

Ship's Name **"FRED EVERARD."**

Port of Survey **GRANGEMOUTH**

Official Number **187792**

Surveyor's Signature **Alister M. Cameron**

Nationality and Port of Registry **BRITISH - LONDON.**

Date of Survey **DURING CONSTRUCTION.**

Disposition and dimensions of superstructures, trunks, deckhouses, machinery casings and wood sheathing to be inserted in the diagrams and tabular statement :-

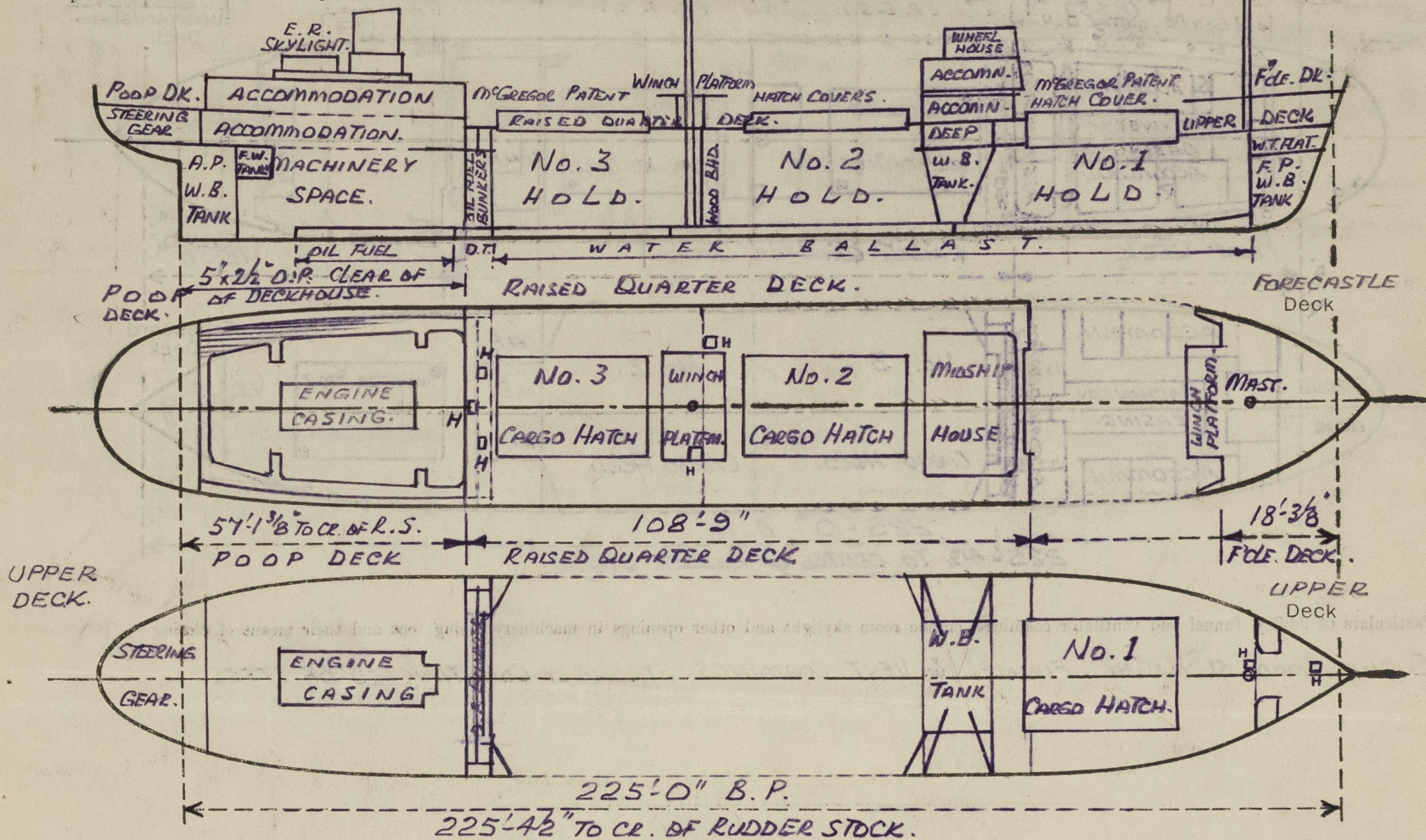

Particulars of Superstructures, Trunks, Casings, Deckhouses.

	Coaming	Plating	Stiffeners	Spacing	End Attachments of Stiffeners	Size of Openings	Height of Sills	Height, Beam to Beam
Poop Bulkhead	30"	30"	3"x2 1/2"x 25" I.A.	24"	WELDED AT POOP & UPPER DECK'S	NONE	-	2'8" ABOVE R. & D.
Raised Quarter Deck Bulkhead	32"	32"	3"x2 1/2"x 30" I.A.	32"	WELDED	NONE	-	5'0" ABOVE UPPER DECK.
Bridge, After Bulkhead								
Bridge, Forward Bulkhead								
Forecastle Bulkhead								
Trunk, Aft								
Trunk, Forward								
Exposed Machinery Casings on Freeboard or Raised Quarter Decks								
Exposed Machinery Casings on Superstructure Decks								
Machinery Casings within Superstructures not fitted with Class I Closing Appliances	23"-25"		3"x4" FLAT BARS 3/4" PLG. PLATE.	34" & 31"	NONE AT TOP CARDED THRO' AT BOTTOM	STAD. 5'0"x2'6" FWD. 5'0"x2'6"	15" 15"	7'6"
Deckhouses and Pump Room Entrances								

Particulars of Closing Appliances (state if capable of being manipulated from both sides).

Poop Bulkhead	INTACT
Raised Quarter Deck Bulkhead	INTACT
Bridge, After Bulkhead	
Bridge, Forward Bulkhead	
Forecastle Bulkhead	
Exposed Machinery Casings on Freeboard or Raised Quarter Decks	
Exposed Machinery Casings on Superstructure Decks	
Machinery Casings within Superstructures not fitted with Class I Closing Appliances	HINGED STEEL DOORS, OPERATED BOTH SIDES.
Deckhouses and Pump Room Entrances	

PARTICULARS OF PROTECTION TO OPENINGS, ETC.

The following diagrams should be used to indicate the positions of cargo and coaling hatchways, gangway, cargo and coaling ports, side scuttles, scuppers, ventilators, companionways, etc., which would affect the seaworthiness of the ship :-

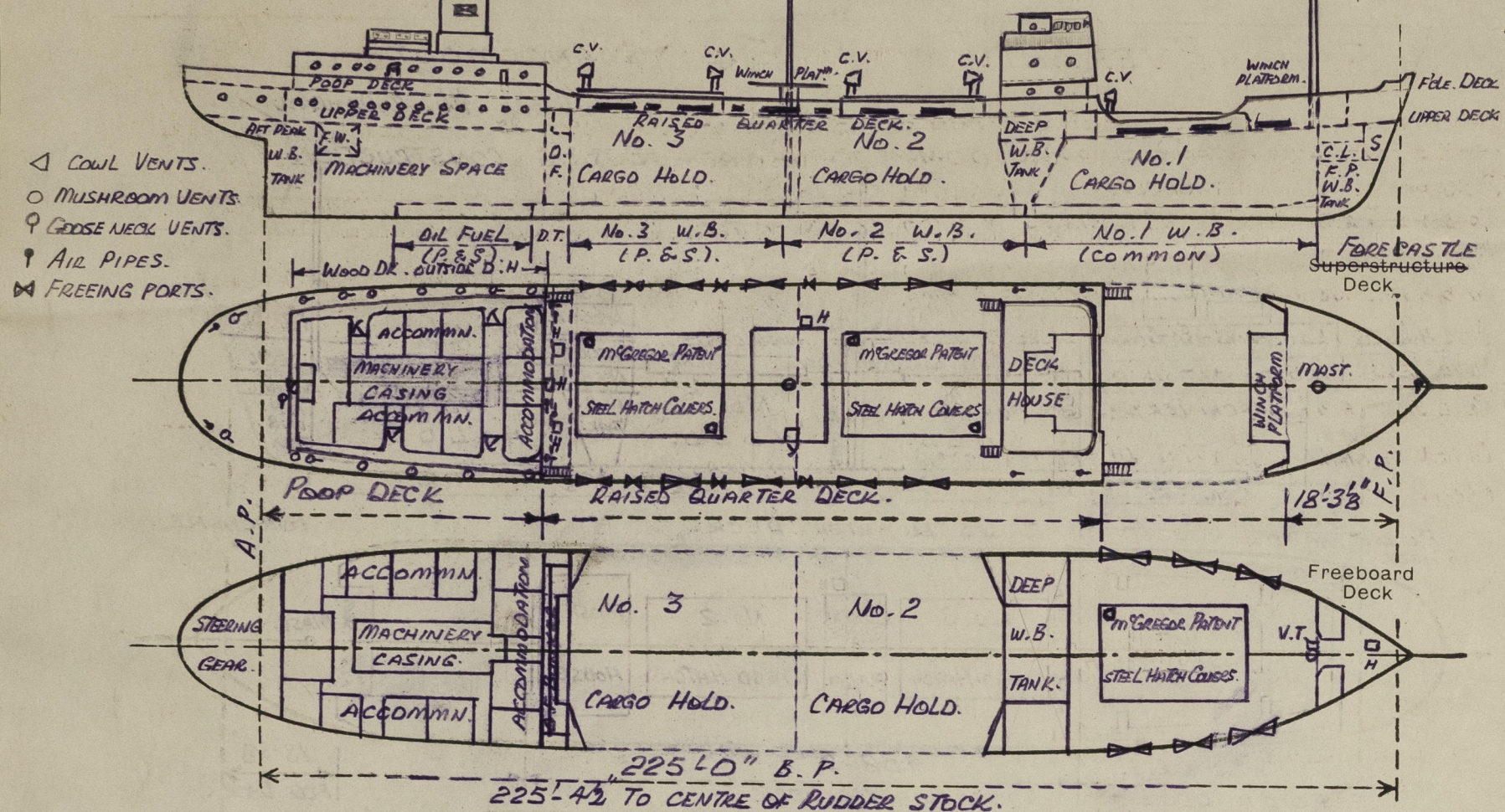

Particulars of fiddle, funnel and ventilator coamings, engine room skylight and other openings in machinery casing tops and their means of closing :-

ENGINE ROOM SKYLIGHT, FUNNEL & VENT COAMINGS, STRONGLY CONSTRUCTED OF STEEL.

Particulars of Flush Bunker Scuttles :-

NONE.

Particulars of Companionways :-

(including those incorporated in deckhouses and masthouses)

COMPANIONWAY TO AFT TWEEN DECK ACCOMMODATION, ENCLOSED IN STRONGLY CONSTRUCTED STEEL DECKHOUSE ON POOP DECK. 5 IN NO. 2" HINGED WOOD DOORS, OPERATED BOTH SIDES - SILLS 18" HIGH ABOVE WOOD DECK.

ACCESS TO NO. 3 HOLD - IN STRONGLY CONSTRUCTED STEEL COMPANIONWAY WITHIN WINCH HOUSE ON RAISED QUARTER DECK (S.S.) OPENING 7'4" x 2'0" - SILL 18" HIGH. HINGED STEEL W.T. DOOR, OPERATED BOTH SIDES - 6 IN NO. TEGGLES, HASP & PADLOCK.

Particulars of Ventilators in exposed positions on freeboard and superstructure decks :-

UPPER DECK.

1 - 14" DIAM. COWL VENT. COAMING 15" HIGH x 36" THICK x 1 - 22" x 12" TRUNK, LED TO FLE., COVERED WITH WIRE GAUZE & PORTABLE FLAP. TRUNK PLATING .40" THICK.

RAISED QUARTER DECK.

4 - 14" DIAM. COWL VENTS COAMING 15" HIGH x 36" THICK x 1 - 9" DIAM. COWL VENT. COAMING 30" HIGH x 32" THICK.

WINCH PLATFORM AFT.

2 - 5" DIAM. G.N.V. - 30" HIGH.

POOP DECK.

5 - 5" DIAM. G.N.V. - 18" HIGH. 9 - 5" DIAM. MUSHROOM VENTS, 12" HIGH.

MUSHROOM VENTS FITTED WITH SCREW DOWN TOPS, CAPABLE OF BEING CLOSED WATER TIGHT.

REMAINDER OF VENTS PROVIDED WITH WOOD PLUGS AND CANVAS COVERS.

VENTS MARKED THUS ARE SITUATED ON HATCH COVERS.

Particulars of Air Pipes in exposed positions on freeboard, raised quarter, or superstructure decks :-

FORECASTLE DECK.

1 - 5" DIAM. x 36" HIGH.

UPPER DECK.

2 - 4" DIAM. x 36" HIGH.

1 - 4" DIAM. x 36" HIGH.

* OIL FUEL AIR PIPES MARKED THUS ARE PROVIDED WITH GAUZE & CANVAS COVERS.

REMAINDER PROVIDED WITH WOOD PLUGS.

RAISED QUARTER DECK.

2 - 4" DIAM. x 30" HIGH.

2 - 4" DIAM. x 30" HIGH.

4 - 5" DIAM. x 30" HIGH.

4 - 2" DIAM. x 30" HIGH.

* 2 - 4" DIAM. CARRIED ABOVE POOP / DECK LEVEL & ADEQUATELY SUPPORTED.

POOP DECK.

* 2 - 4" DIAM. x 18" HIGH.

2 - 3" DIAM. x 18" HIGH.

1 - 2" DIAM. x 18" HIGH.

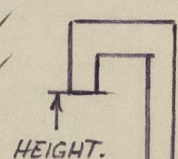

Particulars of Gangway Cargo and Coaling Ports :-

NONE.

Fred Everard.

Particulars of Scuppers and Sanitary Discharge Pipes :-

DISCHARGES FROM W.C.S. SITUATED WITHIN BRIDGE HOUSE, LED OVERBOARD BELOW RAISED QUARTER DECK LEVEL & FITTED WITH AUTOMATIC NON-RETURN VALVE AT SHIP'S SIDE & BRASS SEATED VALVE AT W.C.S.

DISCHARGES FROM WASHBASINS, SINKS & SCUPPERS, SITUATED WITHIN BRIDGE HOUSE, LED OVERBOARD BELOW RAISED QUARTER DECK LEVEL & FITTED WITH AUTOMATIC NON-RETURN VALVE AT SHIP'S SIDE.

DISCHARGES FROM W.C.S. SITUATED WITHIN POOP HOUSE, LED OVERBOARD BELOW POOP DECK LEVEL & FITTED WITH AUTOMATIC NON-RETURN AT SHIP'S SIDE & BRASS SEATED VALVE AT W.C.S.

DISCHARGES FROM WASHBASINS, SINKS & SCUPPERS SITUATED WITHIN POOP HOUSE, LED OVERBOARD, BELOW POOP DECK LEVEL & FITTED WITH AUTOMATIC NON RETURN VALVES AT SHIP'S SIDE.

COLD STORES IN TWEEN DECKS AFT DRAINED BY MEANS OF TRAPPED SCUPPER LED TO ENGINE ROOM BILGES.

UPPER & RAISED QUARTER DECKS (EXPOSED) DRAINED BY MEANS OF OPENINGS IN DECK STRINGER BARS, (COMPENSATION PROVIDED).

Particulars of Side Scuttles and Deadlights :-

AFT TWEEN DECK ACCOMMODATION FITTED WITH 10" DIAM. SIDE LIGHTS, RECESSED IN TUBES, EACH FITTED WITH DEADLIGHT.

10" DIAM. SIDE LIGHTS FITTED IN POOP FRONT & EACH FITTED WITH DEADLIGHT.

Vertical distance of Sill of lowest Side Scuttle above top of keel

21'6"

Distance from amidships to centre of lowest Side Scuttle

Particulars of Guard Rails and Bulwarks :-

FORECASTLE DECK :- 3 HANDRAILS, WITH STANCHIONS, 3'0" HIGH, SPACED 4'0" APART.

BULWARK IN WAY OF UPPER DECK :- 3'6" HIGH x 32" THICK WITH 7'3" x 30" B.A. RAIL BAR & 7'x 40" B.P. STAYS, SPACED 5'4" APART.

BULWARK IN WAY OF R.O.D. :- 3'3" HIGH x 32" THICK WITH 7'3" x 30" B.A. RAIL BAR & 7'x 40" B.P. STAYS, SPACED 5'4" APART.

BULWARK IN WAY OF POOP DECK :- 3'3" HIGH x 32" THICK WITH 5'3" x 30" B.A. RAIL BAR & 6'x 40" B.P. STAYS, SPACED 5'4" APART.

Particulars of Gangways, Lifelines, etc. :-

PROVISION MADE FOR FITTING LIFELINES.

Particulars of Freeing Arrangements.

	Length of Bulwark	Height of Bulwark	Size of Freeing Ports	Number each side	Area each side	Rule area each side
After Well ...	108'0"	3'3"	7'6" x 8 1/2"	5	30.53 ft ²	21.75 ft ²
Forward Well ...	35'6"	3'6"	7'6" x 8 1/2"	3	15.94 ft ²	10.62 ft ²

State position of each freeing port ... { After Well : (AFT OF R.O.D. BND) 28'0", 45'0", 56'3", 62'0", 73'1 1/2", 78'9", 200'0" & 95'6" (F. and A. position and height above deck edge) { Forward Well : (FWD. OF R.O.D. BND) 3'6", 15'0" & 28'1 1/2"

State whether the freeing ports are fitted with shutters, bars, or rails, and give particulars of such :- OPEN SLOTS.

Additional area where sheer is less than standard.

FREEING PORT HEIGHT ABOVE R.B.D. = 4"

FREEING PORT HEIGHT ABOVE UPPER DECK = 6 1/2" IN WAY OF 6'x6" STR. ANG.

4" IN WAY OF 3 1/2'x3 1/2' STR. ANG.

PARTICULARS OF PROTECTION TO OPENINGS, ETC.

HATCHWAYS ON FREEBOARD AND SUPERSTRUCTURE DECKS.										
← UPPER DECK →					← RAISED QUARTER DECK →					
Description of Hatchway	No. 1 CARGO	W.T. HATCH TO STORE	ACCESS HATCH TO No. 1 H.D.		No. 2 CARGO	No. 3 CARGO	ACCESS HATCH TO No. 2 H.D.	W.T. HATCH TO DECK	HATCHES TO O.F. BUNKERS	
Dimensions of Hatchway	32'3" x 21'0"	2'6" x 2'0"	2'0" x 1'9"		29'0" x 23'1"	29'0" x 23'1"	1'11 1/2" x 1'9 7/8"	1'9 3/8" x 2'0"	1'9 1/2" x 2'0"	
COAMINGS	Height above Deck	6'3 3/4"	24"	24"	36"	36"	24"	24"	24"	
	Thickness	44"	30"	30"	44"	44"	30"	30"	30"	
	Stiffeners	12 x 3 1/2 x 50 B.A.			10 x 3 1/2 x 40 B.A.					
	Brackets, Stays	40 SIDES 20 ENDS								
ALL AS PER APPROVED PLAN.										
MACGREGOR'S PATENT STEEL HATCH COVERS ON UPPER AND RAISED QUARTER DECKS.										
HATCH BEAMS	Number	1	6	26' x 31"	5 WITH 1 1 WITH 2	23 1/4' x 31 5/8"	10 1/2' x 30"	7' x 50" 8' x 50" 8 1/2' x 50" 4' x 50"	8 9/16' x 3 1/8"	13 1/16' x 3 1/8"
	Spacing									
	Scantling and Sketch									
FORE AND AFTERS	Number	2	5	26' x 30"	4 WITH 1 1 WITH 2	24 3/4' x 34 1/8"	11 1/2' x 30"	8' x 50" 7' x 50" 5' x 50" 3 1/2' x 50"	9 1/16' x 3 1/8"	14 1/16' x 3 1/8"
	Spacing									
	Scantling and Sketch									
HATCH COVERS	Material	SEE	STEEL	STEEL		SEE	SEE	STEEL	STEEL	STEEL
	Thickness	ABOVE	30"	30"		ABOVE	ABOVE	30"	30"	30"
	How fitted		W.T. WITH 8 IN NO. TOGGLES	W.T. WITH 6 IN NO. TOGGLES				WATER TIGHT WITH NO. TOGGLES.		
Spacing of Cleats		39' APART				42" APART ON SIDES & ENDS.				
	Number of Tarpaulins		ON SIDES & ENDS.							
CROSS JOINT WEDGES SPACED NOT MORE THAN 4'0" APART.										
BRACKETS } SIDES 3 IN NO NOT 20 HATCHES } ENDS 2 IN NO										
*Are wood fore and afters steel shod at all bearing surfaces? Are battens and wedges efficient and in good condition? Are tarpaulins in good condition and in accordance with rule requirements? Are lashings provided in accordance with rule requirements? Are wood covers fitted with galvanised end bands?										

Particulars of any special features:— (Timber Deck-cargo Fittings, Skylights, Sewage Systems, Ash Ejectors, Rubbish Shoots, etc.)

TIMBER DECK CARGO.

CENTRE GIRDER WATERTIGHT FOR 1/2 LENGTH AMIDSHIPS.

AUXILIARY STEERING GEAR FITTED.

EYEPLATES FOR LASHINGS, RIVETED TO SHEERSTRAKE SPACED NOT MORE THAN 10'0" APART AND 6'6" FROM SUPERSTRUCTURE BULKHEADS.

3 1/2" x 3 1/8" FLAT BAR SOCKETS FOR 9 IN NO. SQUARE UPRIGHTS, WELDED TO STRINGER PLATE NOT MORE THAN 10'0" APART, WITH 1" DIAM. PORTABLE SOCKETS OVER, SLOTTED INTO BULWARK.

LASHINGS AND STRETCHING SCREWS, ETC., PROVIDED BY OWNERS.



© 2020

Lloyd's Register
Foundation