

Lloyd's Register of Shipping.

SURVEYS FOR FREEBOARD.

(CONDITIONS OF ASSIGNMENT.)

DEC -8 '38

GRK. REPORT N° 20664

Ship's Name **SAN ELISEO.**Port of Survey **GREENOCK.**Official Number **167176.**Surveyor's Signature *Kenneth Inglis*Nationality and Port of Registry **BRITISH, LONDON.**Date of Survey **While BUILDING (1938).**

Disposition and dimensions of superstructures, trunks, deckhouses and machinery casings to be inserted in the diagrams and tabular statement:—

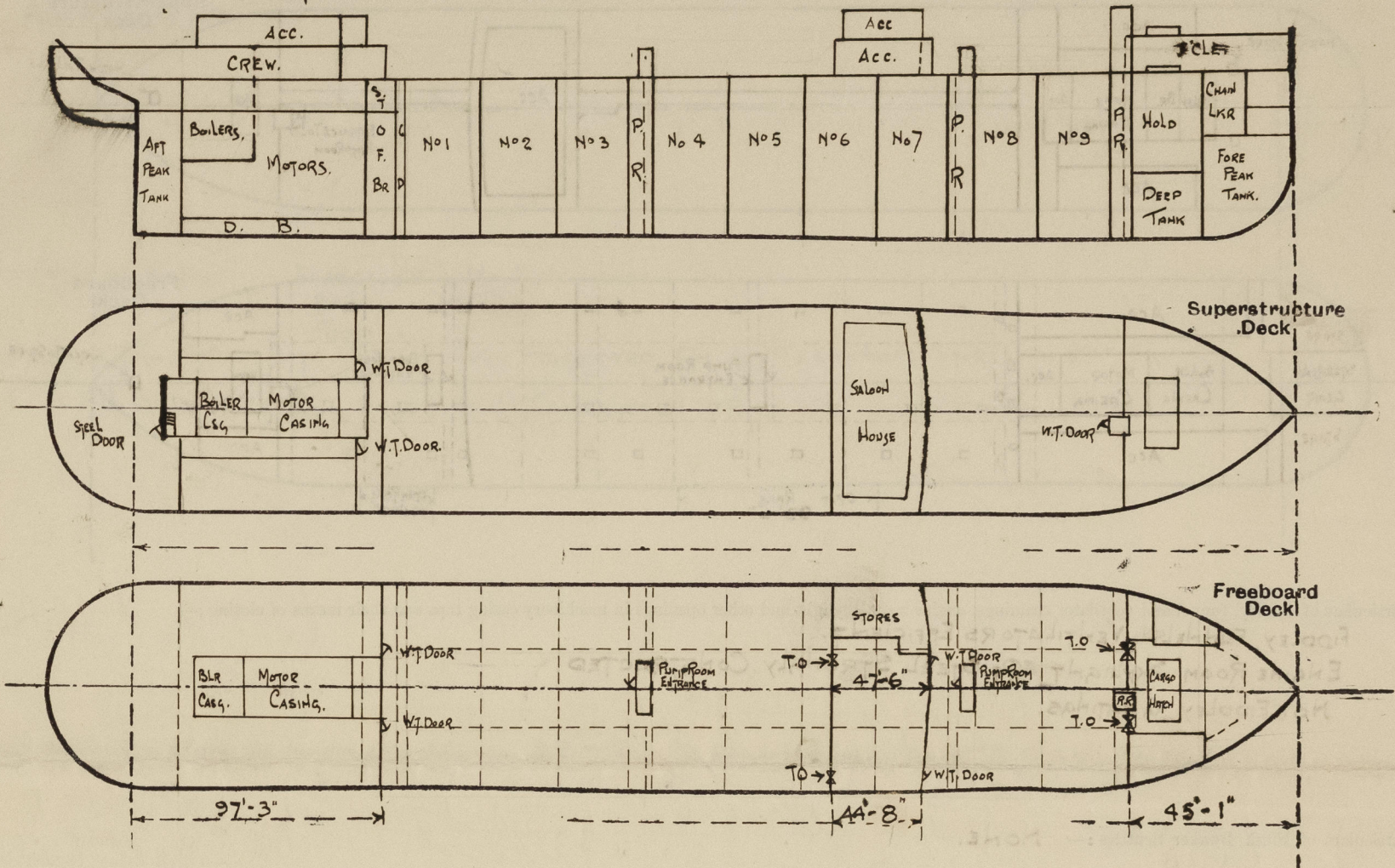

Particulars of Superstructures, Trunks, Casings, Deckhouses.

	Coaming	Plating	Stiffeners	Spacing	End Attachments of Stiffeners	Size of Openings	Height of Sills	Height of Casings
Poop Bulkhead44	.44	10 x 3 1/2 x .50 BA @ 33	30 1/2	WELDED	5'-3" P+S	18	7'-6"
Raised Quarter Deck Bulkhead ...								
Bridge, After Bulkhead34	.34	4 x 3 x .32 OA.	36"	Bcgs At Top.	5'-1" x 3'-1" P+S	18	7'-6"
Bridge, Forward Bulkhead48	.48	9 x 3 1/2 x .48 BA.	36"	Bcgs To Longs At Top. WELDED Bcgs At Bottom	5' x 3' P+S	18	7'-6"
Forecastle Bulkhead30	.30	4 x 3 x .32 OA.	30"	NONE	5'-6" x 3'-1" P+S	18	7'-6"
Trunk, Aft ...								
Trunk, Forward ...								
Exposed Machinery Casings on Freeboard or Raised Quarter Decks ...								
Exposed Machinery Casings on Superstructure Decks34	.32	3 x 3 x .30 ANG.	30"	Bcgs At Top.	5'-0" x 25" P+S	18	7'-6"
Machinery Casings within Superstructures not fitted with Class I Closing Appliances ...								
PUMP ROOM ENTRANCES FOR AFT								
Deckhouses on Flush Deck Ships40	.35	6 x 3 x .50 B.A.	36"	Bcgs & Lugs	4'-6" x 2'-3"	18"	6'-6"

Particulars of Closing Appliances (state if capable of being manipulated from both sides).

Poop Bulkhead ...	TWO STEEL WATERTIGHT DOORS WORKABLE FROM BOTH SIDES. ✓
Raised Quarter Deck Bulkhead ...	
Bridge, After Bulkhead ...	TWO TONNAGE OPENINGS WITH STEEL PLATES & HOOK BOLTS SPACED 15" APART. ✓
Bridge, Forward Bulkhead ...	TWO STEEL HINGED WATERTIGHT DOORS WORKABLE FROM BOTH SIDES. ✓
Forecastle Bulkhead ...	TWO TONNAGE OPENINGS FITTED WITH 3" SHIFTING BOARDS FULL HEIGHT. ✓
Exposed Machinery Casings on Freeboard or Raised Quarter Decks ...	HINGED STEEL CASING. DOORS WORKABLE FROM BOTH SIDES. ✓
Exposed Machinery Casings on Superstructure Decks ...	
Machinery Casings within Superstructures not fitted with Class I Closing Appliances ...	
PUMP ROOM ENTRANCES	
Deckhouses on Flush Deck Ships ...	HINGED STEEL WATERTIGHT DOOR AT EACH PUMP ROOM WORKABLE FROM BOTH SIDES. ✓

PARTICULARS OF PROTECTION TO OPENINGS, ETC.

The following diagrams should be used to indicate the positions of cargo and coaling hatchways, gangway, cargo and coaling ports, ventilators, companionways, etc., which would affect the seaworthiness of the ship :-

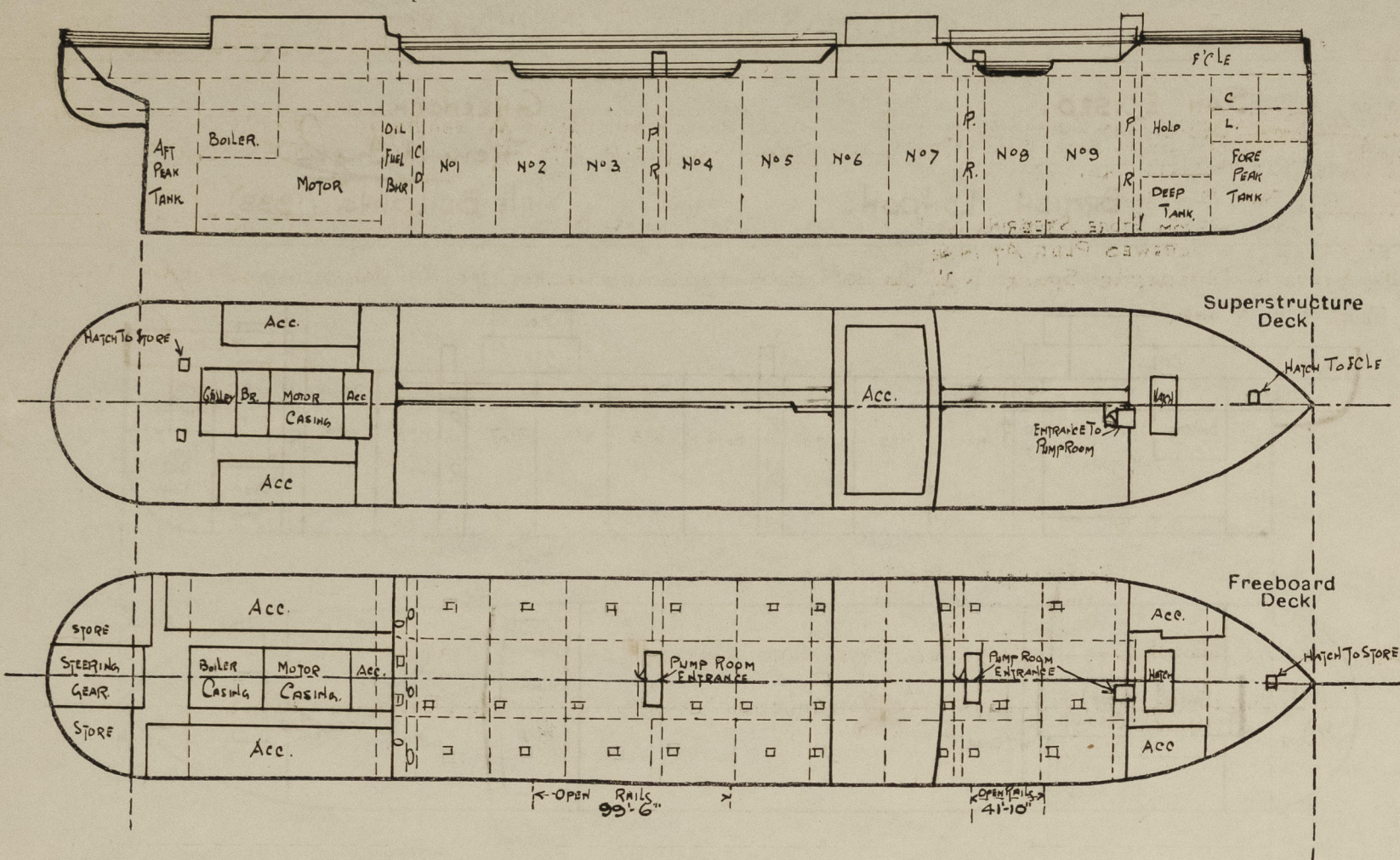

Particulars of fiddle, funnel and ventilator coamings, engine room skylight and other openings in machinery casing tops and their means of closing :-

FIDDLE, FUNNEL VENTILATORS EFFICIENT.
ENGINE ROOM SKYLIGHT OF STEEL, STRONGLY CONSTRUCTED.
NO FIDDLE GRATINGS.

Particulars of Flush Bunker Scuttles :- NONE.

Particulars of Companionways :- PUMP ROOM ENTRANCES : FORE AFT : DECK OPENINGS ENCLOSED BY STEEL HOUSES WITH HINGED STEEL WATERTIGHT DOORS AT AFTER END. DOORS WORKABLE FROM BOTH SIDES WITH SILLS 18" HIGH.
PUMP ROOM ENTRANCE TO FORE PUMP ROOM IN COFFERDAM FORWARD : HINGED STEEL WATERTIGHT DOOR FITTED AT LEVEL OF GANGWAY
TO 32 TRUNK : DOOR WORKABLE FROM BOTH SIDES. TRUNK SIDES 32 STIFFENED WITH 4x3x32 ANGLES SPACED 30" APART.

Particulars of Ventilators in exposed positions on freeboard and superstructure decks :-

FORECASTLE DECK
1. VENT 9" DIA TO STORE COAMING 36" x 32.
4 " 12" " " HOLD 36" x 34.
4 " 12" " " PUMP ROOM 30" x 30 ON TOP OF COMPANION.
UPPER DECK
2 VENTS 12" DIA TO FORWARD PUMP ROOM. COAMING 7' 6" x 34.*
4 " 18" " " PUMP ROOMS 7' 6" x 40.*
4 DERRICK POST VENTS 18" DIA TO COFFERDAMS 20' 0" x 40.*
AT SIDES OF PUMP ROOMS.
POOP DECK
2 VENTS 12" DIA TO ALLEYWAY. COAMING 30" x 34.
1 " 12" " " REFRIG. MACH. ROOM 30" x 34.
2 " 12" " " PASSAGE 7' 6" x 34.*
2 " 12" " " STEERING GEAR 30" x 34.
2 " 6" " " STORES 30" x 30.
8 S.N. VENTS 6" " " LAVATORIES ETC 30" HIGH.

Particulars of Air Pipes in exposed positions on freeboard, raised quarter or superstructure decks :-

FORECASTLE DECK
2-3" DIA SWAN NECK AIR PIPES TO FORE PEAK TANK - 18" HIGH.
2-4" " " " " DEEP TANK 18".
UPPER DECK
2-2" DIA S.N. AIR PIPES TO FORWARD COFFERDAM 36" HIGH.
2-2" " " " " AFT 7' 6" HIGH.
4-2" " " " " SETTLING TANK. FIXED TO POOP FRONT.
2-4" " " " " OIL FUEL BUNKER.
POOP DECK
2-3" DIA S.N. AIR PIPES TO AFTER PEAK TANK 18" HIGH.
2-4" " " " " OIL FUEL DOUBLE BOTTOM TANK.

BOAT DECK
4-2" DIA S.N. AIR PIPES TO COFFERDAMS IN D.B. - 18" HIGH.
4-3 1/2" " " " " DOUBBLE BOTTOM TANKS. - 18" "
AIR PIPES TO OIL TANKS FITTED WITH GAUZE & HINGED COVERS.
TO WATER TANKS FITTED WITH WOOD PLUGS.

Particulars of Gangway Cargo and Coaling Ports :-

NONE.

Particulars of Scuppers and Sanitary Discharge Pipes :-

SANITARY DISCHARGES :- FROM ACCOMMODATION INWAY OF POOP, POOP SIDEHUSES & SALOON HOUSE ON BRIDGE DECK CARRIED THROUGH SHIPS SIDE BELOW FREEBOARD DECK AND FITTED WITH STORM VALVES AT OUT BOARD END & BEND TRAP AT INNER END.
SCUPPERS FROM POOP SPACE
SCUPPERS FROM STORE, STEERING GEAR, PASSAGES & BATH ROOM CARRIED BELOW FREEBOARD DECK, FITTED WITH STORM VALVES & SCREWED PLUG AT INNER END.
SCUPPERS IN FORECASTLE SPACE 1-3/2" DIA & 5 BELOW FREEBOARD DECK FITTED WITH STORM VALVES & HAVING WOOD PLUG AT INNER END.

Particulars of Side Scuttles :-

FORECASTLE - NO SIDELIGHTS
BRIDGE - 10" DIA
POOP - 12" "

ALSO 10" DIA SIDELIGHTS FITTED UNDER FREEBOARD DECK AFT TO ENGINEERS STORES ON 2ND DK.
ALL SIDELIGHTS OF SUBSTANTIAL CONSTRUCTION & FITTED WITH HINGED DEADLIGHTS & PLUGS.

Vertical distance of Sill of lowest Side Scuttle above top of keel 33'-2" (TO ENGINEERS STORES ON 2ND DK INWAY OF ENGINE ROOM)

Particulars of Guard Rails :-

POOP, BRIDGE & FORECASTLE
3 RAILS 3'-6" HIGH WITH STANCHIONS 4'-6" APART.
OPEN RAILS AT UPPER DK (LENGTH AS BELOW) 4 RAIL STANCHIONS 3'-6" HIGH 5'-0" APART.
LENGTH OF RAILS IN AFT WELL = 99'-6"
" " " " FOR " = 41'-10"

Particulars of Lifelines, etc. :-

EFFICIENT GANGWAY FITTED FROM POOP TO BRIDGE & FROM BRIDGE TO FORECASTLE.
FORE AFT PLATFORM ANGLE 6x3x3x40 CHANNEL.
SUPPORT ANGLE 4x4x40 SPACED 8' 3" APART.
CROSS TIE ANGLE 3x3x40.
R/A BRACING ANGLE 3x3x30.
PLATFORM 5x3 O.P. SPACED 1' APART.

Particulars of Freeing Arrangements.						
	Length of Well	Height of Bulwark	Size of Freeing Ports	Number each side	Area each side	Rule area each side
After Well	184'-10"	3'-6"	3'-6" x 9"	4	99.50 ft. rails 10.5 ft. ports	92.42 ft. rails
Forward Well	88'-2"	3'-6"	3'-6" x 1'-3"	1	41.84 ft. rails 4.37 ft. ports	41.84 ft. rails 3.93 ft. ports

State position of each freeing port ... (After Well : 6' 23" FROM BRIDGE POOP FRONT 12" ABOVE DK
(F. and A. position and height above deck edge) Forward Well :)

State whether the freeing ports are fitted with shutters, bars, or rails, and give particulars of such :- ONE RAIL ON 1'-3" S.P.

Additional area where sheer is less than standard.

PARTICULARS OF PROTECTION TO OPENINGS, ETC.

HATCHWAYS ON FREEBOARD AND SUPERSTRUCTURE DECKS.									
Description of Hatchway
Dimensions of Hatchway
COAMINGS	Height above Deck
	Thickness
	Stiffeners
	Brackets, Stays
HATCH BEAMS	Number
	Spacing
FORE AND AFTERS	Number
	Spacing
HATCH COVERS	Material
	Thickness
Spacing of Cleats
Number of Tarpaulins
*Are wood fore and afters steel shod at all bearing surfaces ? ✓									
Are battens and wedges efficient and in good condition ? ✓									
Are tarpaulins in good condition and in accordance with rule requirements ? ✓									
Are lashings provided in accordance with rule requirements ? ✓									

Particulars of any special features :—

Endorsement at first survey and at surveys for renewal of Certificate :—

The fittings and appliances are in accordance with the particulars shown on this form (or as now modified) and are in good condition.



© 2021

Lloyd's Register Foundation