

Lloyd's Register of Shipping.  
SURVEYS FOR FREEBOARD.  
(CONDITIONS OF ASSIGNMENT.)

No. 18208

Ship's Name "EMPIRE MARLOWE".

Port of Survey West Hartlepool.

Official Number 168933

Surveyor's Signature J. J. Craig

Nationality and Port of Registry British, West Hartlepool

Date of Survey Nov 1941 whilst building.

Disposition and dimensions of superstructures, trunks, deckhouses and machinery casings to be inserted in the diagrams and tabular statement : --

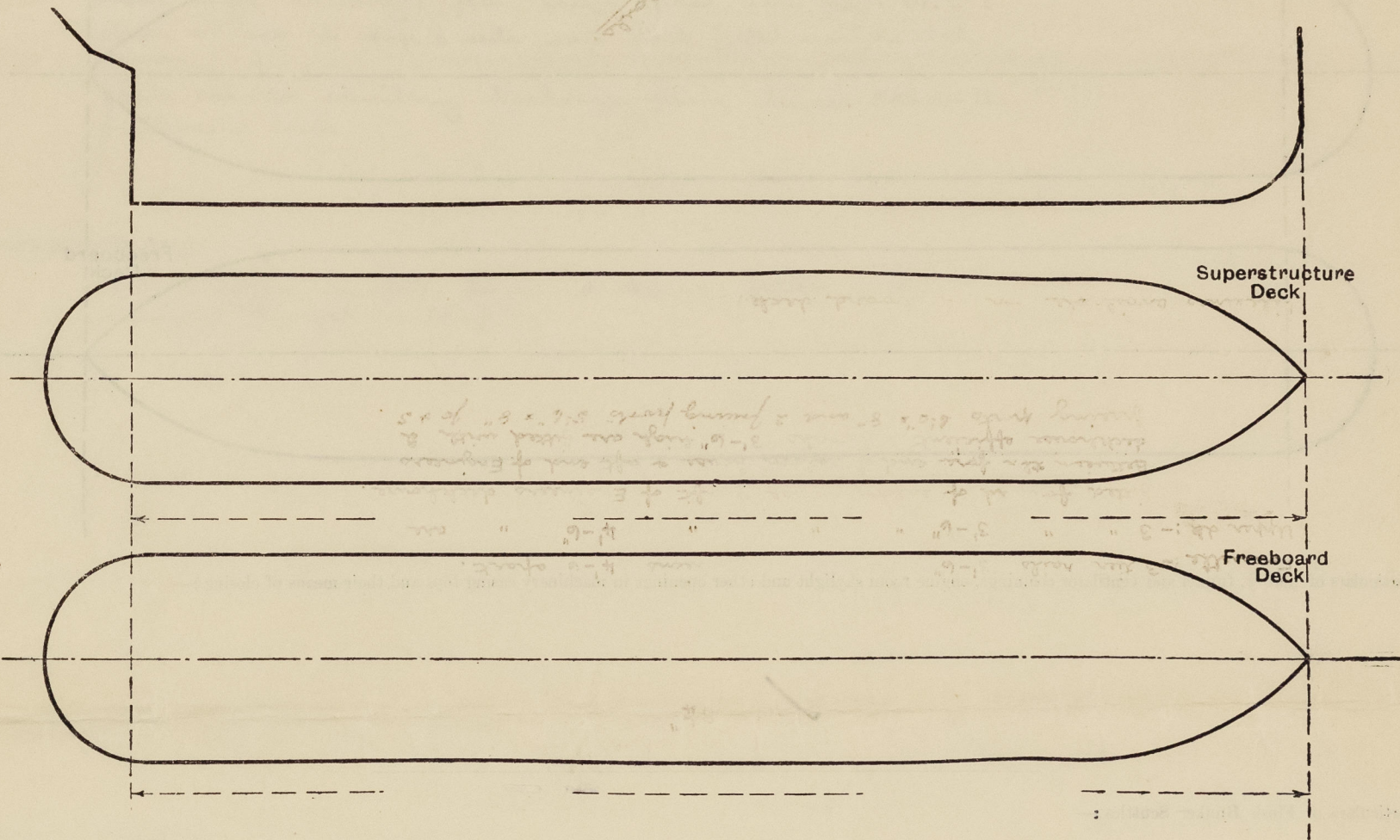

Particulars of Superstructures, Trunks, Casings, Deckhouses.

	Coaming	Plating	Stiffeners	Spacing	End Attachments of Stiffeners	Size of Openings	Height of Sills	Height of Casings
Poop Bulkhead (between decks)		26 4/30	5 x 3 x 5/16	30"	none	none	none	8' aft of chd. 11'-2" fwd of chd.
Raised Quarter Deck Bulkhead ...				✓				
Bridge, After Bulkhead ...			not fitted - no tonnage space.					
Bridge, Forward Bulkhead ...				✓				
Forecastle Bulkhead ...				✓				
Trunk, Aft ...				✓				
Trunk, Forward ...				✓				
Exposed Machinery Casings on Freeboard or Raised Quarter Decks ...				✓				
Exposed Machinery Casings on Superstructure Decks ...				✓				
Machinery Casings within Superstructures not fitted with Class I Closing Appliances on second deck.	30	26	4 x 2 1/2 x 5/16	30"	none	2 at 5' x 2'	18"	8'-6"
Deckhouses on Flush Deck Ships ...				✓				

Particulars of Closing Appliances (state if capable of being manipulated from both sides).

Poop Bulkhead (between decks)	No openings
Raised Quarter Deck Bulkhead ...	✓
Bridge, After Bulkhead ...	✓
Bridge, Forward Bulkhead ...	✓
Forecastle Bulkhead ...	✓
Exposed Machinery Casings on Freeboard or Raised Quarter Decks ...	✓
Exposed Machinery Casings on Superstructure Decks ...	✓
Machinery Casings within Superstructures not fitted with Class I Closing Appliances on second deck.	Hinged steel doors operated from both sides.
Deckhouses on Flush Deck Ships ...	✓



# PARTICULARS OF PROTECTION TO OPENINGS, ETC.

The following diagrams should be used to indicate the positions of cargo and coaling hatchways, gangway, cargo and coaling ports, ventilators, companionways, etc., which would affect the seaworthiness of the ship:—

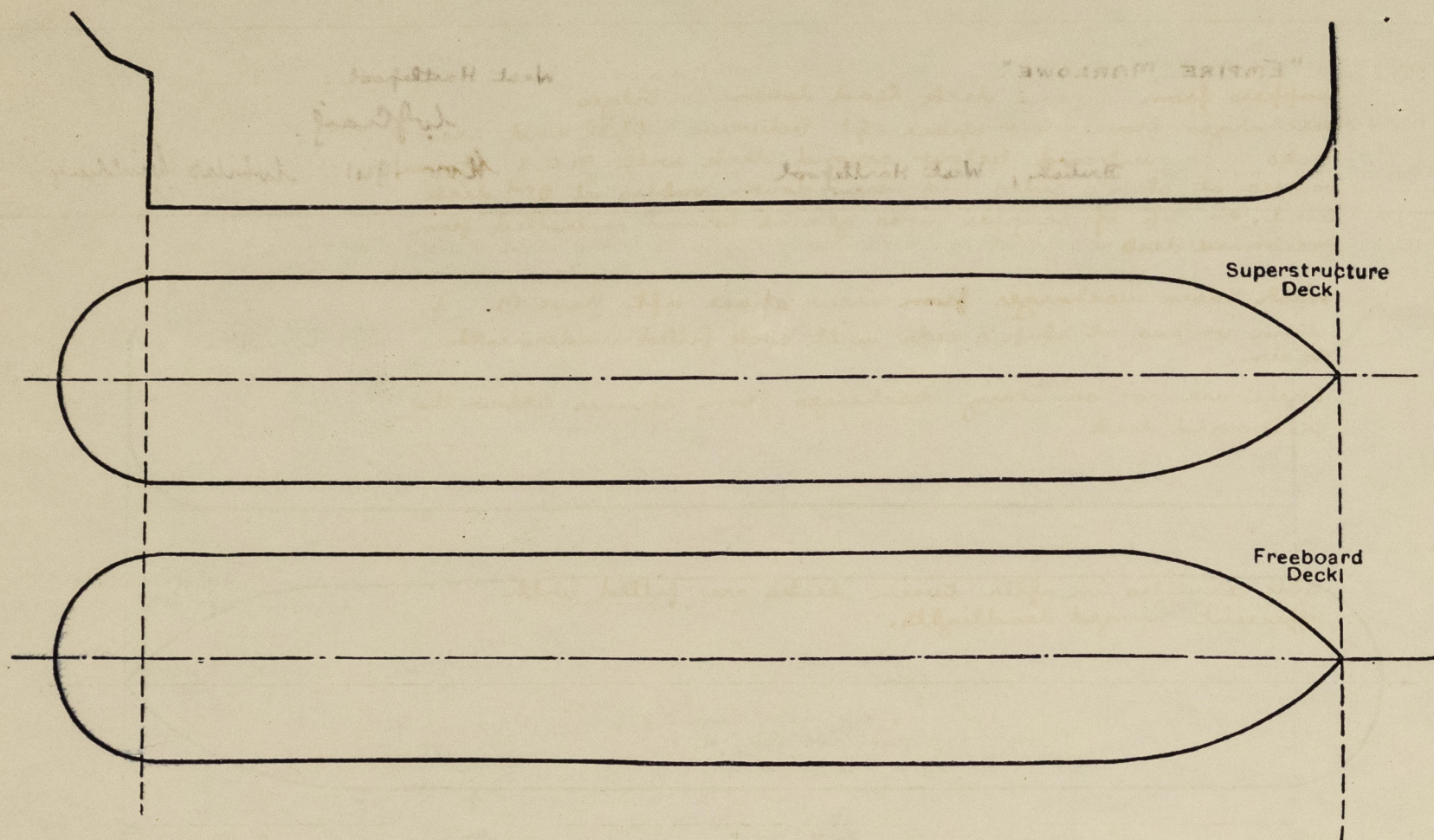

Particulars of fiddle, funnel and ventilator coamings, engine room skylight and other openings in machinery casing tops and their means of closing:—

Particulars of Flush Bunker Scuttles:—

Particulars of Companionways:— Entrances in tween decks between Nos. 1 and 2 holds and between Nos. 4 and 5 holds to holds.  
 5'-0" x 2'-0" } Hinged steel doors operated from both sides with  
 5'-0" x 1'-9" } sills 18" high.

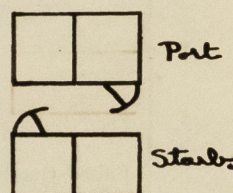

Particulars of Ventilators in exposed positions on freeboard and superstructure decks:—

Particulars of Air Pipes in exposed positions on freeboard, raised quarter, or superstructure decks:—

Particulars of Gangway Cargo and Coaling Ports:—

Particulars of Scuppers and Sanitary Discharge Pipes:—

Scuppers from second deck lead down to bilges.  
 Discharges from crew space aft between upper and second decks lead overboard below second deck with M.C.I. storm valves at ship's sides and screw down valves at 2nd deck level on top of scupper pipes geared to and controlled from freeboard deck.

Wash basin discharges from crew space aft have M.C.I. storm valves at ship's side with cock fitted underneath basin.

There are no sanitary discharges from spaces below the freeboard deck.

Particulars of Side Scuttles:—

Side scuttles in after tween decks are fitted with efficient hinged deadlights.

Vertical distance of Sill of lowest Side Scuttle above top of keel 37'-8 1/4"

Particulars of Guard Rails:—

Particulars of Gangways, Lifelines, etc.:—

Particulars of Freeing Arrangements.						
	Length of Bulwark	Height of Bulwark	Size of Freeing Ports	Number each side	Area each side	Rule area each side
After Well ... ..						
Forward Well ... ..						
State position of each freeing port ... .. { After Well:— (F. and A. position and height above deck edge) { Forward Well:—						
State whether the freeing ports are fitted with shutters, bars, or rails, and give particulars of such:—						
Additional area where sheer is less than standard.						



# PARTICULARS OF PROTECTION TO OPENINGS, ETC.

HATCHWAYS ON FREEBOARD AND SUPERSTRUCTURE DECKS. on second deck.									
Description of Hatchway	No. 1	No. 2	No. 3	No. 3A	No. 4	No. 5	Coal Hatches	Escape Hatches	
Dimensions of Hatchway	31'-6" x 22'-0"	32'-6" x 22'-0"	20'-0" x 22'-0"	14'-3" x 22'-0"	32'-6" x 22'-0"	32'-6" x 22'-0"	2'-0" x 3'-6"	2'-0" x 2'-0"	
COAMINGS			9 x 3 1/2 B.A.	7/16			9 x 3 1/2 B.A.	9 x 3 1/2 B.A.	
Height above Deck									
Thickness									
Sides									
Ends									
Stiffeners									
Brackets, Stays									
HATCH BEAMS									
Number	6	6	3	2	5	6			
Spacing	4'-6"	4'-8"	5'-0"	4'-9"	5'-5"	4'-8"			
Scantling and Sketch									
Bearing Surface	22 1/2 x 38	20 x 38	20 x 38	20 x 36	21 x 38	21 x 38			
	6 x 3 1/2 x 38 angles			double T & B					
FORE AND AFTERS									
Number	✓	✓	✓	✓	✓	✓			
Spacing									
Unsupported Lengths									
Scantling* and Sketch									
Bearing Surface									
HATCH COVERS									
Material									
Thickness									
How fitted									
Bearing Surface	3	3	3	3	3	3	3	2 3/8" hinged wood hatches secured by bolts and wing nuts and painted.	
Spacing of Cleats	24	24	24	24	24	24	24		
Number of Tarpaulins				not fitted.					
<p>*Are wood fore and afters steel shod at all bearing surfaces? <input checked="" type="checkbox"/> Yes</p> <p>Are battens and wedges efficient and in good condition? <input checked="" type="checkbox"/> None</p> <p>Are tarpaulins in good condition and in accordance with rule requirements? <input checked="" type="checkbox"/></p> <p>Are lashings provided in accordance with rule requirements? <input checked="" type="checkbox"/></p>									

Particulars of any special features:—

Endorsement at first survey and at surveys for renewal of Certificate:—

The fittings and appliances are in accordance with the particulars shown on this form (or as now modified) and are in good condition.



© 2020

Lloyd's Register Foundation