

N^{os} 191-2 SHIPS N^o 214-5 For N^o 214-5 *see*
 PROFILE & DECKS (MODIFICATIONS *also plan of Profile & Decks*
 IN WAY OF COAL BUNKER.) *as built 44.*
 SCALE: - $\frac{1}{8}$ " = 1 FOOT.

ALL BULB ANGLES ARE N.B.S.

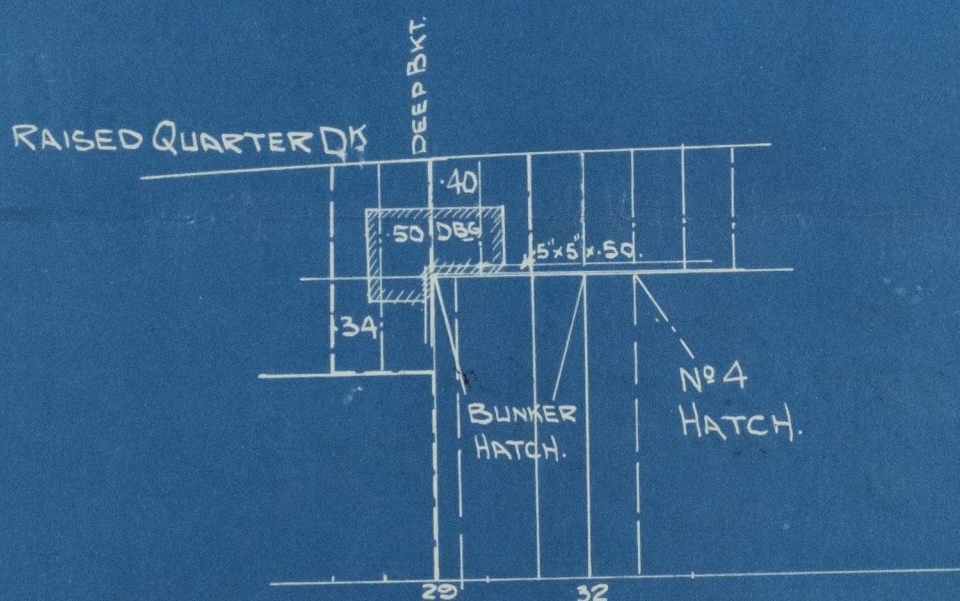
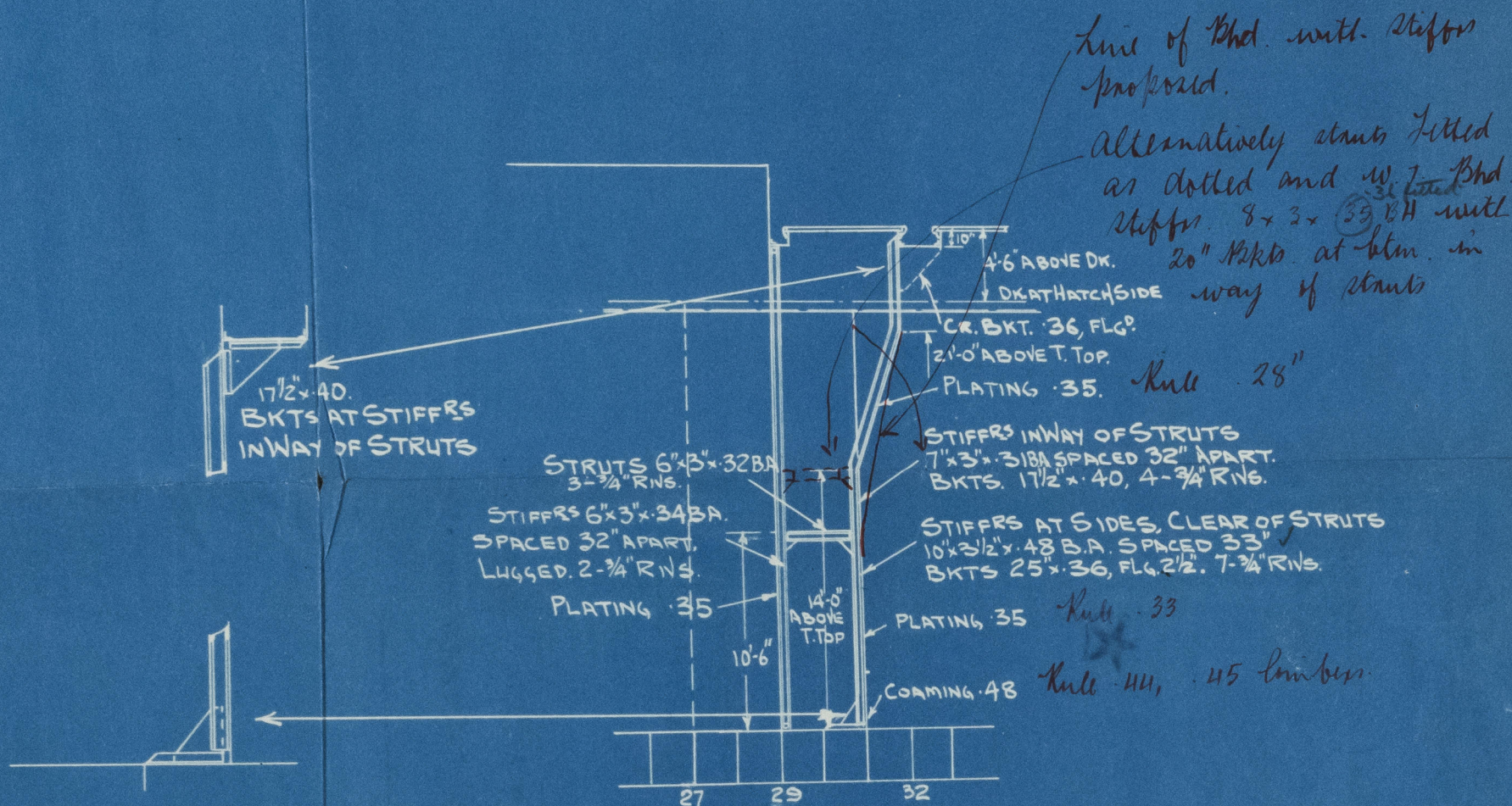

APPROVED *for 214-5*

LLOYD'S REGISTER OF SHIPPING

H. Dickerson

DATE 19/3/34

APPROVED

LLOYD'S REGISTER OF SHIPPING

H. Dickerson

DATE 7-6-35

004703-004709-0203

Foundation

BURNTISLAND SB

N^{os} 1917 2 / 214-5

Profile & Decks (modification
in way of coal bunker)
as fitted

(3)

WHITFLEET

ss "Corbrae" ★

Lth. Rpt. No. 18977.

s/s "Corburn"

Lth. Rpt. N^o 19000

s/s "Corfield"

Lth. Rpt. N^o 19369

ss "Corferry"

Lth. Rpt. No. 19441.

For N^{os} 214 & 5 see also
Plan of Profile & Decks as
built



© 2020

Lloyd's Register
Foundation

004703-004709-0203