

# REPORT ON WATER TUBE BOILERS

No. 109984

3-DEC-1952

Donkey Boilers Report

Received at London Office

When handed in at Local Office - 1 DEC 1952 19

Port of NEWCASTLE ON TYNE

Survey held at NEWCASTLE ON TYNE

Date, First Survey 27<sup>th</sup> September 1952 Last Survey 27<sup>th</sup> November 1952

On the S.S. "CALTEX LIVERPOOL" (Number of Visits 116) Gross 118.14

NEWCASTLE ON TYNE By whom built R. W. HAWTHORN LESLIE & CO. LD Yard No. 706 Tons Net 6886

Do " Do By whom made Do " Do " Engine No. A090 When built 1952

Do " Do By whom made Do " Do " Boiler No. A090 When made 1952

Power 1,640 (MAX) 1,460 (SERV) Owners OVERSEAS TANKSHIP (U.K.) LD. Port belonging to LONDON

TUBE BOILERS—MAIN, AUXILIARY, OR DONKEY.—Manufacturers of Steel SEE GLASGOW CERT N° 94697

Approval of plan DRUMS: 7.8/5/51 (GLS) SUPRTS: 1-10-51. TUBES: 10/5/49.

TWO - YARROW TYPE W/T. V Working Pressure 480 LBS Tested by Hydraulic Pressure to 770 LBS Date of Test SEE GLS CERT

(GLS) 94697 Can each boiler be worked separately YES. Total Heating Surface of Boilers 6,700 (INCL SUPRTS)

Are they fitted with easing gear YES. Area of Fire Grate (coal) in each Boiler 6700 x 2 - Caltex Manufactured

of burners (oil) in each boiler THREE - TODD VARIABLE CAPACITY

STEAM DRUM: ONE 24" SINGLE No. and description of safety valves on

SPHTA: ONE 24" DOUBLE (IMP. H.L.) Area of each set of valves per boiler per rule 11.280"

DRUM: 480 LBS as fitted 11.930" Pressure to which they

SPHTA: 470 " Are they fitted with easing gear YES. In case of donkey boilers state whether steam from main boilers can enter

boiler. Smallest distance between boilers or uptakes and bunkers or woodwork 32'-0" Height of boiler 16'-4"

length 16'-10 1/4" x 16'-7 3/4" Steam Drums: Number in each boiler ONE Inside diameter 4'-2"

WRAPPER 1" TUBE PLATE 2 3/32 Range of tensile strength 28 - 32 T.P.I. Are drum shell plates welded

WELDED. If fusion welded, state name of welding firm JOHN BROWN & CO. LD. Have all the requirements of the Rules

vessels been complied with Description of riveting: Circ. seams long seams

rivet holes in long seams Please see GLASGOW CERT. N° 94697 Thickness of straps Percentage strength of

Plate Rivet Diameter of tube holes in drum Pitch of tube holes

length of shell in way of tubes Steam Drum Heads or Ends: Range of tensile strength 26 - 30 T.P.I.

of plates 2" Radius or how stayed 3'-6" Size of manhole or handhole 16" x 12" Water Drums: Number

Two Inside diameter 2'-3" Thickness of plates 5/8" AND 1/2" Range of tensile strength 28 - 32 Are drum shell plates

flanged WELDED. If fusion welded, state name of welding firm JOHN BROWN & CO. LD. Have all the requirements of the Rules

vessels been complied with Description of riveting: Circ. seams long seams

rivet holes in long seams Please see GLASGOW CERT. N° 94697 Thickness of straps 26 - 30 T.P.I.

length of long joint: Plate Rivet Diameter of tube holes in drum Pitch of tube holes

length of drum shell in way of tubes Water Drum Heads or Ends: Range of tensile strength 26 - 30 T.P.I.

plates 1 1/2" Radius or how stayed 2'-3" Size of manhole or handhole 16" x 12"

Sections: Number Material Thickness Tested by hydraulic pressure to

diameter 1 1/4" AND 1 3/4" O.D. Thickness 116" AND 167" Number 1284 x 1 1/4"; 208 x 1 1/4" Steam Dome or Collector: Description of

Inside diameter Thickness of shell plates Range of tensile

Description of longitudinal joint If fusion welded, state name of welding

Have all the requirements for the Rules for Class I vessels been complied with Diameter of rivet holes

Thickness of straps Percentage strength of long joint plate rivet

End Plates: Range of tensile strength Thickness Radius or how stayed

HEATER, Drums or Headers: Number in each boiler Two Inside diameter 6" sq.

Material S.D. St. Range of tensile strength 28 - 32 T.P.I. Are drum shell plates welded

If fusion welded, state name of welding firm THE SUPERHEATER CO. LD. Have all the requirements of the Rules

vessels been complied with Description of riveting: Circ. seams long seams

rivet holes in long seams Please see MANCHESTER CERT. N° 560 Thickness of straps Percentage strength of

Plate Rivet Diameter of tube holes in drum Pitch of tube holes

in way of tubes Drum Heads or Ends: Thickness 1 1/4" Flat Range of tensile strength 28 - 32 T.P.I.

how stayed SWAGED & WELDED. Size of manhole or handhole Number, diameter, and thickness of tubes 44 - 1 1/4" x 10W.G.

hydraulic pressure to HEADERS 770. Date of test AS PER MAN. CERT. Is a safety valve fitted to each section of the superheater which

t off from the boiler No. and description of safety valves Area of each set

Pressure to which they are adjusted Is easing gear fitted

Has the spare gear required by the Rules been supplied YES.

FOR R. & W. HAWTHORN LESLIE & CO. LIMITED Manufacturer.

During progress of work in shops Is the approved plan of boiler forwarded herewith

During erection on board vessel Phase see Ppt 4a Total No. of visits

or a duplicate of a previous case No. If so, state vessel's name and report No.

AL REMARKS (State quality of workmanship, opinions as to class, &c. These boilers have been constructed

installed under Special Survey in accordance with Approved Plans and

my's letters. The safety valves have been adjusted under steam, accumulation

carried out and the boilers examined under full working conditions

satisfactory results. The materials and workmanship are good.

When applied for 19

When received 19

SELLING EXPENSES (if any) £

ate FRI 9 JAN 1953 Engineer Surveyor to Lloyd's Register of Shipping

See F.E. mch. apt.

004693-004697-0224 1/2



# "S. S. CALTEX LIVERPOOL"

## ARRANGEMENT OF AUXILIARIES

### BOTTOM PLATFORM

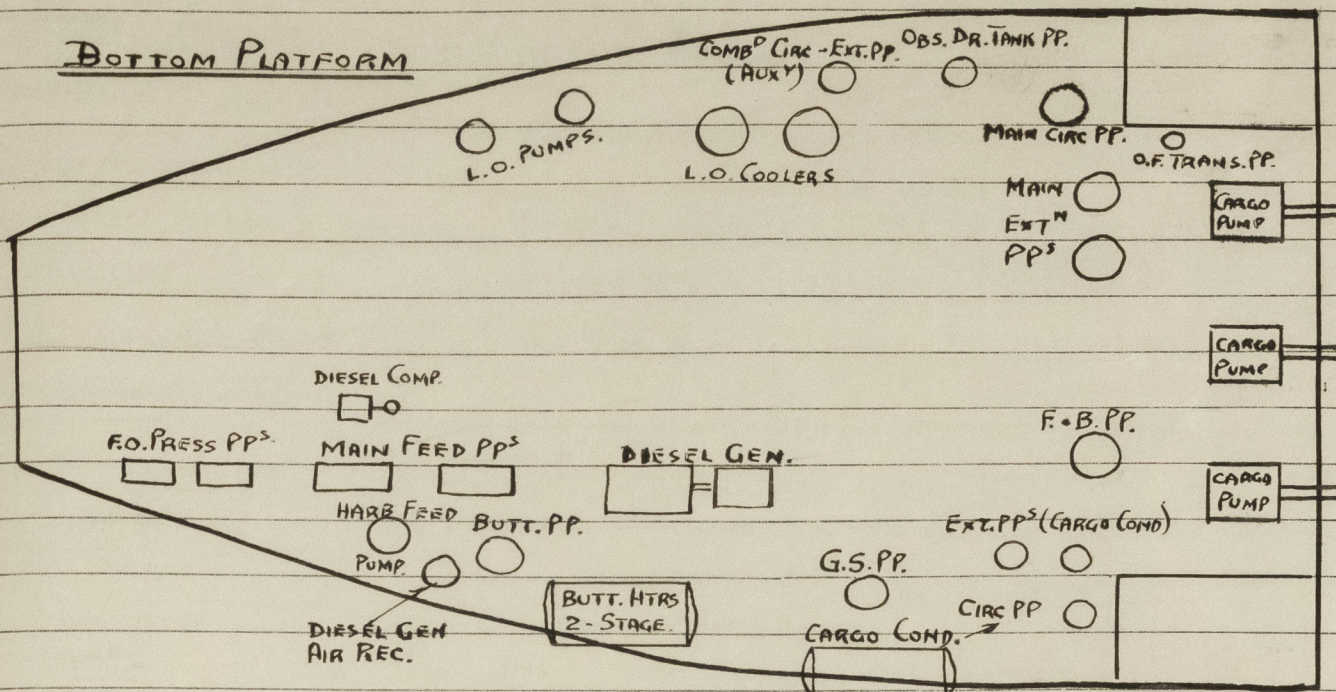

### E.R. & BOILER FLATS

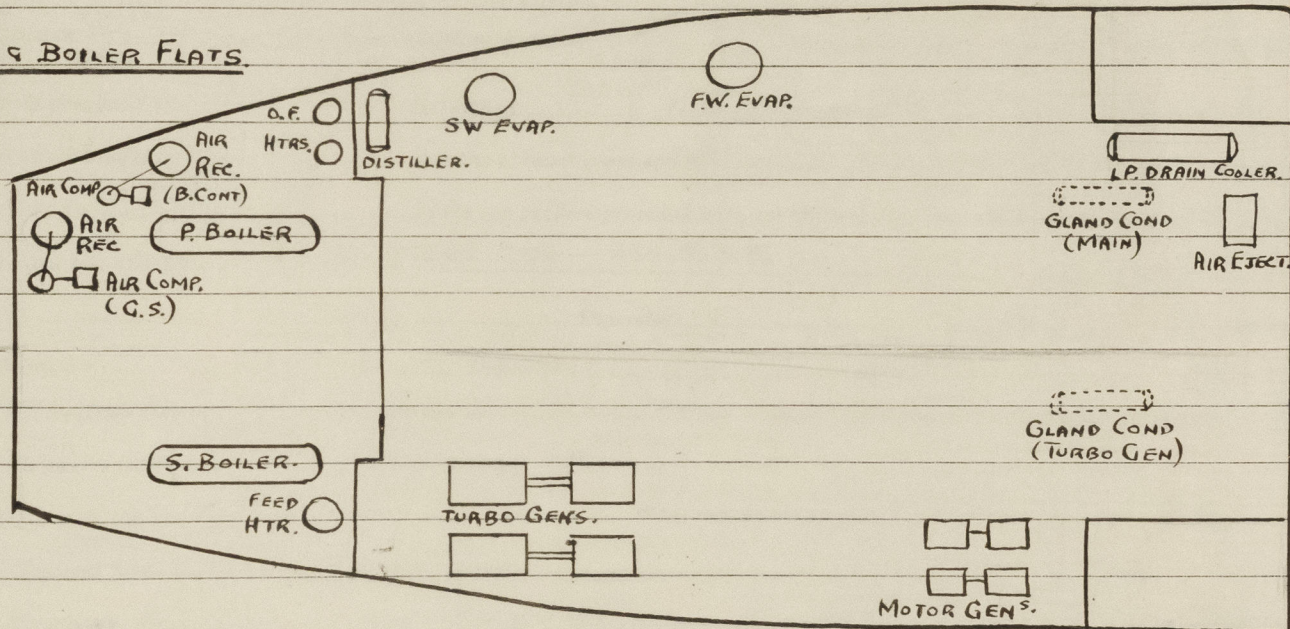

T. Sm.

SURVEYOR TO LLOYD'S REGISTER,  
NEWCASTLE-ON-TYNE.