

# WEYBURN

## HATCHWAYS

Nº 1 UPPER DECK	48.00 x 18.00 x 2.06
Nº 2 UPPER DECK	8.00 x 28.00 x 2.07
Nº 3 UPPER DECK	8.00 x 28.00 x 2.07

## SMALL HATCHES IN WINDLASS SPACE

TO FOREPEAK SPACE	1 AT 2.42 x 1.82 x 2.02
TO TWEEN DECK FORWARD	1 AT 1.68 x 2.05 x 2.03

## ERECTION

DECKHOUSE AT FORWARD END OF BUNKER ON UPPER DECK

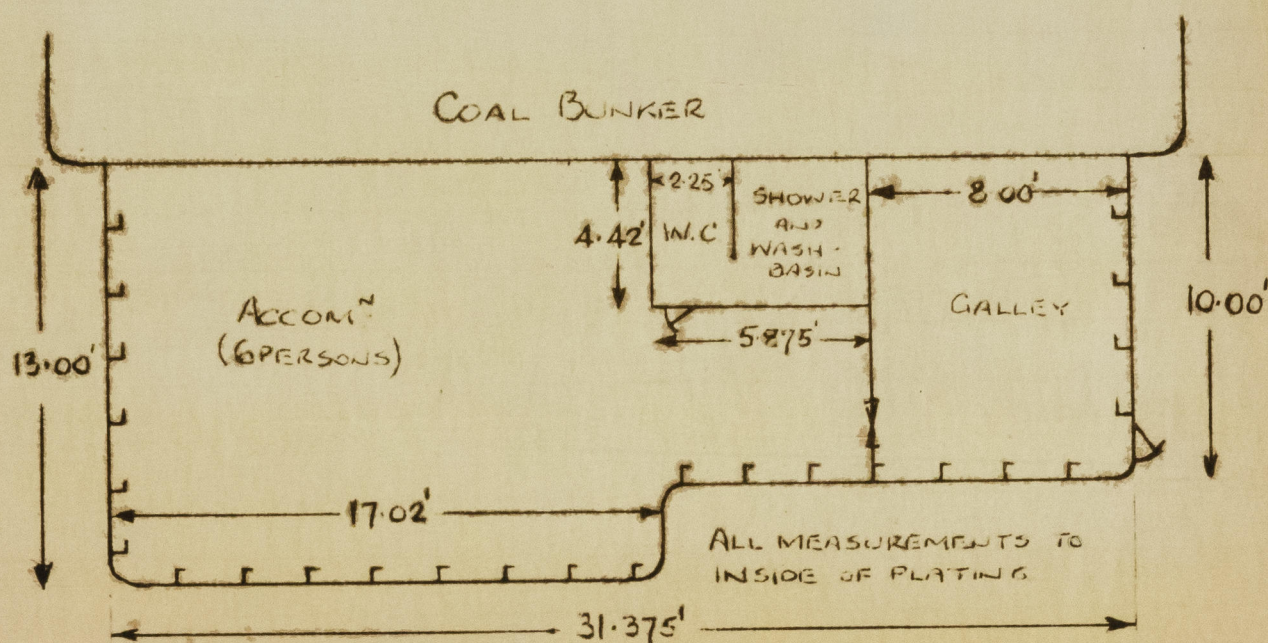

PLATING : FRONT  $\frac{5}{16}$ " SIDES  $\frac{1}{4}$ "

STIFFENERS : FRONT  $4" \times 4" \times \frac{1}{2}$  I.O.A. SIDES  $4" \times 3" \times \frac{1}{2}$  I.O.A.

ALL SPACED 24" WELDED TOP & BOTTOM

HOUSE TOP PLATING  $\frac{1}{4}$ " BEAMS TRANSVERSE  $8" \times 4" \times \frac{1}{2}$  I.O.A.

SPACED 24", CAMBER SIMILAR TO UPPER DECK

HEIGHT 7.49' FROM TOP OF UPPER DECK BEAM TO UNDERSIDE OF HOUSE TOP PLATING.

<b>WEYBURN</b>	
COMPANY <i>MTL</i>	Rpt. No <i>15811</i>
Dated <i>10-11-63</i>	
CT:-	

*W. Neatlie*

*October 25<sup>th</sup> 1963*



Lloyd's Register  
Foundation