

Rpt. 8

Date of writing Report 15.3.61.

When handed in at Local Office

Port SOUTHAMPTON

No. 26693

Survey held at MARCHWOOD.

No. of Visits 1

First Date

Received London

Last Date 28.1. 19 61.

REPORT OF SHIP SURVEYS AND REPAIRS

(The Surveyor's attention is drawn to the relevant requirements of Chapters B & C of the Rules.)

No. in R.B.

60214

S.S.

on the Iron or Steel M.S.

"ESSO GENESEE"

Built at GRANGEMOUTH.

By Whom Grangemouth Dockyard Co.

Tons gross 797

Year

Month

When 1943

4

Owners Esso Petroleum Co.

Owners' address

(If not already in R.B.)

Managers

Port of Registry

GRANGEMOUTH.

Surveyed Afloat or in Drydock Afloat.

Name of Dock

Husbands Shipyard.

Date of last examn. in Drydock

N.B.—Any alterations in existing particulars in the Register Book should be reported and underlined.

Last Report: No.

26573

Port

SOU

To be filled in at Head Office.

Particulars of Classification (which must be inserted precisely as in Register Book and Supplement)

SHIP'S CLASS		Machinery	
Date of Special and of Drydocking Surveys, etc.			
BS ⁺	Oil Tanker.	MBS E ⁺	1.57.
SS Dr.	1.57.	B ⁺	
Dkg.	2.60.	MBS	2.60.
		TS (CL)	2.60.
		SPS	1.57.

veys must be reported in the terms of the Rules. The nature and extent of Examinations (Repairs (if any) must be stated in detail, the parts examined and their condition being fully indicated. For Annual, Special or other Condition Surveys the Summary of Examination and Condition on the back of the Report is to be carefully completed and amplified if necessary in the body of the Report. Outstanding items to complete the Survey should be summarised at the end of the Report. The reasons for Repairs must be stated. Repairs on account of Damage (the alleged cause of which must be stated) should be separated in Repairs due to other causes, and, besides being detailed in the body of the Report, should be summarised in the form below. When, at a Special Survey, the Shell and Deck plating is drilled the results must be reported on Report 8(Dr). Whenever Anchors or Chain plates are replaced or retested the necessary particulars are to be given on Report 8(Eq) which is to be attached to this Report.

dates and references to any letters relating to this Report

Damage cases where the Surveyor has not made a special damage report he should state whether he offered his services for this purpose and to whom and why they were declined

Freeboard as marked on ship and now verified

ft

ins

Was a damage report made by anyone else? If so, by whom?

EXAMINATION AND REPAIRS AS PER RULE FOR LEAKAGE.

Now Done: At request of Owners' Representative examined No.3 Cargo Tank s.s. and Fore Peak Tank internally with a view to recommending repairs necessary to maintain this ship in service for a limited period.

It was subsequently decided not to carry out repairs to maintain class, and the ship was sold to Dutch interests for scrapping. It is understood cement boxes were fitted at the recommendation of M.O.T. Surveyors prior to the ship being towed to Holland.

Deadline Certificates have been withdrawn and are attached hereto.

CONTINUATION OVER/OR SHEET 2

SUMMARY OF DAMAGE REPAIRS	Shell Plates	Frames	R. Frames	Floors and Bracket Floors	Inner Bottom Plates	Deck Plates	Beams	Other Items
Renewed								
Moved and Fairied or Repaired								
Red or Repaired in place								

Survey also been held on machinery of the Ship? No.

Is the Report sent now, or when will it be sent?

Is Classification Certificate required? If so, to be sent to

No.

Has Interim Certificate been issued?

No.

GENERAL OBSERVATIONS, OPINION AND RECOMMENDATION AS TO CLASS

State clearly what alteration, if any, is suggested to be made in the existing Classification or Survey or other records of the Ship in the Register Book consequent upon this survey; for example:— "to remain as Classed in the Register Book without fresh record of Docking"; "to remain as Classed and to have record of drydocking 1,55"; or "to remain as Classed and to have record of drydocking 1,55, and the notation of S.S. . . . 1,55".

the information of the Committee.

J.L. Beasley
Surveyor to Lloyd's Register of Shipping

TUESDAY 11 APR 1961

Committee

TABLE 1

PARTS OF THE SHIP AS INDICATED BELOW HAVE BEEN EXAMINED FOR		SURVEY	
Items	Now Examined YES NO or NONE	Tanks	Now Examined Internally Now Tested
Shell plating, sternframe and rudder cleaned, examined and recoated in drydock		F.P. Tank	
Rudder lifted		A.P. "	
Weather Decks, Superstructures and Casings		D.B. Tanks (indicate Oil Fuel) and Cofferdams	
Hatchways, Covers, closing and securing appliances			
Ventilator coamings, skylights, companionways and closing appliances		Fresh Water Tanks	
Holds		Deep Tanks	
		Oil Fuel Bunkers and Settling Tanks	
Tween Decks		Side Tanks	
		Wing Tanks	
Fore Peak Spaces		Other Tanks	
After " "			
Engine Space		Cargo Tanks (Tankers)	
Boiler "			
Under Engines and Boilers			
Tunnel and Well		Cofferdams	
Coal Bunkers		Pump Rooms	
Chain Locker			
Other Spaces			
		Have Tanks now Examined been Cleaned as Necessary?	
		Have Struts in Cargo Tanks (of Tankers) been removed?	
		Have Tanks been Retested as necessary after completion of any Repairs?	

Have the spaces now surveyed been cleared and cleaned as necessary?

Have the close ceiling and cargo battens, linings, pipe casings, etc., been removed and replaced as required by the Rules?

Have the bilges been cleaned out and examined?

Has steelwork had rust removed and afterwards been recoated as necessary?

Were inspection plugs or any insulation removed in insulated spaces for examination of steelwork?

Has a Load Line Survey been held? If so, state which

Have the shell and deck plating been drilled as per Rule? If so, Report 8(Dr) to be attached

Have any alterations to the approved scantlings and arrangements now been effected? If so, report details in body of Report.

NOTE:—Indicate which compartments and/or tanks have been examined or tested by giving the identification numbers and inserting the word "Yes", e.g. Holds: Nos. 1, 2 & 3—Yes; or All—Yes.

TABLE 2

The present condition of the following parts in so far as examined is to be reported:—		
Shell plating	Ceiling and Cargo Battens	Sluice Valves examined and found
" " in way of side scuttles	Cement or Asphalt	Air and Sounding Pipes
Rudder and Sternframe	Cargo and other Hatchways	Doubling Plates under Sounding Pipes
Decks	Hatches and closing appliances	Masts and Rigging examined and found
Superstructures and their closing appliances	Ventilators, their coamings and closing appliances	Condition, how ascertained (State if wedges removed)
Coamings and Casings	Companionways and Skylights	Chain Locker
Beams and Fastenings	Shell Openings	EQUIPMENT
Frames	Ash Shoots	Equipment Letter
Reverse Frames	Overboard Discharges and Scuppers	Anchors, No. of Condition
Longitudinals	Freeing ports	Cables (State if now ranged and examined)
Transverses	Steering Gear (Main and Auxiliary)	" length mean diam. (on board)
Floors	examined and found	" Rule Length Size
Keelsons	Windlass examined and found	Hawsers and Warps
Stringers	Pumps " " "	State if any Anchors or Chain Cable have
Inner Bottom Plating	W.T. Doors " " "	now been supplied or retested, if so
Bulkheads and Tunnel		complete Report 8(Eq) and attach.

Have conditions (A) or endorsements (B) of Class (if any) been dealt with? See Below

REMARKS, REPAIRS, Etc. (Contd.)

Survey Fee £7..7..0.

Special Damage or Repair Fee (if any)

Travelling Expenses (if chargeable)

Second Surveyor's Fee (if any)

Date when A/c. Rendered

18/-

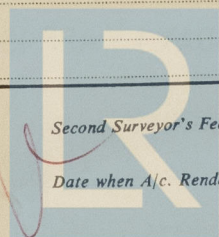

© 2021

Lloyd's Register Foundation