

THE BRITISH CORPORATION REGISTER OF SHIPPING AND AIRCRAFT SURVEY FOR FREEBOARD CONDITIONS OF ASSIGNMENT

SHIPS NAME *"Runnymede Park"*OFFICIAL NUMBER *175393*Nationality and Port of Registry *British, Montreal*

PARTICULARS OF SUPERSTRUCTURES, TRUNKS, CASINGS, DECKHOUSES

	Coaming	Plating	Stiffeners	Spacing	End Attachments	No. and size of Openings	Height of Sills	Height of Casings
Poop Bulkhead								
R.Q.D. ..								
Bridge Aft Bulkhead								
.. Forward ..								
Forecastle Bulkhead								
Trunk, Aft								
.. Forward								
Exposed Machinery Casings on } Freeboard or R.Q. Decks	<i>5/16"</i>	<i>5/16"</i>	<i>3" x 3" x 5/16"</i>	<i>30"</i>	<i>Blk</i>	<i>5' x 3'</i>	<i>34"</i>	<i>10'-6"</i>
Exposed Machinery Casings on } superstructure decks								
Machinery Casings within Super- } structures not fitted with Cl. 1 } closing appliances								
Deckhouses on flush deck ships	<i>5/16"</i>	<i>5/16"</i>	<i>3" x 3" x 5/16"</i> <i>5" x 3" x 5/16"</i>	<i>36"</i> <i>33"</i>	<i>Blk</i>	<i>5' x 3'</i>	<i>18"-24"</i>	<i>4'-6"</i>

PARTICULARS OF CLOSING APPLIANCES (state if capable of being manipulated from both sides)

Poop Bulkhead	
R.Q.D. ..	
Bridge Aft Bulkhead	
.. Forward ..	
Forecastle Bulkhead	
Exposed Machinery Casings on } Freeboard on R.Q. decks	<i>Hinged steel doors - operated both sides.</i>
Exposed Machinery Casings on } superstructure decks	
Machinery Casings within super- } structures not fitted with Cl. 1 } Closing Appliances	
Deck houses on Flush Deck ships	<i>Hinged wood door (2" thick) operated both sides.</i>

PARTICULARS OF FREEING ARRANGEMENTS

	Length of Bulwark	Height of Bulwark	No. and size of Freeing Ports each side	Area each side	Rule Area
After Well	<i>127.9'</i>	<i>3'-6"</i>	<i>4 @ 3'-0" x 9"</i>	<i>96</i>	
Forward Well					

State fore and aft position and height above
deck to bottom of port, for each port

After Well

Forward Well

State whether freeing ports are fitted with shutters, bars or rails, and give particulars

Give particulars of freeing port area, etc., on superstructure decks

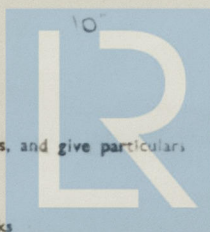

© 2020

Lloyd's Register
Foundation

004369-004373-0165 6

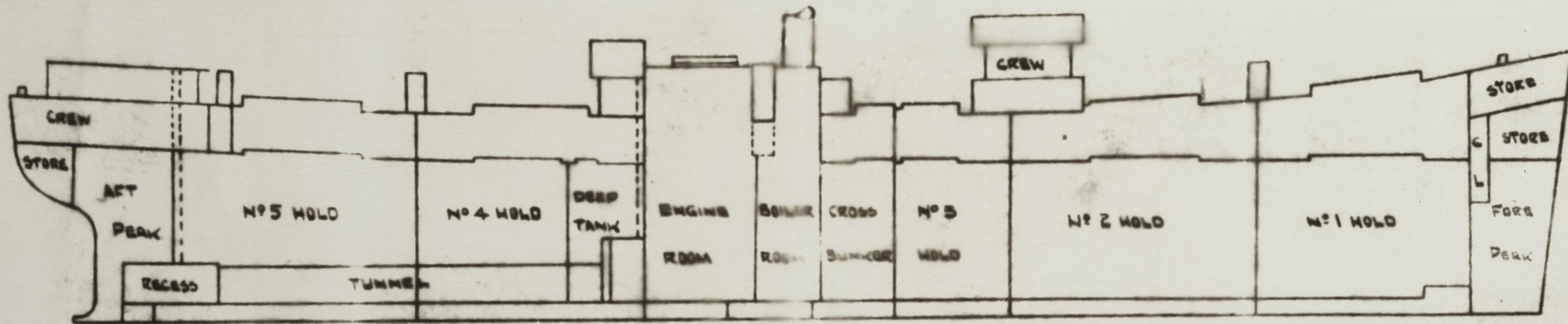

PROFILE

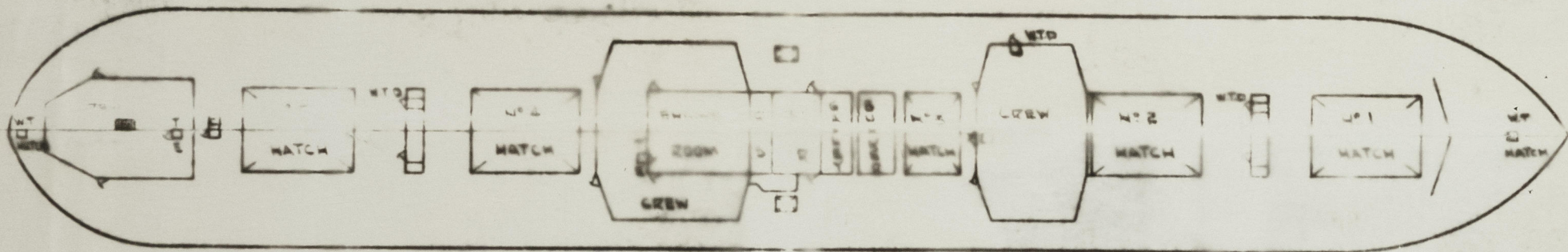

FREEBOARD CK

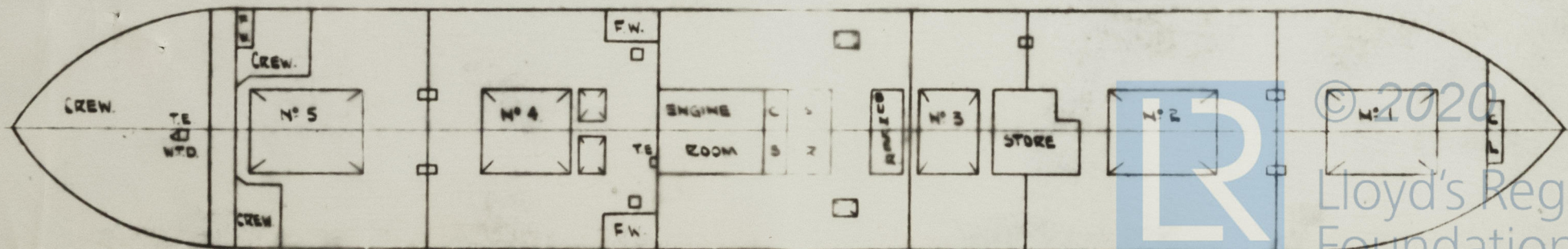

SECOND DK

TRIMMING MATCHES FITTED IN 2ND DK
TO HOLDS - STEEL HINGED COVER

0168 ²/₈

PARTICULARS OF ALL HATCHWAYS ON FREEBOARD AND SUPERSTRUCTURE DECK

Number and description of Hatchway from forward		1	2	3	BUNKER		5	COAL HATCH	STORE HATCH	STORE HATCH
Dimensions of Hatchway		33'-9" x 20'	33' x 20'	15' x 20'	8' x 20'	33' x 20'	33' x 20'	7'-3" x 4'	3'-3" x 2'	11'-9" x 3'-0"
COAMINGS	Height above { steel { deck {	2'-6"						2'-6"	2'-6"	2'-6"
	Thickness { sides { ends {	7/16						7/16	7/16	7/16
	Stiffeners	7 x 3/2 x 3/8	Ditto	Ditto	Ditto		Ditto			
Brackets or Stays		4' x 3' x 3/8								
HATCH BEAMS	Number	8	8	2	1	8	8			
	Spacing	5'-7 1/2"	5'-10"	4'-7" + 3'-40"	4'-0"	5'-10"	5'-10"			
	Scantling and Sketch	18 1/2" x 11/32			18 1/2" x 9/16					
	Bearing Surface and thickness of carriers or sockets	3 x 3 x 3/8 L								
FORE AND AFTERS	Number									
	Spacing									
	Unsupported lengths									
	Scantling and Sketch									
HATCH COVERS	Bearing Surface and thickness of carriers or sockets		As No. 1	As No. 1	As No. 1	As No. 1	As No. 1			
	Material	SPRUCE						SPRUCE		
	Thickness	5"						5"		
	How Fitted	F & A						ATTN.		
Bearing Surface		5"						3'		
Spacing of Cleats		24"						24"		
Number of Tarpaulins		2						2		

Are tarpaulins in good condition and in accordance with rule requirements?

Yes

Are lashings provided in accordance with rule requirements?

LOCKING BARS FITTED

Are wood fore and afters steel shod at all bearing surfaces?

Are bars and wedges efficient and in good condition?

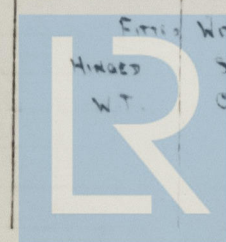

© 2020

Lloyd's Register Foundation

0168 ³/₈

Give full particulars of the following :—

Fiddley, Funnel and Vent Coamings, Engine Room skylight and other openings in Machinery Casing tops and their means of closing (state height of coamings, type of fiddley covers, and if these are permanently attached in their proper positions)

Top of E.R. & B.R. casing 10'6" above upper deck - fiddley gratings and E.R. skylight steel with hinged steel covers fitted to openings permanently secured.

Funnel secured direct to casing top.

Flush Bunker Scuttles on freeboard and superstructure decks (state material, type of joints, etc., and if secured by hinge or permanent chain attachment)

Companionways on freeboard and superstructure decks (state material, height of doorway sills, type of doors, and if these can be closed and secured from both sides)

Steel companionway to crew's quarters aft - 24" coaming - 2" solid wood door operated both sides.

Entrances in Deck-house aft, 24" coamings - 2" solid wood doors - operated both sides.

Doors to pantry in Ford.-house - steel weathertight - operated both sides. Reinforced with portable wood strong back.

Doors giving access to holds and tween decks are steel, rubber jointed and with toggles operated both sides.

Ventilators in exposed positions on freeboard, raised quarter and superstructure decks to spaces below freeboard decks and fully enclosed superstructures enclosed by Class 1 appliances (state height of steel coamings, pitch of rivets in deck connection, type of closing arrangements)

Upper deck coamings 36" minimum - welded above and below deck. Wood plugs and canvas covers supplied.

Airpipes in exposed positions on freeboard, raised quarter and superstructure decks (state height to opening and if satisfactory closing arrangements are provided)

Minimum heights of air pipes on upper deck 36 inches to bottom of bend. Closing arrangements wood plugs secured by chain to air pipes.



© 2020

Lloyd's Register
Foundation

0165 1/6

Scuppers and Sanitary Discharge Pipes (state material, type and number of valves)

In tween decks - 7 off stern valves from deckhouses on Upper deck (Port)
4 " " " " " " " " (Stbd)
3 " double " " accom. in T.Dk. aft (Port)
In No.3 hold - 1 " geared " " refriger.space in T.Dk. (P.& S.)
Valve geared to upper deck.

All valves of brass.

Side Scuttles to spaces below freeboard and superstructure decks (state type or pattern, and if permanent or portable deadlights are supplied)

10" brass framed side scuttles having O.I. hinged deadlights fitted to crew accommodation aft.

Vertical distance of sill of lowest side scuttle below top of freeboard deck at side amidships

Side scuttles aft are 36 inches below.

Guard Rails on freeboard and superstructure decks (state type and where fitted)

Bulworks amidships and forward - guard rails, three in number elsewhere on upper deck.

Gangways and Lifelines

Lifelines to crew accommodation aft.

Gangway, Cargo and Coaling Ports in sides of ship

None.



© 2020

Lloyd's Register
Foundation

016576

SUPPLEMENTARY REQUIREMENTS FOR STEAMER CARRYING TIMBER DECK CARGOES

Do Superstructure and Machinery Casings comply with rules?

Is provision made for protection of steering gear?

Is emergency steering gear provided?

Are efficient sockets and eyes for lashings provided and properly spaced?

State particulars of longitudinal subdivision in double bottom

State particulars of Bulwarks and Rails

Particulars of any Special Features in the construction of the Ship

Endorsement at first survey and at surveys for Renewal of Certificate:—

The fittings and appliances are in accordance with the particulars shown in the form and are in good condition



© 2020

Lloyd's Register
Foundation