

SHIP NO 397.

SINGLE SCREW MOTOR SHIP.

GENERAL ARRANGEMENT.

LENGTH B.P. ON 28' 0" WL. = 452' 0"

BREADTH MLD. = 61' 0"

DEPTH MLD. TO UPPER DK. = 35' 3"

TWN. DK. 10' 0"

SCALE: 1/16" = 1 FOOT.

13 AUG 1941

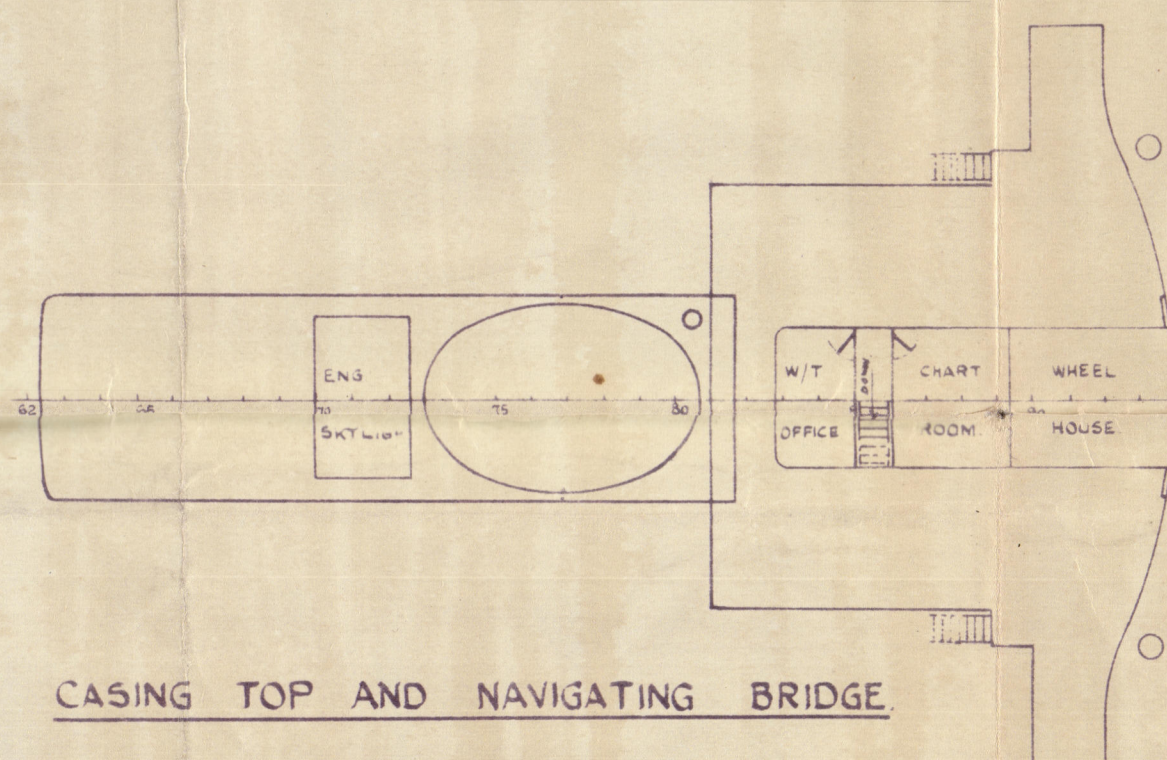
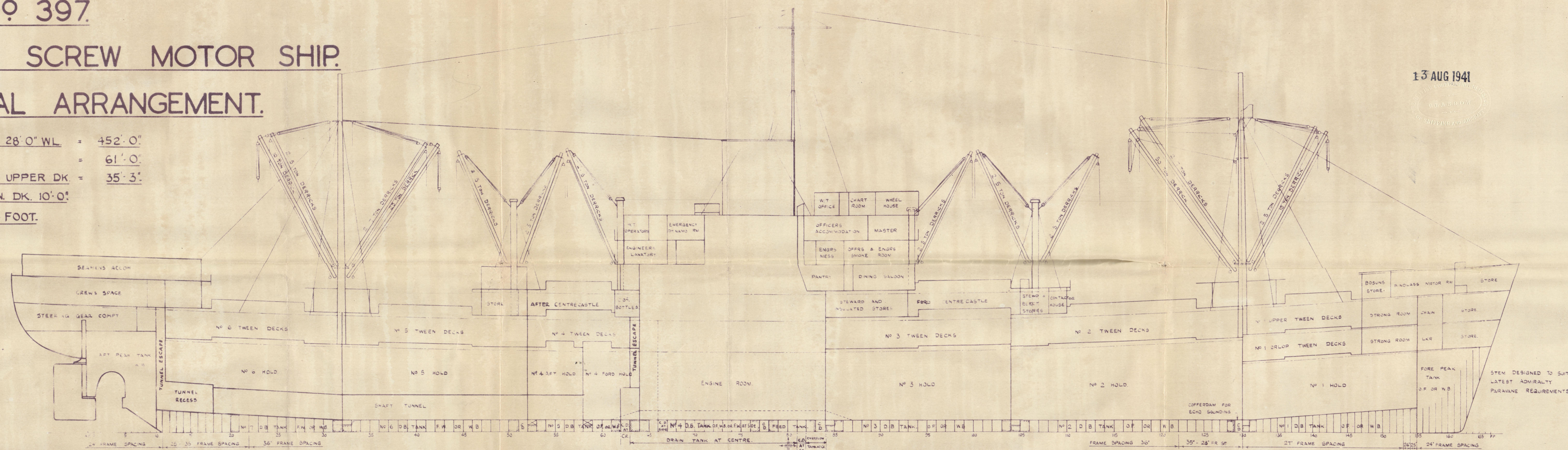

CASING TOP AND NAVIGATING BRIDGE

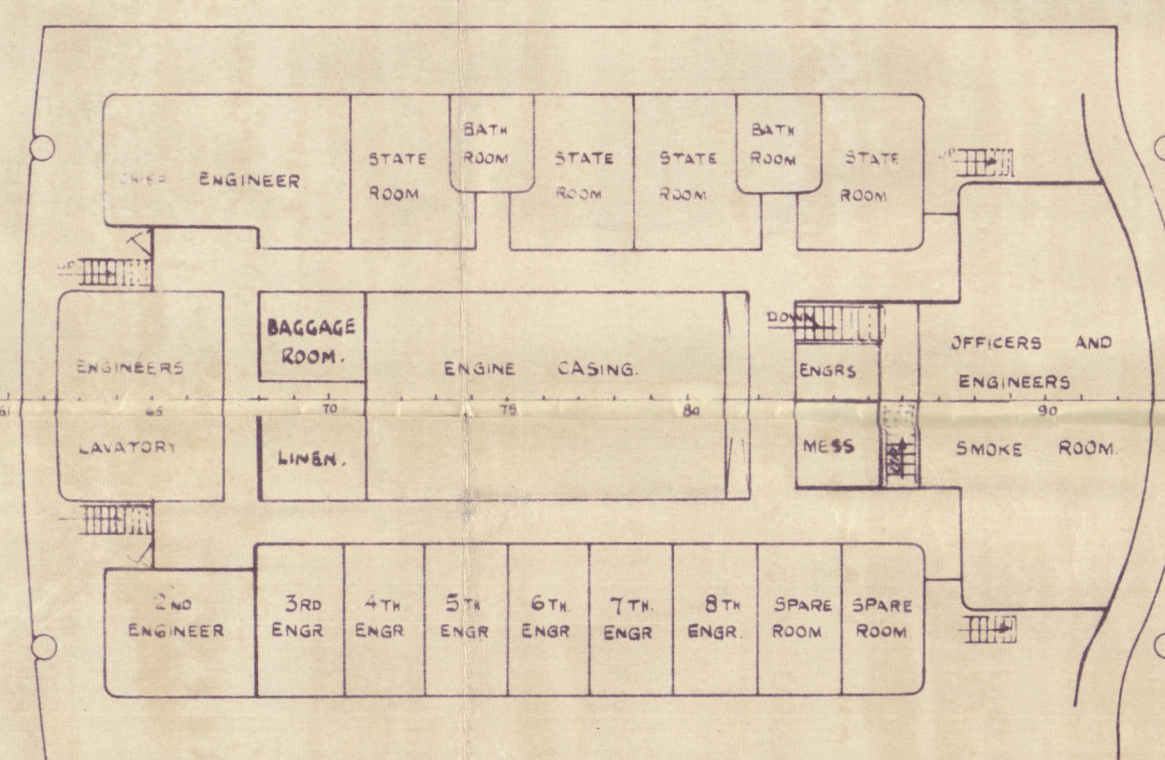

ENGINEERS DECK.

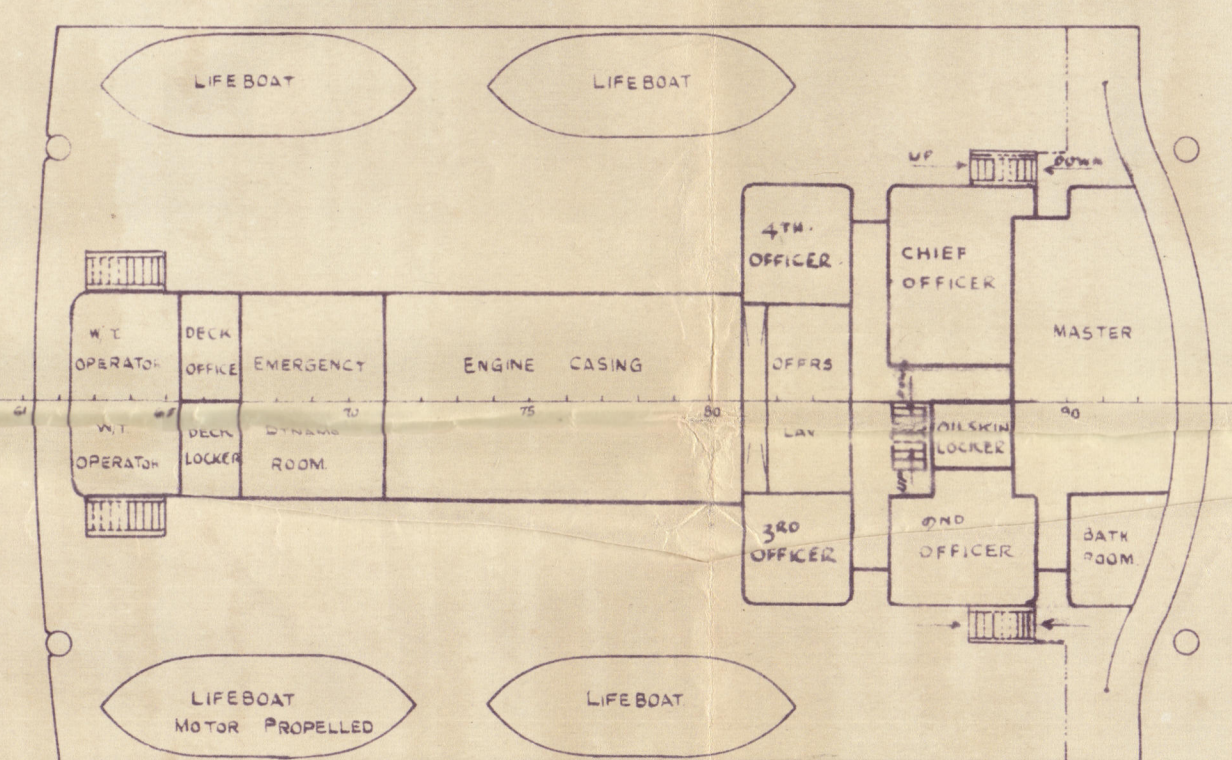

BOAT DECK.

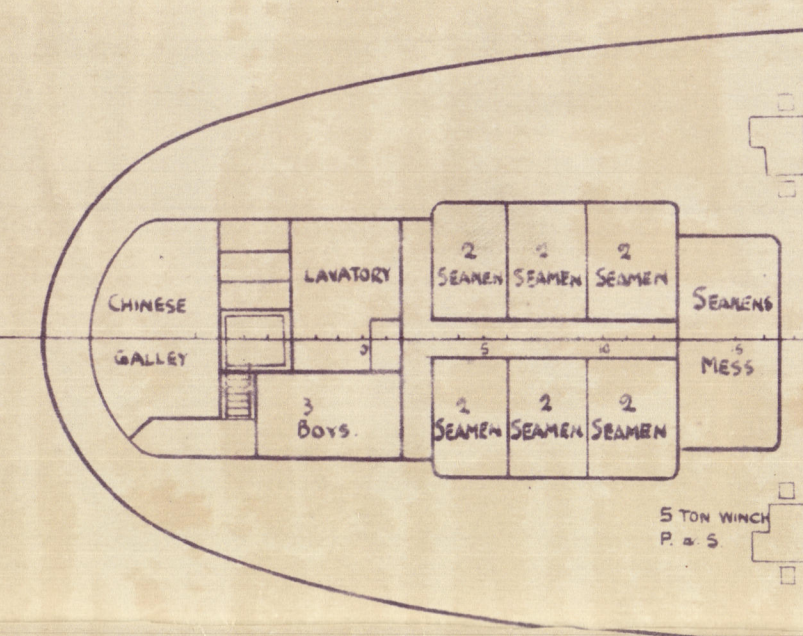

POOP DECK.

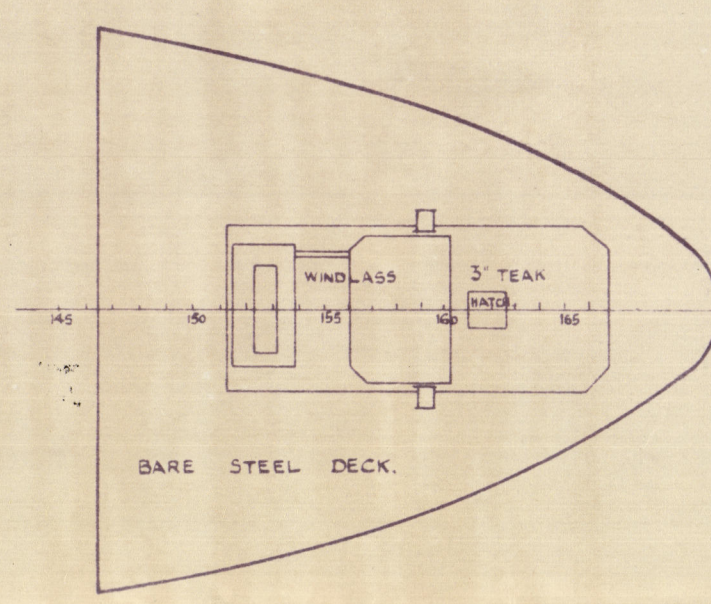
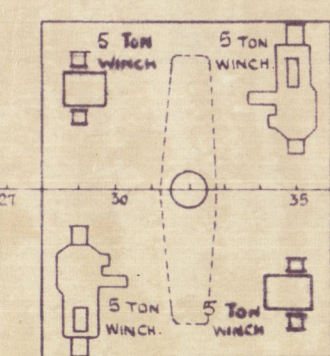

FORECASTLE DECK.

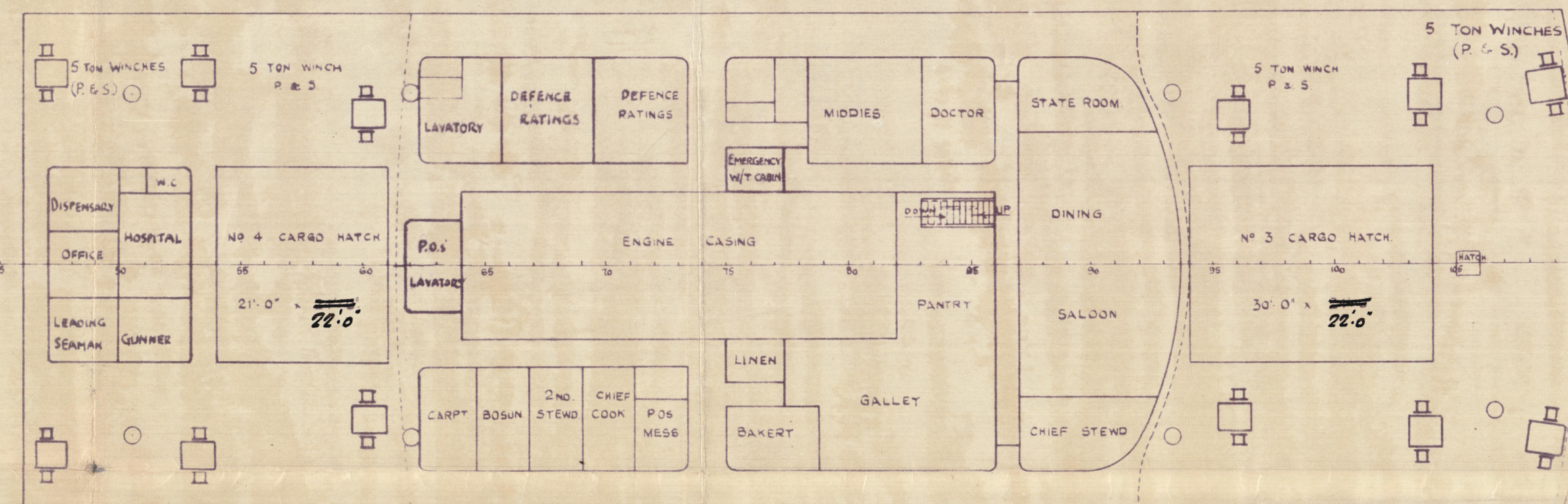

CENTRE CASTLE DECK.

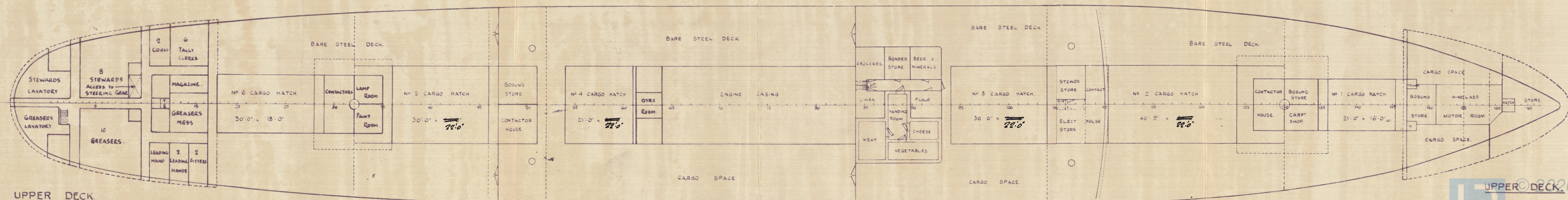

UPPER DECK.



FOR ENCLOSURE

To BRITISH CORPORATION

From THE CALEDON SHIPBUILDING & ENGINEERING CO. LTD.  
CALEDON SHIPYARD, DUNDEE

0007 2/2

97.

CREW MOTOR SHIP.

ARRANGEMENT.

LENGTH B.P. ON 28'-0" WL. = 452'-0"

BREADTH MLD. = 61'-0"

DEPTH MLD. TO UPPER DK. = 35'-3"

TWN. DK. 10'-0"

SCALE :- 1/16" = 1 FOOT.

*[Handwritten signature]*

THE CALEDON SHIPBUILDING & ENGINEERING CO. LTD.  
DUNDEE  
12-8-41  
4449

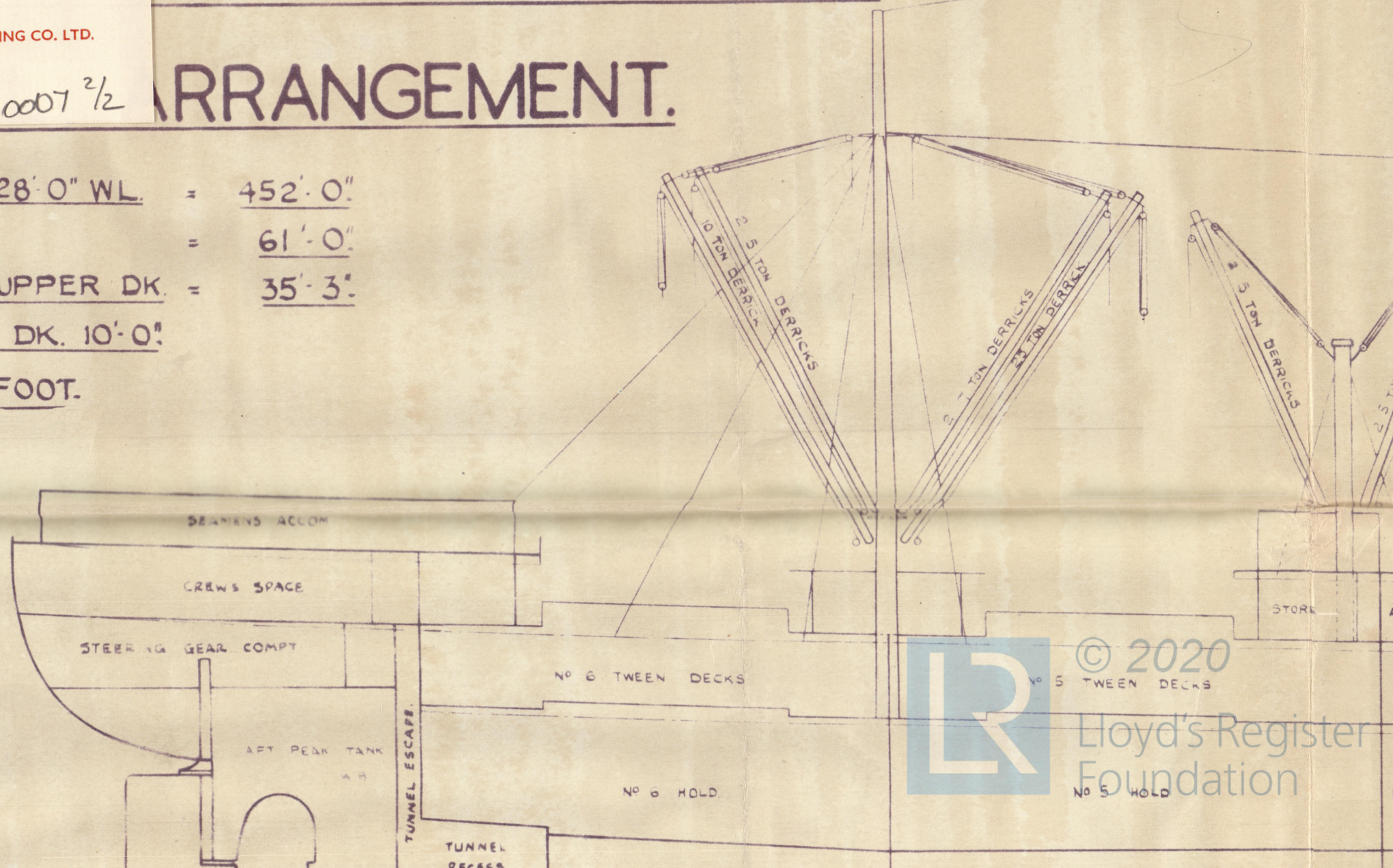

© 2020

Lloyd's Register  
Foundation



3

465  
205

General Urquhart  
Caledon St. E. Co.

No 297.

NANCHANG  
EX  
TELEMACHUS: ★

For No 423.

RECORDS DEPT.,  
LONDON.

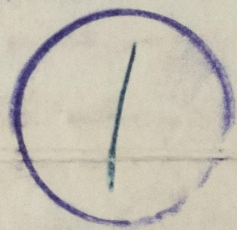

465



© 2020

Lloyd's Register  
Foundation

004364-004368-0007 1/2