

Lloyd's Register of Shipping.
SURVEYS FOR FREEBOARD.
(CONDITIONS OF ASSIGNMENT.)

Nº 34681

Ship's Name *S. S. "PATRICIAN"* Port of Survey *Sunderland*
Official Number *181087* Surveyor's Signature *D. Forsyth*
Nationality and Port of Registry *British, Liverpool* Date of Survey *During Construction*

Disposition and dimensions of superstructures, trunks, deckhouses and machinery casings to be inserted in the diagrams and tabular statement: -

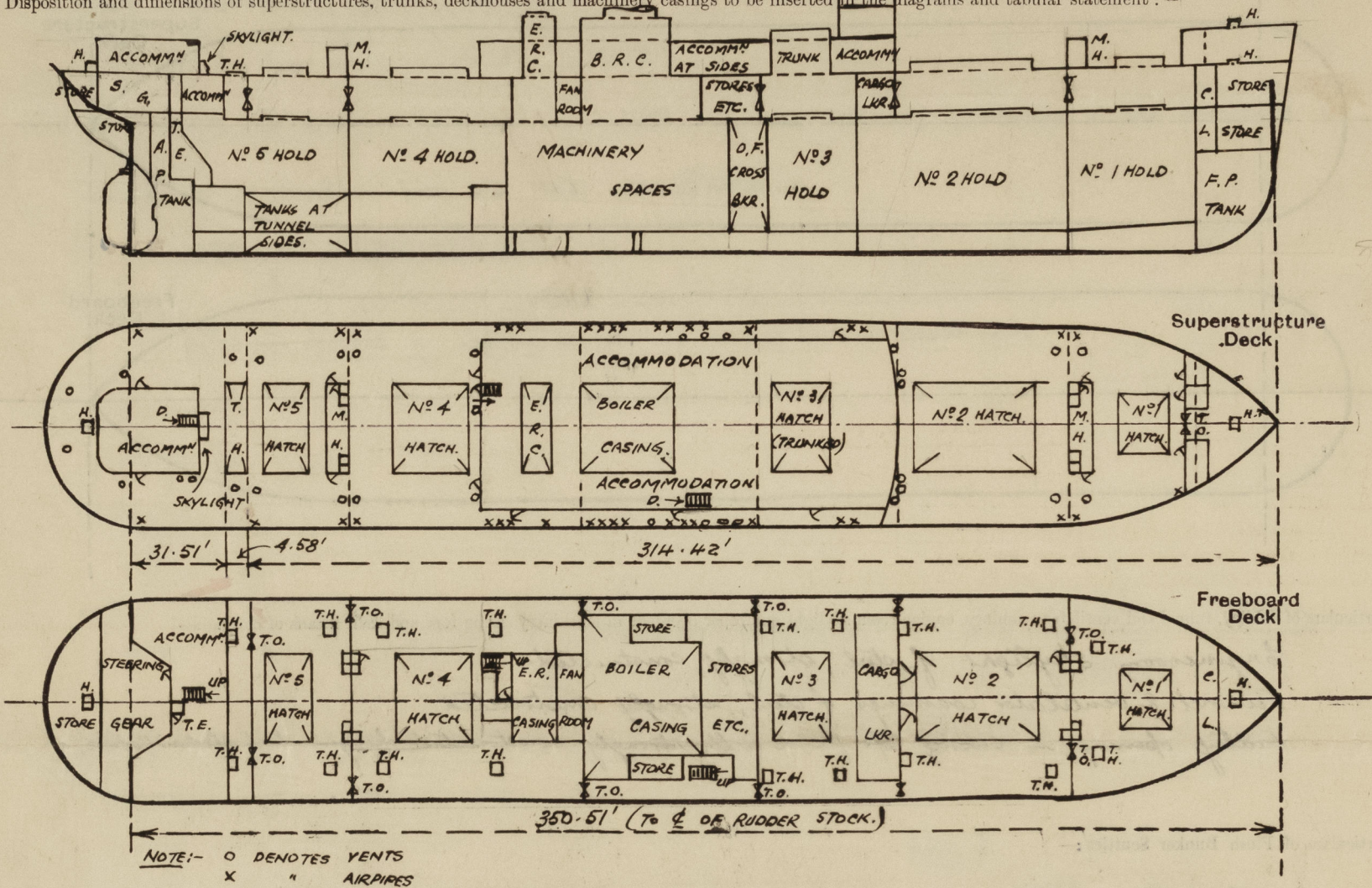

Particulars of Superstructures, Trunks, Casings, Deckhouses.								
	Coaming	Plating	Stiffeners	Spacing	End Attachments of Stiffeners	Size of Openings	Height of Sills	Height of Casings
Poop Bulkhead (TONNAGE WELL).	.26"	.26"	4" x 3" x 30" OA.	36"	Riveted to boundary angle at top & welded to bulk. top & bottom	✓	✓	9'6" Fore & 8'0" Aft Bulk.
Raised Quarter Deck Bulkhead (TONNAGE WELL).	.26"	.26"	5" x 3" x 30" OA.	36"	Riveted to boundary angle at top & welded to bulk. top & bottom	2 @ 4'6" x 3'0 1/2"	18"	9'6"
Bridge, After Bulkhead ...								
Bridge, Forward Bulkhead ...								
Forecastle Bulkhead (ON C.S.S.).	.28"	.28"	4" x 3" x 32" OA.	30" - 36"	Riveted to boundary angles 1 @ 5'1" x 4'1" 2 @ 5'0" x 2'6"	✓	18"	7'0"
Trunk, Aft ...								
Trunk, Forward ...								
Exposed Machinery Casings on Freeboard or Raised Quarter Decks ...								
Exposed Machinery Casings on Superstructure Decks (ABOVE BRAT OK.)	.30"	.30"	3" x 3" x 30"	29"	Bracketted top Continuous bottom 2 @ 4'5" x 1'8"	✓	10" above wood dk.	6'0"
Machinery Casings within Superstructures not fitted with Class I Closing Appliances40" & .60"	.30"	3" x 3" x 30"	29"	Riveted to beams at top Free at bottom	✓	✓	9'6"
Deckhouses on Flush Deck Ships ...								

Particulars of Closing Appliances (state if capable of being manipulated from both sides).

Poop Bulkhead (TONNAGE WELL).	✓
Raised Quarter Deck Bulkhead ...	✓
Bridge, After Bulkhead (TONNAGE WELL).	3" Shifting Boards in full height channels
Bridge, Forward Bulkhead ...	✓
Forecastle Bulkhead (ON C.S.S.).	3" Shifting boards in full height channels, & hinged steel doors, operated both sides.
Exposed Machinery Casings on Freeboard or Raised Quarter Decks ...	✓
Exposed Machinery Casings on Superstructure Decks (ON BRAT OK.)	Hinged steel doors, operated both sides.
Machinery Casings within Superstructures not fitted with Class I Closing Appliances ...	✓
Deckhouses on Flush Deck Ships ...	✓

Name of Ship PATRICIAN

Freeboard Report Examined

(Date) 6 May 1957

Signed [Signature]

0118 2/3

PARTICULARS OF PROTECTION TO OPENINGS, ETC.

The following diagrams should be used to indicate the positions of cargo and coaling hatchways, gangway, cargo and coaling ports, ventilators, companionways, etc., which would affect the seaworthiness of the ship:—

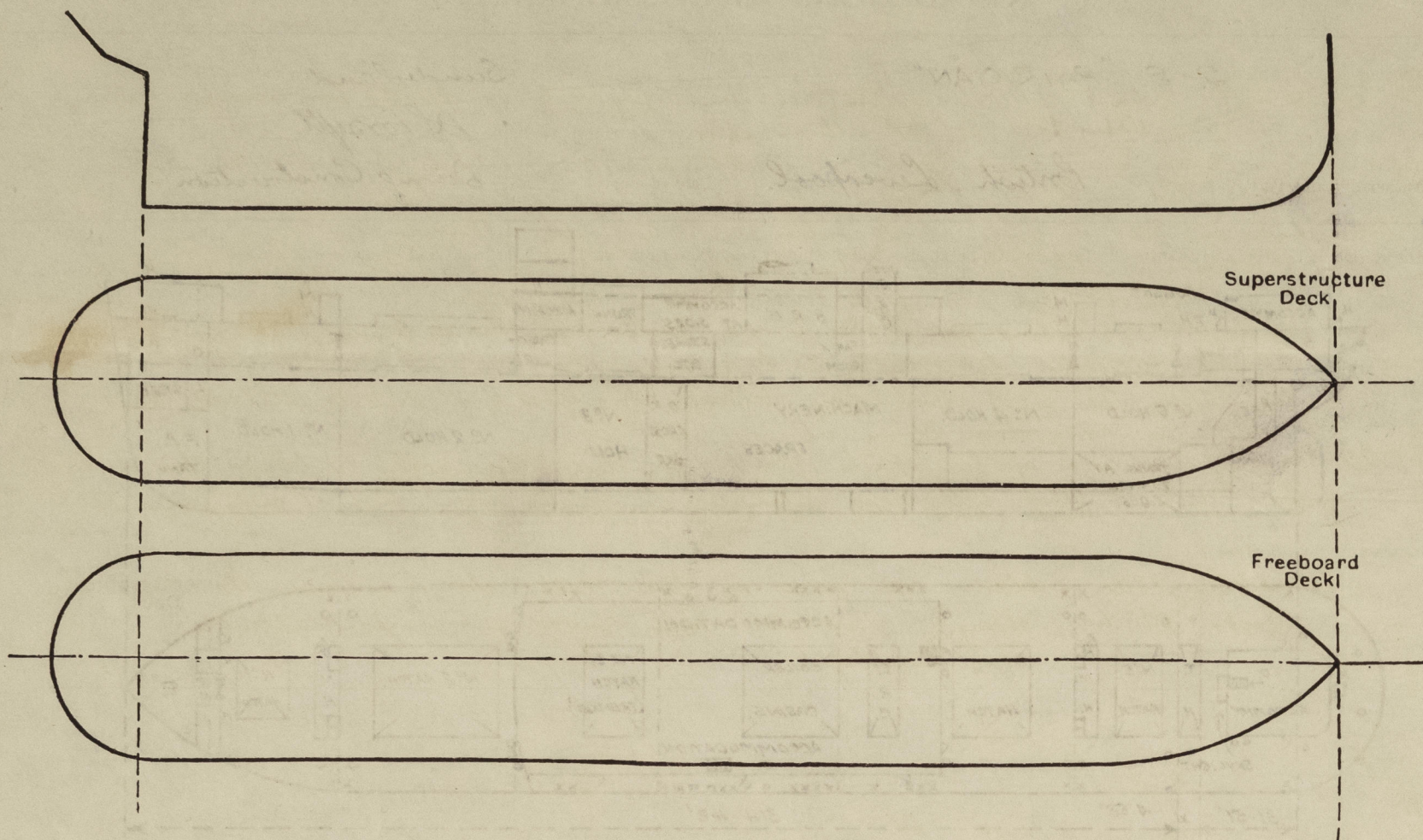

Particulars of fiddley, funnel and ventilator coamings, engine room skylight and other openings in machinery casing tops and their means of closing:—

Engine room skylight of steel, strongly constructed.
Funnel & ventilator coamings of steel, strongly constructed.
Fiddley openings in casing top fitted with strongly constructed hinged steel storm covers.

Particulars of Flush Bunker Scuttles:—

None

Particulars of Companionways:— *Access & Vent trunks to hold spaces in masts houses - openings 4'-0" x 1'-9", coamings 24" with hinged steel W.T. doors, operated both sides; in tween dks. the openings 4'-6" x 2'-0", coamings 18" with hinged steel doors, operated both sides. In midship house, openings 5'-1" x 2'-6" & 5'-1" x 2'-1", coamings 18", with hinged solid hardwood doors, enclosing companionways to store spaces & engine room casings. In after deckhouse, openings 4'-9" x 2'-0", coamings 18", with hinged solid hardwood doors, enclosing companionways to accommodation spaces & tunnel escape.*

Particulars of Ventilators in exposed positions on freeboard and superstructure decks:—

2 @ 11" dia., coamings 8'-0" x 32" to N°1 Hold (efficiently stayed)	} On Fore Dk.	2 @ 11" dia., coamings 2'-0" x 32" to N°1 Hold	} On Mast House tops
1 @ 14" " " 3'-0" x 36" to Fore Store spaces.		2 @ 21" " " 2'-0" x 40" to N°2 Hold	
2 @ 17" " " 7'-0" x 38" to N°1 Tween (efficiently stayed)	} On Upper Deck.	2 @ 17" " " 2'-0" x 38" to N°4 Hold	} On Boat Deck
10 @ 17" " " 3'-0" x 38" to N°1, 2, 3, 4 & 5 Tween & Holds.		2 @ 12" " " 2'-0" x 34" to N°5 Hold	
4 @ 17" " " 4'-9" x 38" to N°2, 3 & 5 Tween (efficiently stayed)	} On Upper Deck.	2 @ 15" " " 1'-6" x 36" to N°3 Hold	} On Boat Deck
2 @ 30" (derrick post vents) to N°3 Hold		4 @ 17" " " 1'-6" x 38" to N°3 & 4 Tween	
6 @ 12" coamings 3'-0" x 34" to N°5 Hold, Cargo Lks, Bulk Store & Refrig. Machf.	1 @ 9" " " 2'-9" x 32" to Stores	} On Boat Deck	
2 @ 17" " " 9'-9" x 38" to N°4 Hold (efficiently stayed)	1 @ 12" " " 3'-9" x 34" to Machinery Spaces		
2 @ 16" " " 3'-0" x 38" to Tunnel	2 @ 21" " " 5'-6" x 40" " " "		
2 @ 10" " " 3'-0" x 32" to Stores aft			
3 @ 9" " " 3'-0" x 32" to Gyro room & Steering gear.			
2 @ 6" goose-necks, 3'-0" to opening to N°4 Tween.			
3 @ 6" coamings 3'-0" x 38" to after accomm. & store amidships			

Ventilators fitted with wood plugs & canvas covers.

Particulars of Air Pipes in exposed positions on freeboard, raised quarter, or superstructure decks:—

To peaks, and to D.B. feed & fresh water tanks & cofferdams 3" dia., openings 30" above dk.
To deep oil fuel & settling tanks, and D.B. oil fuel or water ballast tanks 4" dia., openings 36" above deck, and fitted with 'Nonex' patent type heads by Newhaven Engineering Co.

Air pipes other than with patent heads fitted with wood plugs.

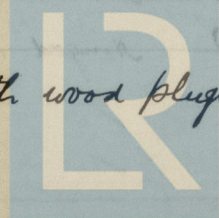

Lloyd's Register
Foundation

None

Particulars of Scuppers and Sanitary Discharge Pipes:—

- In Tonnage well 1-5" dia, S.D.N.R. valve scupper (p. & s.) discharging overboard, operated from accessible position on Upper Deck & fitted with indicator. ✓
- In way of machinery space amidships 2-3½" dia, scupper pipes (p. & s.) led into 1 common 4" dia. scupper pipe (p. & s.) led to E.R. bilges & fitted with weighted lever cocks at lower ends. ✓
- Deck Drain holes cut p. & s. in wings of all intermediate tween dk. bulkheads. ✓
- In way of refrigerated store spaces 3-1½" dia, scuppers led into 1 common 3" dia, scupper pipe led to bilges & fitted with water sealed traps at tops & bottom. ✓
- From after lazarette & steering gear spaces 2" dia, scupper pipes led to tunnel well bilge, & fitted with weighted lever cocks at lower ends. ✓
- Upper 8-2" dia, scupper pipes (p. & s.) discharging overboard above level of 2nd deck, & fitted with brass automatic non-return storm valves at ship's sides. ✓
- Deck & above All sanitary discharges are from spaces above the upper deck & discharging overboard above the level of the 2nd deck, & fitted with brass automatic non-return storm valves at ship's sides. ✓

Particulars of Side Scuttles:—

To accommodation & steering gear spaces in tween decks aft, & in Forecastle tween decks 12" dia, strongly constructed with hinged galvanized malleable iron deadlights. ✓

Vertical distance of Sill of lowest Side Scuttle above top of keel

33'-7"
(side scuttles fitted in tween deck, aft only) ✓

Particulars of Guard Rails:—

Strongly constructed steel bulwarks, efficiently stayed fitted on upper deck for about 125'-0" abreast midship house & for about 27'-0" abreast No. 1 hatchway; close to on upper deck & Forecastle deck strong steel stanchions 3'-6" in height, spaced about 5'-0" apart, with 3 rails. (portable gates in way of cargo hatchways). ✓

Particulars of Gangways, Lifelines, etc.:—



Particulars of Freeing Arrangements. (See also Scuppers).

	Length of Bulwark	Height of Bulwark	Size of Freeing Ports	Number each side	Area each side	Rule area each side
Tonnage Well	4'-7"	✓	5" dia, S.D.N.R. Valves operated from Upper Dk.	1	✓	✓
Forward Well						

State position of each freeing port { After Well:— ✓
(F. and A. position and height above deck edge) { Forward Well:— ✓

State whether the freeing ports are fitted with shutters, bars, or rails, and give particulars of such:— ✓

Additional area where sheer is less than standard. ✓



© 2020

Lloyd's Register
Foundation

PARTICULARS OF PROTECTION TO OPENINGS, ETC.

		HATCHWAYS ON FREEBOARD AND SUPERSTRUCTURE DECKS.										
		FREEBOARD DECK					UPPER DECK					BOAT DECK
Description of Hatchway		Nº 1	Nº 2	Nº 3	Nº 4	Nº 5	Nº 1	Nº 2	Nº 4	Nº 5	Nº 3	
Dimensions of Hatchway		14'-0" x 10'-0"	39'-0" x 18'-0"	19'-10" x 15'-0"	27'-1" x 18'-0"	15'-0" x 18'-0"	13'-6" x 14'-6"	38'-6" x 18'-0"	26'-7" x 18'-0"	14'-6" x 18'-0"	19'-4" x 15'-0"	
COAMINGS	Height above Deck	9" x 3" x 7/16" B.A.										
	Thickness	9" x 3" x 7/16"										
	Sides	9" x 3" x 7/16"										
	Ends	9" x 3" x 7/16"										
HATCH BEAMS	Stiffeners	✓	✓	✓	✓	✓	✓	✓	✓	✓	✓	
	Brackets, Stays	✓	✓	✓	✓	✓	✓	✓	✓	✓	✓	
	Number	2	7	3	5	2	2	7	5	2	3	
	Spacing	4'-8"	4'-10 1/2"	4'-11 1/2"	4'-6"	5'-0"	4'-8"	4'-10 1/2"	4'-6"	5'-0"	4'-11 1/2"	
FORE AND AFTERS	Scantling and Sketch											
	WEB PLATES	12" x .32"	16" x .36"	20" x .38"	15" x .35"	16" x .36"	15" x .32"	16" x .36"	15" x .32"	15" x .32"	15" x .28"	
	Bearing Surface	TOP & BOTTOM ANGLES 4" x 3" x .44" (4" HORIZ.)										
		TOP & BOTTOM ANGLES 4" x 3" x .44" (4" HORIZ.)										
HATCH COVERS	Material	W. WOOD										
	Thickness	2 1/2"										
	How fitted	F. & A.										
	Bearing Surface	3" AT HATCH ENDS, 4" ON BEAMS										
Spacing of Cleats		24"										
Number of Tarpaulins		1										

*Are wood fore and afters steel shod at all bearing surfaces? *Yes*
 Are battens and wedges efficient and in good condition? *Yes*
 Are tarpaulins in good condition and in accordance with rule requirements? *Yes*
 Are lashings provided in accordance with rule requirements? *Yes (locking bars)*

NOTE:- Ends of wood covers protected by galv. steel bands, efficiently secured.

Particulars of any special features:-

Steel Skylight:- Strongly constructed steel skylight on upper deck at forward end of after deckhouse to crew's accommodation, coaming 23" high & fitted with steel hinging W.T. covers.

Small Hatches

On upper Deck { Tonnage Hatch:- 4'-7" x 18'-1", coaming 9" x 3" x .44" L, 3" wood covers, fitted F. & A., bearing surface 3", covers secured by ring bolts and lashings.
To After Peak Store:- 2'-11" x 3'-11", coaming 30" x .44", with hinged steel W.T. cover .40" thick, secured by 8 toggles.
To Fore Store in Fore Tower:- 3'-9" x 3'-0", coaming 9" x 3" x 3/8" L, 2 1/2" W. Wood covers fitted F. & A., bearing surface 2 1/2", & complete with battens, cleats & 2 tarpaulins.

On Fore Deck { To Fore Store:- 3'-8" x 1'-6", coaming 30" x .44", with hinged steel W.T. cover .40" thick secured by 8 toggles.
Trimming hatches 18 off 2'-5" x 2'-7", coaming 9" x 3" x 3/8" L, 2 1/2" W. Wood covers, bearing surface 2 1/2" secured by strong steel hinges & 6 toggles with jointing.



FREEBOARD DK. STRINGER PLATE DETAIL

Endorsement at first survey and at surveys for renewal of Certificate:-

The fittings and appliances are in accordance with the particulars shown on this form (or as now modified) and are in good condition.

