

Office  
copy

M/ ROSE-JULIE M.  
PROPOSED ALTERATIONS TO N°2 HATCH  
DIMENSIONS LBP 140'-0" B.M.-26'-0" x D.M.-11'-0"

SCALE: 1/4" = 1 FT.

RPT. No. Ems 23387

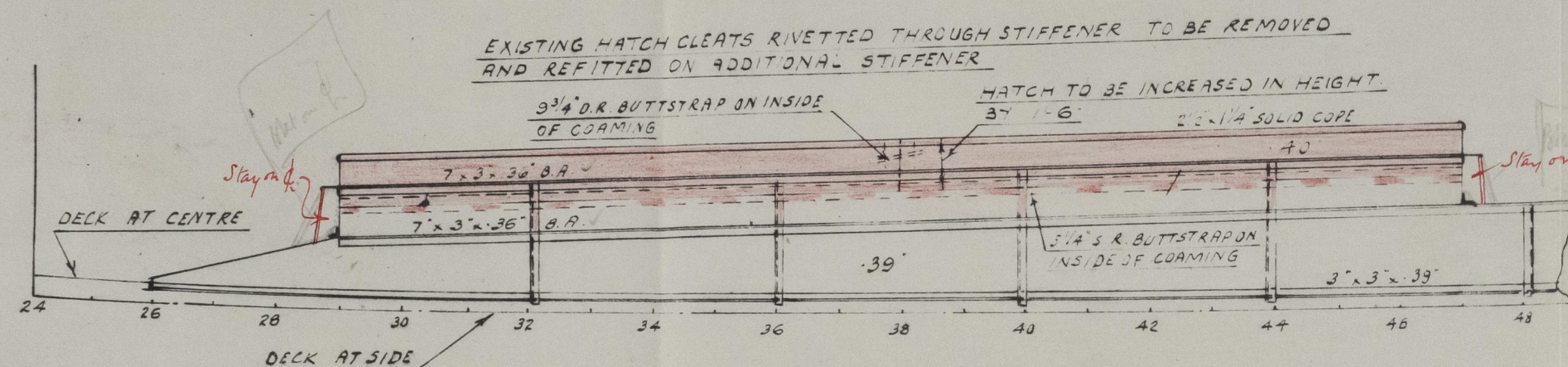

ELEVATION SHOWING HATCH SIDE  
LOOKING TOWARDS CENTRE LINE

EXISTING 2 1/2 x 1 1/4 SOLID COPE TO  
BE REMOVED AND BE REFITTED  
WHERE SHOWN

AN INTERMEDIATE HOLE IS TO  
BE FITTED BETWEEN EXISTING  
RIVET HOLES WHERE COPE IS TO BE  
REMOVED FOR RIVETING BUTTSTRAP

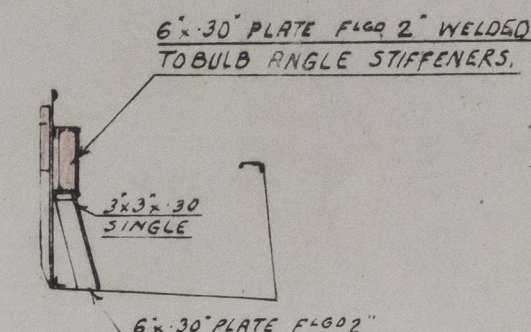
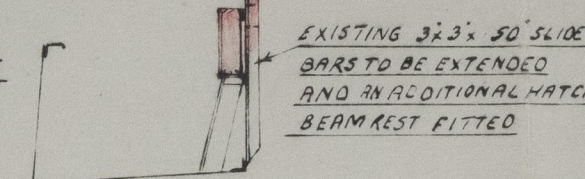

TYPICAL SECTION

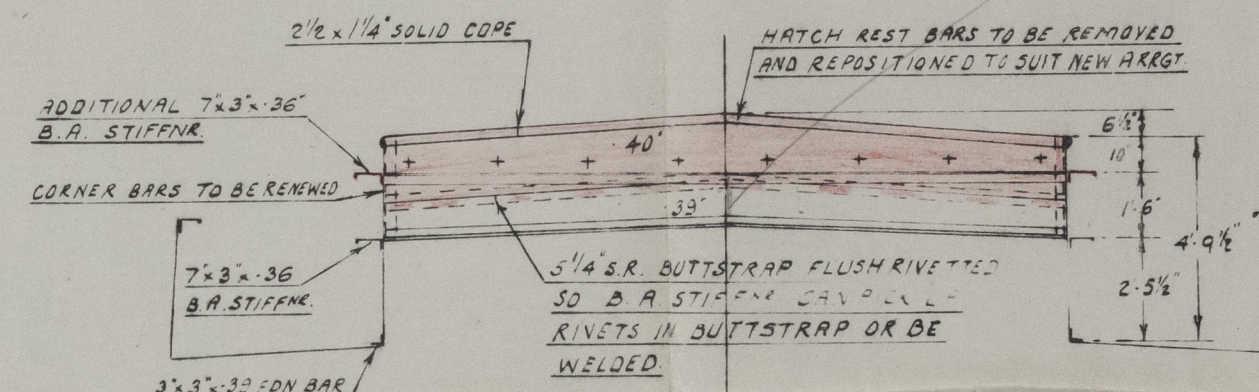

SECTION SHOWING FORE END OF HATCH  
LOOKING AFT

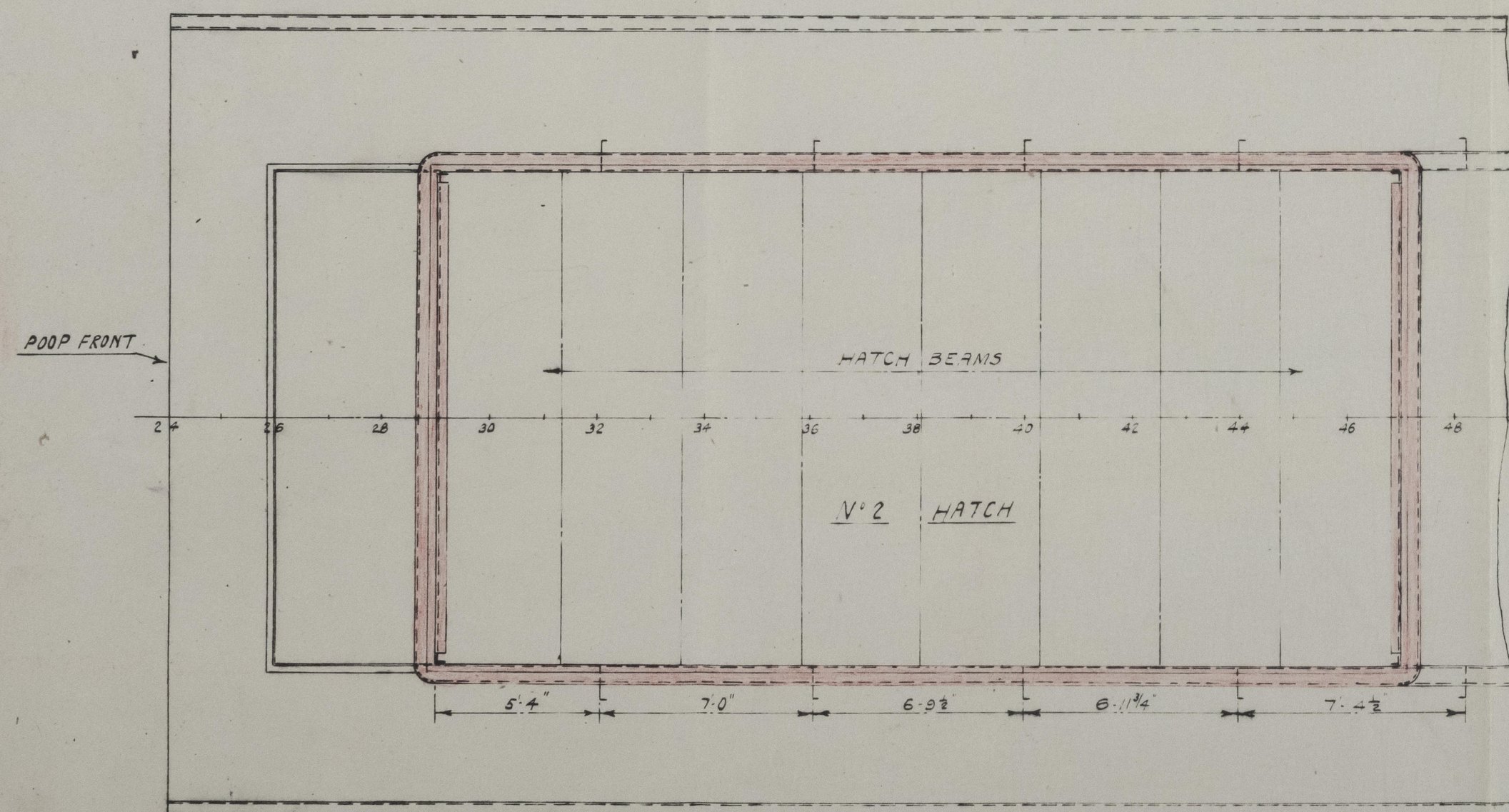

DECK PLAN

HATCH REST BARS TO BE REMOVED AND  
REPOSITIONED TO SUIT NEW ARRANGEMENT

EXISTING HATCH CLEATS TO BE  
REMOVED AND REPOSITIONED TO  
SUIT NEW ARRANGEMENT

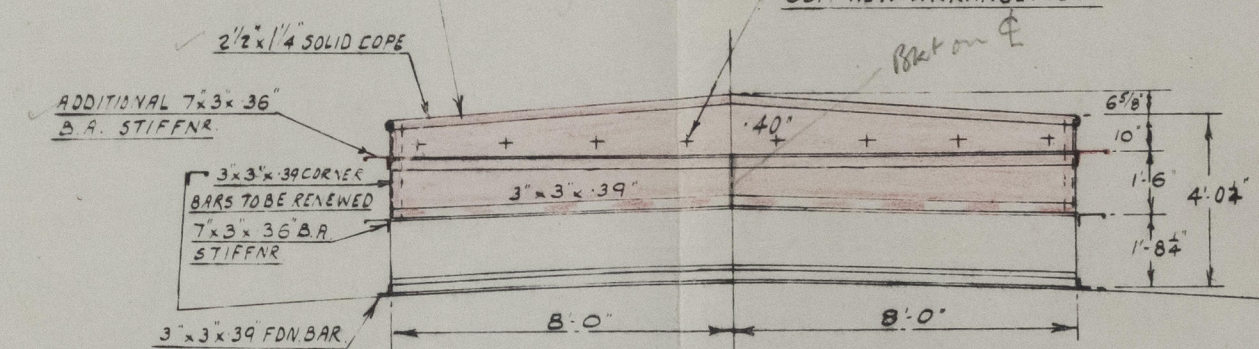

SECTION SHOWING AFT END OF HATCH  
LOOKING FORWARD

RIVETING LIST			
DESCRIPTION	SIZES	INT. SPACING	
SOLID COPE	3/4 RIVS.	70 x 70	5/4\"
BULB ANGLE STIFFENERS	3/4	7	5/4\"
SINGLE RIVETTED BUTTSTRAP	3/4	37	2 1/8\"
DOUBLE	3/4	4	3

1.10.48



J.S. DOIG (GRIMSBY) LTD  
SHIPBUILDERS AND ENGINEERS  
GRIMSBY

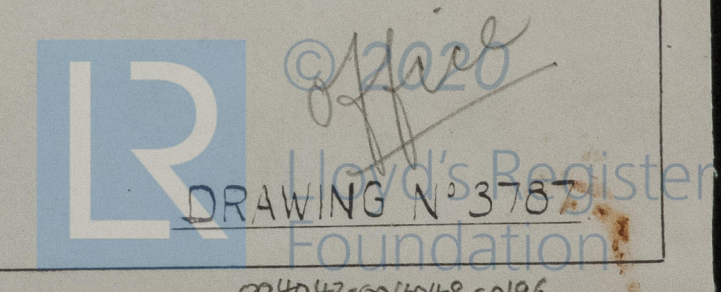

004042-004048-0196