

PARATIA LONGITUDINALE
DISEGNATA LA DESTRA, SINISTRA SIMMETRICA
VISTA DA ENTRO CASSE NAFTA

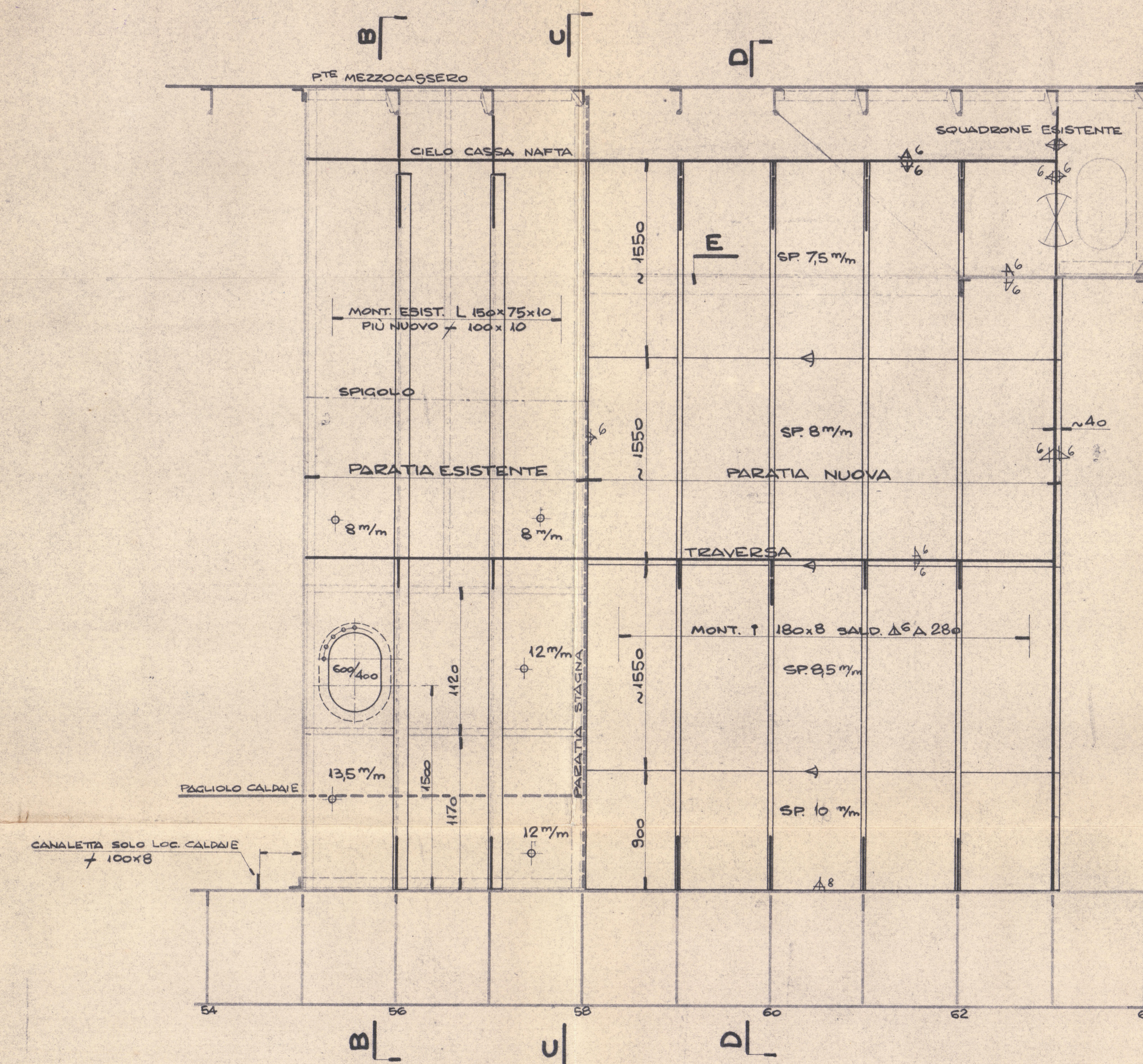

PARATI TRASV. ORD. 55 ESIST
GUARDANDO PRORA
DISEGNATA LA DESTRA, SINISTRA SIMMETRICA

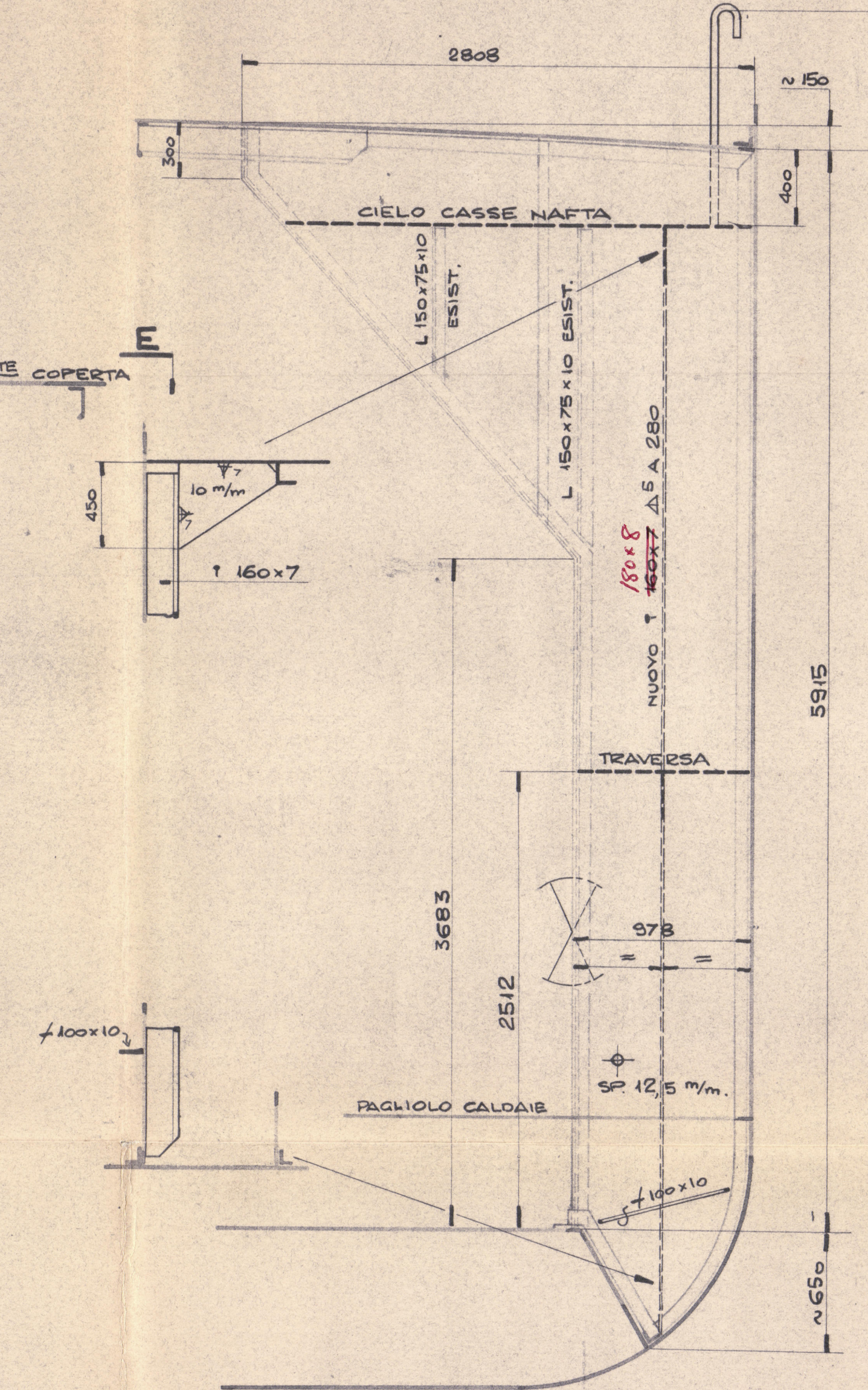

SEZIONE B-B
ORD. 56-57
GUARDANDO PROVA

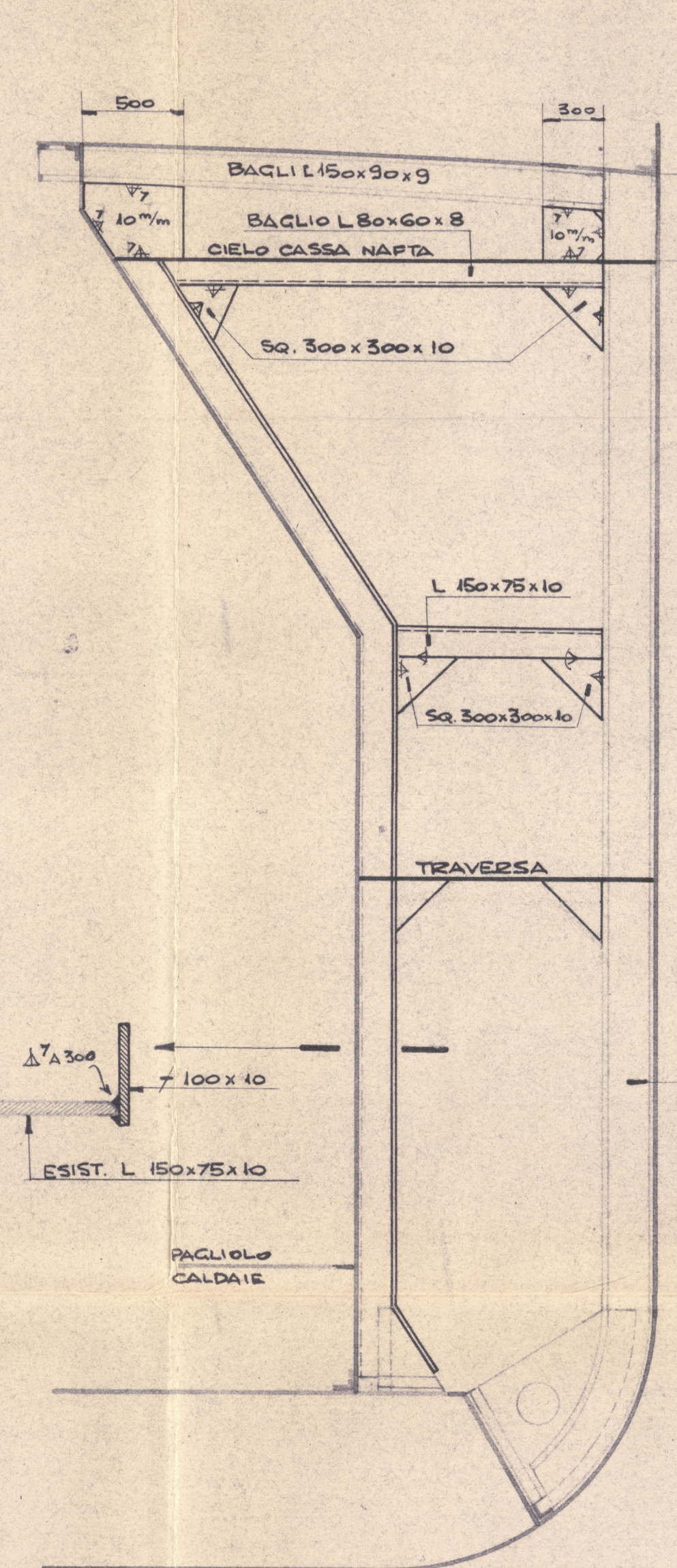

SEZIONE C-C
02D. 58
GUARDANDO PRIMA

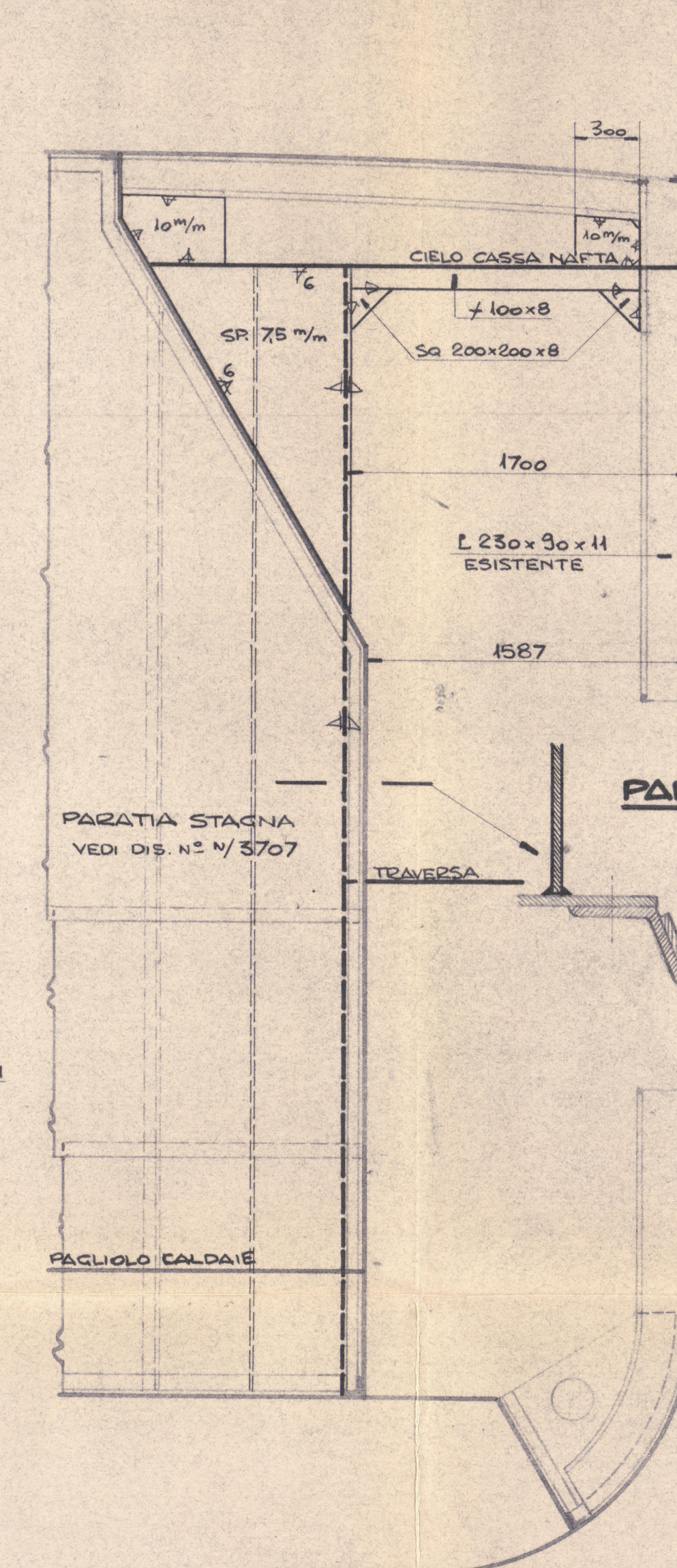

SEZIONE D-C
ORD. 59-60-61-62
GUARDANDO PRORA

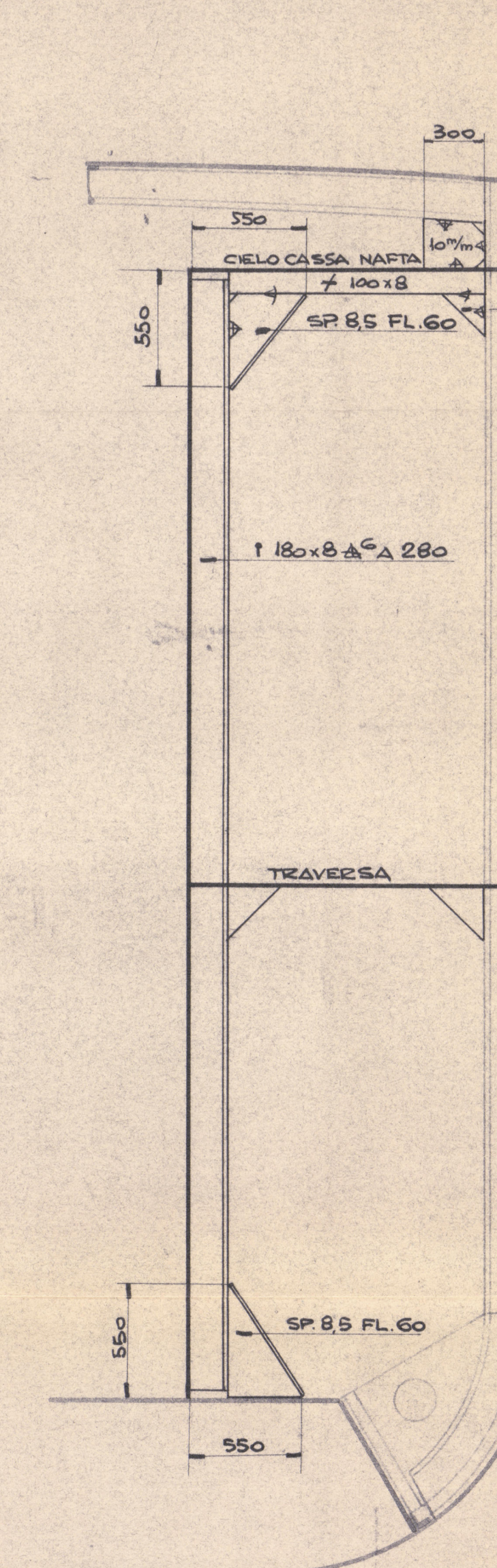

PARATIA TRASY. ORD. 63
GUARDANDO PRORA
DISEGNATA LA DESTRA SINISTRA SIMMETRICA

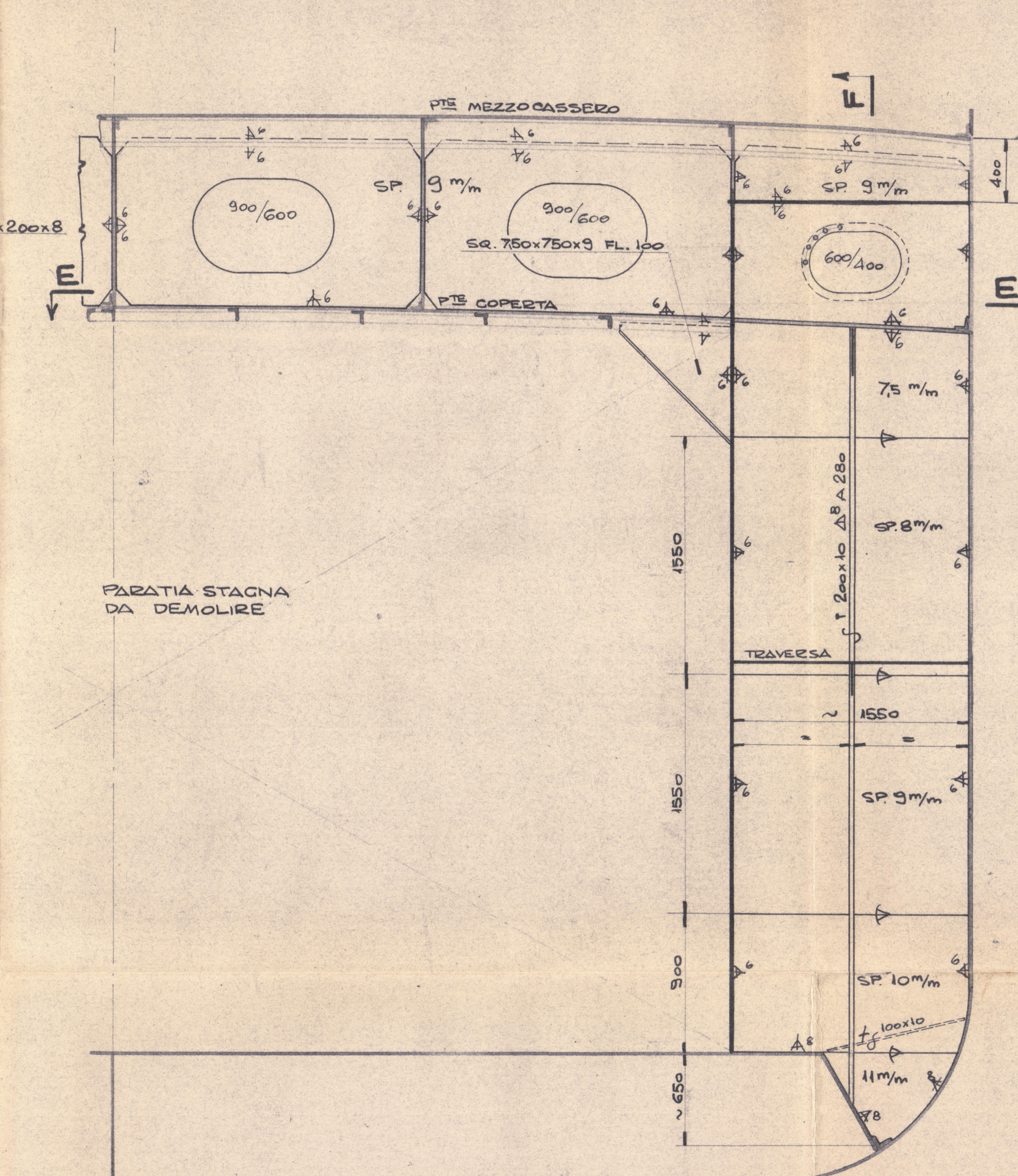

SEZIONE F-F

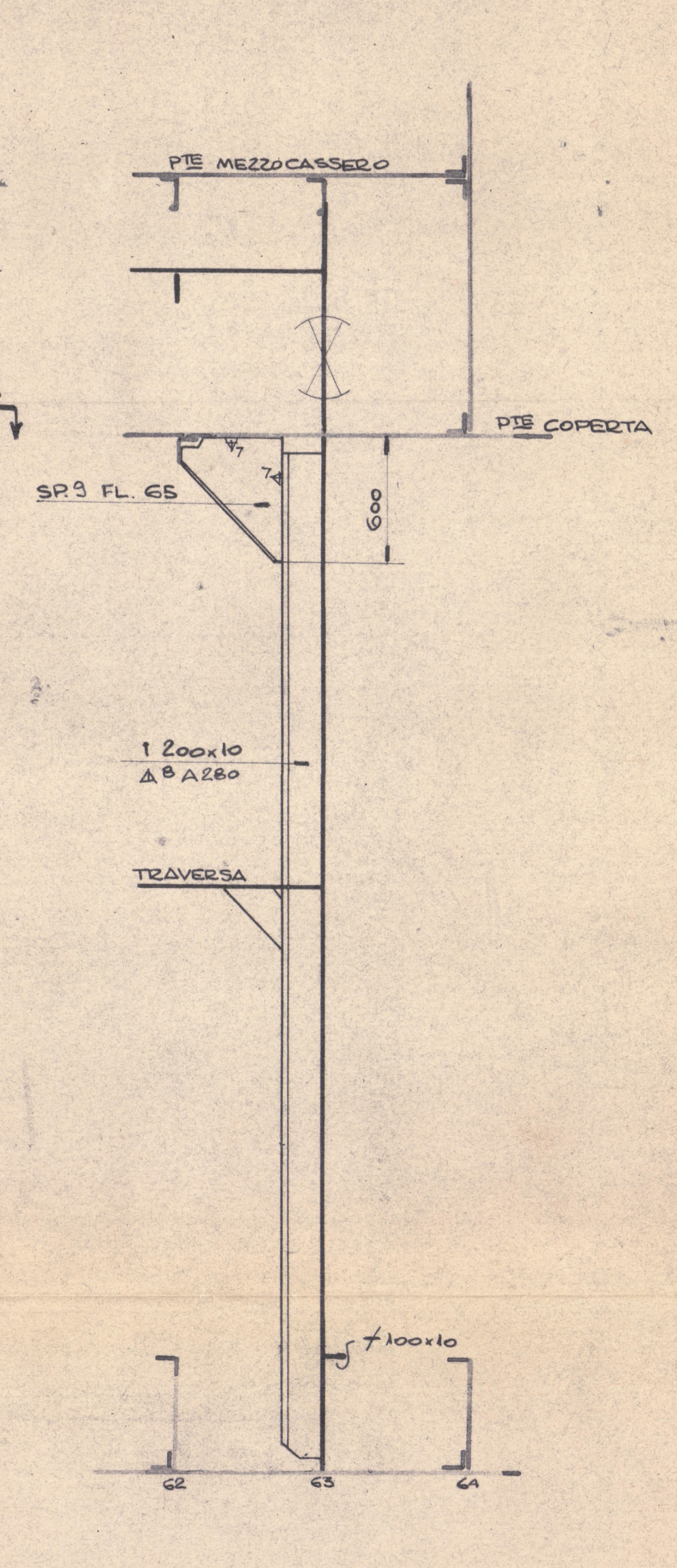

SEZIONE E-E
PTE COPERTA

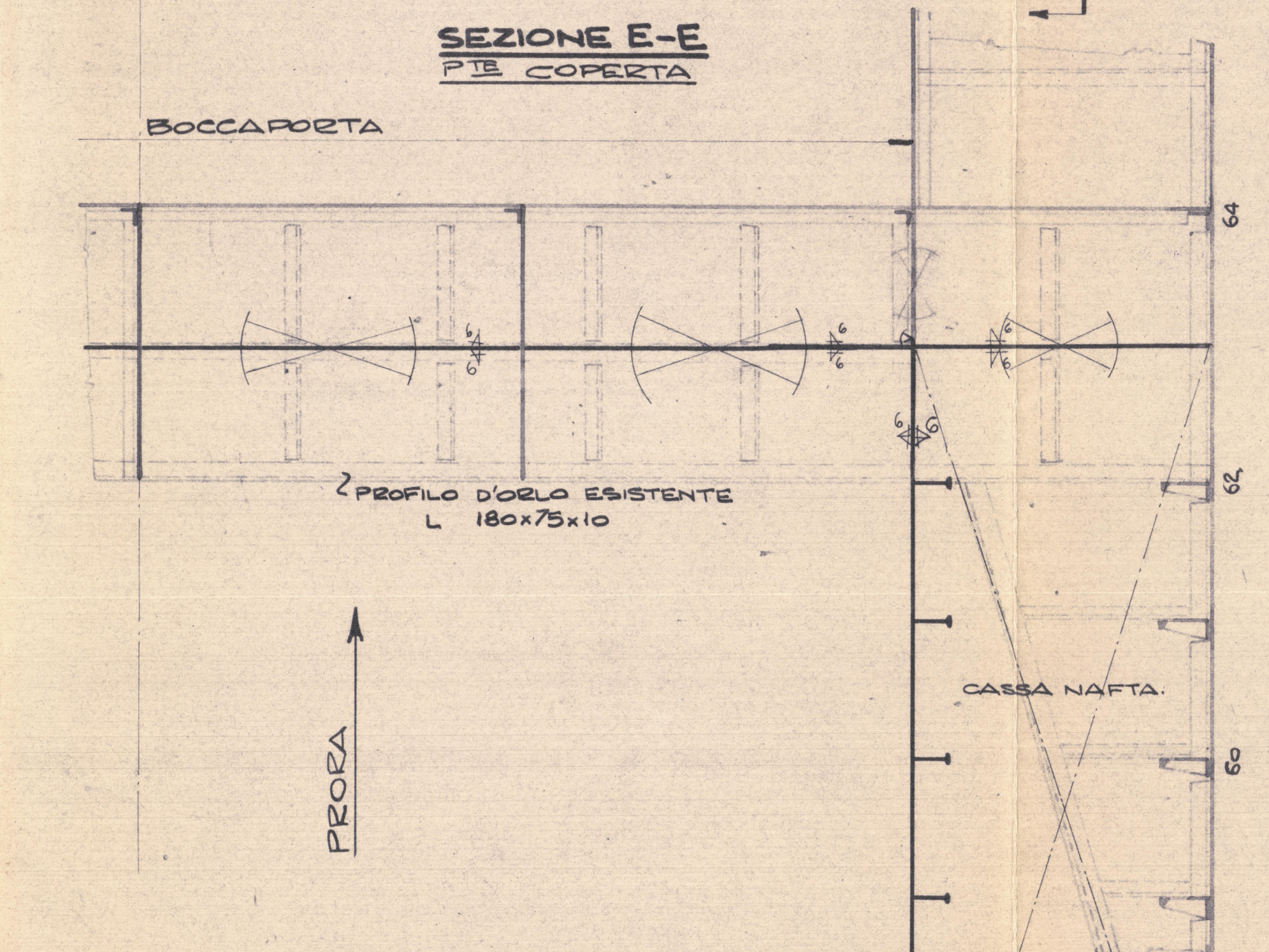

CIELO CASSA NAFTA
DISEGNATO A DESTRO, SINISTRO SIMMETRICO

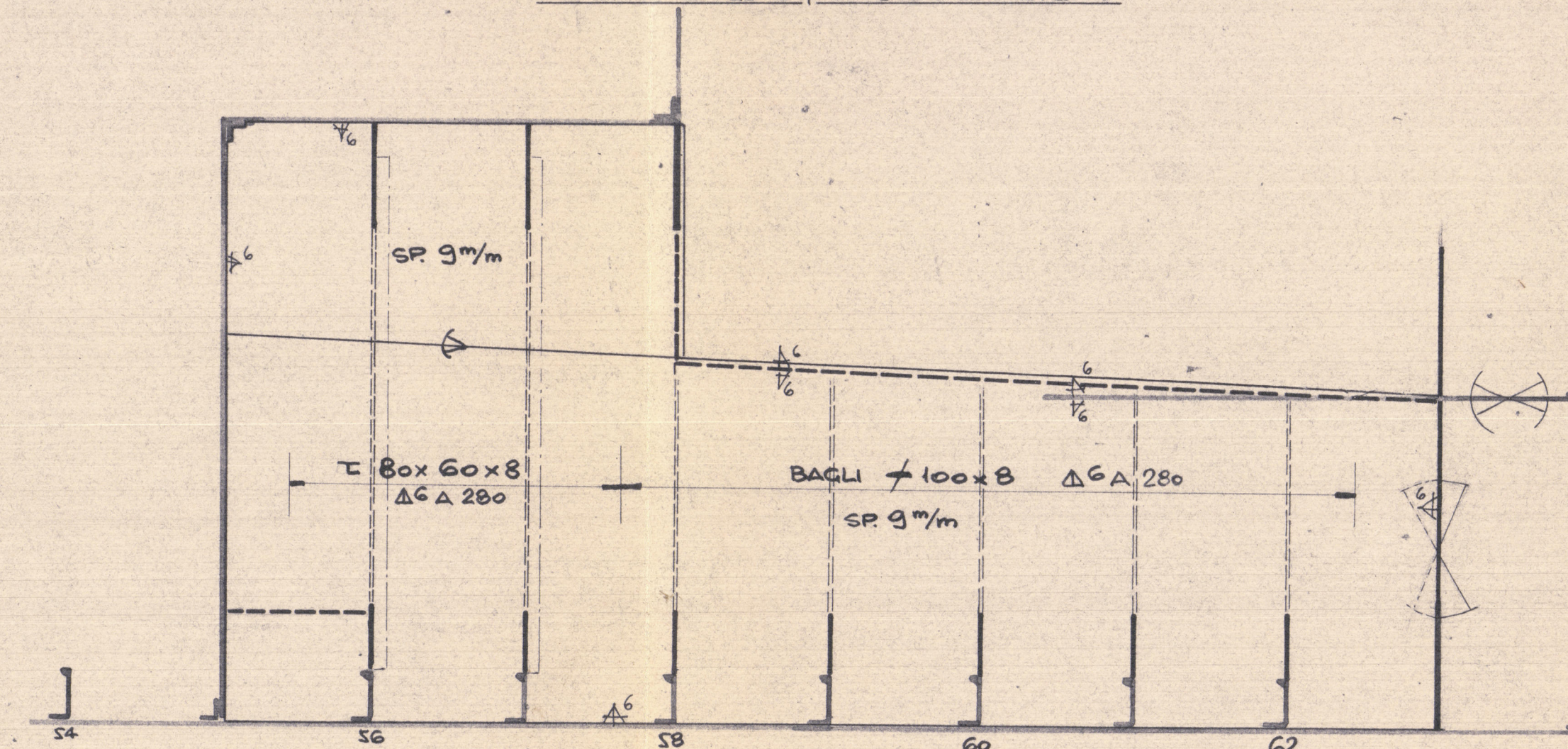

INTERVALLO OSSATURA 711 m/m

NB: IL PRESENTE DISEGNO
ANNULLA E SOSTITUISCE I
DISEGNI N° N/3675 - N/3707

NB: CONTORNI, TESTATE E CHIMENTI DELLE PARETI ESISTENTI DOVRANNO ESSER RESI STAGNI MEDIANTE SALDATURA ELETTRICA.

Plan No. 3708 approved 1.12.56
to be adhered to,

FLASH POINT OF OIL FUEL TO BE ABOVE 65.5° C. AND REMAINING REQUIREMENTS OF SECTION 20 OF THE RULES, WHERE APPLICABLE, TO BE COMPLIED WITH.



Pfe BLUEBELL © 2020 30-XI-56 1:2
STRUTTURE CASSE NAFTA N/3711

003788-003799-0085

2.2. "BLUEBELL"

TRIESTE Hgt. n.º 14537

O. F. site numbers

— . —
003788 - 003799 - 0085



© 2020

Lloyd's Register
Foundation