

8 AUG. 1924

No 123. (NORTHERN STEAMER)  
GENERAL ARRANGEMENT.  
T.S. PASSENGER & CARGO STEAMER.  
MAIN DECK & HOLD.  
DIMS: 218'0" x 37'0" x 13'6"  
SCALE: 1/8" = 1 FOOT.

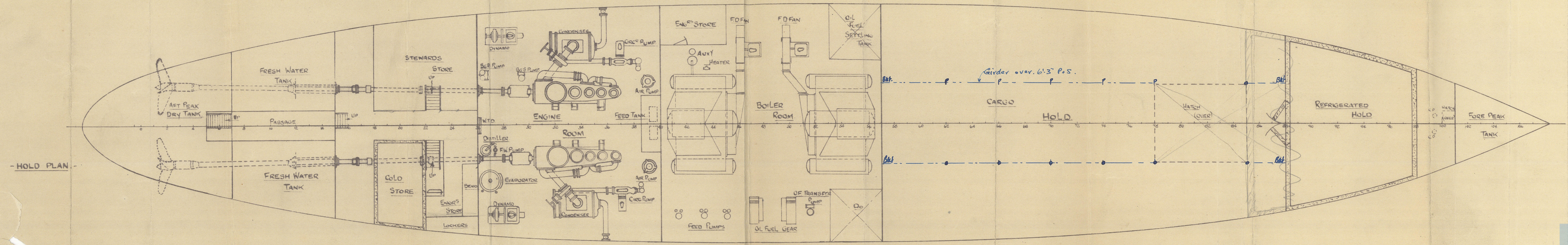

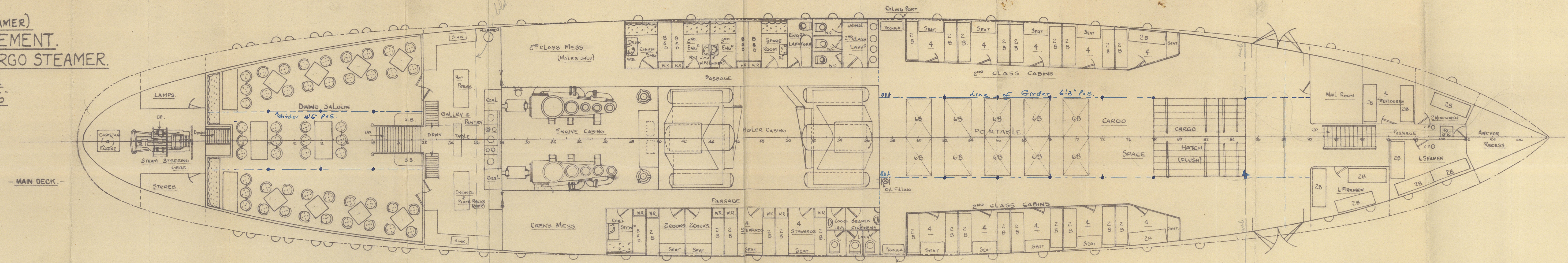

Coastal Const Co

123

Genl. Argyt.

Bag:

T.C. 19/11/24

Coastal Const Co.

123.

Genl. Argyt. Main Dk  
Main Dk & Hold & how.  
8.8.24

2. (c)