

PLAN  
LATEST  
Profile DK

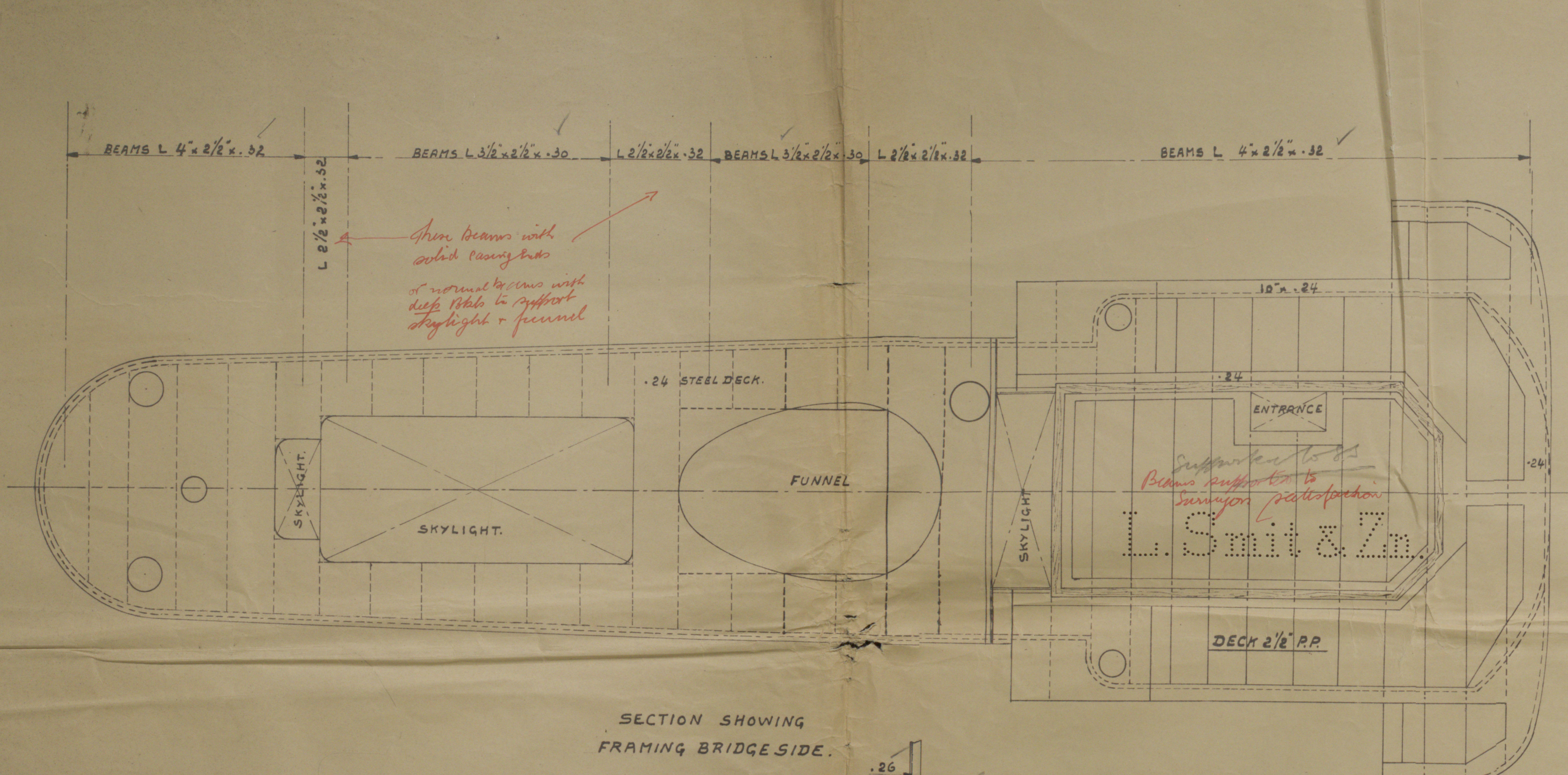

SECTION SHOWING FRAMING BRIDGE SIDE.

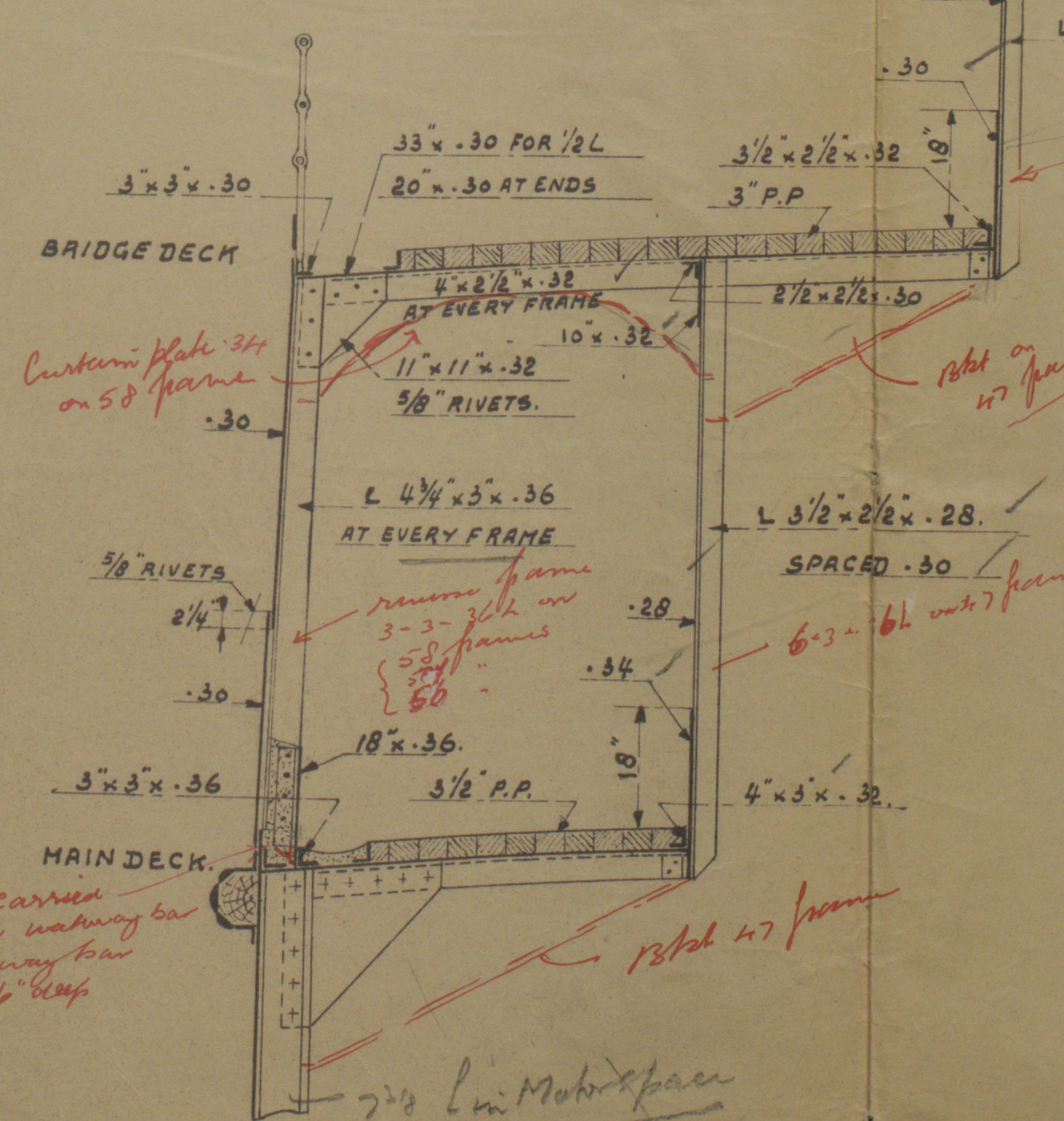

LONGITUDINAL SECTION OF A STEEL MOTOR SCREW TUG.

LOYD'S CLASS No. 100. A. 1. "FOR TOWING SERVICES."

DIMENSIONS:

LENGTH B.P.P.	60.10 M = 197.18 FT
BREADTH MLD	9.76 = 32.02
DEPTH	5.90 = 19.36

SCALE 1:50.

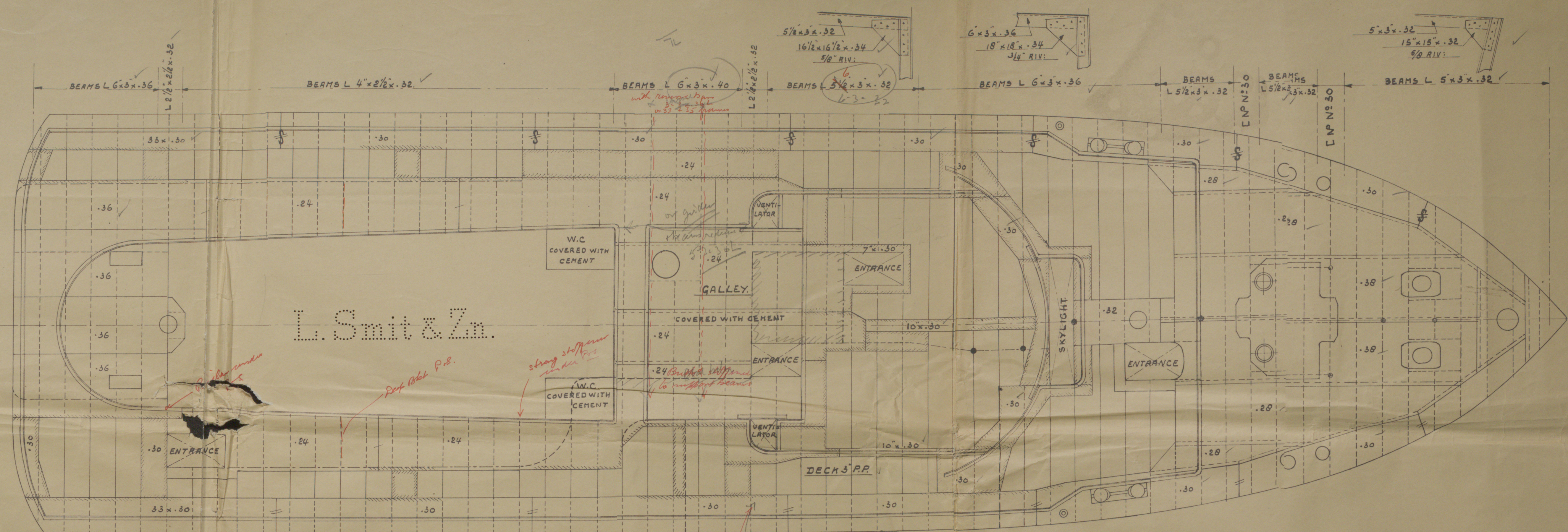

1<sup>st</sup> N = L x D = 197.18 x 19.36 = 3817.  
2<sup>nd</sup> N = L (B + D) = 197.18 (32.02 + 19.36) = 10131.  
3<sup>rd</sup> 197.18 : 19.36 = 10.19.  
B = 32.02  
D = 19.36

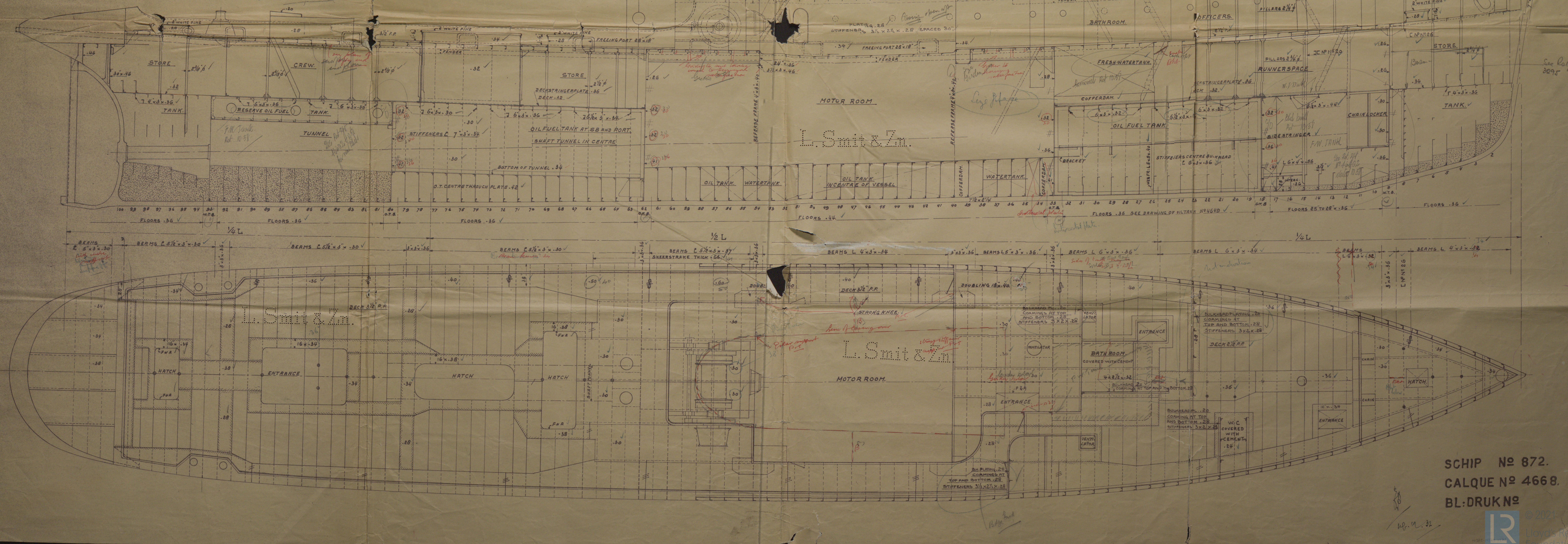

SCHIP No 872.  
CALQUE No 4668.  
BL: DRUK No





Profile & Decks

**'ZWARTE ZEE'**

GEN. BOX NO 1218



© 2021

Lloyd's Register  
Foundation

003712-003719-0272