

# Lloyd's Register of Shipping.

## SURVEYS FOR FREEBOARD.

### (CONDITIONS OF ASSIGNMENT.)

Ship's Name "SAINT EUNAN."Port of Survey GlasgowOfficial Number 115054Surveyor's Signature M. Macleod.Nationality and Port of Registry British. Sharn.Date of Survey Building(Temporary).

Disposition and dimensions of superstructures, trunks, deckhouses and machinery casings to be inserted in the diagrams and tabular statement:—

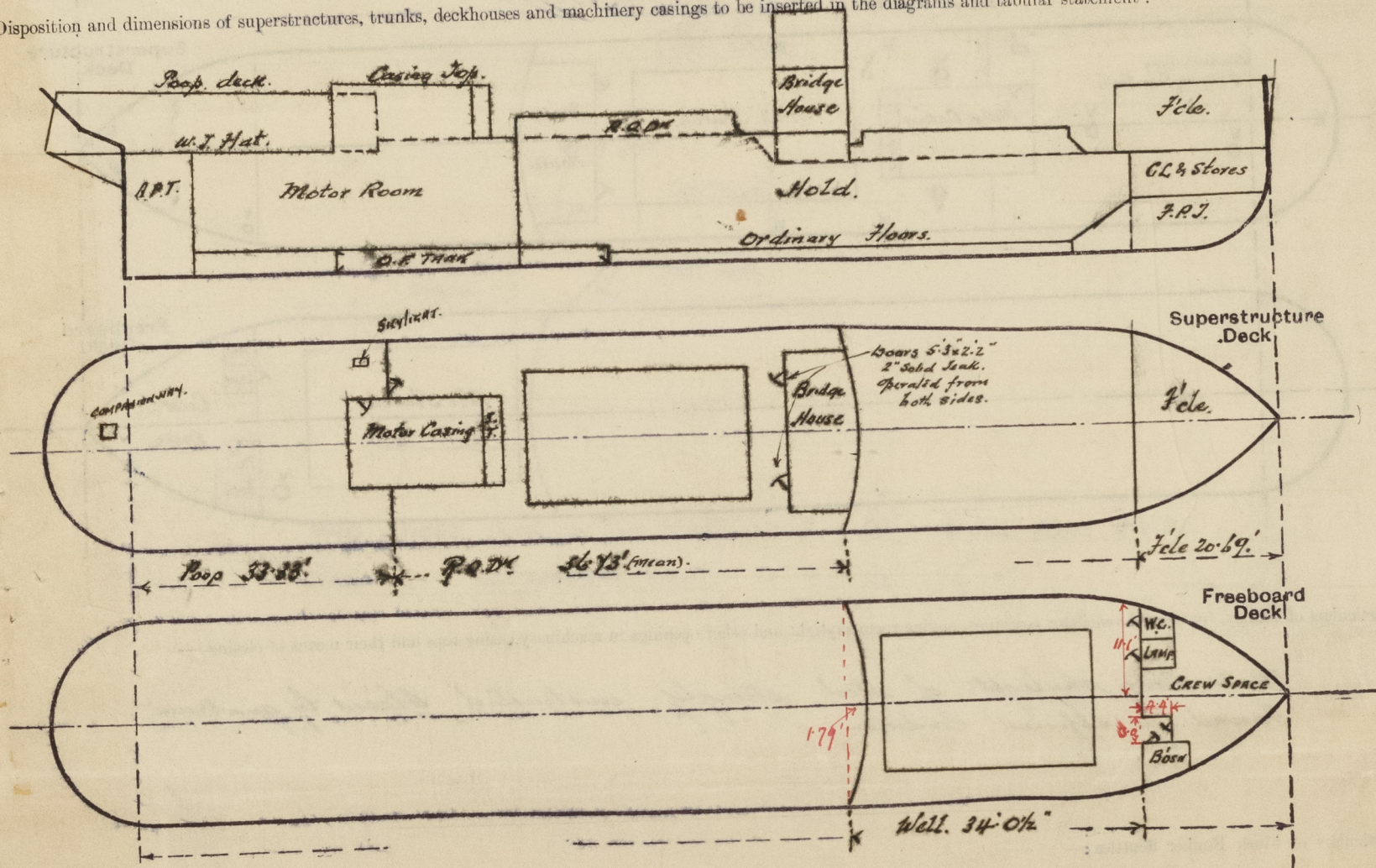

Particulars of Superstructures, Trunks, Casings, Deckhouses.

	Coaming	Plating	Stiffeners	Spacing	End Attachments of Stiffeners	Size of Openings	Height of Sills	Height of Casings
Poop Bulkhead ...	Plating	30	5x3x30 BR	24 1/2 x 33	RIVETED TO BOUNDARY BAR AT TOP WELDED TO DECK AT BOTTOM	DOOR 4'6" x 2'0" WINDOW 1'8" x 1'1"	18" 22"	✓
Raised Quarter Deck Bulkhead ...	"	30	5x3x30 BR	25 1/2 x 30	LOADED AT TOP WELDED TO DECK AT BOTTOM	NONE	"	✓
Bridge, After Bulkhead ...	✓							
Bridge, Forward Bulkhead ...	✓							
Forecastle Bulkhead ...	Plating	20	2 1/2 x 2 1/2 x 36	21 1/2 x 31	RIVETED TOP & BOTTOM TO BOUNDARY BAR	2 DOORS 5'2" x 2'0" 1 DOOR 5'3" x 2'0"	12" 12"	
Trunk, Aft ...	✓							
Trunk, Forward ...	✓							
Exposed Machinery Casings on Freeboard or Raised Quarter Decks ...	Plating	30	3 x 2 1/2 x 28 & 5 x 3 x 40 BR	25 to 32	BRACKETED AT TOP RIVETED TO BOUNDARY BAR AT BOTTOM	NONE	"	6'3"
Exposed Machinery Casings on Superstructure Decks ...	✓							
Machinery Casings within Superstructures not fitted with Class I Closing Appliances ...	Plating	30	3 x 2 1/2 x 28 L	29"	Bracketed at top and connected to ground bar at 5'0" x 2'0" bottom		18"	7'0"
Deckhouses on Flush Deck Ships ...	✓							

Particulars of Closing Appliances (state if capable of being manipulated from both sides).

Poop Bulkhead ...	SOLID TEAK DOOR 2" THICK. TO PASSAGEWAY ENTRANCE TO ENGINE ROOM. OPERATED FROM BOTH SIDES. SPARRED WINDOW TO GALLEY WITH SLIDING WOOD SHUTTER OF SUBSTANTIAL CONSTRUCTION WHICH CANNOT BE REMOVED FROM BULKHEAD. SLIDING GLASS PANEL ON INSIDE.
Raised Quarter Deck Bulkhead ...	No opening
Bridge, After Bulkhead ...	✓
Bridge, Forward Bulkhead ...	✓
Forecastle Bulkhead ...	✓
Exposed Machinery Casings on Freeboard or Raised Quarter Decks ...	TWO SOLID TEAK DOORS 2" THICK. TO W.C. & FORECASTLE SPACE OPERATED FROM BOTH SIDES. ONE STEEL DOOR 2" THICK. TO LAMP ROOM OPERATED FROM BOTH SIDES.
Exposed Machinery Casings on Superstructure Decks ...	✓
Machinery Casings within Superstructures not fitted with Class I Closing Appliances ...	✓
Deckhouses on Flush Deck Ships ...	✓

## PARTICULARS OF PROTECTION TO OPENINGS, ETC.

The following diagrams should be used to indicate the positions of cargo and coaling hatchways, gangway, cargo and coaling ports, ventilators, companionways, etc., which would affect the seaworthiness of the ship:—

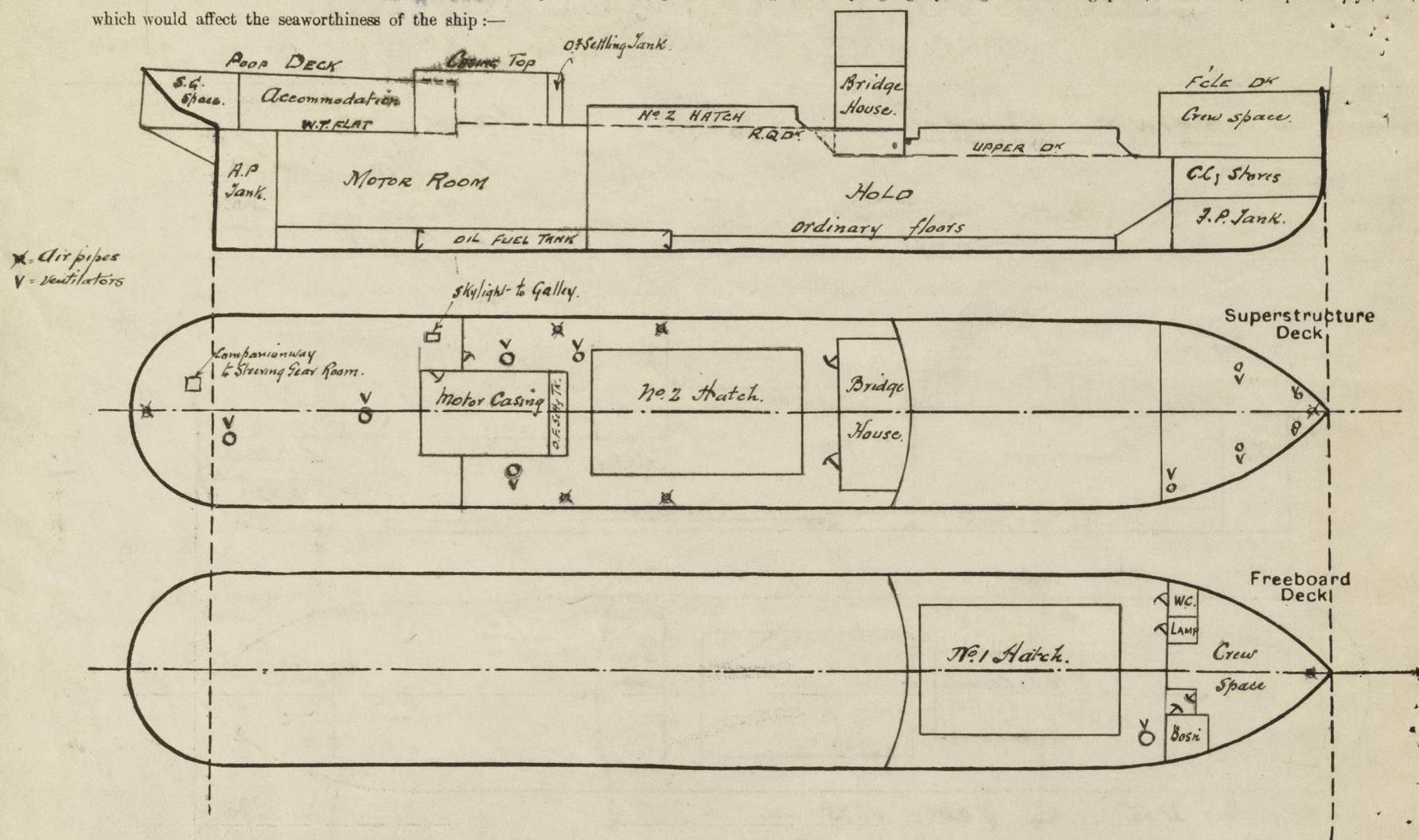

Particulars of fiddle, funnel and ventilator coamings, engine room skylight and other openings in machinery casing tops and their means of closing:—

*Motor room skylight of steel strongly constructed. Closed by quadrant  
Funnel in efficient condition.*

Particulars of Flush Bunker Scuttles:—

*NONE.*

Particulars of Companionways:—

*Poop Deck.*

*Companionway to Steering Gear Space of steel strongly constructed. 2" solid teak doors operated from both sides  
canvas cover supplied. 18" x 9" sill.*

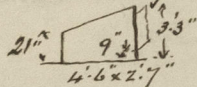

*Skylight of steel (to Galley) 2' 6" x 1' 3". Steel hinged flaps. Canvas cover supplied.*

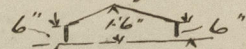

*closed by quadrant.*

Particulars of Ventilators in exposed positions on freeboard and superstructure decks:—

*Forecastle deck:— Two 6" cowl vents 36" x 30" to crew space.  
Three 6" mushroom vents 30" with screw down tops.*

*Upper deck:— One 15" cowl vent 36" x 40" to Hold.*

*Raised Qr. deck:— One 15" cowl vent 36" x 40" to Hold.  
Two 15" cowl vent 30" x 3/8" to Motor Room.*

*Poop deck:— Two 6" cowl vents 30" x 30" to Accommodation.*

*Ventilators constructed in accordance with rule requirements  
Wood plugs and canvas covers supplied.*

Particulars of Air Pipes in exposed positions on freeboard, raised quarter, or superstructure decks:—

*Forecastle deck:— One 3" dia. 18" high to Iron peak Tank.*

*Raised Qr. dk:— Four 2 1/2" dia. 30" high to O.F. Tanks.*

*Poop dk:— One 3" dia. 18" high to A.P. Tank.  
Canvas covers supplied.*



© 2020

Lloyd's Register  
Foundation

Particulars of Gangway Cargo and Coaling Ports:—

None.

Particulars of Scuppers and Sanitary Discharge Pipes:—

All scupper and sanitary discharge pipes are fitted with non-return valves on ships side & efficient traps at inner end.

Particulars of Side Scuttles:—

Scuttles to crew's Accommodation spaces above freeboard deck fitted with hinged (M.C.I.) deadlights.

Vertical distance of Sill of lowest Side Scuttle above top of keel 18' 9"

Particulars of Guard Rails:—

Forecastle deck Two rails 36" high. Stanchions 4' 6" apart.  
 Poop deck Two rails 36" " " 4' 6" "  
 Raised Quarter Deck: Stbd Bulwarks 3' 3 1/2" high efficiently constructed & supported.  
 Well or Ford: do: 3' 6 1/2" do: do:

Particulars of Gangways, Lifelines, etc.:—

Lifelines as required by rule  
 Gangway to Hatch. with portable stanchions.

Particulars of Freeing Arrangements.						
	Length of Bulwark	Height of Bulwark	Size of Freeing Ports	Number each side	Area each side	Rule area each side
After Well ... R.D.O.T.	55' 6 1/2"	3' 3 1/2"	7' 0" x 8"	Three	13.986 sq. ft.	12.05 <del>sq. ft.</del>
Forward Well ...	34' 0 1/2"	3' 6 1/2"	<del>4' 6" x 8"</del> 7' 6" x 12" x	Two	9.99 sq. ft.	9.9 <del>sq. ft.</del>
State position of each freeing port ...	measured from fore end of each well. to fore end of each port.					
(F. and A. position and height above deck edge)	After Well:— 8.75; 24.45; 40.45' Forward Well:— 6.45; 20.25'					
State whether the freeing ports are fitted with shutters, bars, or rails, and give particulars of such:—	none. & Horizontal bar fitted with 2 vertical supports					
Additional area where sheer is less than standard.						

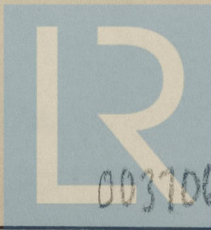

© 2020

Lloyd's Register  
 Foundation

003706-003711-00562

# PARTICULARS OF PROTECTION TO OPENINGS, ETC.

HATCHWAYS ON FREEBOARD AND SUPERSTRUCTURE DECKS.									
Description of Hatchway		WELL DECK No. 1.	R.Q. No. No. 2.						
Dimensions of Hatchway		22' 3 1/2" x 14' 0"	23' 3 1/2" x 14' 0"						
COAMINGS	Height above Deck	39"	36"						
	Thickness { Sides	40"	40"						
	{ Ends	40"	40"						
	Stiffeners	Self-Trimming	7 x 3 x 40 BR. afters only						
	Brackets, Stays	12 x 40 BR 3 off	12 x 40 BR 3 off						
HATCH BEAMS	Number	Three	Four						
	Spacing	5' 6 1/8"	4' 7 1/2"						
	Scantling and Sketch	7 1/2 x 13 x 32 plat 3 x 3 x 42 angles	do:						
	Bearing Surface	3"							
FORE AND AFTERS	Number								
	Spacing								
	Unsupported Lengths								
	Scantling* and Sketch	None.	✓						
	Bearing Surface								
HATCH COVERS	Material	Baltic Pine	do:						
	Thickness	2 1/2"	do:						
	How fitted	3 1/2"							
	Bearing Surface	3"							
Spacing of Cleats		24"	do:						
Number of Tarpaulins		Two.	do:						
<p>*Are wood fore and afters steel shod at all bearing surfaces? <i>yes.</i></p> <p>Are battens and wedges efficient and in good condition? <i>yes.</i></p> <p>Are tarpaulins in good condition and in accordance with rule requirements? <i>yes.</i></p> <p>Are lashings provided in accordance with rule requirements? <i>yes.</i></p>									

Particulars of any special features:—

Endorsement at first survey and at surveys for renewal of Certificate:—

The fittings and appliances are in accordance with the particulars shown on this form (or as now modified) and are in good condition.



© 2020  
Lloyd's Register  
Foundation