

# Lloyd's Register of Shipping.

## SURVEYS FOR FREEBOARD.

### (CONDITIONS OF ASSIGNMENT.)

19825.

Ship's Name *M.V. "GUERNSEY QUEEN"*Port of Survey *LEITH*Official Number *✓ 167240*Surveyor's Signature *G. PHAN*Nationality and Port of Registry *BRITISH - LONDON*Date of Survey *24<sup>th</sup> March + 18<sup>th</sup> April 1939*

Disposition and dimensions of superstructures, trunks, deckhouses and machinery casings to be inserted in the diagrams and tabular statement:—

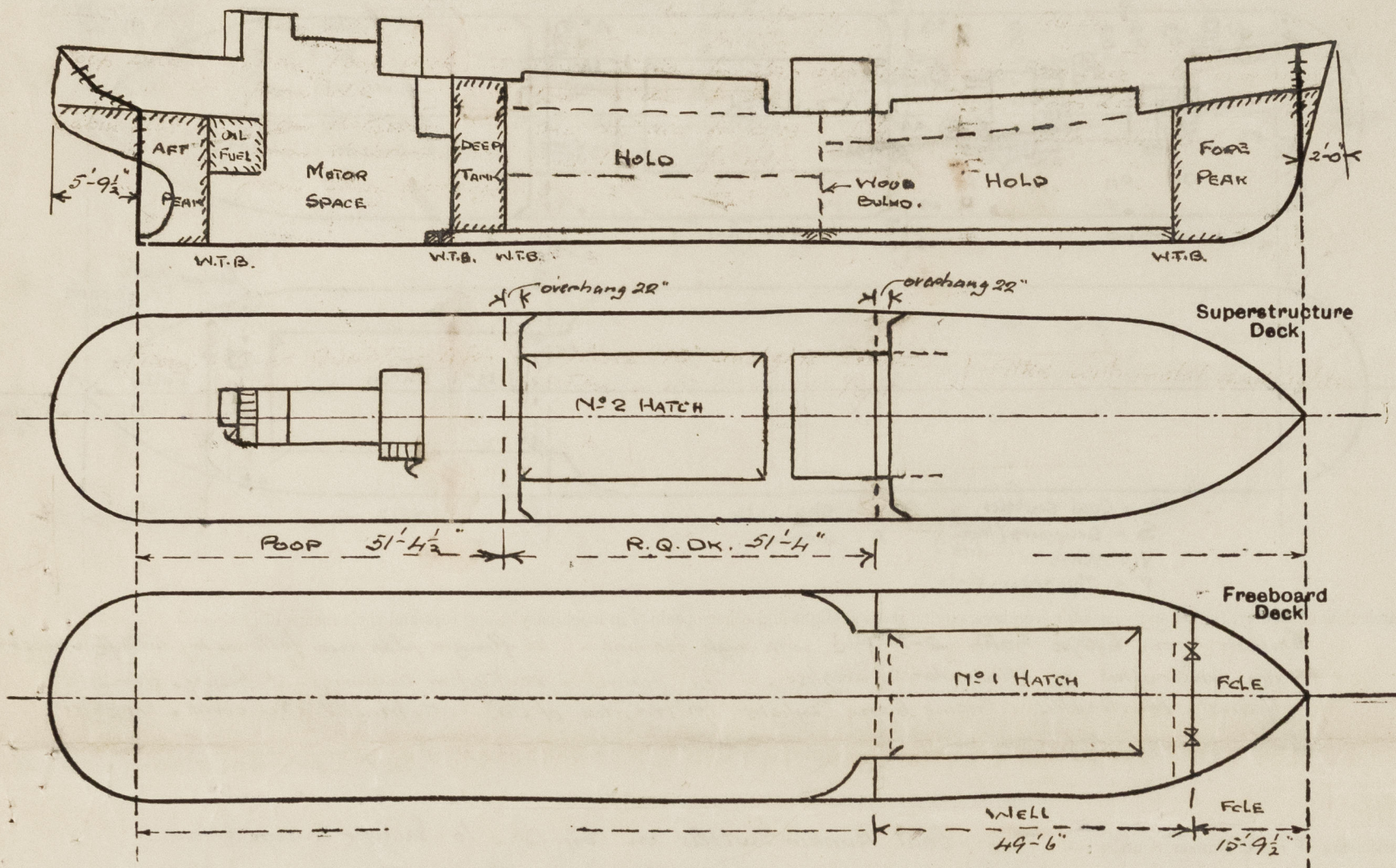

Particulars of Superstructures, Trunks, Casings, Deckhouses.								
	Coaming	Plating	Stiffeners	Spacing	End Attachments of Stiffeners	Size of Openings	Height of Sills	Height of Casings
Poop Bulkhead ...	✓ 30	30	Diaphragm	30"	✓	None	None	7'-0"
Raised Quarter Deck Bulkhead ...	✓ 30	30	Diaphragm	30"	✓	None	None	4'-3"
Bridge, After Bulkhead ...	✓							
Bridge, Forward Bulkhead ...	✓							
Forecastle Bulkhead ...	✓ 20	20	3 x 2 1/2 x 29 L	30"	Riveted to Body Bars Aft stiffeners bolted to deck	Two 4'-0 1/2 x 3'-0 1/2"	15"	6'-0"
Trunk, Aft ...	✓							
Trunk, Forward ...	✓							
Exposed Machinery Casings on Freeboard or Raised Quarter Decks ...	✓							
Exposed Machinery Casings on Superstructure Decks ...	✓ 26	26	3 x 3 x 32 L	32"	Bolts at top Continuous at bottom	Two Doorways to Cabin Flat 4'-6" x 1'-10" 4'-9" x 2'-0"	18" above wood dk	5'-6" 7'-0" + 6'-6" in way of doorways
Machinery Casings within Superstructures not fitted with Class I Closing Appliances ...	✓							
Deckhouses on Flush Deck Ships ...	✓							

Particulars of Closing Appliances (state if capable of being manipulated from both sides).

Poop Bulkhead ...	None No Openings
Raised Quarter Deck Bulkhead ...	None No Openings
Bridge, After Bulkhead ...	✓
Bridge, Forward Bulkhead ...	✓
Forecastle Bulkhead ...	Stormboards fitted full height in riveted channels
Exposed Machinery Casings on Freeboard or Raised Quarter Decks ...	✓
Exposed Machinery Casings on Superstructure Decks ...	2 Doors of hardwood to Cabin Flat - Can be manipulated from both sides
Machinery Casings within Superstructures not fitted with Class I Closing Appliances ...	✓
Deckhouses on Flush Deck Ships ...	✓



Particulars of Freeing Arrangements.						
	Length of Bulwark	Height of Bulwark	Size of Freeing Ports	Number each side	Area each side	Rule area each side
R.Q. 9k After Well ... ..	51'-4"	3'-6"	$\left\{ \begin{array}{l} 10'-4" \times 8" \\ 11'-0" \times 8" \end{array} \right.$	2	14.48 sq ✓	11.63 sq ✓
Forward Well ... ..	49'-6"	3'-6"	$\left\{ \begin{array}{l} 16'-6" \times 8" \\ 8'-6" \times 8" \end{array} \right.$	2	14.65 sq ✓	11.45 sq ✓

State position of each freeing port ... .. (F. and A. position and height above deck edge)

State whether the freeing ports are fitted with shutters, bars, or rails, and give particulars of such:

Additional area where sheer is less than standard.

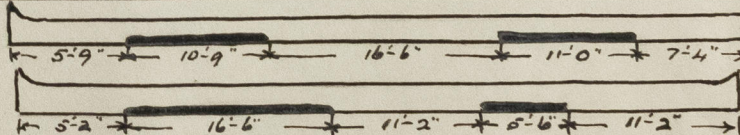
After Well :- 

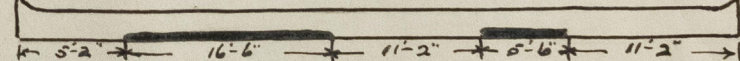
Forward Well :- 

Openings 8" wide - no shutters or bars ✓

Openings 4" above deck edge



© 2020  
Lloyd's Register



# PARTICULARS OF PROTECTION TO OPENINGS, ETC.

HATCHWAYS ON FREEBOARD AND SUPERSTRUCTURE DECKS.									
Description of Hatchway		Upper Deck	RO DE	Escape hatch for	W.T. hatch to Deep Tank				
Dimensions of Hatchway		38'-6" x 17'-6"	36'-8" x 17'-6"	2'-0" x 1'-10"	18 1/2" dia.				
COAMINGS	Height above Deck	4'-3 1/2" - 10'	3'-7"	2'-6"	8"				
	Thickness	4 1/4"	4 1/4"	3/8"	3/8"				
	Sides	4 1/4"	4 1/4"	3/8"	3/8"				
	Ends	4 1/4"	4 1/4"	3/8"	3/8"				
Stiffeners		see sketch	see sketch						
	Brackets, Stays	4" plate	4" plate						
HATCH BEAMS	Number	5	5						
	Spacing	6'-5 3/8"	6'-2 1/2"						
	Scantling and Sketch	4"x3"-43	4"x3"-43	None	None				
	Bearing Surface	3 1/2"	3 1/2"						
FORE AND AFTERS	Number								
	Spacing								
	Unsupported Lengths								
	Scantling and Sketch	None	None	None	None				
HATCH COVERS	Material	W.W.	W.W.	W.W.	Battled plate cover				
	Thickness	3"	3"	2 1/2"	3/8"				
	How fitted	Fore + aft	Fore + aft	Fore + aft	3/8"				
	Bearing Surface	4" x 3"	4" x 3"	2 1/2"	3 1/2"				
Spacing of Cleats		24"	24"	None 12"	None				
Number of Tarpaulins		Two	Two	Two	None				
<p>*Are wood fore and afters steel shod at all bearing surfaces? <i>None</i></p> <p>Are battens and wedges efficient and in good condition? <i>Yes</i></p> <p>Are tarpaulins in good condition and in accordance with rule requirements? <i>Yes</i></p> <p>Are lashings provided in accordance with rule requirements? <i>Yes</i> - Ringbolts provided each side of hatchways for lashings + in addition at 1st hatchway independent wire rope lashings provided at each end of each section of the covers, set up with rigging screws</p>									

Particulars of any special features :—

Endorsement at first survey and at surveys for renewal of Certificate :—

The fittings and appliances are in accordance with the particulars shown on this form (or as now modified) and are in good condition.



© 2020

Lloyd's Register Foundation