

25/7/33.

1-9-33 N° 582.
6-9-33 N° 587.

STERNFRAME N° 578-9-80 & 81.

SCALE $\frac{3}{4}'' = 1 \text{ FOOT.}$

6 N° 582.
6 N° 587.
6 N° 590.

HOLES PITCHED $1\frac{1}{4}''$ & $2''$ FROM INNER EDGE OF POST

HOLES DRILLED FOR $1''$ DIA RIVETS 5 DIAS APART

MATERIAL TO BE FORGED SCRAP STEEL

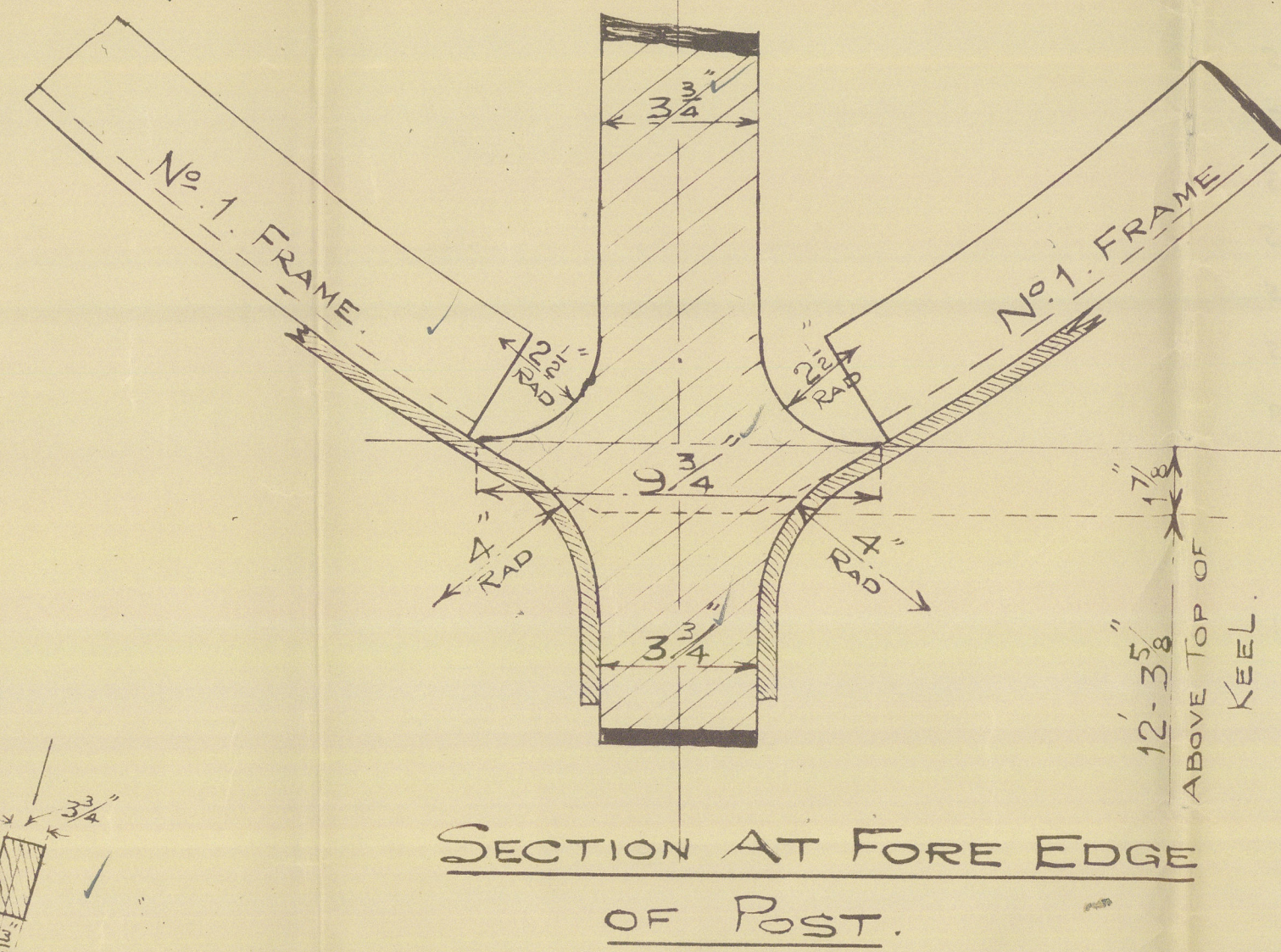
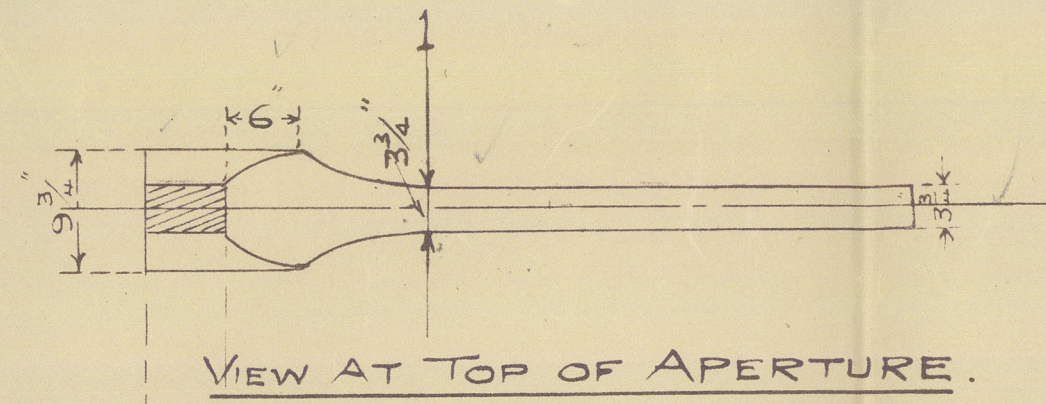

TOP & MIDDLE GUDGEON

SCALE $3'' = 1 \text{ FOOT.}$

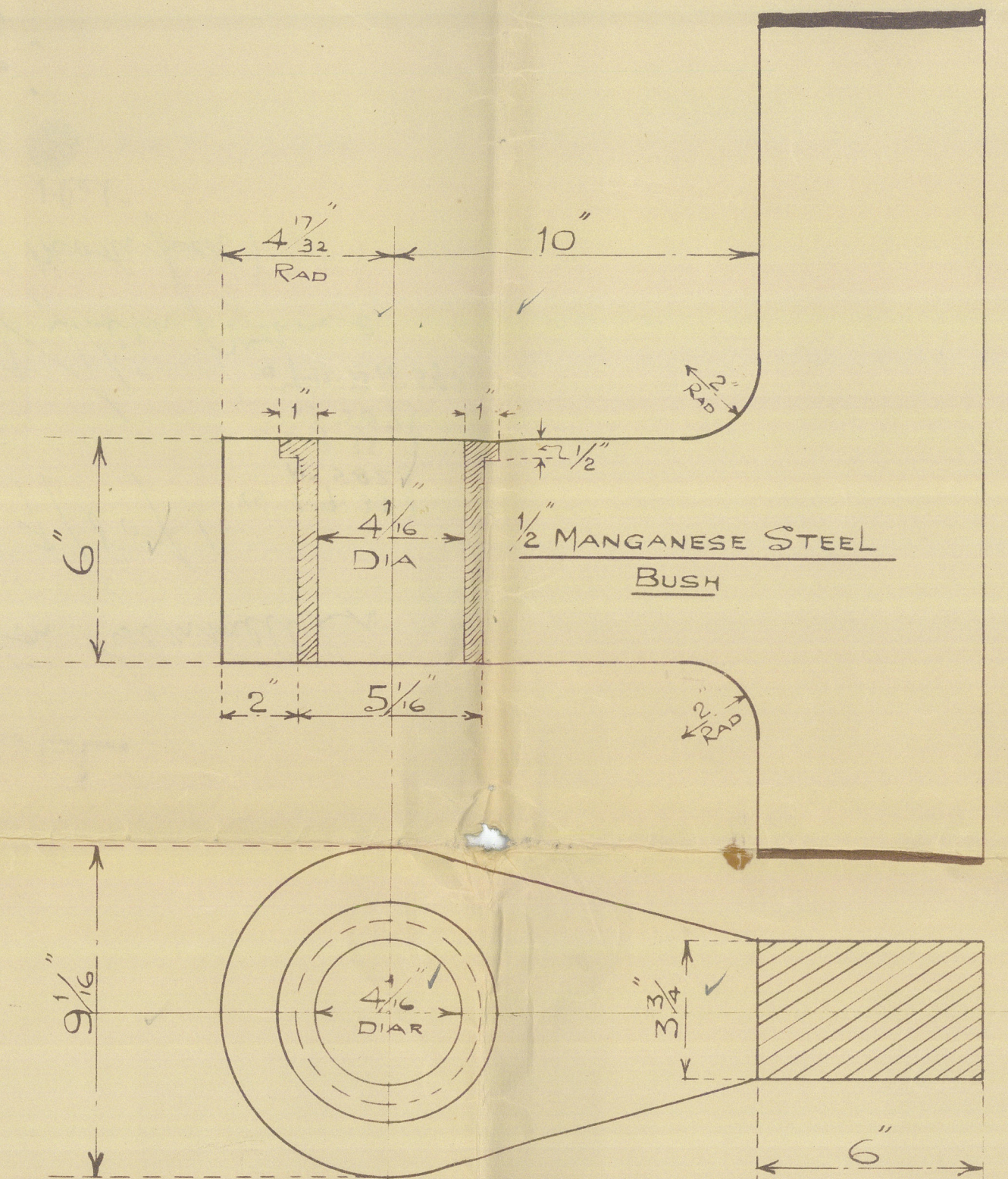

COOK WELTON & GEMMELL LTD
SHIPBUILDERS
BEVERLEY.

APPROVED By LLOYDS 17-7-33

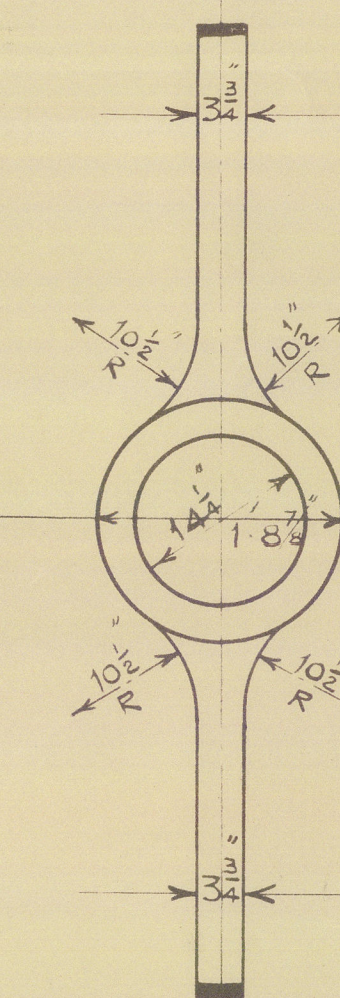

NOTE - HOLE BORED EXACTLY TO SIZE GIVEN VIZ - $14\frac{1}{4}''$

N.B. CENTRE OF BOSS SLOPES SLIGHTLY TO KEEL.

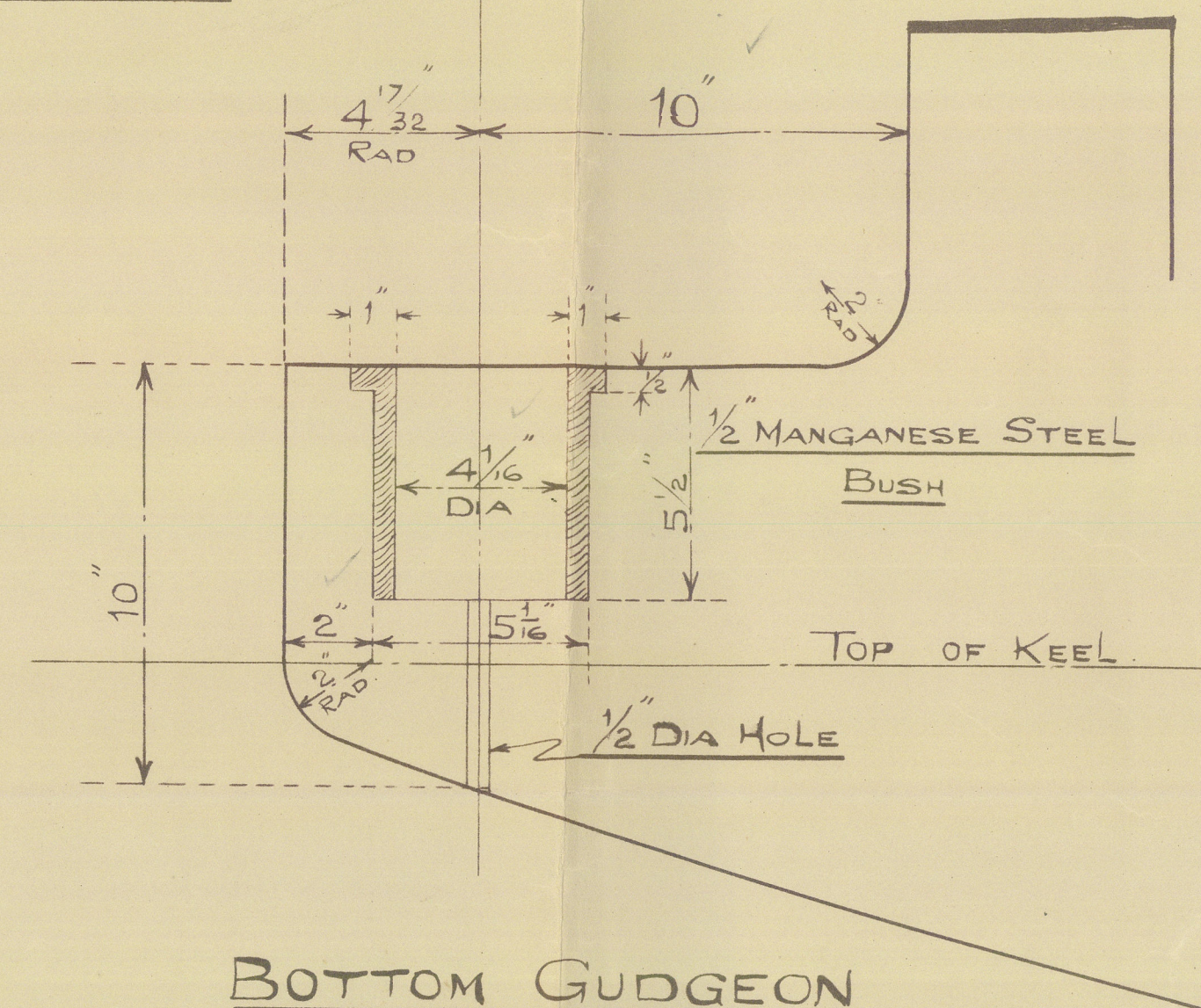

SEPARATE PLAN SUBMITTED

STERN POST GUDGEONS TO BE FACED

TOP OF KEEL.

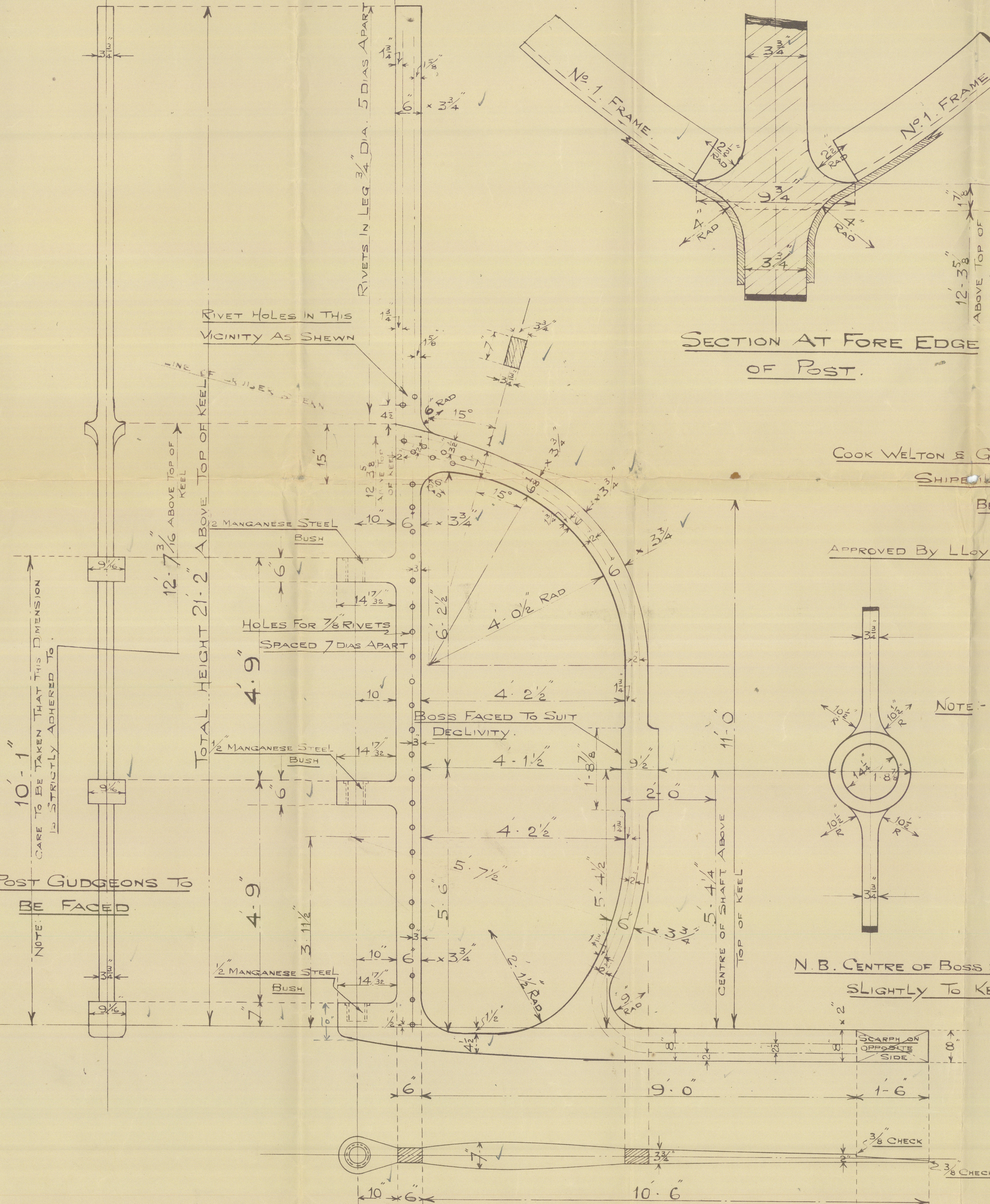

15. 7. 33

HULL

book, Welton & Gemmell Lr

578 / 9 / 80 / 1.

6 1-9-33 }
N: 582.

6 6-9-33 }
N: 587.

6 7-12-33 N: 590.

Print of Stein frame
(notified)

Red Gauntlet

- 578 Arab ^{ex}  now Cedar
- 579 "Lorenzo"
- 580 "Picador"
- 581 "Basque"
- 582 "Lock Seaforth"
- 587 "Dervish"
- 590 "Bronze"

Transferred to Reptonian
W.S. 526

~~D. 1140~~



© 2020

Lloyd's Register
Foundation

003671-003678-0001