

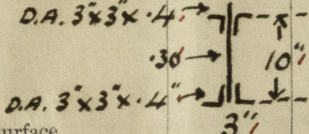

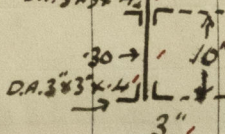
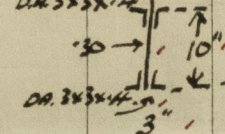

## PARTICULARS OF PROTECTION TO OPENINGS, ETC.

## HATCHWAYS ON FREEBOARD AND SUPERSTRUCTURE DECKS

Description of Hatchway	No 1.	No 2	No 3	COALING HATCH ON BOAT DECK.
Dimensions of Hatchway	9'-10" L. 9'-10" B.	14'-0" 10'-1"	14'-0" 10'-2"	6'-0" 12'-0"
COAMINGS { Height above Deck ... Thickness { Sides ... Stiffeners ... Ends ... Brackets, Stays ...	.5' .5' none. none.	.5' .5' none. none.	.5' .5' none. none.	.25' .25' 5"x3"x.34 OR.
HATCH BEAMS { Number ... Spacing ... Scantling and Sketch ... Bearing Surface ...	one. 4'-11"  D.A. 3'x3'x.4" 3"	two. 4'-8"  D.A. 3'x3'x.4" 3"	two. 4'-8"  D.A. 3'x3'x.4" 3"	
FORE AND AFTERS { Number ... Spacing ... Unsupported Lengths ... Scantling* and Sketch ... Bearing Surface ...	none. none. none. none. none.	none. none. none. none. none.	none. none. none. none. none.	two 4'-0" 7'x3x.4' B.A. RIVETED TO ENDS.
HATCH COVERS { Material ... Thickness ... How fitted ... Bearing Surface ...	W.P.N.E. 2 1/2" F.T.A. 3"	W.P.N.E. 2 1/2" F.T.A. 3"	W.P.N.E. 2 1/2" F.T.A. 3"	STEEL HINGED COVERS SECURED BY HINGED BOLTS! F.T.A. 2 1/2"
Number of Cleats	22"	23"	22 1/2"	none ✓
Number of Tarpaulins	3.	3.	3.	none

Are wood fore and afters steel shod at all bearing surfaces? *yes.*  
Are battens and wedges efficient and in good condition? *yes.*  
Are the fore and afters secured to the hull with rule requirements? *yes.*  
Are the fore and afters secured to the hull with rule requirements? *yes.*

Stokehold gratings covered by strong steel  
key and funnel ventilators in efficient  
skylight of steel strongly constructed.

Particulars of Companionways:— One steel companion 3'-11" x 2'-8" x 6'-2" high, on fore-castle deck leading to enclosed fore-castle, doorway 2'-0½" x 4'-10" sill 12"; door wood 1½" thick, operated from both sides. Aft deck house, companionway door 1'-11½" x 5'-2½" sill 12". Door of steel 26' operated from both sides, leading to open poop.

Particulars of Ventilators in exposed positions on freeboard and superstructure decks :—

Particulars of Ventilators in exposed positions on freeboard and superstructure decks :-					led to		No 1 Hold.	
one	Vent.	on forecastle deck	16" dia coaming	3' x 4'			No 1	HOLD.
two	"	" Shelter	24" "	3'-1" x 4'	"	"	No 2	" TWEEN DECK.
one	"	" Bridge deck, P.	15" "	20½" x 4'	"	"	" 2	"
two	"	" Top, "	24" "	4'-0" x 4'	"	"	" 2	"
one	"	" Bridge "	P 15" "	2'-7" x 4'	"	"	" 3	"
one	"	" Poop, "	15" "	2'-7" x 4'	"	"	" 3	"
one	"	" "	12" "	2'-7" x 3½'	"	"	"	TUNNEL.
All vents are constructed in accordance with Rules and closed with wood plugs & canvas covers.								

Particulars of Air Pipes in exposed positions on freeboard, raised quarter, or superstructure decks:—

Particulars of Air Pipes in exposed positions on freeboard, raised quarter, or superstructure decks :—					
C.I.	air pipe on forecastle deck	20"	high	3" dia.	from fore peak.
"	"	21"	"	3"	No 1. D.B. Tank.
W.I.	" under Bridge deck.	6'	"	3"	No 2. " "
"	"	6'	"	3"	FEED TANK.
"	"	6'	"	3"	No 3. D.B. Tank.
"	"	6'	"	3"	aft peak.
"	"	21"	"	3"	"
all air pipes are closed with wood plugs.					

Particulars of Gangway Cargo and Coaling Ports :—

Particulars of Gangway Cargo and Coaling Ports:—

No. 1	Gangway door	8' wide	sill 18"	P. and S.	in way of	No. 1 hatch	efficiently constructed and
No. 2	"	9'-10"	" 10"	" " " "	"	No. 2 "	secured by strongbacks.
No. 3	"	9'-10½"	" 10"	" " " "	"	No. 3 "	do. do. do.
one weather-tight coaling door 2'-11" x 6'-1" sill 8" P. and S. in bridge sides efficiently constructed.							



9 JAN 1936

[illegible]

Particulars of Side Scuttles:

Particulars of Side Scuttles: No side scuttles below foreboard deck.  
Side scuttles to crew's spaces in forecabin are provided with hinged deadlights and are of substantial construction.

Particulars of Guard Rails:— Steel bulwarks on forecastle 3'-8" high, bridge 3'-9" high efficiently constructed and supported. Guard rails on shelter & poop, 3'-4" high with five rods and stanchions spaced 4 ft apart.

Particulars of Gangways, Lifelines, etc.:—Gangways fitted from poop to bridge and bridge to shelter and shelter to fore-castle. efficiently supported, having stanchions spaced 4 ft fitted with rod at top and two chains, on each side.

	Length of Bulwark	Height of Bulwark	Size of Freeing Ports	Number each side	Area each side	Rule area each side
Starboard Well ... <i>None</i> ...						
Forward Well <i>None</i> ...						

State position of each freeing port ... } After Well :—  
(F. and A. position and height above deck edge) } Forward Well :—

State whether the freeing ports are fitted with shutters, bars, or rails, and give particulars of such :—

Additional area where sheer is less than standard.

	Coaming	Plating	Stiffeners	Spacing	End Attachments of Stiffeners	Size of Openings	Height of Sills	Height of Casings
Poop Bulkhead ... ..	✓							
Raised Quarter Deck Bulkhead ...	✓							
Bridge, After Bulkhead ... ..	✓							
Bridge, Forward Bulkhead ... ..	✓							
Forecastle Bulkhead ... ..	none	.25	3" x 3" x .3	AVERAGE 2 1/2" - 3"	none	2' x 5'-6"	12"	8'
Trunk, Aft ... ..	✓							
Trunk, Forward ... ..	✓							
Exposed Machinery Casings on Free- board or Raised Quarter Decks ...	✓							
Exposed Machinery Casings on Super- structure Decks ... ..	none	.3	3" x 2 1/2" x .3	AVERAGE 2 1/2" - 4"	BRACETS TOP	2' x 5'-2"	12"	8'
Machinery Casings within Superstruc- tures not fitted with Class I Closing Appliances ... ..	none	.26	3" FLANGES AND 3" x 2 1/2" x .26	2 1/2"	DO.	3' x 3' 2' x 5'-2"	36" 18"	7'-6"
Deckhouses on Flush Deck Ships ...	✓							

Poop Bulkhead	✓
Raised Quarter Deck Bulkhead	✓
Bridge, After Bulkhead	✓
Bridge, Forward Bulkhead	✓
Forecastle Bulkhead	Door 2' x 5'-6" sill 12" wood door 1 3/8" thick operated from both sides.
Exposed Machinery Casings on Free-board or Raised Quarter Decks	Stokehold doors P & S. 2' x 5'-2" sill 12" steel door operated from both sides.
Exposed Machinery Casings on Superstructure Decks	Engineroom " " 2' x 5'-2" " 12" " " " "
Machinery Casings within Superstructures not fitted with Class I Closing Appliances	Stokehold door 2' x 5'-2" " 15" " " Coaling door 3' x 3' sill 36" secured by turnbuckles.
Deckhouses on Flush Deck Ships	✓



*Laid down*

Superstructure bulkheads, trunks, deckhouses, casings, cargo and coaling hatchways, extent and thickness of sheathing on the freeboard deck, gangway, cargo and coaling ports, and any other openings, etc., which would affect the seaworthiness of the ship are to be shown on the following sketches:—

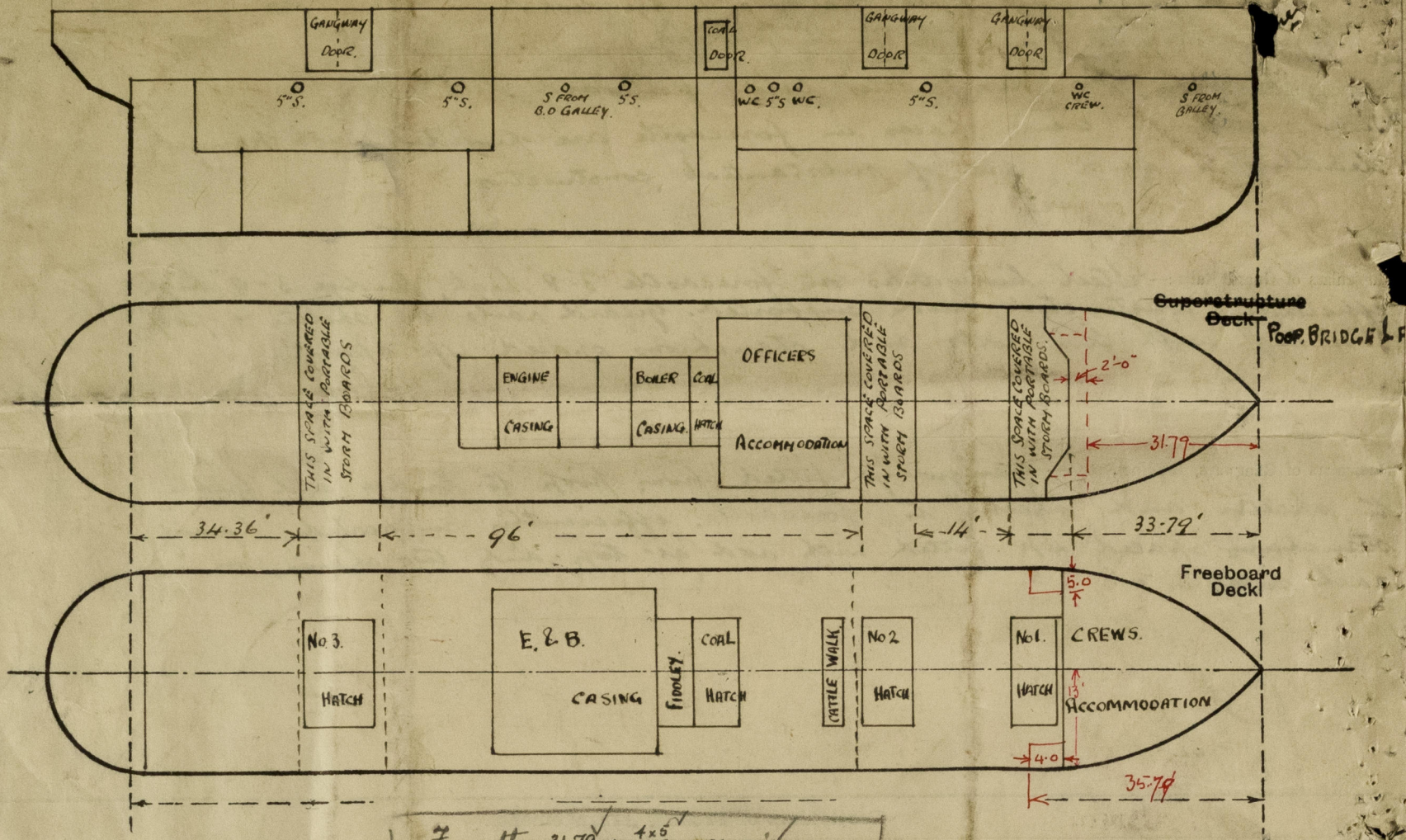

$$\text{Forecastle } 31.79 + \frac{4 \times 5}{13} = 33.33$$

$$\text{Overhang} = 33.79 - 33.33 = .46'$$

State any special features in the construction of the ship:— Vessel examined in dry dock for condition Report No 4945 follows, when repairs completed.

Freeboard deck is covered with DECKFELT 1" thick.  
 at the fore end of the bridge on the freeboard deck there is a cattle walk leading to the tween decks, doorway 3'-5" x 5'-8" folding sill 3ft, secured by secured pins also butterfly hinged bolts.

Moulded Displacement at 85% of Moulded Depth.	=	1840 TONS.
External	" 15 ft draught.	= 1975 "
"	" 14 "	= 1825 "
"	" 13 "	= 1625 "
Tons per inch.	" 15 "	= 14.4
"	" 14 "	= 14.1
"	" 13 "	= 13.85

*omit*

Builder's name and yard number DUBLIN DOCKYARD CO. VICINERS (IRELAND) LD. No 146  
 Names of sister ships \_\_\_\_\_  
 Owners SLIGO STEAM NAVIGATION CO. LTD. SLIGO.  
 Fee £ 6 : 16 : 0 Received by me \_\_\_\_\_