

Rpt. 8

Date of writing Report 24 June 1959

When handed in at Local Office 25th June 1959

Port DJAKARTA

No. 5619

Received London

8 JUL 1959

Survey held at Tandjong Priok

No. of Visits 2

First Date 22 June 19 59

Last Date 23 June 19 59

REPORT OF SHIP SURVEYS AND REPAIRS

The Surveyor's attention is drawn to the relevant requirements of Chapters B & C of the Rules.)

No. in R.B.

69827

S.S.

on the Iron or Steel M.S.

M.V. "MACOMA"

Tons gross

8069

Built at

Amsterdam

By Whom

N.V. Nederl. Scheps. Mts.

When Year Month

1936-

5

Owners

N.V. Petroleum Mts. "LA CORONA"

Owners' address

(If not already in R.B.)

Managers

Shell Tankers

Port of Registry

The Hague

Surveyed Afloat or in Drydock

afloat

Name of Dock

Oil wharf

Date of last examn. in Drydock

N.B.—Any alterations in existing particulars in the Register Book should be reported and underlined.

Last Report: No.

12864

Port

Sng

To be filled in at Head Office.

Particulars of Classification (which must be inserted precisely as in Register Book and Supplement)

Surveys must be reported in the terms of the Rules. The nature and extent of Examinations and Repairs (if any) must be stated in detail, the parts examined and their condition being clearly indicated. For Annual, Special or other Condition Surveys the Summary of Examination and Condition on the back of the Report is to be carefully completed and amplified if necessary in the body of the Report. Outstanding items to complete the Survey should be summarised at the end of the Report. The reasons for Repairs must be stated. Repairs on account of Damage (the alleged cause of which must be stated) should be separated from Repairs due to other causes, and, besides being detailed in the body of the Report, should be summarised in the form below. When, at a Special Survey, the Shell and Deck Plating is drilled the results must be reported on Report 8(Dr). Whenever Anchors or Chain Cables are replaced or retested the necessary particulars are to be given on Report 8(Eq) which is to be attached to this Report.

Give dates and references to any letters relating to this Report

SHIP'S CLASS

Date of Special and of Drydocking Surveys, etc.

Machinery

± 100 A1	± LMC.CS	5,54
Carrying petroleum in bulk.	d	9,58
s.s. Ret. (Br)	TS(OL)	9,58
Dkg.	sps	5,54

oil engs

In damage cases where the Surveyor has not made a special damage report he should state whether he offered his services for this purpose and to whom and why they were declined.

not required

Freeboard as marked on ship and now verified

ft

ins

Was a damage report made by anyone else? If so, by whom?

no

EXAMINATION AND REPAIRS AS PER RULE FOR STEERING GEAR DEFECT

It was stated that the vessel left Pladju on the 18th June 1959 in loaded condition for Djakarta. Whilst passing through the Bangka Straits on the 20th June it was noticed that the Steering Gear was not operating efficiently when the helm was over 20° to port or stbd., and an excessive pressure showed on the gauges of the hydraulic rams. The Gear operated quite efficiently when the main engine was stopped.

NOW DONE:-

STEERING GEAR DEFECT: Steering Gear examined as far as possible under working conditions alongside the wharf and found satisfactory.

An underwater examination carried out by a Diver who removed a banana trunk from between the rudder post and leading edge of the rudder, in way of one of the gudgeons, and reported that there were no other defects visible.

The vessel left Tandjong Priok, the steering gear operated under full working conditions with main engine running (not attended by the undersigned) outside the harbour and reported satisfactory.

SRI (168): Nothing done towards indented shell plates at this time.

CONTINUATION OVER/OR SHEET 2

SUMMARY OF DAMAGE REPAIRS	Shell Plates	Frames	R. Frames	Floors and Bracket Floors	Inner Bottom Plates	Deck Plates	Beams	Other Items
Renewed								
Removed and Faired or Repaired								
Faired or Repaired in place								

Has a Survey also been held on machinery of the Ship?

no

Is Classification Certificate required? If so, to be sent to

If so, is the Report sent now, or when will it be sent?

Has Interim Certificate been issued?

yes

GENERAL OBSERVATIONS, OPINION AND RECOMMENDATION AS TO CLASS

State clearly what alteration, if any, is suggested to be made in the existing Classification or Survey or other records of the Ship in the Register Book consequent upon this survey; for example:—"to remain as Classed in the Register Book without fresh record of Docking"; "to remain as Classed and to have record of drydocking 1,55"; or "to remain as Classed and to have record of drydocking 1,55, and the notation of S.S. . . . 1,55".

This vessel so far as now seen is eligible in my opinion to remain as Classed, subject to indented plates G10, H10 (s.s.f) and wasted plates A.2, A3 (p.s.f) (locally doubled 9,58) being examined and dealt with as necessary at the next Special Survey.

J.A. Boater

Surveyor to Lloyd's Register of Shipping
(J.A. Boater).

Date of Committee

MONDAY 20 JUL 1959

Minute

Deferred for SS (by 10.59)
(Subject)

Noted
for
Header

30m.5.55

003649-003658-0049

© 2020

Lloyd's Register
Foundation

TABLE 1

PARTS OF THE SHIP AS INDICATED BELOW HAVE BEEN EXAMINED FOR		SURVEY		
Items	Now Examined	Tanks	Now Examined Internally	Now Tested
	YES NO or NONE			
Shell plating, sternframe and rudder cleaned, examined and recoated in drydock		F.P. Tank		
Rudder lifted		A.P. "		
Weather Decks, Superstructures and Casings		D.B. Tanks (indicate Oil Fuel and Cofferdams		
Hatchways, Covers, closing and securing appliances				
Ventilator coamings, skylights, companionways and closing appliances		Fresh Water Tanks		
Holds		Deep Tanks		
		Oil Fuel Bunkers and Settling Tanks		
'Tween Decks		Side Tanks		
		Wing Tanks		
Fore Peak Spaces		Other Tanks		
After " "				
Engine Space		Cargo Tanks (Tankers)		
Boiler "				
Under Engines and Boilers				
Tunnel and Well		Cofferdams		
Coal Bunkers		Pump Rooms		
Chain Locker				
Other Spaces				
		Have Tanks now Examined been Cleaned as Necessary?		
		Have Struts in Cargo Tanks (of Tankers) been removed?		
		Have Tanks been Retested as necessary after completion of any Repairs?		

Have the spaces now surveyed been cleared and cleaned as necessary?

Have the close ceiling and cargo battens, linings, pipe casings, etc., been removed and replaced as required by the Rules?

Have the bilges been cleaned out and examined? Has cement in bottom been examined?

Has steelwork had rust removed and afterwards been recoated as necessary?

Were inspection plugs or any insulation removed in insulated spaces for examination of steelwork?

Has a Load Line Survey been held? If so, state which

Have the shell and deck plating been drilled as per Rule? If so, Report 8(Dr) to be attached

Have any alterations to the approved scantlings and arrangements now been effected? If so, report details in body of Report.

NOTE:—Indicate which compartments and/or tanks have been examined or tested by giving the identification numbers and inserting the word "Yes", e.g. Holds: Nos. 1, 2 & 3—Yes; or All—Yes.

TABLE 2

The present condition of the following parts in so far as examined is to be reported:—		
Shell plating	Ceiling and Cargo Battens	Sluice Valves examined and found
" " in way of side scuttles	Cement or Asphalt	Air and Sounding Pipes
Rudder and Sternframe	Cargo and other Hatchways	Doubling Plates under Sounding Pipes
Decks	Hatches and closing appliances	Masts and Rigging examined and found
Superstructures and their closing appliances	Ventilators, their coamings and closing appliances	Condition, how ascertained (State if wedges removed)
Coamings and Casings	Companionways and Skylights	Chain Locker
Beams and Fastenings	Shell Openings	EQUIPMENT
Frames	Ash Shoots	Equipment Letter
Reverse Frames	Overboard Discharges and Scuppers	Anchors, No. of Condition
Longitudinals	Freeing ports	Cables (State if now ranged and examined)
Transverses	Steering Gear (Main and Auxiliary)	" length mean diam. (on board)
Floors	examined and found	" Rule Length Size
Kecisons	Windlass examined and found	Hawsers and Warps
Stringers	Pumps " " "	State if any Anchors or Chain Cable have
Inner Bottom Plating	W.T. Doors " " "	now been supplied or retested, if so,
Bulkheads and Tunnel		complete Report 8(Eq) and attach.

Have conditions (A) or endorsements (B) of Class (if any) been dealt with? See Below

REMARKS, REPAIRS, Etc. (Contd.)

Survey Fee Steering Gear 1.500.==

Special Damage or Repair Fee (if any)

Travelling Expenses (if chargeable) 200.==

Second Surveyor's Fee (if any)

Date when A/c. Rendered

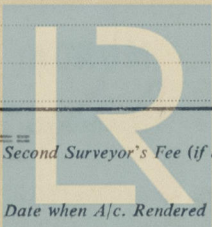

© 2020

Lloyd's Register Foundation