

Lloyd's Register of Shipping.
SURVEYS FOR FREEBOARD.
(CONDITIONS OF ASSIGNMENT.)

F. 80

Ship's Name "LEPTON" Port of Survey BELFAST.
Official Number 181572 Surveyor's Signature J. M. Miller.
Nationality and Port of Registry BRITISH, LONDON. Date of Survey DURING CONSTRUCTION.

Disposition and dimensions of superstructures, trunks, deckhouses and machinery casings to be inserted in the diagrams and tabular statement:—

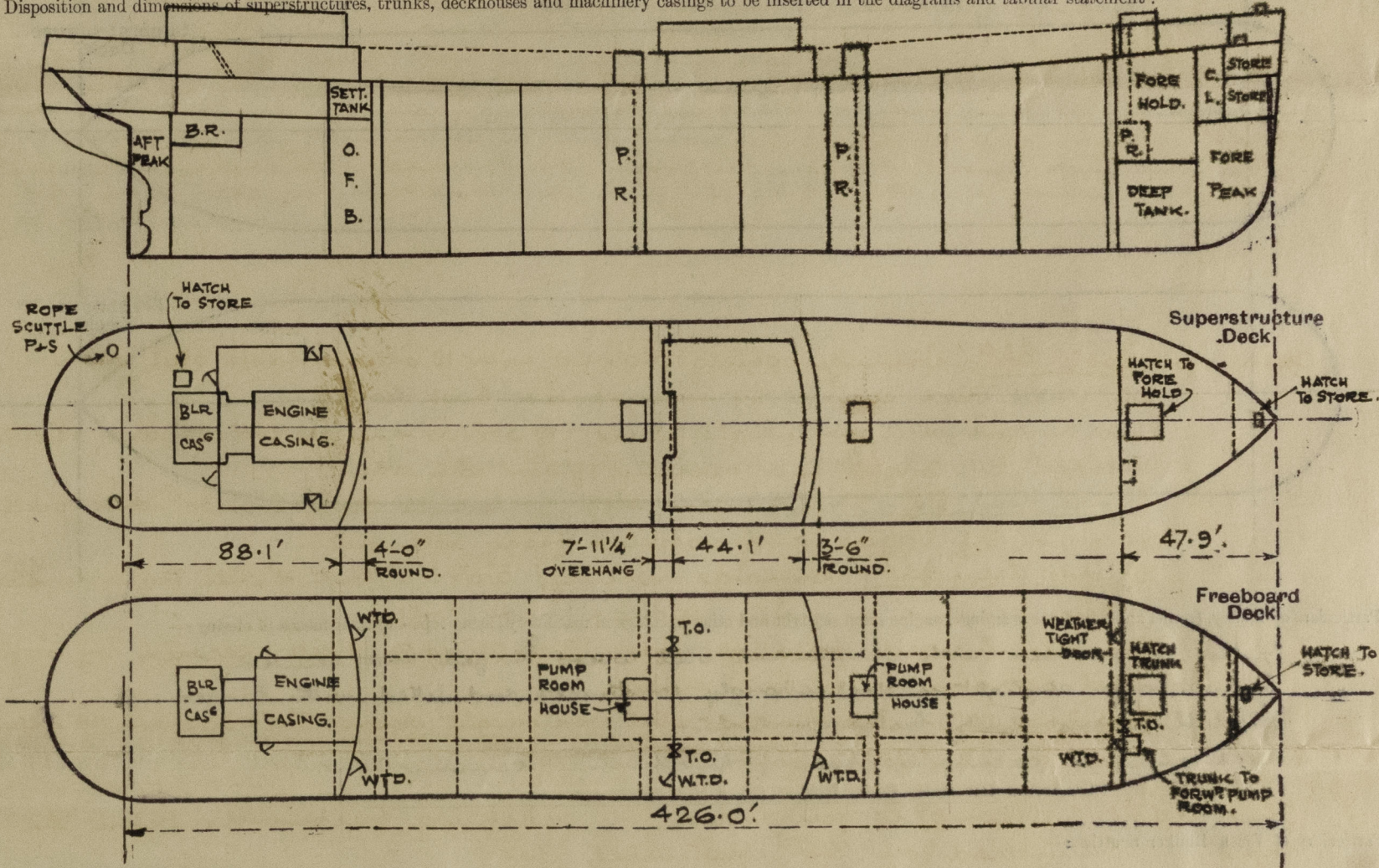

Particulars of Superstructures, Trunks, Casings, Deckhouses.								
	Coaming	Plating	Stiffeners	Spacing	End Attachments of Stiffeners	Size of Openings	Height of Sills	Height of Casings
Poop Bulkhead44"	.44"	8"x3 1/2"x.50"QA WELDED TOE ON	30" To 33"	WELDED TOP & BOTTOM.	2 AT 5'-0"x2'-6"	18"	8'-0"
Raised Quarter Deck Bulkhead ...	✓	✓	✓	✓	✓	✓	✓	✓
Bridge, After Bulkhead30"	.30"	5"x3 3/8" FLATS. WELDED.	30" To 35 1/2"	WELDED TOP & BOTTOM.	2 AT 5'-0"x2'-6" 1 AT 5'-0"x2'-0"	18"	7'-6"
Bridge, Forward Bulkhead44"	.44"	8"x3 1/2"x.44"QA WELDED TOE ON	24" To 35"	D°	1 AT 5'-0"x2'-6"	18"	7'-6"
Forecastle Bulkhead30"	.30"	5"x3 3/8" FLATS WELDED.	29" To 33"	D°	1 AT 5'-0"x4'-0" 1 AT 5'-0"x2'-6" 1 AT 5'-0"x2'-0"	18"	7'-6"
Trunk, Aft ...	✓							
Trunk, Forward ...	✓							
Exposed Machinery Casings on Freeboard or Raised Quarter Decks ...	✓							
Exposed Machinery Casings on Superstructure Decks ...	NOT EXPOSED.							
Machinery Casings within Superstructures not fitted with Class I Closing Appliances ...	✓							
Deckhouses on Flush Deck Ships ...	✓							

Particulars of Closing Appliances (state if capable of being manipulated from both sides).

Poop Bulkhead ...	2 HINGED STEEL WATERTIGHT DOORS, OPERATED FROM BOTH SIDES.	✓
Raised Quarter Deck Bulkhead ...	✓	
Bridge, After Bulkhead ...	ONE HINGED STEEL WATERTIGHT DOOR, OPERATED FROM BOTH SIDES. 2 PORTABLE STEEL PLATES, SECURED BY HOOK BOLTS.	✓
Bridge, Forward Bulkhead ...	ONE HINGED STEEL WATERTIGHT DOOR, OPERATED FROM BOTH SIDES.	✓
Forecastle Bulkhead ...	ONE HINGED STEEL WATERTIGHT DOOR, OPERATED FROM BOTH SIDES.	✓
Exposed Machinery Casings on Freeboard or Raised Quarter Decks ...	ONE HINGED STEEL WEATHERTIGHT DOOR, OPERATED FROM BOTH SIDES.	✓
Exposed Machinery Casings on Superstructure Decks ...	ONE PORTABLE STEEL PLATE (STIFFENED), SECURED BY HOOK BOLTS.	
Machinery Casings within Superstructures not fitted with Class I Closing Appliances ...		
Deckhouses on Flush Deck Ships ...		

PARTICULARS OF PROTECTION TO OPENINGS, ETC.

HATCHWAYS ON FREEBOARD AND SUPERSTRUCTURE DECKS.										
FREEBOARD DECK POOP DECK FORE DECK										
Description of Hatchway	24 CARGO TANKS	8 COFFERDAM 9/F. BUNKERS	FORWARD STORES.	AFTER STORES.	2 ROPE SCUTTLES.	AFTER STORES.	FORE HOLD.	FORWARD STORES.		
Dimensions of Hatchway	4'-0" DIAM.	23'x18'	30'x30'	30'x30'	16" DIA.	27'x27'	8'-0"x8'-0"	18'x14'		
COAMINGS	Height above Deck	10"	7"	9" B.A.	3 1/2"	9"	9" B.A.	30"	9" B.A.	
	Thickness	.75"	7'x3 1/2'x.50"	.44"	.33"	.44"	.44"	.46"	.44"	
	Stiffeners	✓	ANGLE WELDED	✓	✓	✓	✓	6'x3'x.32" B.A.	✓	
	Brackets, Stays	✓	TOE ON.	✓	✓	✓	✓	TRUNKED	✓	
HATCH BEAMS	Number									
	Spacing									
FORE AND AFTERS	Scantling and Sketch									
	Bearing Surface	✓	✓	✓	✓	✓	✓	✓	✓	
	Number									
	Spacing									
HATCH COVERS	Material	STEEL	STEEL	STEEL	STEEL	STEEL	STEEL	STEEL	STEEL	
	Thickness	.40"	.44"	.44"	.25"	.38"	.44"	.46"	.44"	
	How fitted	HINGED	BOLTED	HINGED	HINGED	STRONGBACK WITH HOOK TOGGLE	HINGED	6'x3'x.38" B.A.	HINGED	
	Bearing Surface	O.T.	O.T.	W.T.	✓	✓	W.T.	W.T.	W.T.	
Spacing of Cleats	TOGGLES	✓	TOGGLES	✓	AND JOINTED	TOGGLES	TOGGLES	TOGGLES		
Number of Tarpaulins	SPACED 19" APT.	✓	SPACED 18" APT.	✓	W.T.	SPACED 18" APT.	SPACED 20" APT.	4 TOGGLES		
*Are wood fore and afters steel shod at all bearing surfaces? ✓										
Are battens and wedges efficient and in good condition? ✓										
Are tarpaulins in good condition and in accordance with rule requirements? ✓										
Are lashings provided in accordance with rule requirements? ✓										

Particulars of any special features:—

Guard rails fitted around cargo hatches.

mit

Endorsement at first survey and at surveys for renewal of Certificate:—

The fittings and appliances are in accordance with the particulars shown on this form (or as now modified) and are in good condition.

ML-13



© 2021

Lloyd's Register Foundation