

Lloyd's Register of Shipping.

SURVEYS FOR FREEBOARD.

(CONDITIONS OF ASSIGNMENT.)

Index No. _____
(For London Office only.)

Mdb. Rpt. No. 19269.

Ship's Name "BRITISH LADY"Port of Survey MIDDLESBROUGHOfficial Number 184466Surveyor's Signature J. D. RufusNationality and Port of Registry BRITISHDate of Survey Whilst Building

Disposition and dimensions of superstructures, trunks, deckhouses and machinery casings to be inserted in the diagrams and tabular statement:—

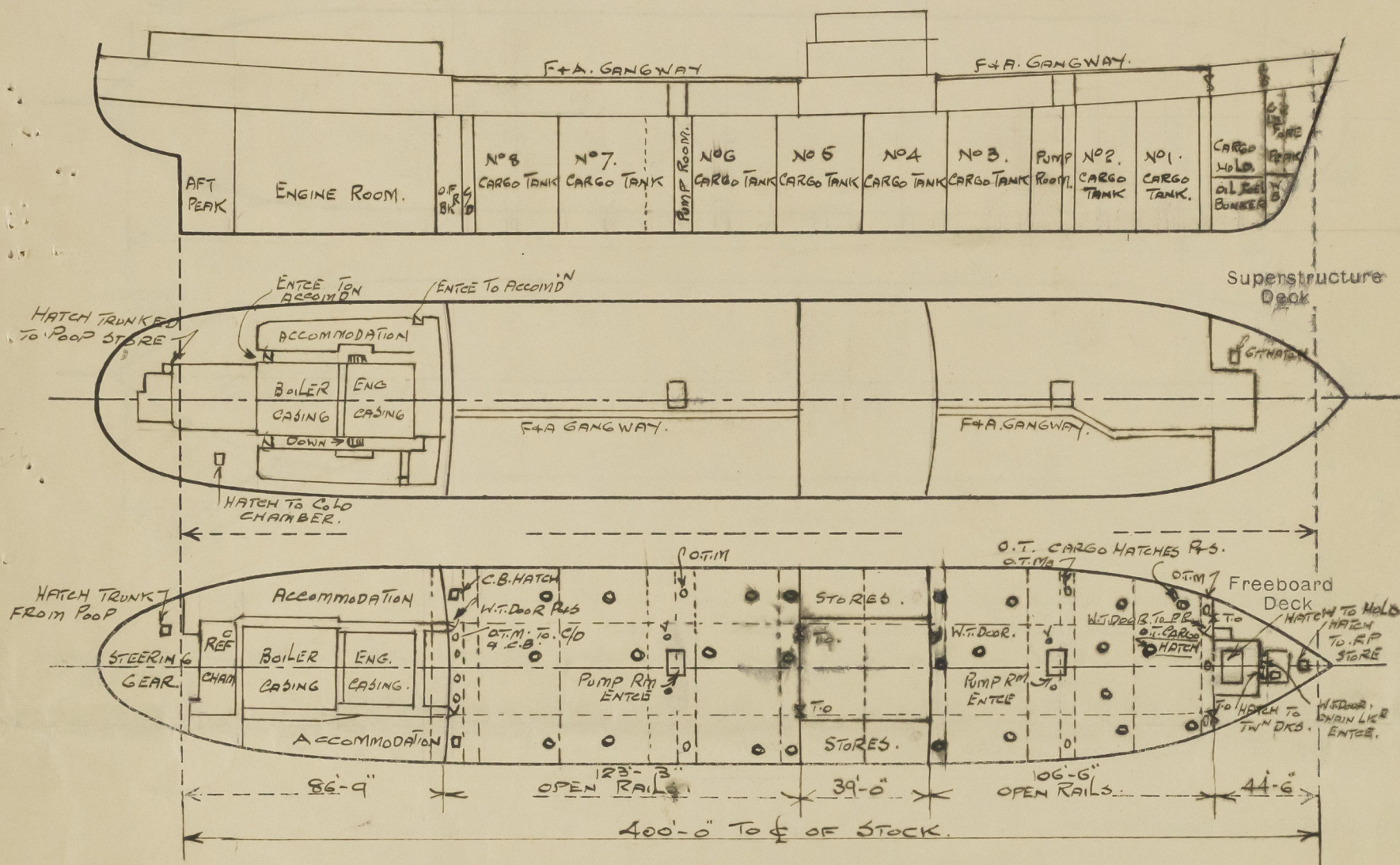

Particulars of Superstructures, Trunks, Casings, Deckhouses.

	Coaming	Plating	Stiffeners	Spacing	End Attachments of Stiffeners	Size of Openings	Height of Sills	Height of Casings
Poop Bulkhead ...	—	.44	9"x3 1/2"x 41 B.A.	2'-6"	BKTS AT HEAD. WELDED AT HEEL.	5'-0" x 3'-0" P+S	18"	8'-0"
Raised Quarter Deck Bulkhead ...	—	.30	4"x3"x 40 L 4"x3"x 42 L 5"x3"x 32 L	MAX 2'-9"	WELDED HEAD + HEEL.	4'-1" x 3'-1" P+S	18"	8'-0"
Bridge, After Bulkhead ...	—	.44	9"x3 1/2"x 38 B.A.	2'-6"	WELDED HEAD + HEEL.	ONE AT 5'-0" x 3'-0"	18" CH. LK	8'-0"
Bridge, Forward Bulkhead ...	—	.30	3"x2 1/2"x 25 L WELDED T.T.P.	2'-6"	WELDED HEAD + HEEL.	4'-1" x 3'-1" P+S. 4'-3" x 2'-3" TO PR	19" 24" (PUMP Room)	8'-0"
Trunk, Aft ...								
Trunk, Forward ...								
Exposed Machinery Casings on Freeboard or Raised Quarter Decks ...								
Exposed Machinery Casings on Superstructure Decks ...								
Machinery Casings within Superstructures not fitted with Class I Closing Appliances ...								
Deckhouses on Flush Deck Ships ...								

Particulars of Closing Appliances (state if capable of being manipulated from both sides).

Poop Bulkhead ...	W.T. Doors. P+S. manipulated from both sides ✓
Raised Quarter Deck Bulkhead ...	—
Bridge, After Bulkhead ...	Steel plates with hooked bolts (also weather boards in full height channels) ✓
Bridge, Forward Bulkhead ...	Steel W.T. Door. manipulated from both sides ✓
Forecastle Bulkhead ...	Steel plates with hooked bolts & 2 W.T. Doors. manipulated from both sides ✓
Exposed Machinery Casings on Freeboard or Raised Quarter Decks ...	(also weather boards in full height channels)
Exposed Machinery Casings on Superstructure Decks ...	—
Machinery Casings within Superstructures not fitted with Class I Closing Appliances ...	—
Deckhouses on Flush Deck Ships ...	—

PARTICULARS OF PROTECTION TO OPENINGS, ETC.

		HATCHWAYS ON FREEBOARD AND SUPERSTRUCTURE DECKS.								POOP DECK	
		FREEBOARD DECK	FILE D.K.	FREE BOARD DECK							
Description of Hatchway		O.T. CARGO	TO FILE	G.T. HATCH	G.T. HATCH	G.T. HATCH	O.T. HATCHES	O.T. MANHOLES	O.T. MANHOLES	HATCH TO	TRUNKED
Dimensions of Hatchway		HATCHES	TO FILE	FILE SPACE	TO F.P. HOLD	TO F.P. SPACE	TO CROSS	RUMPRIMS	C/D + C.B.S.	GOLD CHAMBER	HATCH
		8 TO 8 TANKS	24" x 18"	2' 6" x 2' 0"	4' 0" x 10' 0"	3' 0" x 3' 0"	3' 0" x 3' 0"	23" x 18"	23" x 18"	2' 9" x 2' 9"	2' 6" x 2' 6"
COAMINGS	Height above Deck	12"	24"	9"	30"	9"	30"	12" x 3 1/2"	12" x 3 1/2"	18"	2' 9"
	Thickness	.45	.40		.40	.50	.40	.50	.50	.38	.40
	Stiffeners	-	-	-	-	-	-	-	-	-	-
	Brackets, Stays	-	-	-	-	-	-	-	-	-	-
HATCH BEAMS											
Bearing Surface											
FORE AND AFTERS											
Bearing Surface											
HATCH COVERS											
Material		STEEL	STEEL	STEEL	STEEL	STEEL	STEEL	STEEL	STEEL	WOOD	STEEL
Thickness		.50	.50	.50	.50	.50	.60	.50	.50	2 1/2	ONE 50
How fitted		ONE PIECE	ONE PIECE	ONE PIECE	IN HALVES	ONE PIECE	ONE PIECE	ONE PIECE	ONE PIECE	FLA	HINGED
Bearing Surface		HINGED	HINGED	HINGED	HINGED	HINGED	HINGED	BOLTED	BOLTED	2 1/2	4 TOGGLES
Spacing of Cleats		3- 1/4 TOGGLES	5 TOGGLES	7 TOGGLES	TOGGLES	4 TOGGLES	4 TOGGLES	4 BOLTS 4 CROS	4 BOLTS 4 CROS	22"	
Number of Tarpaulins										2	
		ALL HATCH LID CLOSE ON GREASEY HEMP.									
*Are wood fore and afters steel shod at all bearing surfaces?		YES									
Are battens and wedges efficient and in good condition?		YES									
Are tarpaulins in good condition and in accordance with rule requirements?		YES									
Are lashings provided in accordance with rule requirements?		-									

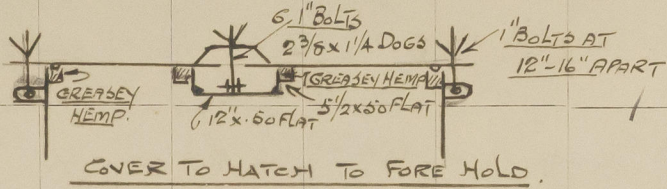

Particulars of any special features :—

914



© 2020
Lloyd's Register
Foundation