

<u>PARTICULARS FOR FREEBOARD</u>		
96' $\frac{0}{8}$ OF LENGTH INCLUDING CRUISE STERN		398-9
LENGTH BETWEEN PERPENDICULARS		400-0
BREADTH MOULDED	(53' $\frac{3}{8}$)	53-3
DEPTH MOULDED TO 2 ND DECK	(27' $\frac{6}{8}$)	27-6
65% OF MOULDED DEPTH	(33' $\frac{3}{4}$)	33-2A
MOULDED DISPLACEMENT @ 95% OF MAX. DRAFT		10640-T
CORRECTION FOR FINENESS		-7-5
APPROXIMATE TONS PER INCH		43-5
DEPTH OF BEAM	12' $\frac{7}{8}$	
<u>SCANTLING:</u> CLASS 100-A-1 WITH FREEBOARD	SEE NOTE	
SHEER - AFTER SIDE OF STERN POST = 4'-2"	UNCLIPPING	
" FOR PERPENDICULAR = 5'-0"		
TWEEN DECKS 8'-6" HIGH - STANDARD 7-6	SEE NOTE PARALLEL	

NOTE: SHEER AT FORE END
SPRUNG UP AN EXTRA
10" OVER THE ABOVE
GIVING 9'-10" AT FORE BEAM

CENTRE LINE BULKHEAD IN HOLDS.
DETAILS OF HATCH END BRACKETS & CONNECTIONS TO
DOUBLE BULB ANGLE STIFFENERS AT ALL 2ND DK HATCH ENDS
SCALE $3\frac{3}{8}" = 1$ FOOT.

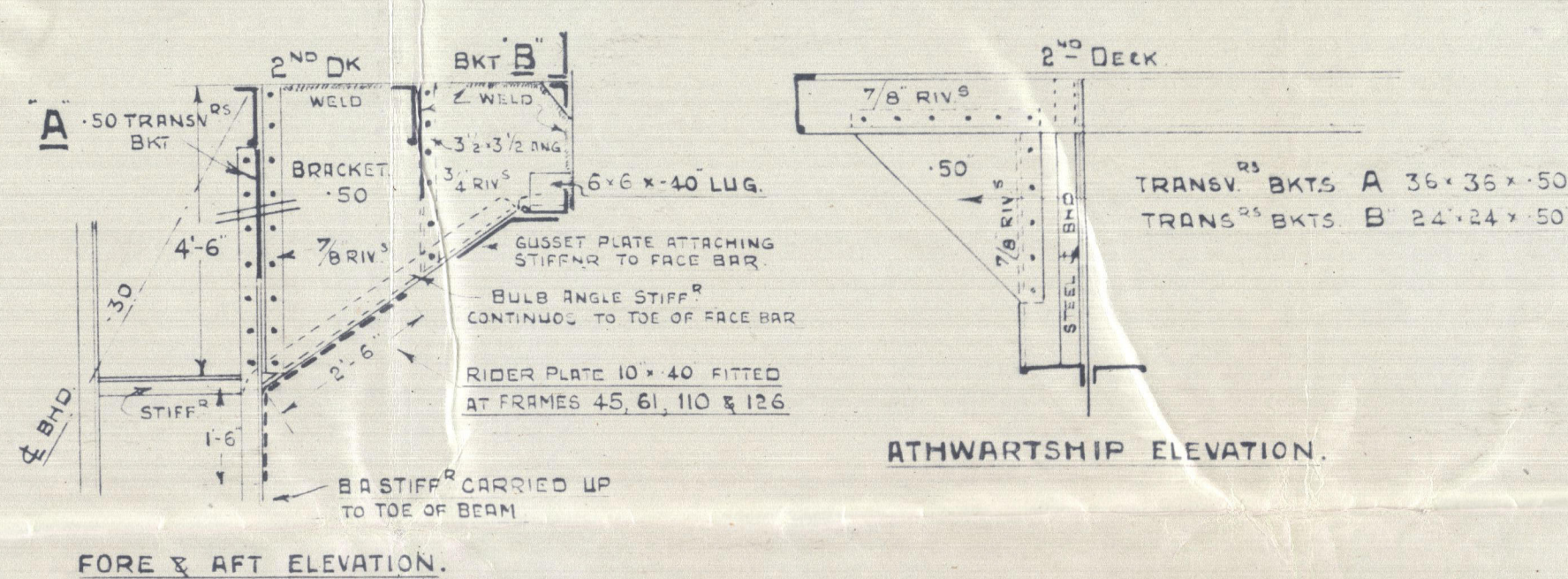

¢ BHD STIFF AT H E BEAMS BRACKETED TOP AND BOTTOM
BEAMS LUGGED TO ¢ BHD WHERE NO STIFFENERS

Nº 531.

PROFILE & DECKS PLAN. (AS FITTED)

DIMENSIONS AS PER RULE.

LENGTH B.P. — 400.00

BREADTH MLD — 53.29

DEPTH MLD — 35.87'

CLASS 100 A.I. ✕ WITH FREEBOARD

SCALE $\frac{1}{8}" = 1$ FOOT.

WITH THE SCANTLINGS AMENDED SUITABLE
FOR A DRAFT OF 18" IN EXCESS OF THAT
CORRESPONDING TO THE FREEBOARD WHICH COULD
BE ASSIGNED TO THE VESSEL WITH A TONNAGE OPENING

DETAIL OF N°3 HATCH SIDE GIRDERS

(2ND DECK.)

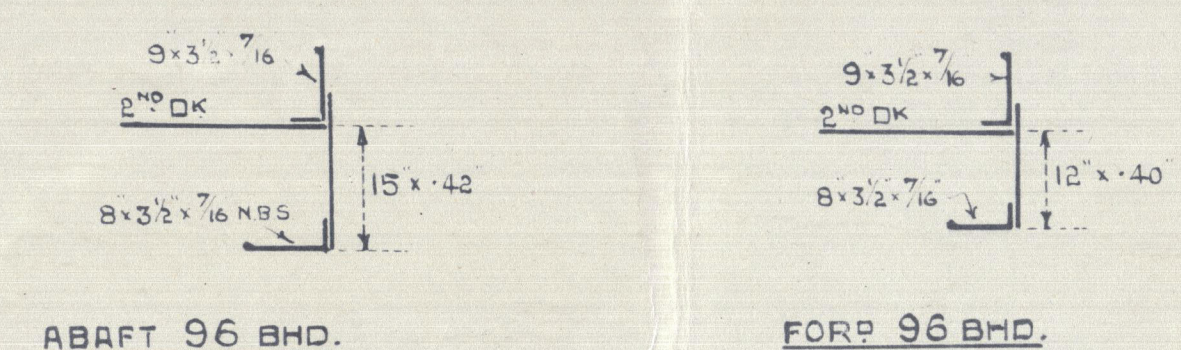

CENTRE LINE BULKHEAD IN HOLDS.
DETAIL OF HATCH END BRACKETS & CONNECTIONS
TO DOUBLE CHANNEL STIFF^S ON FRAMES 110 & 126.

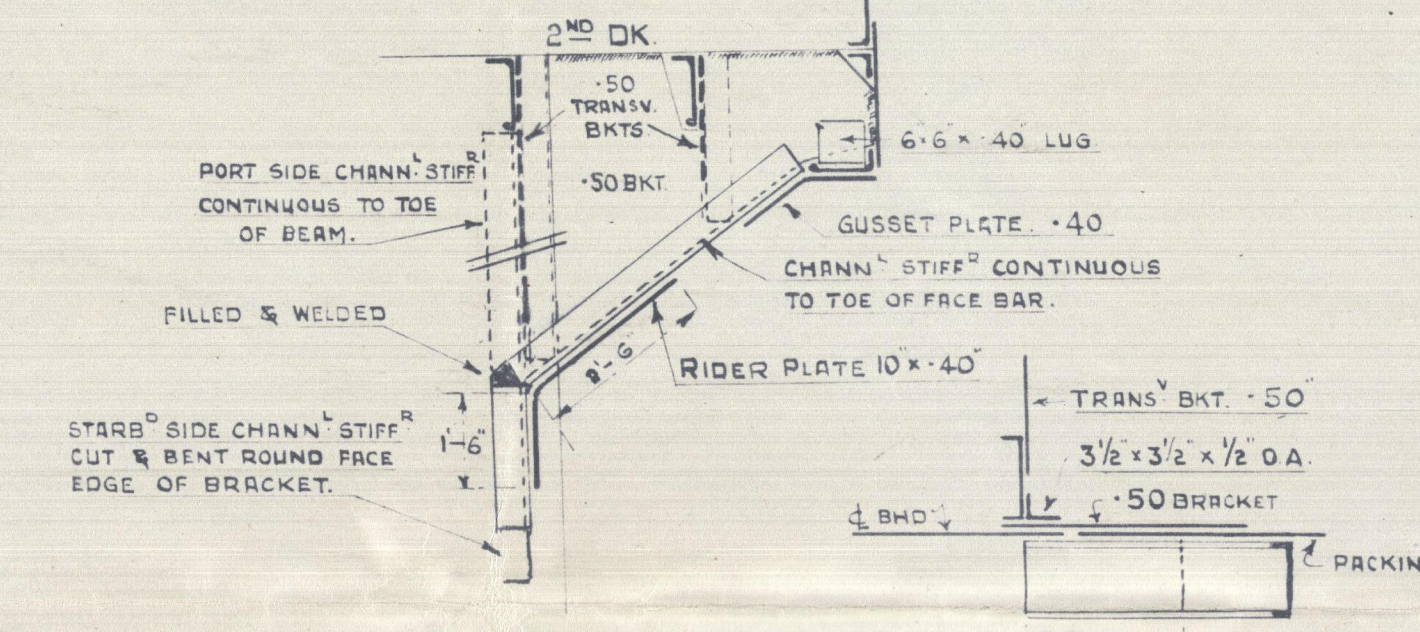

MASTS, WINCHES, WINDLASS, STEERING GEAR ETC
SUPPORTED TO SURVEYORS SATISFACTION.



JOHN READHEAD & SONS LTD
SHIPBUILDERS & ENGINEERS,
SOUTH SHIELDS.

John Headhead & Sons Ltd
SS 531

Profile & ~~reels~~
as filed

EMPIRE FORTUNE.
NEWCASTLE ON TYNE.
Report No. 101040.



© 2020

Lloyd's Register
Foundation

003208-003216-0135