

Lloyd's Register of Shipping.
SURVEYS FOR FREEBOARD.
(CONDITIONS OF ASSIGNMENT.)

Ship's Name DALES WOOD YARD 857 Port of Survey GENOA
Official Number 186186 Surveyor's Signature [Signature]
Nationality and Port of Registry BRITISH Plymouth Date of Survey DECEMBER 1946

Disposition and dimensions of superstructures, trunks, deckhouses and machinery casings to be inserted in the diagrams and tabular statement:—

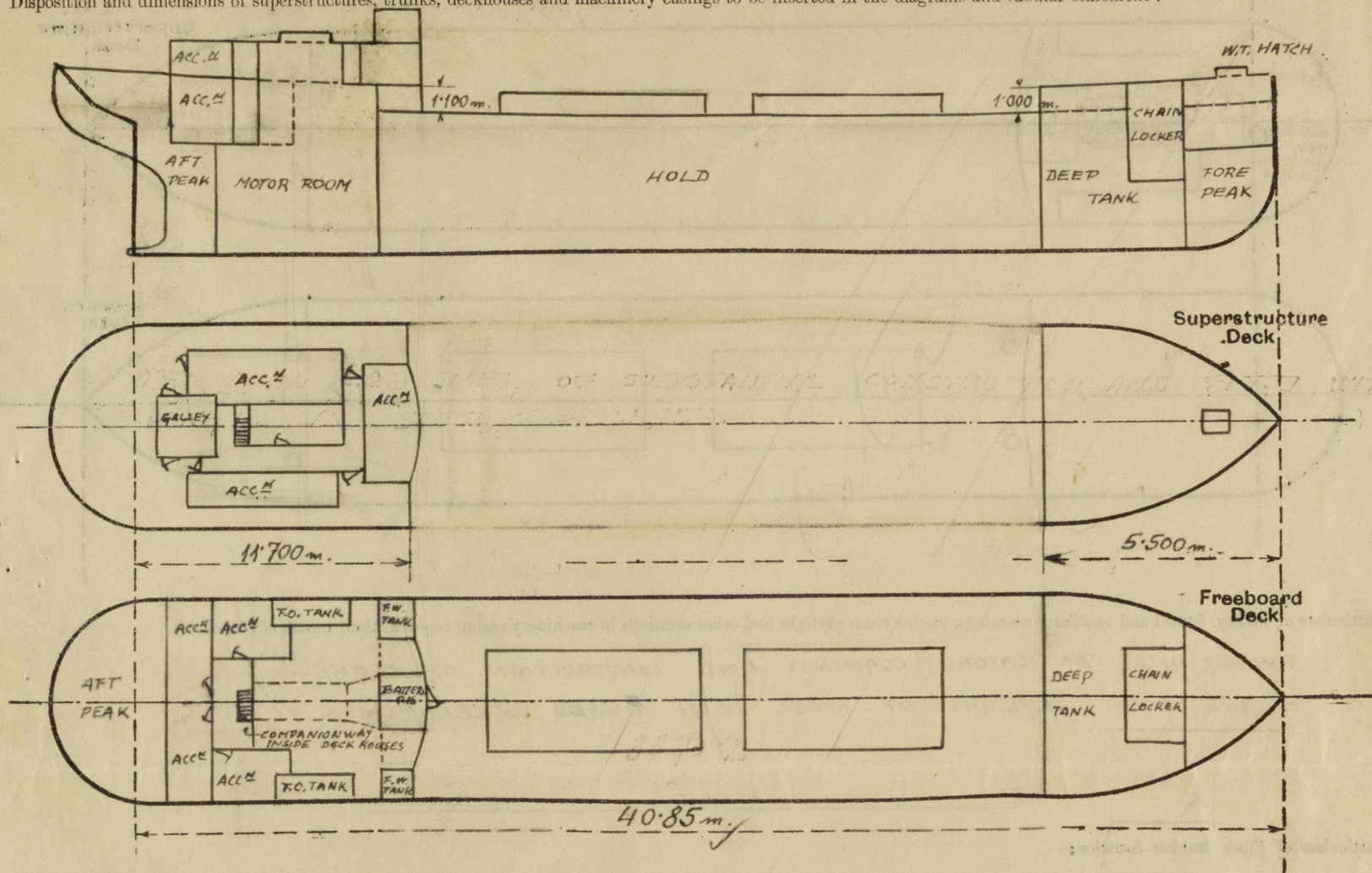

Particulars of Superstructures, Trunks, Casings, Deckhouses.								
	Coaming	Plating	Stiffeners	Spacing	End Attachments of Stiffeners	Size of Openings	Height of Sills	Height of Casings R. & D.
Poop Bulkhead ...	A.B.	7.5	FLAT BAR 100 x 8	580	WELDED AT TOP & BOTTOM	816 x 566	200	1100
Raised Quarter Deck Bulkhead ...	150 x 60 x 9	7.5	FLAT BAR 100 x 8	580	WELDED AT TOP & BOTTOM	816 x 566	200	1100
Bridge, After Bulkhead ...								
Bridge, Forward Bulkhead ...								
Forecastle Bulkhead ...	-	7.5	FLAT IRON 130 x 10	600	BRACKETED AT TOP ONLY	NONE	-	-
Trunk, Aft ...								
Trunk, Forward ...								
Exposed Machinery Casings on Freeboard or Raised Quarter Decks ...	NOT EXPOSED							
Exposed Machinery Casings on Superstructure Decks ...								
Machinery Casings within Superstructures not fitted with Class I Closing Appliances ...								
Deckhouses on Flush Deck Ships ...								

Particulars of Closing Appliances (state if capable of being manipulated from both sides).

Poop Bulkhead ...	
Raised Quarter Deck Bulkhead ...	1 HINGED W.T. DOOR MANIPULATED FROM ONE SIDE
Bridge, After Bulkhead ...	
Bridge, Forward Bulkhead ...	
Forecastle Bulkhead ...	
Exposed Machinery Casings on Freeboard or Raised Quarter Decks ...	
Exposed Machinery Casings on Superstructure Decks ...	
Machinery Casings within Superstructures not fitted with Class I Closing Appliances ...	
Deckhouses on Flush Deck Ships ...	

PARTICULARS OF PROTECTION TO OPENINGS, ETC.

The following diagrams should be used to indicate the positions of cargo and coaling hatchways, gangway, cargo and coaling ports, ventilators, companionways, etc., which would affect the seaworthiness of the ship:—

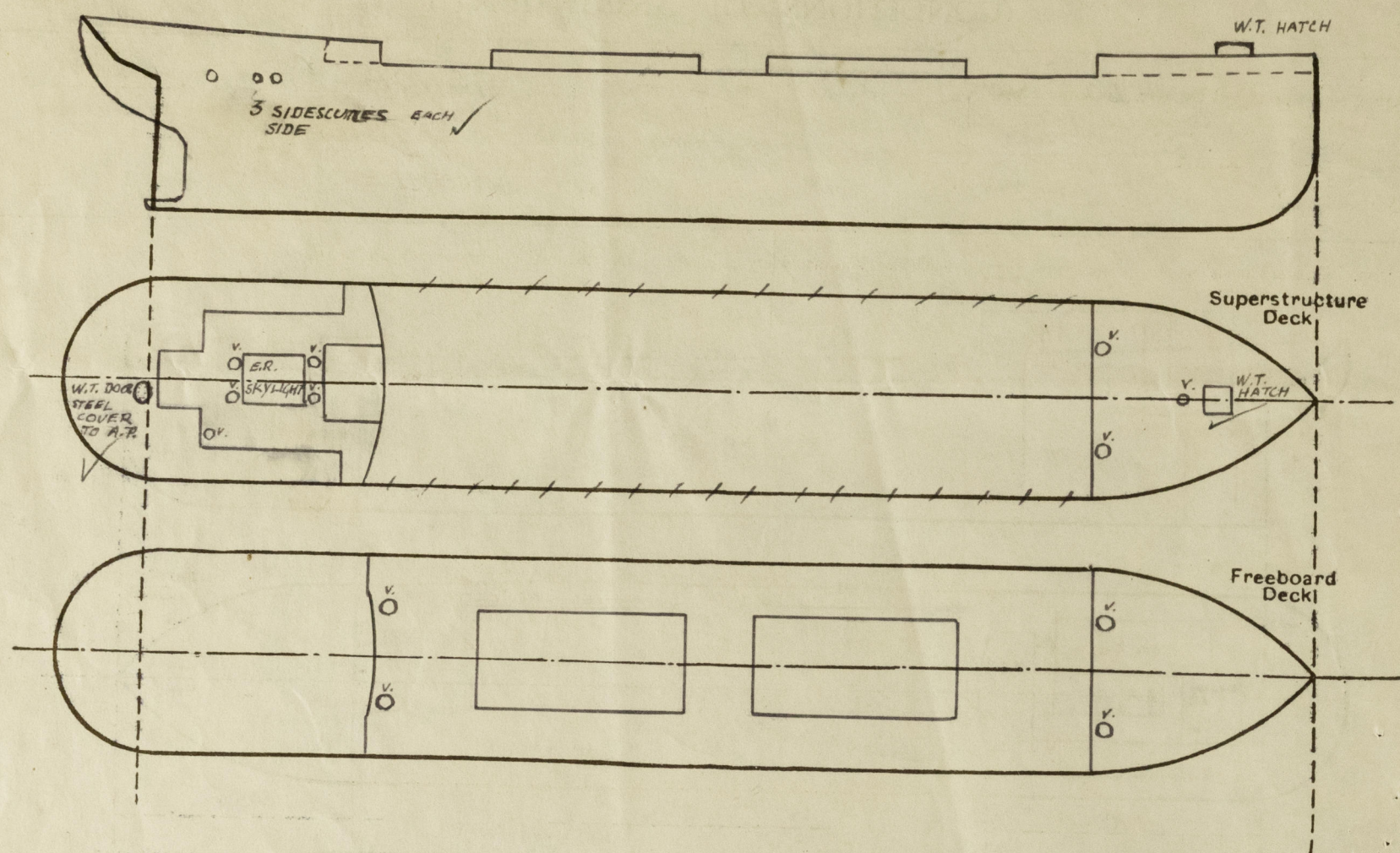

Particulars of fidley, funnel and ventilator coamings, engine room skylight and other openings in machinery casing tops and their means of closing:—

FUNNEL AND VENTILATORS COAMINGS GOOD CONSTRUCTION OF STEEL ✓
ENGINE ROOM SKYLIGHT OF STEEL WITH HINGED STEEL FLAPS ✓

Particulars of Flush Bunker Scuttles:—

NONE

Particulars of Companionways:—

ENTRANCE DECK HOUSE ON R.Q.D. - 6 HINGED STEEL DOORS 7/8" PLATE, SILL 260%

Dom air alleyways

Particulars of Ventilators in exposed positions on freeboard and superstructure decks:—

- 1 VENT. ON FORECASTLE DECK 250" DIA. COAMING 900x8" TO BOATSHAN STORE
- 2 " " " 360" DIA. " 6900x8" DOUBLED FOR 1200% HIGH - TO HOLD ✓
- 2 " " FREEBOARD DECK 360" DIA. " 8000x8" SUPPORTED FROM R.Q.D. FRONT TO HOLD ✓
- 2 " " BOAT DECK 250" DIA. " 750x8" TO ENGINE ROOM
- 2 " " " 250" DIA. " 500x8" " " "
- 1 " " " 250" DIA. " 500x6" TO DECK HOUSE STORE AFT

ALL VENTILATORS CLOSED BY WOOD PLUGS + CANVAS COVER ✓

Particulars of Air Pipes in exposed positions on freeboard, raised quarter, or superstructure decks:—

- 1 AIR PIPE ON FORECASTLE DECK 760" HIGH x 63" DIA. FROM FORE PEAK
- 1 " " " 760" " x 63" " " FORE DEEP TRIMMING TANK
- 2 " " " R.Q.D.K. 760" " x 50" " " FRESH WATER TANK PORT & STARBOARD
- 1 " " " 760" " x 63" " " P+ST. OIL FUEL BUNKERS
- 1 " " " 760" " x 63" " " AFTER PEAK

ALL AIR PIPE FITTED WITH GAUZE AND HINGED FLAPS ✓

Particulars of Gangway Cargo and Coaling Ports:—

Ansaldo.

Particulars of Scuppers and Sanitary Discharge Pipes:—

SCUPPER ON FREEBOARD DECK CUT THROUGH TOP EDGE OF SHEERSTRAKE ✓
30% PIPE SCUPPERS (P+S.) LED OVERBOARD ABOVE L.W.L. FROM WINCH MOTOR SUMP, FITTED WITH STORM VALVES.

SANITARY DISCHARGE PIPES FROM R.Q.D. ERECTIONS, FITTED THROUGH SHIPS SIDE ABOVE L.W.L. WITH STORM VALVES. ✓

Any from below ✓

Particulars of Side Scuttles:—

250% IN R.Q.D. SIDES, OF SUBSTANTIAL CONSTRUCTION, AND FITTED WITH HINGED CAST STEEL DEADLIGHTS. ✓

Vertical distance of Sill of lowest Side Scuttle above top of keel

3870 mm ✓

Particulars of Guard Rails:—

FORECASTLE DECK: STANCHIONS 1100" HIGH, SPACED 1100" APART WITH 2 RAILS ✓
R.Q.D. " 1100" " " 900 " " 2 " ✓

Particulars of Gangways, Lifelines, etc.:—

LIFELINES PROVIDED ✓

Particulars of Freeing Arrangements.

	Length of Bulwark mt	Height of Bulwark mt	Size of Freeing Ports sq. m.	Number each side	Area each side sq. m.	Rule area each side sq. m.
After Well ...	—	—	—	—	—	—
Forward Well ...	23.10	1.20 TO 1.10	0.22 0.13	5 2	1.36 ✓	—

State position of each freeing port ... After Well:—

(F. and A. position and height above deck edge) Forward Well:— SEE SKETCH

State whether the freeing ports are fitted with shutters, bars, or rails, and give particulars of such:— NONE

Additional area where sheer is less than standard.

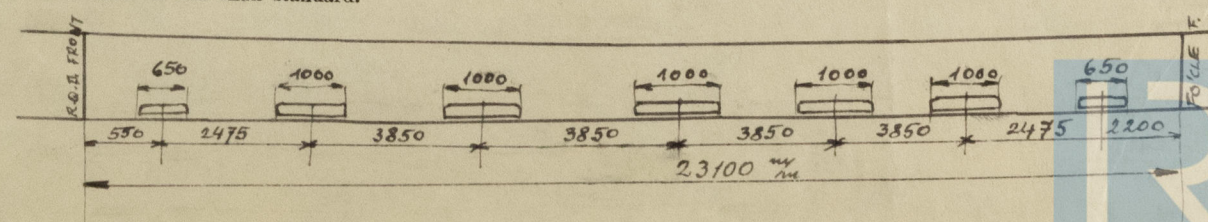

© 1920
220
80%

Lloyd's Register
Foundation

PARTICULARS OF PROTECTION TO OPENINGS, ETC.

HATCHWAYS ON FREEBOARD AND SUPERSTRUCTURE DECKS.					
FREEBOARD DECK FORECASTLE R.Q.D.					
Description of Hatchway	Nº1	Nº2	HATCH TO BOATSMAN STAIR	W.T. DOOR TO A.P.	
Dimensions of Hatchway	8.25x3.60	8.25x3.60	0.6x0.6	0.45x0.35	
COAMINGS	Height above Deck ... 610 mm Thickness { Sides ... 10 Ends ... 10 Stiffeners ... F.B. 180x10 Brackets, Stays ... F.B. 140x4 3rd APART 3rd APART	Height above Deck ... 610 mm Thickness { Sides ... 10 Ends ... 10 Stiffeners ... F.B. 180x10 Brackets, Stays ... F.B. 140x4 3rd APART 3rd APART	400 mm		
HATCH BEAMS	Number ... 5 Spacing ... 1.375 m Scantling and Sketch ... 140x10 450x8 - 450x8 140x10 - 140x10 Bearing Surface ... 90%	Number ... 5 Spacing ... 1.375 m Scantling and Sketch ... 140x10 450x8 - 450x8 140x10 - 140x10 Bearing Surface ... 90%			
FORE AND AFTERS	Number ... Spacing ... Unsupported Lengths ... Scantling* and Sketch ... Bearing Surface ...				
HATCH COVERS	Material ... WOOD Thickness ... 65 How fitted ... F.A. Bearing Surface ... 65%	Material ... WOOD Thickness ... 65 How fitted ... F.A. Bearing Surface ... 65%	HINGED W.T. COVER 7% PLATE	9.5 W.T. STEEL COVER	
Spacing of Cleats	530 mm	530 mm	275 mm	45 mm	
Number of Tarpaulins	2	2	WING NUTS	STUDS NUTS	
*Are wood fore and afters steel shod at all bearing surfaces? Are battens and wedges efficient and in good condition? Are tarpaulins in good condition and in accordance with rule requirements? Are lashings provided in accordance with rule requirements?					

Particulars of any special features:-

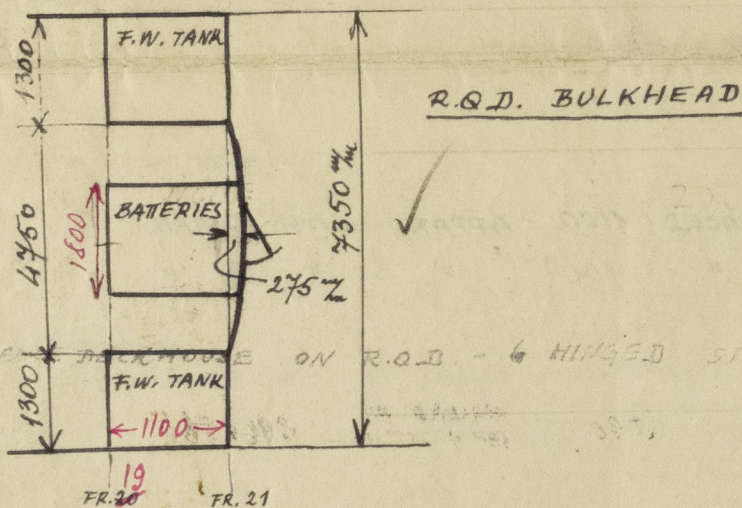

Endorsement at first survey and at surveys for renewal of Certificate:-

The fittings and appliances are in accordance with the particulars shown on this form (or as now modified) and are in good condition.

ALL WOODEN PARTS	ALL WOODEN PARTS	ALL WOODEN PARTS	ALL WOODEN PARTS	ALL WOODEN PARTS
ALL WOODEN PARTS	ALL WOODEN PARTS	ALL WOODEN PARTS	ALL WOODEN PARTS	ALL WOODEN PARTS
ALL WOODEN PARTS	ALL WOODEN PARTS	ALL WOODEN PARTS	ALL WOODEN PARTS	ALL WOODEN PARTS
ALL WOODEN PARTS	ALL WOODEN PARTS	ALL WOODEN PARTS	ALL WOODEN PARTS	ALL WOODEN PARTS
ALL WOODEN PARTS	ALL WOODEN PARTS	ALL WOODEN PARTS	ALL WOODEN PARTS	ALL WOODEN PARTS



© 2020

Lloyd's Register Foundation