

TO BE ATTACHED TO DURBAN REPORT N° 6843.

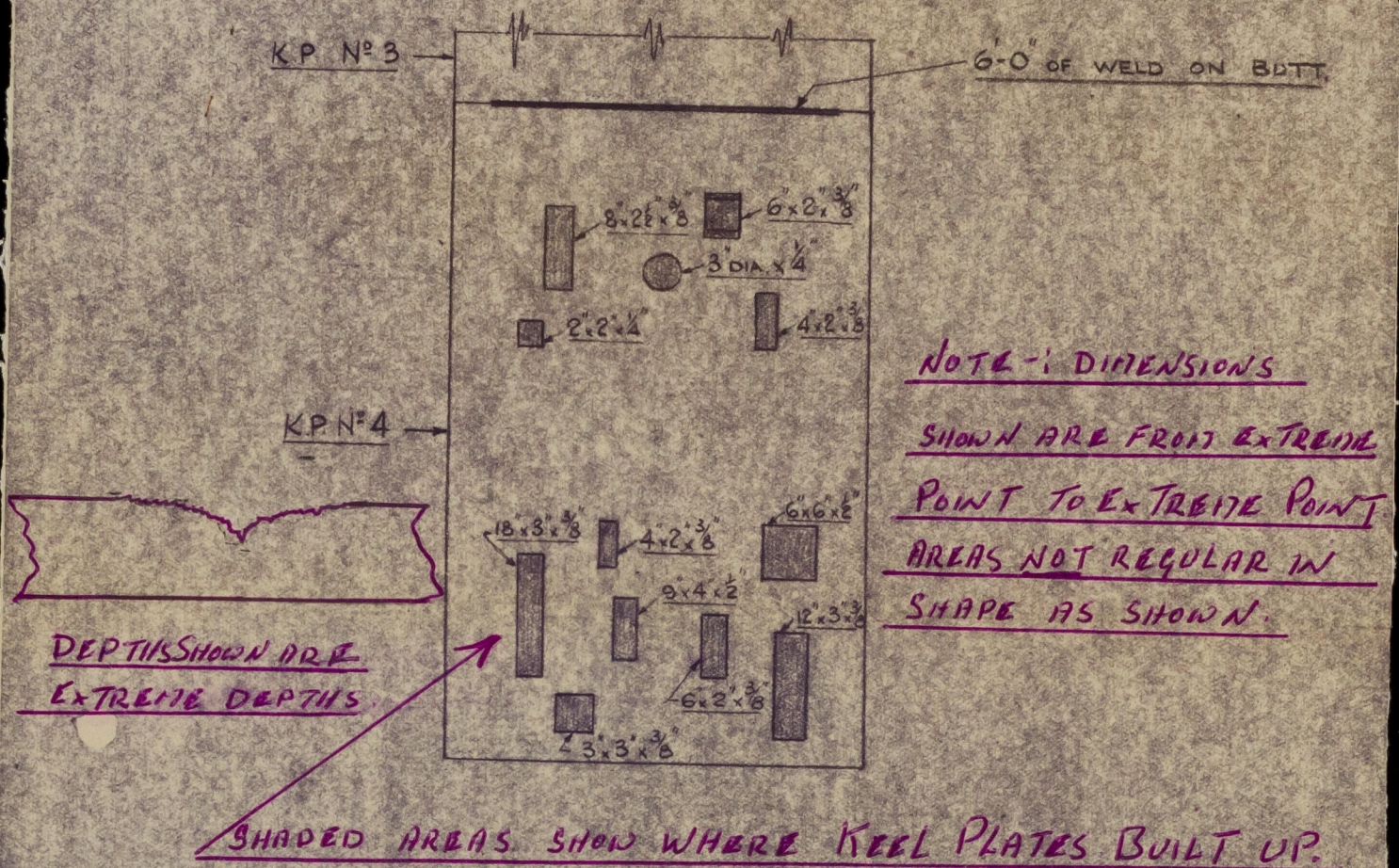

APPROVED ELECTRODES
"SUPERWELD 65"
USED.

M.T. "ANGLO MÆRSK"

DETAILS OF PITTING
IN KEEL PLATES.

JAMES BROWN, LTD.
 ENGINEERS

71, SOUTH BEACH AVE., POINT, DURBAN.

DRAWN BY: *JS*

CHECKED BY:

DATE: 28. 7. 56

SKETCH No. 13933

© 2020 Lloyd's Register Foundation

002018-003022-0017

"Anglo Maersk".

Details of pitting in keel plates.

Dur. rept- No. 6843.



© 2020

Lloyd's Register
Foundation