

Lloyd's Register of Shipping.

SURVEYS FOR FREEBOARD.

(CONDITIONS OF ASSIGNMENT.)

FEB -8 1938

16253

Ship's Name **FURNESS S.B. CO'S N° 277**
"REBECA"Port of Survey **MIDDLESBROUGH**

Official Number

Surveyor's Signature *J. B. Rickton*

Nationality and Port of Registry

Date of Survey

WHILE BUILDING

Disposition and dimensions of superstructures, trunks, deckhouses and machinery casings to be inserted in the diagrams and tabular statement:—

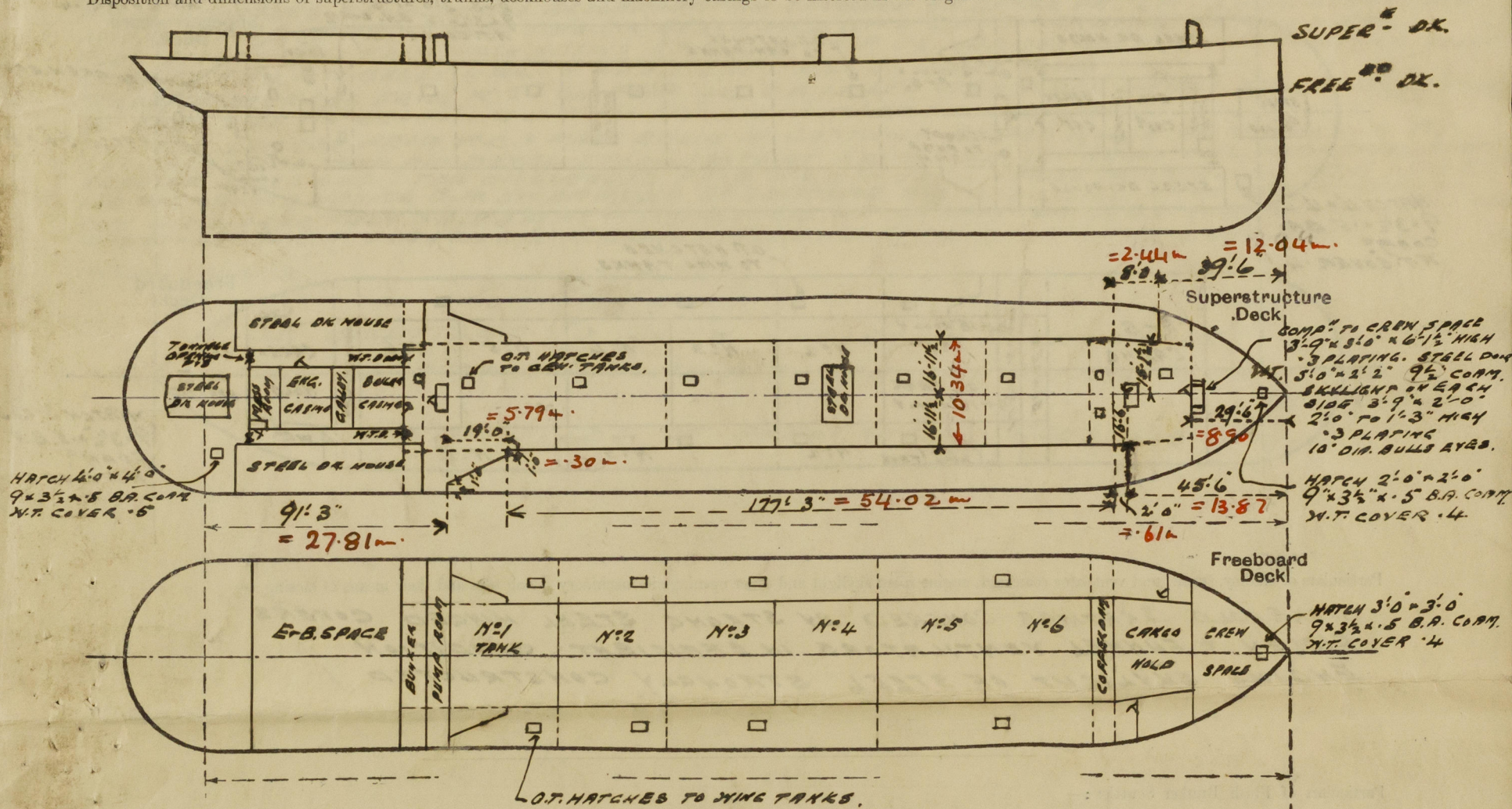

| Particulars of Superstructures, Trunks, Casings, Deckhouses. | | | | | | | | |
|--|---------|---------|---------------------------------|-----------|-------------------------------|------------------|-----------------|-------------------|
| | Coaming | Plating | Stiffeners | Spacing | End Attachments of Stiffeners | Size of Openings | Height of Sills | Height of Casings |
| Poop Bulkhead | ✓ | .57 | 6" x 3" x 36" B.A. | 30" | BRACKETED TOP & BOTTOM | NONE | ✓ | 6'-11 1/2" |
| Raised Quarter Deck Bulkhead ... | ✓ | | | | | | | |
| Bridge, After Bulkhead | ✓ | | | | | | | |
| Bridge, Forward Bulkhead | ✓ | | | | | | | |
| Forecastle Bulkhead | 42" x 3 | .3 | 4 1/2" x 3" x 38" L | 27" ✓ | NONE | 5'-6" x 2'-0" | 12" | 6'-11 1/2" ✓ |
| Trunk, Aft | | | | | | | | |
| Trunk, Forward | NONE | .57 | 8" x 3" x 44" B.A. LONGITUDINAL | 24 1/2" ✓ | | NONE | ✓ | 6'-11 1/2" ✓ |
| Exposed Machinery Casings on Freeboard or Raised Quarter Decks ... | ✓ | | | | | | | |
| Exposed Machinery Casings on Superstructure Decks | NONE | .32 | 3" x 2 1/2" x 3" L | 30" | NONE | 5'-0" x 2'-0" | 18" | 7'-6" ✓ |
| Machinery Casings within Superstructures not fitted with Class I Closing Appliances | ✓ | | | | | | | |
| Deckhouses on Flush Deck Ships ... | ✓ | | | | | | | |

Particulars of Closing Appliances (state if capable of being manipulated from both sides).

| | |
|--|---|
| Poop Bulkhead | NO OPENINGS ✓ |
| Raised Quarter Deck Bulkhead ... | ✓ |
| Bridge, After Bulkhead | ✓ |
| Bridge, Forward Bulkhead | ✓ |
| Forecastle Bulkhead | HINGED STEEL DOORS OPERATED FROM BOTH SIDES ✓ |
| Exposed Machinery Casings on Freeboard or Raised Quarter Decks ... | ✓ |
| Exposed Machinery Casings on Superstructure Decks | N.T. STEEL DOOR TO BOILER CASING. HINGED STEEL DOOR TO ENG. CASING DOORS OPERATED FROM BOTH SIDES ✓ |
| Machinery Casings within Superstructures not fitted with Class I Closing Appliances | ✓ |
| Deckhouses on Flush Deck Ships ... | ✓ |

PARTICULARS OF PROTECTION TO OPENINGS, ETC.

The following diagrams should be used to indicate the positions of cargo and coaling hatchways, gangway, cargo and coaling ports, ventilators, companionways, etc., which would affect the seaworthiness of the ship:—

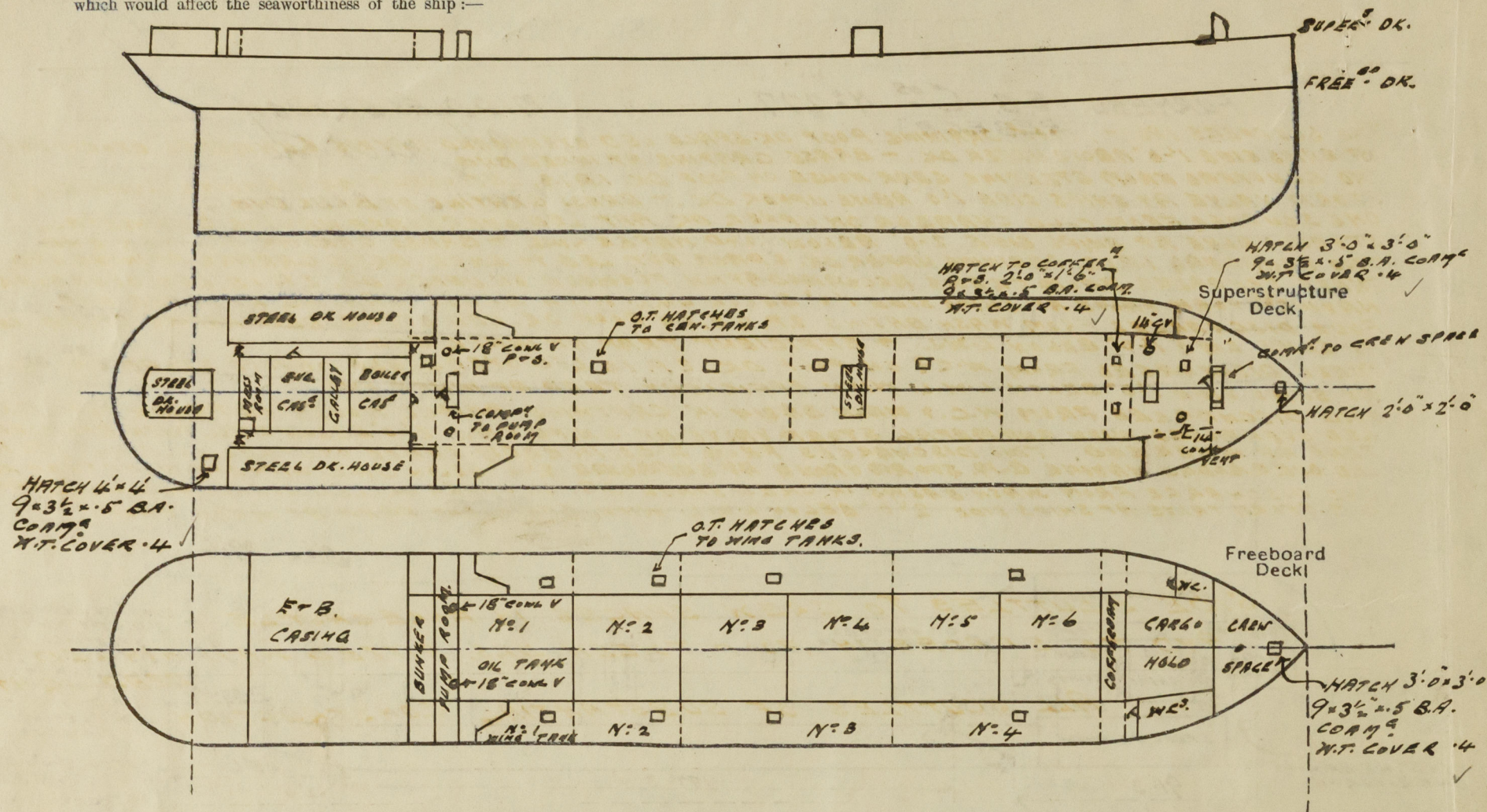

Particulars of fiddley, funnel and ventilator coamings, engine room skylight and other openings in machinery casing tops and their means of closing :—

STAKEHOLD GRATING COVERED BY STRONG STEEL HINGED COVERS
FIDLEY & FUNNEL VENTILATORS IN EFFICIENT CONDITION
ENGINE SKYLIGHT OF STEEL STRONGLY CONSTRUCTED. ✓

Particulars of Flush Bunker Scuttles :—

Particulars of Companionways:— STEEL COMPANIONWAY TO PUMP ROOM 10'0" x 5'6". 7'6" HIGH .3 PLATING
WT. DOOR 5'0" x 2'1" 3" 18" COMP. DOOR OPERATED FROM BOTH SIDES ✓
STEEL COMPANIONWAY ON FLEE DK. TO CRAN SPACE 3'9" x 3'0" 6'1½" HIGH .3 PLATING
WT. DOOR 3'0" x 2'2" 9½" COMP. DOOR OPERATED FROM BOTH SIDES ✓
SKYLIGHT ON ARCH SIDE OF COMPANION 3'9" x 2'0". 2'0" x 1'0" HIGH .3 PLATING
FITTED WITH 10 DIA. BULB EYE LIGHT ✓

Particulars of Ventilators in exposed positions on freeboard and superstructure decks :—

TWO YENTS ON TRUNK DK 14" DIA. CORR. 3'0" x .36 LED TO CARGO HOLD FURN: ✓
TWO YENTS ON TRUNK DK 18" DIA. CORR. 4'0" x .4 LED TO PUMP ROOM ✓
FIVE YENTS ON POOP DN. 2 RAB. TO STORE ROOMS IN POOP SPACE 8" DIA. CORR. 3'6" x .3 ✓
EIGHT YENTS ON FGLE DK 4'45. TO SEARAH + FIXMEN'S QUARTERS + STORE ROOMS 8" DIA. CORR. 3'0" x .3 ✓
ONE YENT ON FGLE DK TO STORE ROOM 6" DIA. CORR. 3'0" x .3 ✓
FIVE LOOSE NECH YENTS. ON FGLE DK. 2 R. 3S. 3 DIA. CORR. 3'0" x .25 LED. TO H.C. + LAVATORIES ✓

ALL VENTILATORS CONSTRUCTED IN ACCORDANCE WITH THE RULES & CORMINGS CLOSED WITH WOOD PLUGS & CANVAS COVERS. ✓

Particulars of Air Pipes in exposed positions on freeboard, raised quarter, or superstructure decks :—

ONE AIR PIPE ON PAID DK. 4" DIA. 18" HIGH FROM AFT PEAK TANK ✓
TWO AIR PIPES 1 P. 1 S. ON BOAT DK. 4" DIA. 18" HIGH FROM OIL FUEL SIDE BUNKERS ✓
ONE AIR PIPE ON BOAT DK. 4" DIA. 18" HIGH FROM OIL FUEL CROSS BUNKER ✓
TWO AIR PIPES 1 P. 1 S. ON TRUNK DK. 3" DIA. 18" HIGH FROM FORWARD COFFERDAM ✓
ONE AIR PIPE ON FORECASTLE 3 1/2" DIA. 18" HIGH FROM FORE PEAK TANK ✓
FOUR AIR PIPES 2 P. 2 S. ON MAIN DK. 4" DIA. 8'-6" HIGH (CONNECTED TO TRUNK SIDE) FROM NO. 1 & 4 WING TANKS

ALL AIR PIPES OF GALV. STEEL TUBE EXCEPT THOSE TO OIL FUEL BUNKERS
WHICH ARE COARSE NECK OF STEEL TUBE

AIR PIPES TO OIL FUEL BUNKERS FITTED WITH METAL GRAUZE

REMAINDER OF AIR PIPES FITTED WITH WOOD PLUGS & CANVAS COVERS. ✓

Particulars of Gangway Cargo and Coaling Ports :—

Particulars of Scuppers and Sanitary Discharge Pipes :—

TWO SCUPPERS 1 PORT / 1 STAR, DRAINING POOP DE. SPACE LED OVERBOARD HAVING GUNMETAL STORM VALVE
AT SHIPS SIDE 1'-0" ABOVE UPPER DE. & BRASS GRATING AT INNER END. ✓
TWO SCUPPERS FROM STEERING GEAR HOUSE ON POOP DE. 1 R. IS. LED OVERBOARD HAVING GUNMETAL
STORM VALVE AT SHIPS SIDE 1'-0" ABOVE UPPER DE. & BRASS GRATING AT INNER END. ✓
ONE SCUPPER FROM COLD CHAMBER ON UPPER DE. AFT LED OVERBOARD HAVING GUNMETAL
STORM VALVE AT SHIPS SIDE 2'-0" BELOW LOAD WATER LINE & BRASS GRATING AT INNER END. ✓
TWO SCUPPERS 1 R. IS. DRAINING UPPER DE. SPACE AFT LED TO ANGLE. BRASS GRATING AT INNER END. ✓
THREE SCUPPERS FROM CRENS ACCOMMODATION FORWARD ON UPPER DE. 2 R. IS. LED OVERBOARD
HAVING STORM VALVE AT SHIPS SIDE 1'-0" BELOW L.W.L. WITH BRASS GRATING AT INNER END. ✓
FOUR DISCHARGES FROM WASH BASINS 2 P. 2 S. ON POOP DE. LED OVERBOARD HAVING STORM VALVE
AT SHIPS SIDE 1'-0" BELOW L.W.L. & EFFICIENT TRAP AT INNER END. ✓
THREE DISCHARGES FROM W.C. 3 ON POOP DE. 2 R. IS. LED OVERBOARD HAVING STORM VALVE G.M.
AT SHIPS SIDE 1'-0" BELOW L.W.L. WITH EFFICIENT TRAP AT INNER END. ✓
TWO DISCHARGES FROM W.C. 3 WASH BASIN IN CAPTAINS BRASSIE HOUSE ON FORTH TOP P.S.
LED OVERBOARD WITH GUNMETAL STORM VALVE AT SHIPS SIDE 2'-0" BELOW L.W.L. WITH EFFICIENT
TRAP AT INNER END. ✓ TWO DISCHARGES FROM W.C. 3 IN CARRY SPACE ON UPPER DE. FORWARD 1 R. IS.
LED OVERBOARD HAVING G.M. STORM VALVE AT SHIPS SIDE 2'-0" BELOW L.W.L. WITH EFFICIENT TRAP AT ✓
ONE DISCHARGE FROM WASH BASIN IN CREN SPACE S.S. ON UPPER DE. LED OVERBOARD WITH INNER END
G.M. STORM VALVE AT SHIPS SIDE 2'-0" BELOW L.W.L. WITH EFFICIENT TRAP AT INNER END. ✓

Particulars of Side Scuttles:—

SIDE SCUTTLES TO CREW SPACES IN FORECASTLE
AND TO SPACES IN POOP TWEEN DECKS. FITTED WITH HINGED
DEADLIGHTS
ALL SCUTTLES OF SUBSTANTIAL CONSTRUCTION. ✓

Vertical distance of Sill of lowest Side Scuttle above top of keel 20' 6"

Particulars of Guard Rails :—

GUARD RAIL ON FREE⁶⁰ DK. 3'-6" HIGH HAVING 3 RODS. STANCHIONS 4'-6" APART
 " " POOP DK " " " " " "
 " " TRUNK DK. " " " " " "
 " " FORECASTLE DK. 3'-8½" HIGH " " " " " "

Particulars of Gangways, Lifelines, etc. :—

| Particulars of Freeing Arrangements. | | | | | | |
|--------------------------------------|-------------------|-------------------|-----------------------|------------------|----------------|---------------------|
| | Length of Bulwark | Height of Bulwark | Size of Freeing Ports | Number each side | Area each side | Rule area each side |
| After Well | | | | | | |
| Forward Well | | | | | | |

State position of each freeing port (After Well :—
(F. and A. position and height above deck edge) (Forward Well :—

State whether the freeing ports are fitted with shutters, bars, or rails, and give particulars of such :—

Additional area where sheer is less than standard.



© 2020
Lloyd's Reg

PARTICULARS OF PROTECTION TO OPENINGS, ETC.

| HATCHWAYS ON FREEBOARD AND SUPERSTRUCTURE DECKS. | | | | | | | | | |
|--|---|---------------------------|---|--|--|--|--|--|--|
| Description of Hatchway | | | | | | | | | |
| Dimensions of Hatchway | | | | | | | | | |
| COAMINGS | { | Height above Deck ... | OILTIGHT HATCHES TO CENTRE OIL TANKS 6 OFF ON TRUNK DK. 4'-0" x 3'-0" BULB ANGLE CORN ² 9' x 3 1/2' x .5 TOP PLATE .5 ✓ | | | | | | |
| | | Thickness { Sides ... | | | | | | | |
| | | { Ends ... | | | | | | | |
| | | Stiffeners | | | | | | | |
| | | Brackets, Stays | | | | | | | |
| HATCH BEAMS | { | Number | OILTIGHT HATCHES ON FREE ⁸⁰ DK. TO WING TANKS N ² 2+3 6'-0" x 2'-6" COAMING 4'-0" x .4 TOP PLATE .5 ✓ DITTO TO N ⁵ 1-4 WING TANKS 6'-0" x 2'-6" COAMING 4'-0" x .4 TOP PLATE .5 RIVETED. WITH BOLTED MANHOLE ON TOP 18" x 13" ✓ | | | | | | |
| | | Spacing | | | | | | | |
| | | Scantling and Sketch ... | | | | | | | |
| | | Bearing Surface | | | | | | | |
| FORE AND AFTERS | { | Number | HATCH TO CARGO HOLD FOR ⁹⁰ ON TRUNK DECK . 6'-0" x 9'-8" 9' x 3 1/2' x .5 BULB ANGLE COAMING. TOP PLATE .5 WITH INT. HATCH ON TOP OF SAME 3'-0" x 3'-0" 9' x 3 1/2' x .5 BULB ANGLE COAMING. TOP PLATE .4 ✓ | | | | | | |
| | | Spacing | | | | | | | |
| | | Unsupported Lengths ... | | | | | | | |
| | | Scantling* and Sketch ... | | | | | | | |
| | | Bearing Surface | | | | | | | |
| HATCH COVERS | { | Material | | | | | | | |
| | | Thickness | | | | | | | |
| | | How fitted | | | | | | | |
| | | Bearing Surface | | | | | | | |
| Spacing of Cleats | | | | | | | | | |
| Number of Tarpaulins | | | | | | | | | |
| <p>*Are wood fore and afters steel shod at all bearing surfaces ?</p> <p>Are battens and wedges efficient and in good condition ?</p> <p>Are tarpaulins in good condition and in accordance with rule requirements ?</p> <p>Are lashings provided in accordance with rule requirements ?</p> | | | | | | | | | |

Particulars of any special features :—

Endorsement at first survey and at surveys for renewal of Certificate :—

The fittings and appliances are in accordance with the particulars shown on this form (or as now modified) and are in good condition.

