

Lloyd's Register of Shipping.

SURVEYS FOR FREEBOARD.

(CONDITIONS OF ASSIGNMENT.)

Index No. 36145.
(For London Office only).

NOV 15 1939

GRK. REPORT N° 20847

Ship's Name **DESMONLEA.**Port of Survey **GREENOCK**

Official Number

Surveyor's Signature *Kenneth Inglis.*Nationality and Port of Registry **BRITISH, LONDON.**Date of Survey **WHILE BUILDING**

Disposition and dimensions of superstructures, trunks, deckhouses and machinery casings to be inserted in the diagrams and tabular statement: --

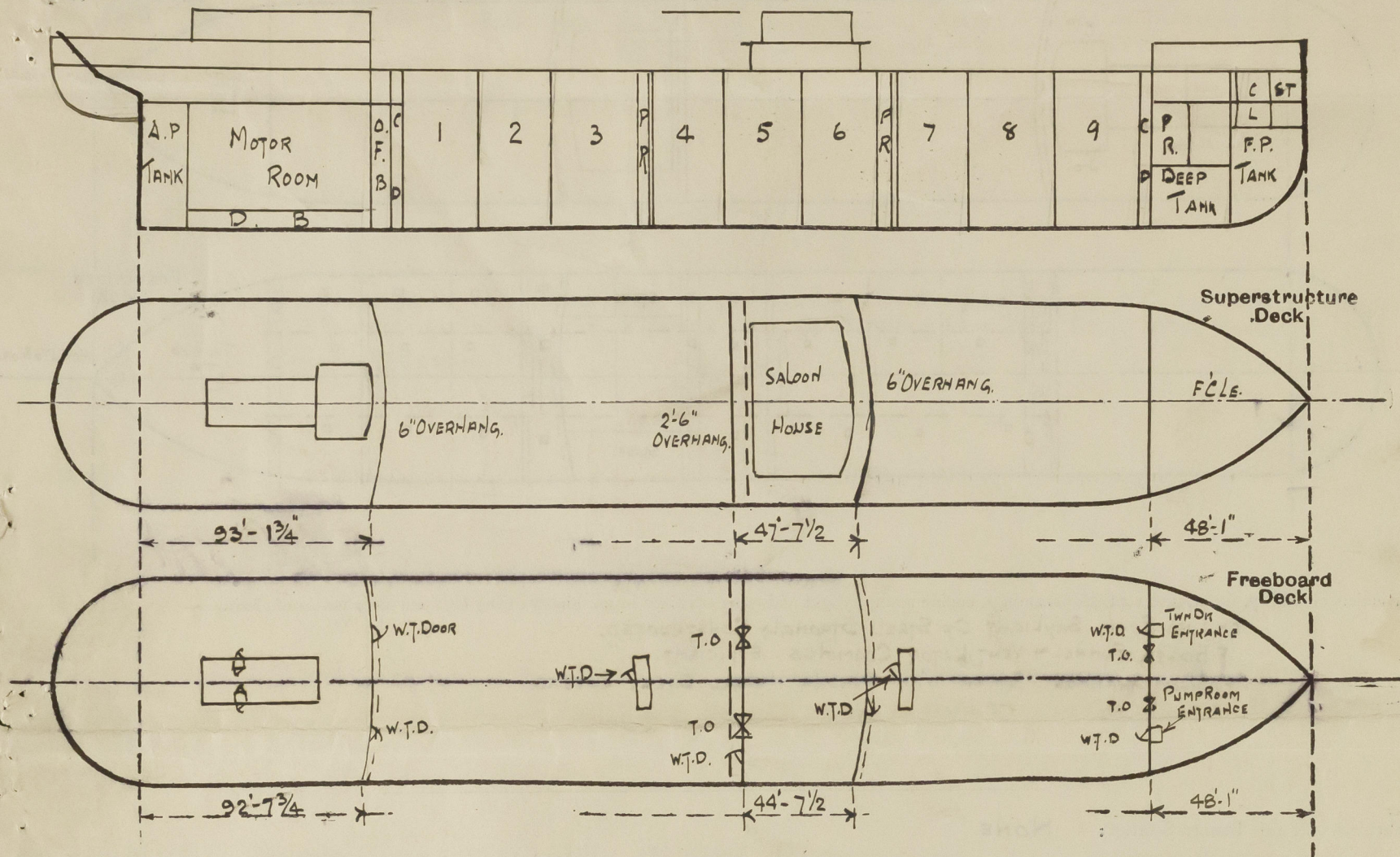

Particulars of Superstructures, Trunks, Casings, Deckhouses.

	Coaming	Plating	Stiffeners	Spacing	End Attachments of Stiffeners	Size of Openings	Height of Sills	Height of Casings
Poop Bulkhead ...	44 ✓	44 ✓	10 x 3 1/2 x 44 BA	30" ✓	WELDED ✓	2 @ 5' x 2' ✓	18 ✓	7'-6" ✓
Raised Quarter Deck Bulkhead ...	✓							
Bridge, After Bulkhead ...	30 ✓	30 ✓	4 1/2 x 3 x 34 ✓	30" ✓	✓	2 @ 5' x 3' ✓ 1 @ 4' 6" x 2' 3" ✓	18 ✓	7-6 ✓
Bridge, Forward Bulkhead ...	44 ✓	44 ✓	9 x 3 1/2 x 40 BA	30" ✓	WELDED ✓	1 @ 4' 6" x 2' 0" ✓ 2 @ 4' 6" x 2' 0" ✓	18" ✓	7'-6" ✓
Forecastle Bulkhead ...	30 ✓	30 ✓	4 x 3 x 32 ✓	30 ✓	✓	2 @ 5' 3" x 3' 1" ✓	18 ✓	7-6 ✓
Trunk, Aft ...	✓							
Trunk, Forward ...	✓							
Exposed Machinery Casings on Freeboard or Raised Quarter Decks ...	✓							
Exposed Machinery Casings on Superstructure Decks ...	34 ✓	30 ✓	3 x 3 x 30 ✓	30 ✓	BCs At Top. Continuous At Bottom	NONE	✓	8'-0" ✓
Machinery Casings within Superstructures not fitted with Class I Closing Appliances ...	✓							
Deckhouses on Flush Deck Ships ...	✓							

Particulars of Closing Appliances (state if capable of being manipulated from both sides).

Poop Bulkhead ...	HINGED STEEL W.T. DOORS OPERATED FROM BOTH SIDES. ✓
Raised Quarter Deck Bulkhead ...	✓
Bridge, After Bulkhead ...	STEEL PLATES SECURED BY HOOK BOLTS 15" APART, HINGED STEEL W.T. DOOR (STAR) ✓
Bridge, Forward Bulkhead ...	HINGED STEEL W.T. DOOR OPERATED FROM BOTH SIDES. ✓
Forecastle Bulkhead ...	2. HINGED STEEL W.T. DOORS OPERATED FROM BOTH SIDES. ✓
Exposed Machinery Casings on Freeboard or Raised Quarter Decks ..	2. OPENINGS FITTED WITH CHANNELS & BOARDS FULL HEIGHT, CHANNELS RIVETED TO BULKHEAD. ✓
Exposed Machinery Casings on Superstructure Decks ...	No OPENINGS ✓
Machinery Casings within Superstructures not fitted with Class I Closing Appliances ...	✓
Deckhouses on Flush Deck Ships ...	✓

PARTICULARS OF PROTECTION TO OPENINGS, ETC.

The following diagrams should be used to indicate the positions of cargo and coaling hatchways, gangway, cargo and coaling ports, ventilators, companionways, etc., which would affect the seaworthiness of the ship:—

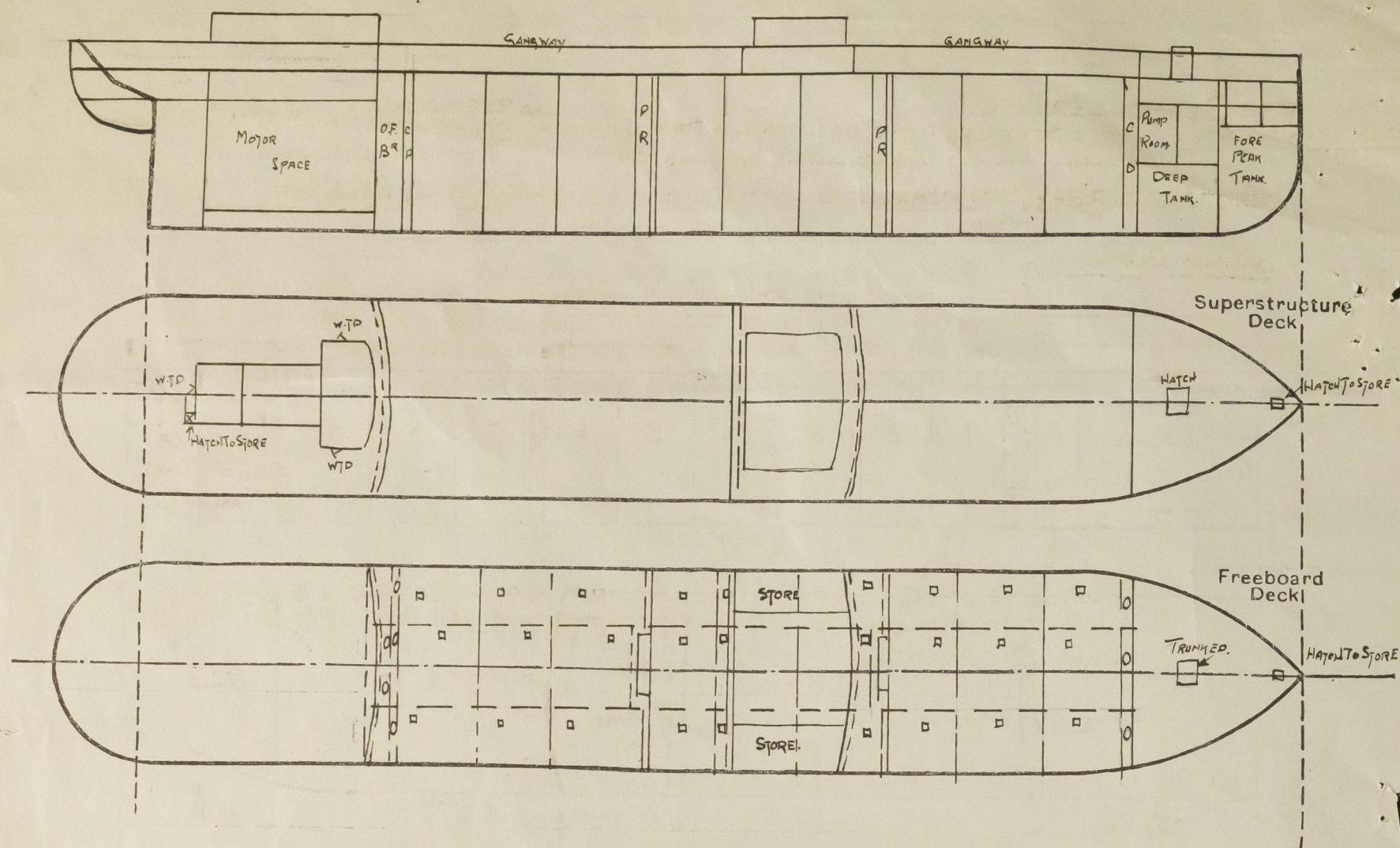

Particulars of fiddle, funnel and ventilator coamings, engine room skylight and other openings in machinery casing tops and their means of closing:—

ENGINE ROOM SKYLIGHT OF STEEL STRONGLY CONSTRUCTED. ✓
FIDDLE, FUNNEL & VENTILATOR COAMINGS EFFICIENT. ✓
FIDDLE GRATINGS FITTED WITH STRONG HINGED STEEL COVERS. ✓

Particulars of Flush Bunker Scuttles:— NONE ✓

Particulars of Companionways:— PUMP ROOM ENTRANCES IN FORE & AFT WELLS. ✓
OPENINGS ENCLOSED BY STEEL HOUSE SUBSTANTIALLY CONSTRUCTED. ✓
WITH HINGED W. T. DOOR AT AFTER END, SILL 18". ✓
DOORS WORKABLE FROM BOTH SIDES. ✓
ALSO COMPANION TO POOP TWIN DECKS CONSTRUCTED OF STEEL & ✓
HAVING HINGED W. T. DOOR WITH SILL 18" HIGH & WORKABLE FROM BOTH SIDES. ✓

Particulars of Ventilators in exposed positions on freeboard and superstructure decks:—

FORECASTLE DECK:—
2-10" DIA COWL VENTS TO FORE HOLD COAMING 36x32 ✓
2-10" " " " " TWIN DECKS " 36x32 ✓
1-10" " " " " PUMP ROOM " 36x32 ✓
2-8" " " " " STORE " 36x30 ✓
3-6" " " " " ROPE STORES " 36x30 ✓
POOP DECK
11-6" S.N. VENTS TO LAVY 36" HIGH ✓
1-12" COWL " " 2nd DECK COAMING 30x34 ✓
1-8" " " " REFRIG MACHY " 30x30 ✓
1-6" " " " ROPE STORE " 30x30 ✓
1-10" " " " STEERING GEAR " 30x32 ✓

FORE & AFT WELLS

1-24" DIA DERRICK POST PAS TO EACH PUMP ROOM CONNECTED TO PUMP ROOM ENTRANCE HOUSE & STAYED. ✓

BRIDGE DECK

7-6" DIA VENTS TO BRIDGE SPACE STORES COAMINGS 30x30 ✓

ALL VENTILATORS CONSTRUCTED ACCORDING TO THE RULES & FITTED WITH EITHER STEEL SCREW DOWN W. T. COVERS OR WOOD PLUGS WITH CANVAS COVERS. ✓

Particulars of Air Pipes in exposed positions on freeboard, raised quarter, or superstructure decks:—

FORECASTLE DECK
2 S.N. AIR PIPES 4" DIA TO FORE PEAK 18" HIGH. ✓
2 " " " " " DEEP TANK 18" " ✓
FORWARD WELL
2-3" DIA AIR PIPES TO COFFERDAM LED UP. ✓
FORECASTLE FRONT 6'6" ABOVE DK. ✓
AFTER WELL
2-3 1/2" DIA AIR PIPE TO COFFERDAM ✓
2-4" " " " " OF BUNKER } LED UP POOP DECK TO ✓
2-3" " " " " " SETTLING TANKS } 2'6" ABOVE POOP DECK ✓

POOP DECK
2-3" AIR PIPES TO AFT PEAK TANK ✓
2-3" " " " " F.W. TANK ✓
BOAT DECK & CASING TOP
2-3" AIR PIPES TO OIL FUEL DB 1'6" HIGH. ✓
2-3 1/2" " " " LUB OIL DB " " ✓
2-2" " " " COFFERDAM DB " " ✓
2-3 1/2" " " " COOKING WATER DB " " ✓

ALL AIR PIPES FROM OIL SPACES. ✓
FITTED WITH COPPER GANZE ELSEWHERE. ✓
WOOD PLUGS FITTED. ✓

Particulars of Gangway Cargo and Coaling Ports:—

Desmoulea.

- NONE -

Particulars of Scuppers and Sanitary Discharge Pipes:—

SCUPPERS:— In Wells. 6" RPE SCUPPERS FITTED AT ENDS OF POOP & BRIDGE DISCHARGING ABOUT 18" BELOW FREEBOARD DK. ✓
STRINGER BAR CUT FOR REMAINING SCUPPERS. ✓

IN POOP & FORECASTLE DECKS:— DISCHARGE OVERBOARD & FITTED WITH STORM VALVES AT SHIPS SIDE ✓
& BRASS SCREWED PLUGS AT INNER END. ✓

SANITARY DISCHARGES:—

FROM ENCLOSED SPACES FITTED WITH STORM VALVES AT SHIPS SIDE & BEND AT INNER END. ✓
STORM VALVES FROM POOP & FORECASTLE SPACES ABOUT 6'0" BELOW FREEBOARD DK. ✓
" " " BRIDGE HOUSES FITTED ABOVE FREEBOARD DECK. ✓

Particulars of Side Scuttles:—

SIDELIGHTS ARE FITTED IN POOP, BRIDGE & FORECASTLE SPACES 8" TO 10" DIA. ✓
ALL SIDELIGHTS ARE OF SUBSTANTIAL CONSTRUCTION & ARE FITTED WITH HINGED STEEL DEADLIGHTS. ✓

Vertical distance of Sill of lowest Side Scuttle above top of keel NO SIDELIGHTS FITTED BELOW FREEBOARD DECK ✓

Particulars of Guard Rails:— POOP, BRIDGE & FORECASTLE DECKS:— RAILS 3'6" HIGH WITH ROPE STANCHIONS SPACED ABOUT 5'0" APART. ✓
FORE & AFT WELLS:— RAILS & STANCHIONS BETWEEN BULWARKS 3'6" HIGH WITH 3 ROPE STANCHIONS SPACED 5'0" APART. ✓

Particulars of Gangways, Lifelines, etc.:—

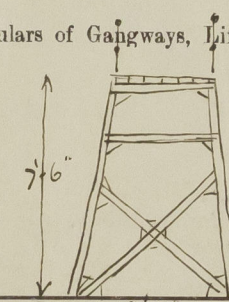

EFFICIENT GANGWAY FITTED OVER BOTH WELLS. ✓
ANGLE SUPPORTS 4x4x40 SPACED ABOUT 7'6" APART. ✓
DIAGONAL STAYS 3x3x30 ✓
PLATFORM ANGLES 4x4x40 ✓
F&A GIRDERS 6x3 1/2x40 CHANNEL ✓
SUPPORTS BRACED F&A WITH 3x3x30 ANGLE STAYS ✓
WOOD PLATFORM 5x3 WOOD SPARRED ✓
RAILS 3'3" HIGH 2 RODS & STANCHIONS 5'0" APART. ✓

Particulars of Freeing Arrangements.

	Length of Bulwark	Height of Bulwark	Size of Freeing Ports	Number each side	Area each side	Rule area each side
After Well ...	FOR OF POOP 17'3"	3'6"	3'0"x1'6" OVAL	1	4.75	OPEN RAILS
	AFT OF BRIDGE 60'0"			2	9.5	78'3" ✓
Forward Well ...	FOR OF BRIDGE 15'3"	3'6"	3'0"x1'6" OVAL	1	4.75	OPEN RAILS
	AFT OF F&A 29'3"			1	4.75	64'2" ✓

State position of each freeing port ... { After Well:—
(F. and A. position and height above deck edge) { Forward Well:—

State whether the freeing ports are fitted with shutters, bars, or rails, and give particulars of such:— FITTED WITH 3 VERTICAL BARS. ✓

Additional area where sheer is less than standard.

PARTICULARS OF PROTECTION TO OPENINGS, ETC.

HATCHWAYS ON FREEBOARD AND SUPERSTRUCTURE DECKS.									
Description of Hatchway	
Dimensions of Hatchway	
COAMINGS	{	Height above Deck
		Thickness
		Sides
		Ends
		Stiffeners
HATCH BEAMS	{	Number
		Spacing
		Scantling and Sketch
		Bearing Surface
	
FORE AND AFTERS	{	Number
		Spacing
		Unsupported Lengths
		Scantling* and Sketch
		Bearing Surface
HATCH COVERS	{	Material
		Thickness
		How fitted
		Bearing Surface
Spacing of Cleats	
Number of Tarpaulins	
<p>*Are wood fore and afters steel shod at all bearing surfaces ?</p> <p>Are battens and wedges efficient and in good condition ?</p> <p>Are tarpaulins in good condition and in accordance with rule requirements ?</p> <p>Are lashings provided in accordance with rule requirements ?</p>									

Particulars of any special features:—

Endorsement at first survey and at surveys for renewal of Certificate:—

The fittings and appliances are in accordance with the particulars shown on this form (or as now modified) and are in good condition.

