

Lloyd's Register of Shipping.
SURVEYS FOR FREEBOARD.
(CONDITIONS OF ASSIGNMENT.)

GRK REPORT N° 22486.

Ship's Name PROSPECTOR. Port of Survey GREENOCK.
Official Number _____ Surveyor's Signature Kenneth Lyle
Nationality and Port of Registry BRITISH LIVERPOOL. Date of Survey WHILE BUILDING. 1943.

Disposition and dimensions of superstructures, trunks, deckhouses and machinery casings to be inserted in the diagrams and tabular statement : --

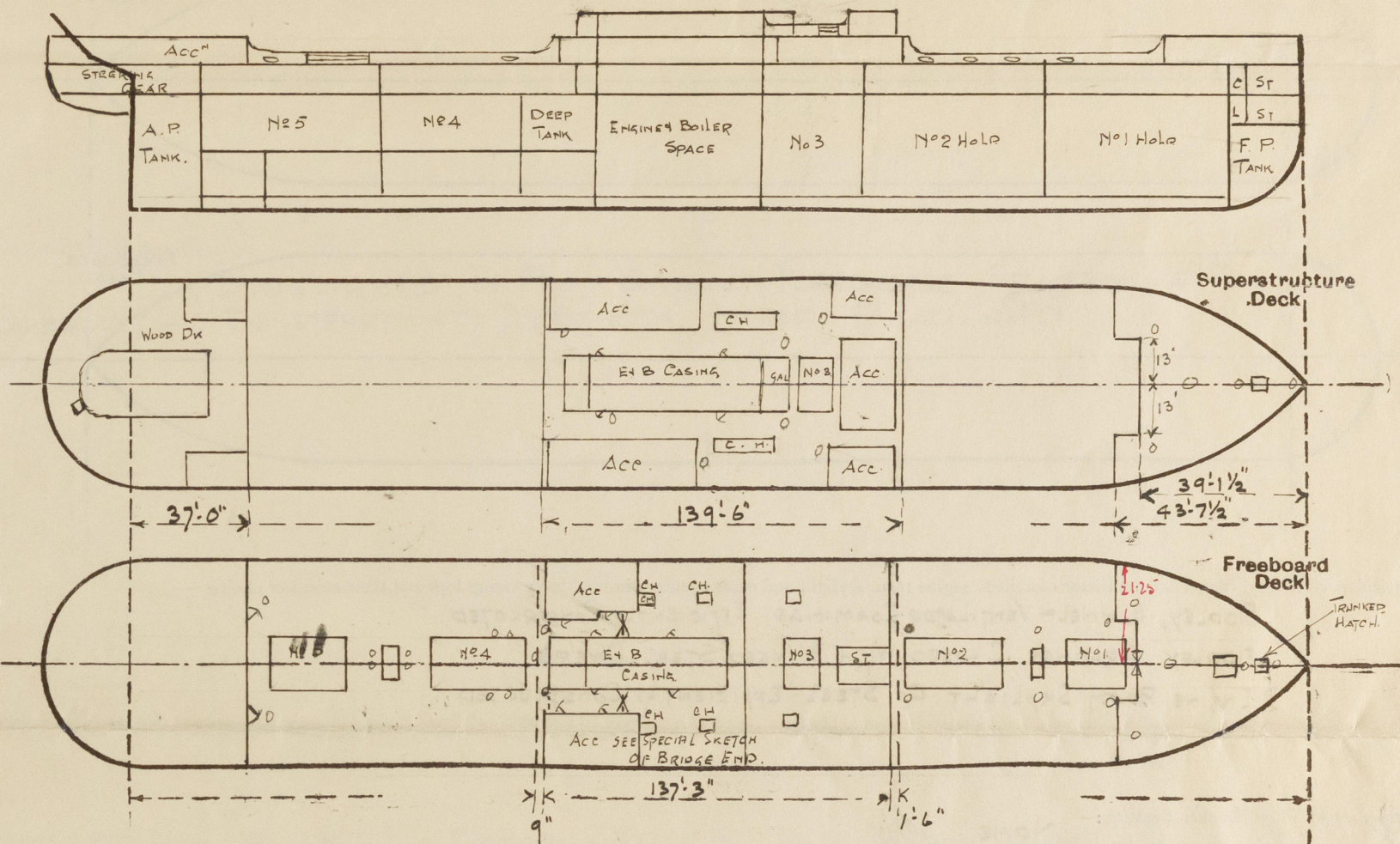

Particulars of Superstructures, Trunks, Casings, Deckhouses.

	Coaming	Plating	Stiffeners	Spacing	End Attachments of Stiffeners	Size of Openings	Height of Sills	Height of Casings
Poop Bulkhead ...	38	38	6x3x32 BA	30" ✓	LUGS	2@ 5'x2'	18"	7-11 1/2
Raised Quarter Deck Bulkhead ...	✓							
Bridge, After Bulkhead ...	30	30	4x3x32 QA	30" ✓	NONE	{ 1 @ 5'x3'-0" 1 @ 5'x4'-6"	18"	7-11 1/2
Bridge, Forward Bulkhead ...	44	44	9x3 1/2x50 BA	30" ✓	LUGS	NONE	✓	7-11 1/2
Forecastle Bulkhead ...	30	30	4x3x32 QA	30" ✓	NONE	2@ 5'-6"x4'-0"	12"	7-11 1/2
Trunk, Aft ...	✓							
Trunk, Forward ...	✓							
Exposed Machinery Casings on Freeboard or Raised Quarter Decks ...	✓							
Exposed Machinery Casings on Superstructure Decks ...	40	40	3x3x300A	44" To 28"	LARGE BRACKETS AT TOP	5'x2'-6"	21"	7-9 1/2
Machinery Casings within Superstructures not fitted with Class I Closing Appliances ...	40	40	3 1/2x3x300A	27"	CONTINUOUS	5'x2'-6"	18"	7-11 1/2
Deckhouses on Flush Deck Ships ...								

Particulars of Closing Appliances (state if capable of being manipulated from both sides).

Poop Bulkhead ...	2" HARDWOOD DOORS WORKABLE FROM BOTH SIDES. ✓
Raised Quarter Deck Bulkhead ...	✓
Bridge, After Bulkhead ...	FULL HEIGHT CHANNELS & BOARDS 3/4" THICK IN CHANNELS RIV'D TO BHP & WOOD DOORS TO SIDEHUSES. ✓
Bridge, Forward Bulkhead ...	NO OPENINGS ✓
Forecastle Bulkhead ...	CHANNELS & BOARDS (3/4") FULL HEIGHT IN CHANNELS RIV'D TO BHP ✓
Exposed Machinery Casings on Freeboard or Raised Quarter Decks ...	✓
Exposed Machinery Casings on Superstructure Decks ...	STEEL DOORS WORKABLE FROM BOTH SIDES. ✓
Machinery Casings within Superstructures not fitted with Class I Closing Appliances ...	- DITTO - ✓
Deckhouses on Flush Deck Ships ...	✓

PARTICULARS OF PROTECTION TO OPENINGS, ETC.

The following diagrams should be used to indicate the positions of cargo and coaling hatchways, gangway, cargo and coaling ports, ventilators, companionways, etc., which would affect the seaworthiness of the ship:—

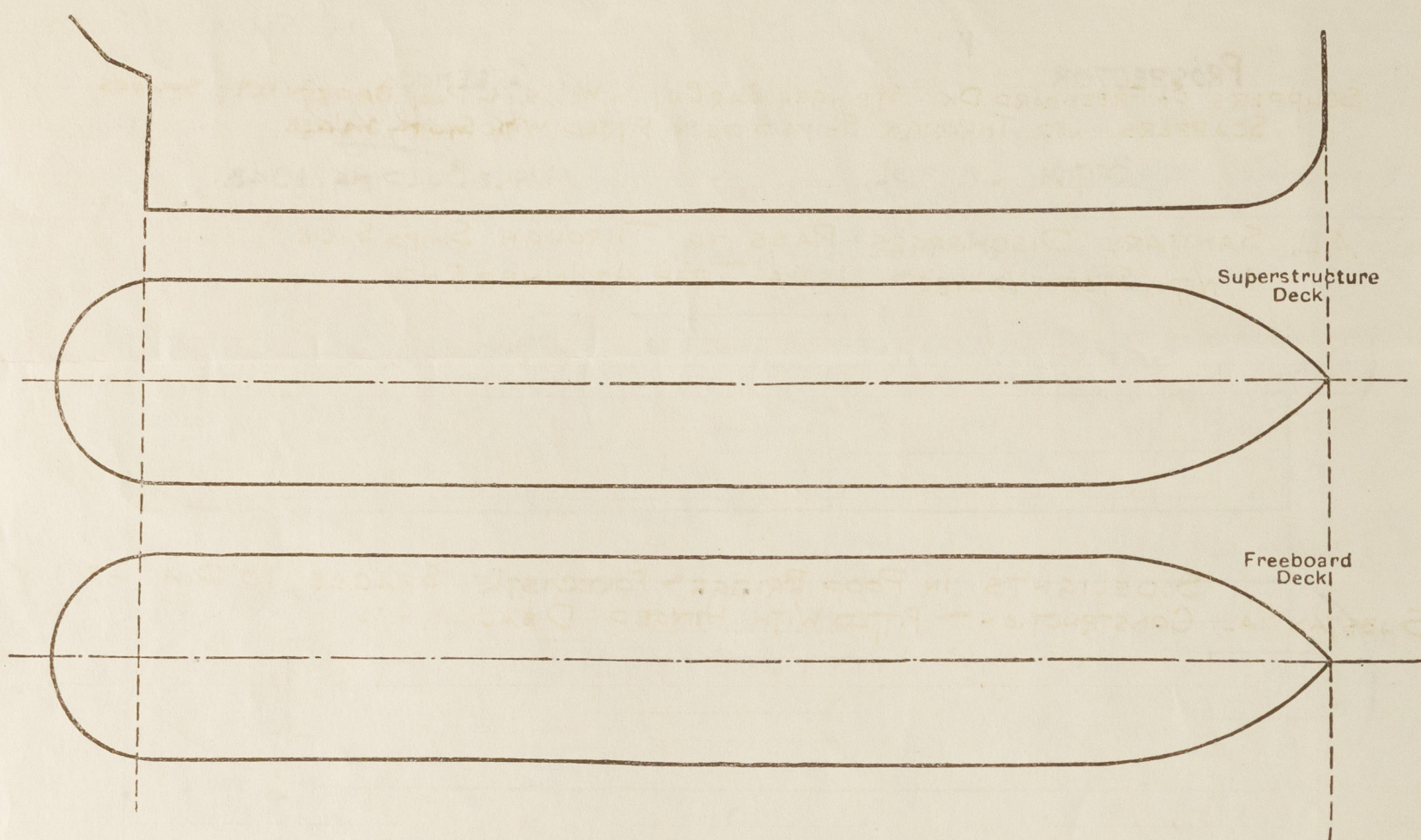

Particulars of fiddle, funnel and ventilator coamings, engine room skylight and other openings in machinery casing tops and their means of closing:—

FIDDLEY, FUNNEL & VENTILATOR COAMINGS EFFICIENTLY CONSTRUCTED ✓

FIDDLEY GRATINGS CLOSED WITH HINGED STEEL COVERS ✓

ENGINE ROOM SKYLIGHT OF STEEL EFFICIENTLY CONSTRUCTED ✓

Particulars of Flush Bunker Scuttles:— NONE ✓

Particulars of Companionways:— NONE ✓

Particulars of Ventilators in exposed positions on freeboard and superstructure decks:—

POOP DK
2-6" DIA To MAGAZINE 30" x 30"
2-6" " " DRYING ROOM 30" x 30"
15-8" " " ACE 30" x 30"
4-10" " " PASSAGES 30" x 32"
1-12" " " TUNNEL ESCAPE 30" x 34"
BRIDGE DK
2-18" " " HOLD 36" x 40"
2-18" " " TWIN DKS 36" x 40"
2-20" " " HOLD 36" x 40"
4-15" DIA To TWIN DKS 30" x 30"
2-7" " " STEWARDS 30" x 30"
1-12" " " TUNNEL ESCAPE 30" x 34"
FORE DECK
1-22" DIA To HOLD 36" x 40"
2-18" " " FORE TWIN DKS 36" x 40"
1-10" " " STORE 36" x 32"
1-9" " " CHAIN LOCKER 36" x 32"

UPPER DK FOREWELL
8-18" DIA To HOLD 48" x 40" ✓

UPPER DK AFTWELL
9-18" DIA To HOLD 48" x 40"
2-15" " " DEEP TANK 48" x 40" ✓

2- D.P. TO DEEP TANK ✓

ALL VENTILATORS CONSTRUCTED TO RULE REQUIREMENTS
& PROVIDED WITH WOOD PLUGS & CANVAS COVERS
COAMINGS OVER 2'-0" IN HEIGHT STAYED. ✓

Particulars of Air Pipes in exposed positions on freeboard, raised quarter, or superstructure decks:—

POOP DK
2-2" DIA S.N. AIR PIPE To AFT PEAK TANK ✓

BRIDGE DK
8-2 1/2" DIA S.N. A.P. To D.B. TANKS ✓

UPPER DK AFTWELL
8-2 1/2" DIA S.N. A.P. To D.B. TANKS ✓
2-2 1/2" " " A.P. FROM DERRICK POST To AFT PEAK TANK ✓

FOREWELL
4-2 1/2" DIA S.N. A.P. To D.B. TANKS ✓

FORECASTLE DK
1-3 1/2" DIA S.N. A.P. To D.B. TANKS ✓
1-3 1/2" DIA " " " FORE PEAK TANK ✓

AIR PIPES IN WELLS 36" HIGH ✓
" " ON POOP BRIDGE & FORECASTLE 18" HIGH ✓

AIR PIPES FITTED WITH WOOD PLUGS &
ANTI-SABOTAGE GANZE. ✓

Particulars of Gangway Cargo and Coaling Ports:— NONE ✓

Particulars of Scuppers and Sanitary Discharge Pipes:—

SCUPPERS ON FREEBOARD DK: STRINGER BAR CUT IN WELLS, IN POOP BRIDGE FOLE SPACES
SCUPPERS LED THROUGH SHIPS SIDE & FITTED WITH STORM VALVES. ✓

ALL SANITARY DISCHARGES PASSING THROUGH SHIPS SIDE FITTED
WITH STORM VALVES & USUAL TRAP AT INNER END ✓

Particulars of Side Scuttles:—

SIDELIGHTS IN POOP BRIDGE & FORECASTLE SPACES, 10" DIA, OF
SUBSTANTIAL CONSTRUCTION & FITTED WITH HINGED DEADLIGHTS. ✓

Vertical distance of Sill of lowest Side Scuttle above top of keel NO SIDELIGHTS BELOW FREEBOARD DK ✓

Particulars of Guard Rails:— POOP & FOLE DECKS:— RAILS 3'-6" HIGH WITH 4 RODS & STANCHIONS 4'-6" APART
BRIDGE DECK: STEEL BULWARK 3'-6" HIGH. STRONGLY CONSTRUCTED WITH
OPEN RAILS IN WAY OF HATCH. ✓

Particulars of Gangways, Lifelines, etc.:—

LIFELINES PROVIDED IN FORE & AFT WELLS. ✓

Particulars of Freeing Arrangements.

	Length of Bulwark	Height of Bulwark	Size of Freeing Ports	Number each side	Area each side	Rule area each side
After Well ...	103'-6"	4'-0"	4'-0" x 1'-6" 4. 21'-0" OPENING FOR A.M.O. GEAR	2	11.04 sf. + 21.0 sf. Open rails.	20.7 sf. ✓
Forward Well ...	97'-0"	4'-0"	4'-0" x 1'-6"	4	22.08 sf.	19.4 sf. ✓

State position of each freeing port ... { After Well:— 22' 9" AFT OF BRIDGE END 15" ABOVE DK
(F. and A. position and height above deck edge) { Forward Well:— 5' 35' 46' 46" FOR OF BRIDGE FRONT

State whether the freeing ports are fitted with shutters, bars, or rails, and give particulars of such:— ROUND BAR IN EACH FREEING PORT ✓

Additional area where sheer is less than standard.



© 2020

Lloyd's Register
Foundation

0201 2/2

PARTICULARS OF PROTECTION TO OPENINGS, ETC.

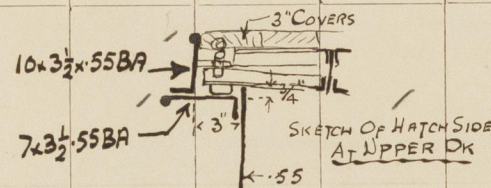
HATCHWAYS ON FREEBOARD AND SUPERSTRUCTURE DECKS.									
Description of Hatchway		Nº1	Nº2	Nº3 BRIDGE DECK	Nº3 UPPER DK	Nº4	Nº5		
Dimensions of Hatchway		29'3" x 17'	33'9" x 17'	9' x 17'	11'3" x 17'	36' x 17'	22'6" x 17'	SMALL HATCHES	
COAMINGS	Height above Deck	30	30	30	30 19"	19 30"	30	FORECASTLE DECK 2'6" x 2'0"	
	Thickness	55	55	55	55	55	55	COAMING 18" x 40" FITTED WITH W.T. STEEL COVER 40" THICK WITH BOLTS SPACED 4 1/2" APART & TRUNKED TO UPPER DK.	
	Stiffeners	2" DIA ENDS	2	2	2	2	2	UNDER FORECASTLE 3'0" x 3'0"	
	Brackets, Stays	2" DIA ENDS	2	2	2	2	2	COAMING 9' x 3' x 40 BA 3" WOOD COVERS ONE TARPANLIN CLEAT 24" APART & USUAL BATTENING ARRANGEMENTS. BRIDGE DK 18' x 4' P+S.	
HATCH BEAMS	Number	4-10 1/2	4-9 1/2	4-6	5-7 1/2	4-6	4-6	COAMING 30" x 48" STIFFENED BY 3" x 3" ANGLES ATTACHED TO BEAMS. COVERS 3" THICK WITH CLEATS 24" APART & TWO TARPANLINS.	
	Spacing	14' x 34'	14' x 34'	13' x 34'	14' x 34'	14' x 34'	14' x 34'	UNDER BRIDGE 4'6" x 4' P+S 9" BA COAMING.	
	Scantling and Sketch	4' x 3' x 46	4' x 3' x 46	3' x 3' x 40	5' x 3' x 47	4' x 3' x 44	4' x 3' x 44	5' x 5' P+S 30" x 40 COAMING. 5' x 6' 9" P+S 30" x 40 COAMING. 3" COVERS & ONE TARPANLIN. CLEAT SETC	
	Bearing Surface	3	3	3	3	3	3	COALING HATCH ON BOAT DECK 5'0" x 16'0" COAMING 3' x 3' x 40 BA. 3" WOOD COVERS 2 TARPANLINS CLEAT 24" APART & USUAL BATTENING ARR. HATCH TO MAGAZINE ON BOAT DECK 2'0" x 1'9" FITTED WITH STEEL WATERTIGHT COVER.	
FORE AND AFTERS	Number								
	Spacing								
	Unsupported Lengths								
	Scantling and Sketch								
HATCH COVERS	Material	W.P.	W.P.	W.P.	W.P.	W.P.	W.P.		
	Thickness	3"	3"	3"	3"	3"	3"		
	How fitted	F+A	F+A	F+A	F+A	F+A	F+A		
	Bearing Surface	3"	3"	3"	3"	3"	3"		
Spacing of Cleats		24	24	24	24	24	24		
Number of Tarpaulins		2	2	2	1	2	2		
<p>*Are wood fore and afters steel shod at all bearing surfaces? <input checked="" type="checkbox"/> YES</p> <p>Are battens and wedges efficient and in good condition? <input checked="" type="checkbox"/> YES</p> <p>Are tarpaulins in good condition and in accordance with rule requirements? <input checked="" type="checkbox"/> YES</p> <p>Are lashings provided in accordance with rule requirements? <input checked="" type="checkbox"/> YES</p>									

Particulars of any special features:—

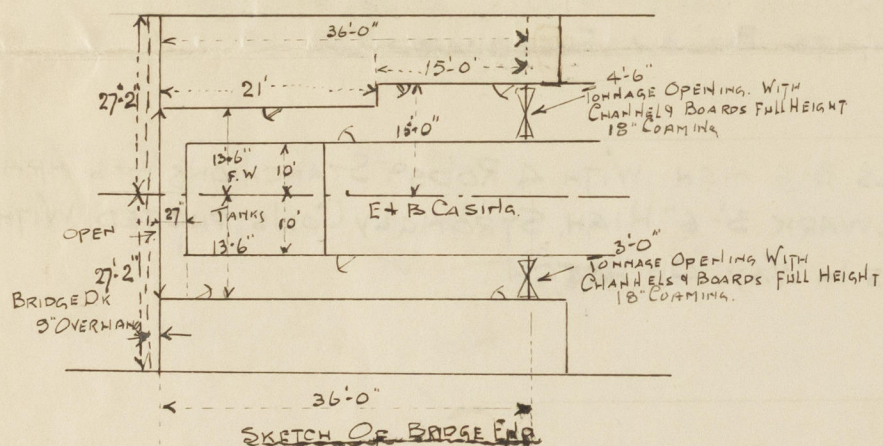

Endorsement at first survey and at surveys for renewal of Certificate:—

The fittings and appliances are in accordance with the particulars shown on this form (or as now modified) and are in good condition.



© 2020

Lloyd's Register Foundation