

LLOYD SABAUDO
GENOVA

"CONTE BIANCAMANO"

Piroscafo a combustione liquida e turbine con doppia elica

STAZZA LORDA TONN. 24.000
LUNGHEZZA METRI 198 - LARGHEZZA METRI 23
FORZA CAVALLI ASSE 24.000

Twin-Screw Turbine Oil-Burning Steamer

GROSS TONNAGE 24,000
LENGTH 650 FEET - BEAM 75 FEET
I. H. P. 24,000

PRIMA CLASSE
FIRST CLASS
SECONDA CLASSE
SECOND CLASS
SECONDA CLASSE INTERMEDIA
INTERMEDIATE SECOND CLASS

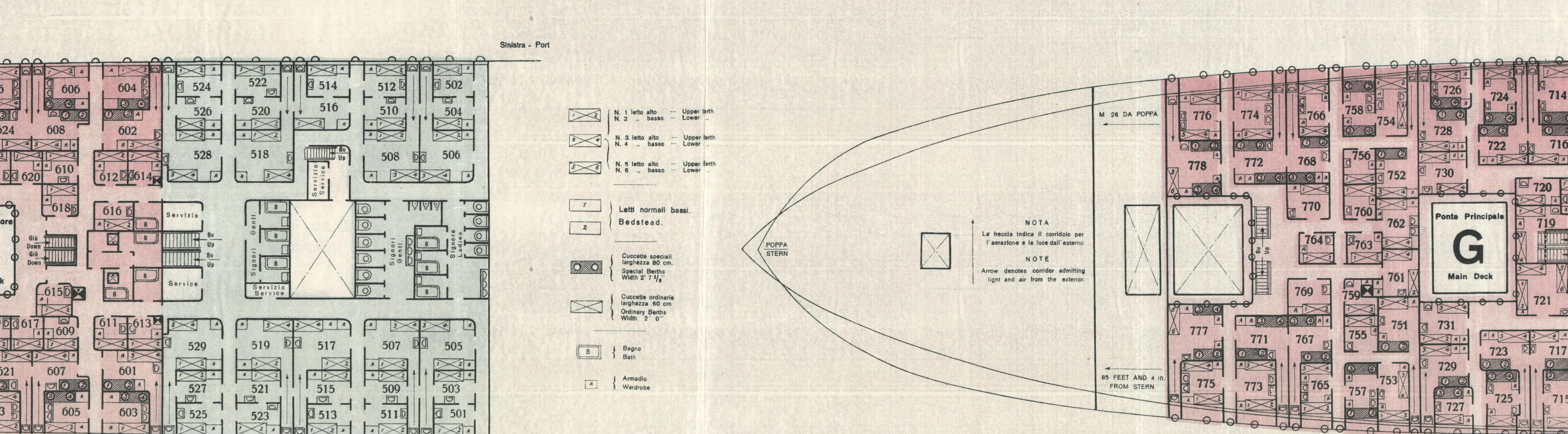
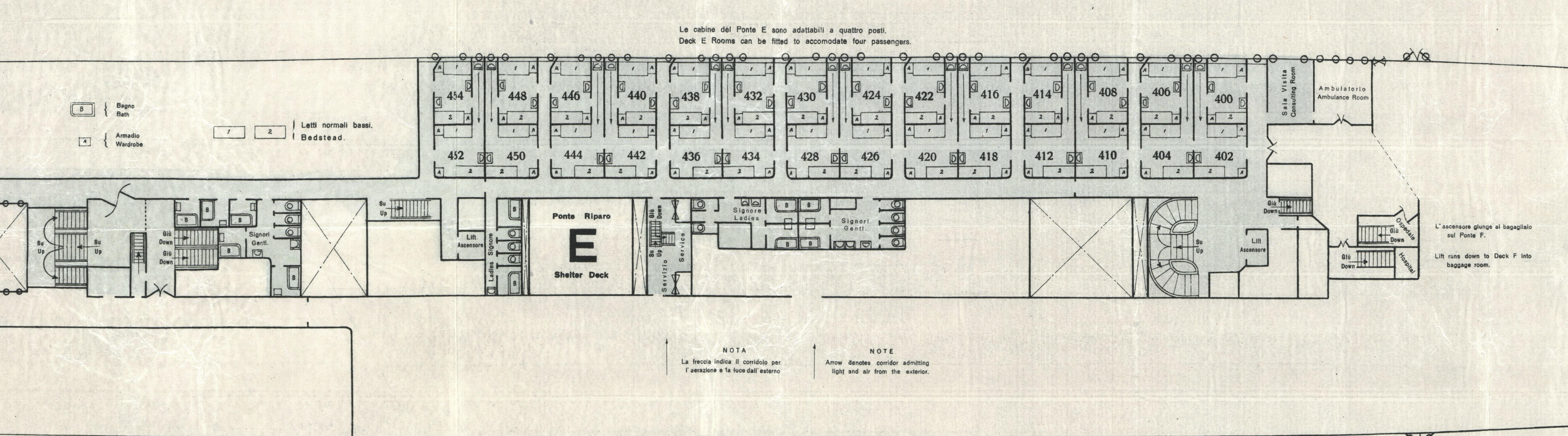
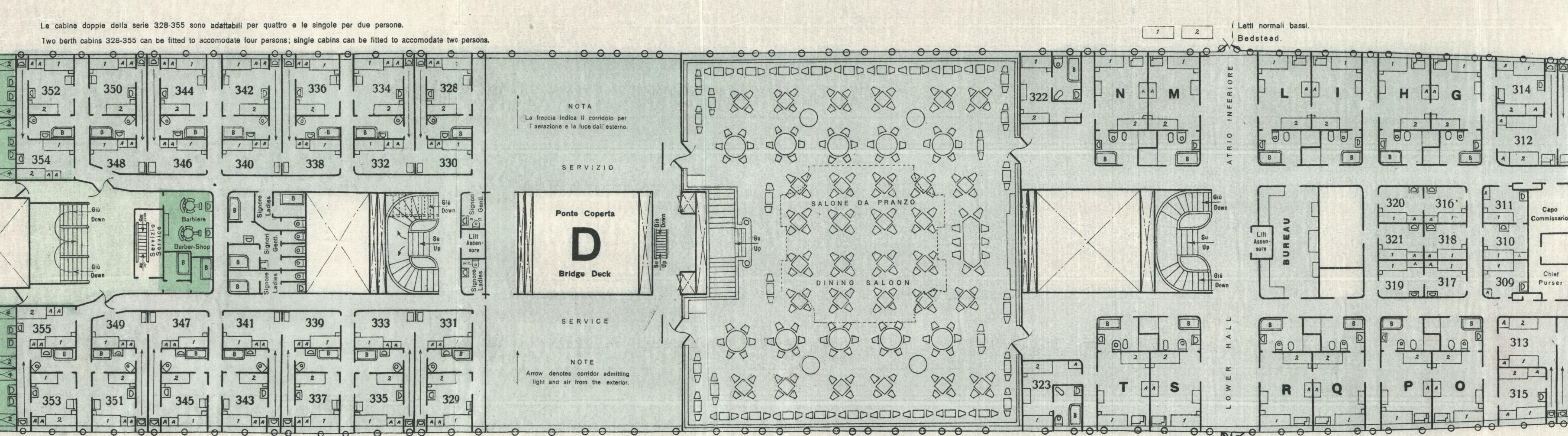
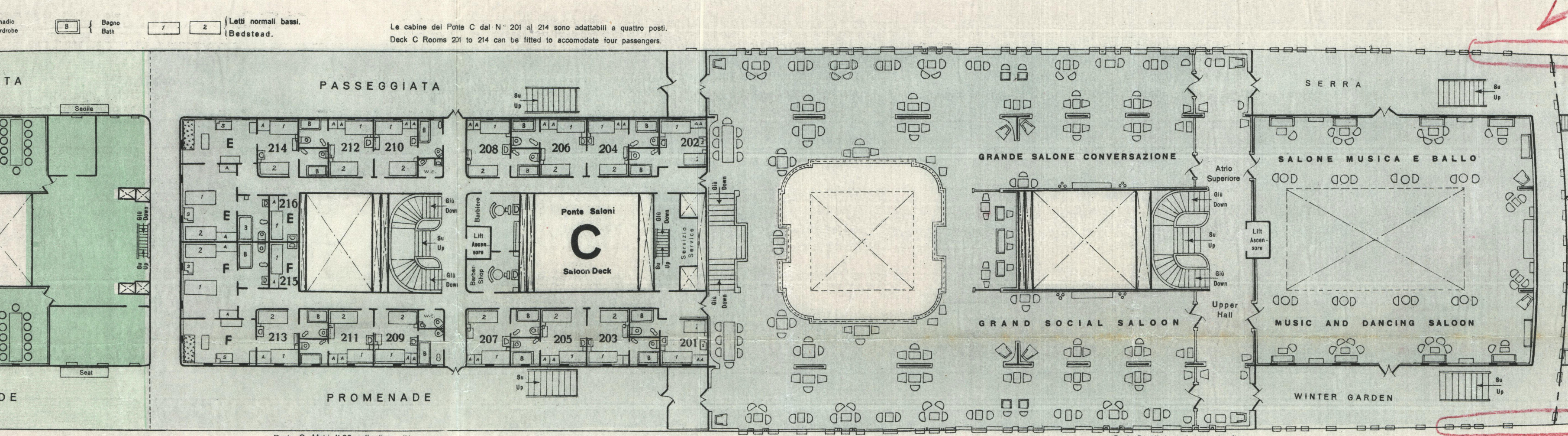
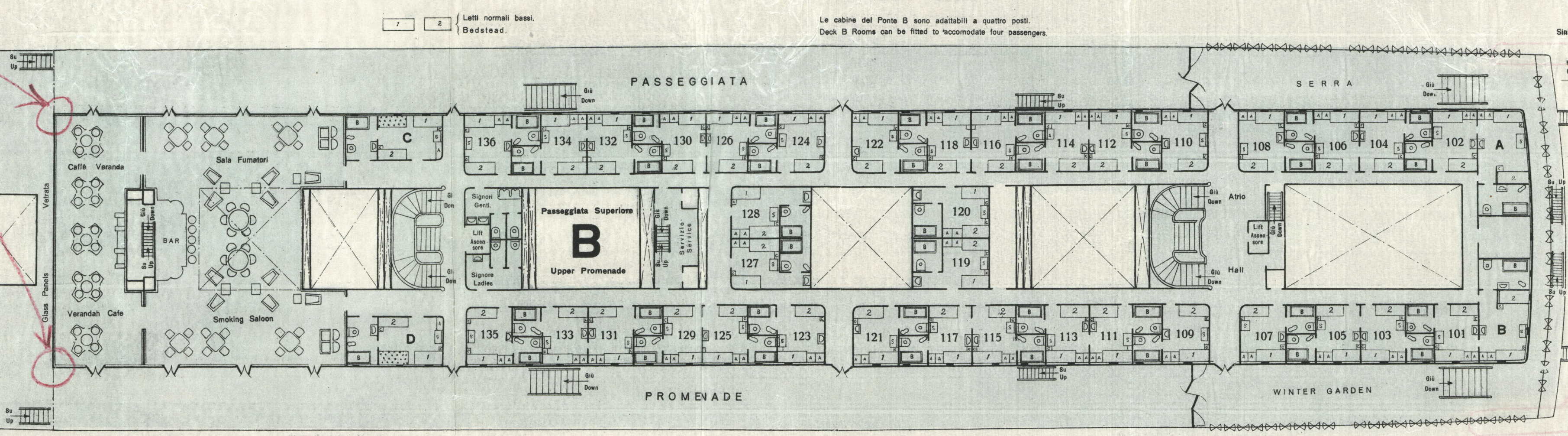
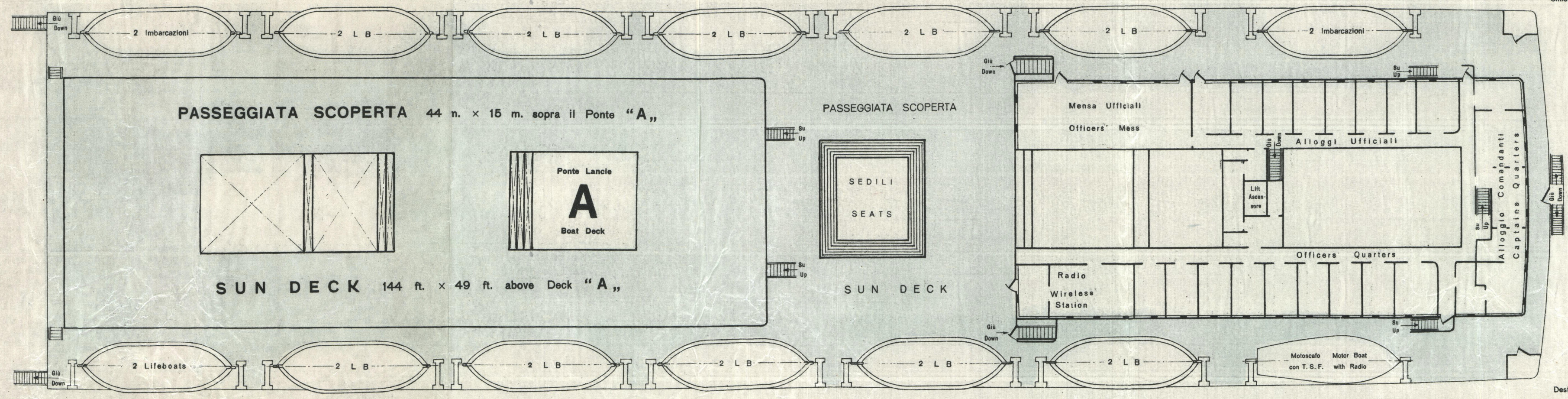
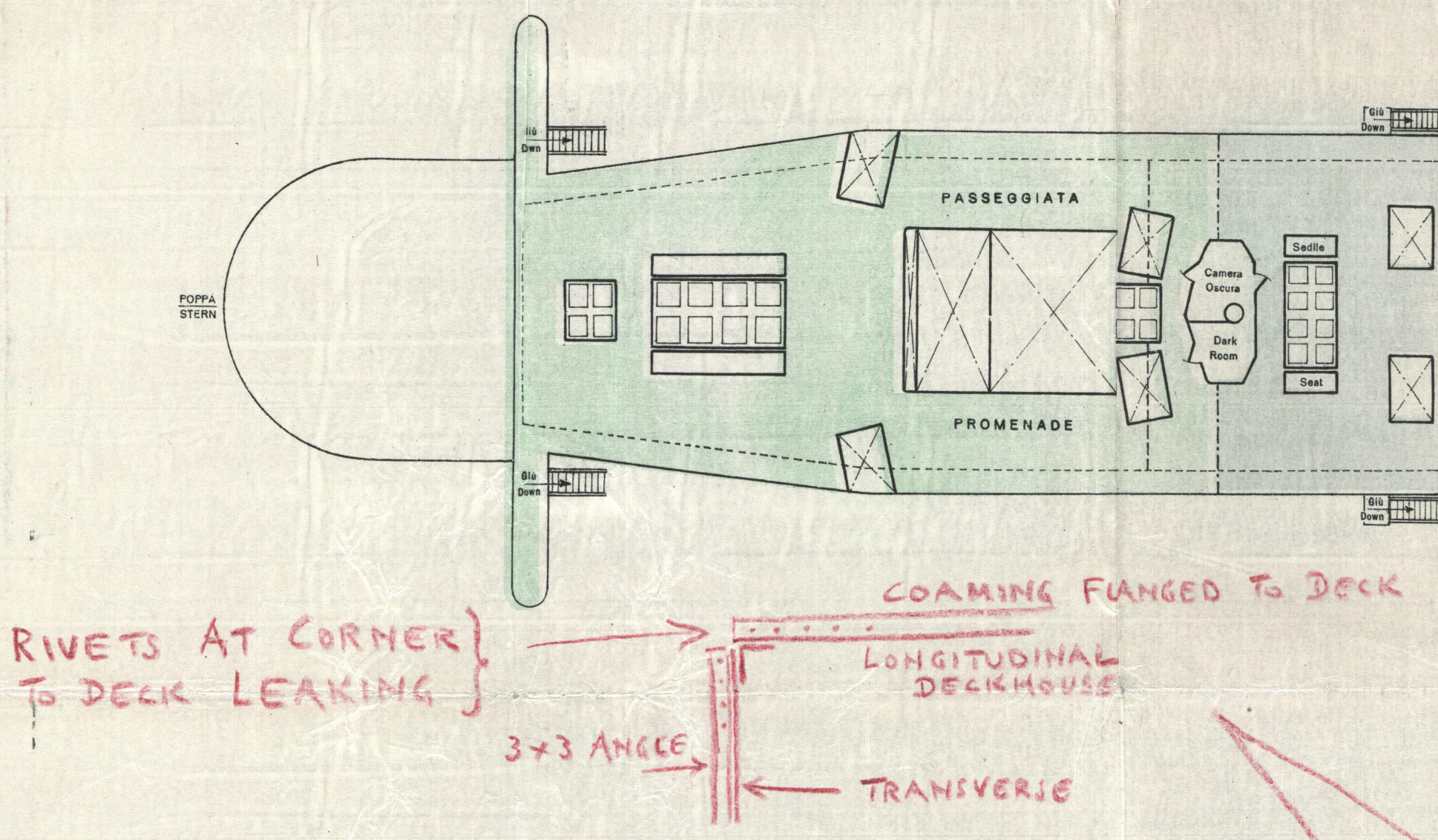

POSITION OF
FRACTURED PLATING
AT WINDOWS &
BULKHEAD RISING
PLATE TO FRONT
BULKHEAD