

Lloyd's Register of Shipping.

SURVEYS FOR FREEBOARD.-STEAM SHIPS.

REGULARS RELATING TO ALL STEAM SHIPS EITHER FLUSH DECKED, OR WITH GALLANT FORECASTLES, SHORT POOPS AND BRIDGE HOUSES DISCONNECTED, OR WITH TOP GALLANT FORECASTLES HAVING LONG POOPS, OR RAISED QUARTER DECKS CONNECTED WITH BRIDGE HOUSES, OR OTHERWISE.

Port of Survey GOTHENBURG
Date of Survey 11-12-24 & 27-2-25
Name of Surveyor H.T. & J.H.K

Ship's Name. "ROSLAGEN"
(STEAMER)
Number in Register Book 90567
Port of Registry and Nationality. STOCKHOLM
SWEDISH
Official Number. ✓
Gross Tonnage. ✓
Date of Build. 1925
Particulars of Classification. +100A1 (CONTEMPLATED)

Registered dimensions from Ship's Register.	LENGTH.	BREADTH.	DEPTH.	UNDER DECK TONNAGE.
	<u>262.01</u>	<u>42.71</u>	<u>18.11</u>	<u>1617.67</u>
Length on LOADLINE.	<u>264'-8 1/2"</u>	Frame Depth <u>8</u> Rule <u>5/3</u>	Ceiling <u>fitted</u> Sheer <u>4.55</u> <u>To Tank Top</u> <u>18.83</u>	Peak Tanks
CORRECTED DIMENSIONS.	<u>264.7</u>	<u>42.21</u>	<u>18.88</u>	<u>1614.67</u>

Co-efficient of fineness.....

.77Any modification necessary
[Para. 4 (a) to (e)]*C.O.B

Co-efficient as corrected

.75Sheer {Stem.....
at {Sternpost ...77
33 1/2110.5 ÷ 2 = 55.25 Mean36.47
19.83
56.36

Sheer at 1/8 of the length from {Stem

42 3/419 1/462 ÷ 2 = 31.0 Mean

Gradual mean Sheer

allowed. 55.80

Standard mean Sheer [Table, Para. 18]

36.4719.33 ÷ 4 = 4.83

§ If limited as Para. 18 (f)

- 4 3/4"Rise in Sheer
from amidships
[Para. 18 (e)]{ At front of bridge house.....
{ At after end of forecastleFall in Sheer
Para. 18 (d) }÷ 2 =

Length uncovered

✓ Correction

ALLOWANCE FOR DECK ERECTIONS :-

Freeboard, Table C.....

Correction for Length, if required (Para. 12, 13, and 14)

Freeboard by Table A, corrected for sheer, and for length,
if required (Para. 12, 13, and 14) }

Difference

Percentage as below.....

Correction for R. Q. Dk. if engine and boiler openings not
covered by bridge house (Para. 11)

Allowance for Deck Erections

	Length.	Length allowed.	Height.
Forecastle.....	<u>30'-9"</u>	<u>30.75</u>	<u>7'-0"</u>
Bridge House	<u>67'-0"</u>	<u>72.50</u>	<u>"</u>
OVERHUNG FORD	<u>2'-0"</u>	<u>"</u>	<u>"</u>
† Raised Q. Dk. AFT	<u>6'-0"</u>	<u>"</u>	<u>"</u>
Poop.....	<u>23'-8"</u>	<u>23.67</u>	<u>"</u>
Total		<u>126.92</u>	<u>5.48</u>
Length of Ship		<u>264.7</u>	

Corresponding percentage
(Para. 11, 12, 13, or 14) }30.6%FREEBOARD recommended amidships from centre of Disc to top of Statutory Deck Line, Wood (Steel) Deck :-

Fresh Water Line	above centre of Disc	...
Indian Summer Line	" " "	...
Winter Line	below " "	...
Winter North Atlantic Line	" " "	...

15 APR 1925

† If the frames, skin planking, or ceiling are of unusual thickness the breadth of vessel to inside of ceiling should be reported if possible.
† In vessels obtaining an allowance for deck erections under Para. 11 where the sheer drops abaft amidships the height of the R.Q.D. is to be taken from the level of the top of the amidship beam.
† In vessels having the total standard mean sheer means the sheer measured at the stem and sternpost, 1/8 of the vessel's length, from stem and sternpost.

Moulded Depth as measured.....

20'-6"Addition for Keel below base line
for draught record.....inches.

NOTE. — If the depth is measure when vessel is afloat, the details of measurement should be reported.

CORRECTION FOR LENGTH.

Length of Ship on Loadline.....

264.7

Length in Table

246.0

Difference

18.7

Correction for 10ft., Table A.

1.2

Table C.

.6

× Difference divided by 10

2.24 (if required.)1.12

If 1/8ths length covered divide by 2

+ 2 1/4"+ 1"

CORRECTION FOR IRON DECK.

Proportion covered, if less than 7/8ths length covered

.48

Thickness of usual wood deck, less stringer

3/2- 1 3/4"

CORRECTION FOR ROUND OF BEAM.

Breadth at Gunwale amidships.....

42'-0"

Round of Beam

10 1/2"

Normal round.....

10 1/2"

Difference

÷ 2 =

Proportion of Deck uncovered (Para. 19)

NOTE. — The round of beam should be reported on the full breadth of vessel at the gunwale.

Freeboard, Table A

Correction for Sheer

Correction for Length

Allowance for Deck Erections

Correction for Round of Beam.....

Correction for fall in Sheer (if any).....

Correction for Iron Deck (if required)

Additions for non-compliance with provisions of
Para. 11 (d) and (e) †

Other Corrections (if any)

Winter Freeboard

Summer Freeboard

Indian Summer Freeboard

N. A. Winter Freeboard

Correction necessary because clearside amidships, measured
in accordance with the Statute is not taken at the
intersection of the wood on steel deck with side.

Winter Freeboard from deck line

Summer " " " "

Indian Summer " " " "

N. A. Winter " " " "

2" 10"

4 1/2"

3"

3"

5"

† State dimensions of freeing port area on back of this form.

† The Surveyor should state whether the fall in sheer as reported is line of keel or to the water line. If measured relatively to water line, survey, and also the usual load draft forward and aft should be reported.

© 2021

Lloyd's Register
Foundation

Do all the Frames extend to the top height in the Poop? *yes* Raised Quarter Deck? *✓* Bridge House? *alt only* Forecastle? *✓*
To what height do the Reverse Frames extend? *Built angle frames*
Has the Poop or Raised Quarter Deck an efficient Iron Bulkhead at the fore end? *yes*
Give particulars of the means for closing the openings in Bulkhead *none*
Is the Poop or Raised Quarter Deck connected with the Bridge House? *no* Has the Bridge House an efficient Bulkhead at the fore end? *yes*
Give particulars of the means for closing the openings in Bulkhead *Hinged w. y. doors 3'-1" wide*
What is the thickness of the Bridge Front plating? *.36* and Coaming plate? *none*
Give scantlings and spacing of the Stiffeners *7 x 3 x .44 B.A. sp 27 1/2" webs at sides of doors*
Are bracket plates fitted at each end of the Stiffeners? *yes* Are hor'l. brackets fitted connecting Bridge Bulk'd. with Bulwarks? *yes*
Has the Bridge House an efficient Iron Bulkhead at the after end? *yes*
How are the openings closed? *3'-0" wide Bolted plates Bolts thro door only*
Is the Forecastle at least as high as the main or top-gallant rail? *yes* Has the Forecastle an efficient Iron or Wood Bulk'd. at after end? *no*
Are the Engine and Boiler openings covered by a Bridge, Poop, Raised Quarter Deck, or enclosed by a Strong Iron or Steel Deckhouse? *yes. Protected above Bridge deck as shown below*
If the openings are not so protected are the exposed parts of the Casings efficiently constructed? *✓*
Give thickness of plating; scantlings and spacing of Stiffeners *✓*
What is the height of the exposed Casings? *✓* Are suitable means provided for closing all openings in them in bad weather? *✓*
Are the Weather Deck Hatchways efficiently constructed and at least equal to the requirements of Section 28 of the Rules for 1904-5? Give particulars below:— *see particulars below*

Position and Size.		No. 4 29'-6" x 18'-0"									
Item.		Ship.	Rule.	Ship.	Rule.	Ship.	Rule.	Ship.	Rule.	Ship.	Rule.
COAMING.	Height above top of DECK	32"									
	Thickness { Sides.....	.50									
	Ends.....	.44									
SHIFTING BEAMS OR WEB PLATES.	Number.....	5									
	Section and Scantlings.....	16 x 36									
	Material.....	4 x 3 x 44 steel									
* FORE AND AFTERS.	Number.....										
	Section and Scantlings.....	none									
	Material.....										
HATCHES Thickness.....		2 1/2"									
Remarks.....											

* The depth of Fore and Afters should be stated from the underside of the hatches in all cases.
(If the sill of the lowest side scuttle will be less than 6 inches above the Indian Summer Load Line if assigned under the tables, state vertical distance from top of deck at side amidships to lower edge of lowest side scuttle.)
The following information is to be given in all Cases of vessels dealt with under Paras. 11, 12 (under 15 feet Moulded depth) and under Shelter Deck Rules.
What is the thickness of the Bridge Sheerstrake? *Strake between Main and Bridge Sheerstrakes?*
Delete the words { The Crew are, are not, berthed in the bridge house.
that do not apply { The arrangements to enable them to get backwards and forwards from their quarters are, are not satisfactory.

Length of Bulwarks in well *134 feet*
Area of Freeing Ports required by Para. 11 (e) each side of vessel = *27.0* Sq. ft. *plus only.*
Ft. Tenths. Ft. Tenths. No. } Freeing Ports (each side of vessel) = *31.4* Sq. ft. *plus*
2.8 x 1.8 x 6
2.7 x .6 x 1
Total deficiency or excess = *4.4* Sq. ft.

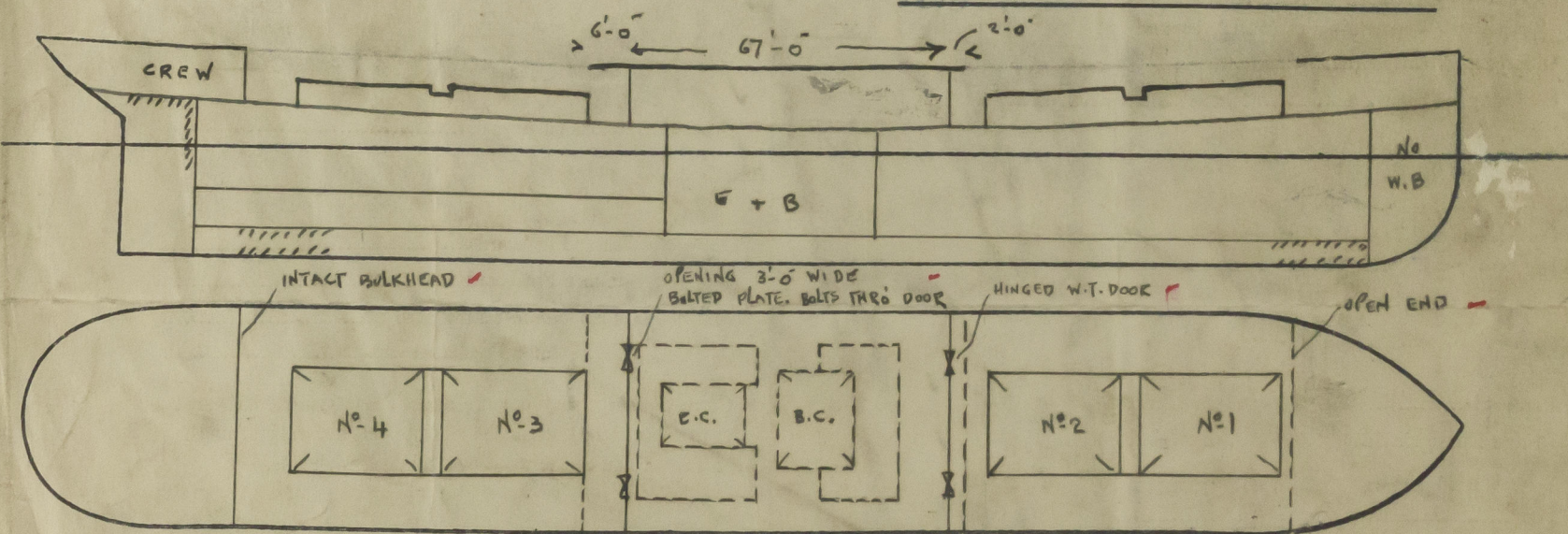

Show hereon line of Floors or Tank Top with position of any Breaks in same; also height of Peak Tank tops, &c., &c.
State any special features in the construction of the Vessel *2 1/2" ceiling on tank top - 1 3/4" cargo battens on ship's side - no openings below upper deck - scupper from bridge transverse deck led to bilge*
Builder's name and yard number *A.B. LINDHOLMEN - MOTALA. No 922*
Names of sister vessels *S.S. BOLHEIM No 64862 IN R.B.*
Owners *REDERI AKTIEBOLAGET ROSLAGEN*
Address *STOCKHOLM.*