

Lloyd's Register of Shipping.

SURVEYS FOR FREEBOARD.

(CONDITIONS OF ASSIGNMENT.)

Ship's Name EMPIRE CONDERTON (ex Lina Fisser) Port of Survey SHARPNESS.
 Official Number 127100 Surveyor's Signature A. Reid.
 Nationality and Port of Registry BRITISH LONDON. Date of Survey 12, 18, 21 Sept, 2, 5, 12, 16 Dec 1945.

Disposition and dimensions of superstructures, trunks, deckhouses and machinery casings to be inserted in the diagrams and tabular statement:—

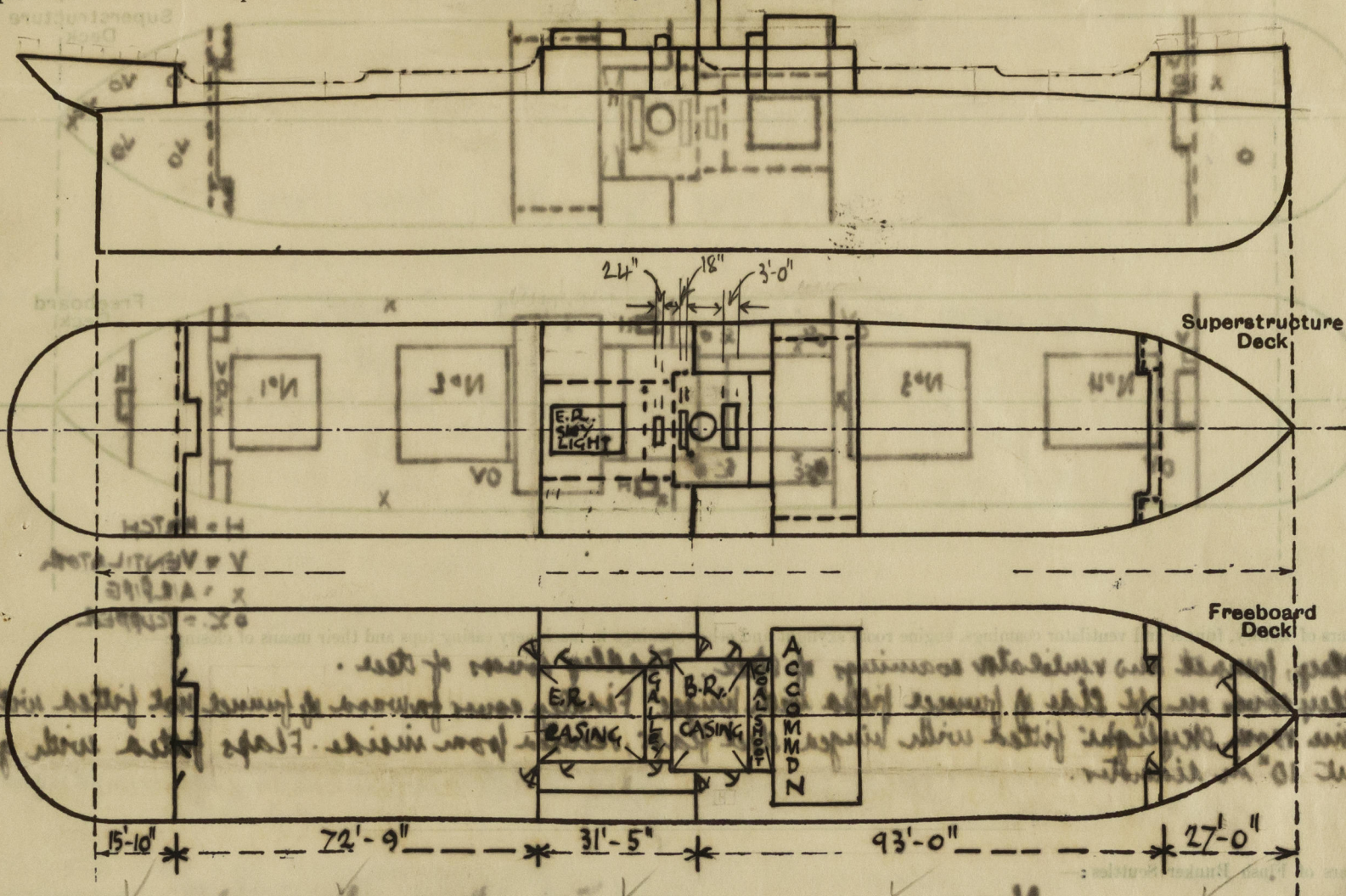

Particulars of Superstructures, Trunks, Casings, Deckhouses.

	Coaming	Plating	Stiffeners	Spacing	End Attachments of Stiffeners	Size of Openings	Height of Sills	Height of Casings
Poop Bulkhead ...	NONE	5/16"	5" x 3 1/2" x 3/8"	36"	NONE	4'-0" x 3'-0" House 5'-0" x 1'-11" S.S. 4'-10" x 1'-10"	22" 13" 12"	6'-6"
Raised Quarter Deck Bulkhead ...								
Bridge, After Bulkhead ...	NONE	1/4"	3" APPROX	3'-0" MAX	NONE	4'-11" x 2'-0 1/2"	18"	7'-0" & 7'-3"
Bridge, Forward Bulkhead ...	NONE	5/16"	3" APPROX	2'-0"	NONE	4'-11" x 2'-0 1/2"	18"	7'-0" & 7'-3"
Forecastle Bulkhead ...	NONE	1/4"	3" APPROX	?	NONE	4'-8" x 2'-0"	16" S. HOUSES 14" CENTRE	7'-0"
Trunk, Aft ...								
Trunk, Forward ...								
Exposed Machinery Casings on Freeboard or Raised Quarter Decks ...	3/8"	3/8"	3 1/2" x 3" x 5/16"	2'-8"	NONE	4'-6" x 1'-10"	19"	7'-3"
Exposed Machinery Casings on Superstructure Decks ...								
Machinery Casings within Superstructures not fitted with Class I Closing Appliances ...	3/8"	3/8"	3" x 1 1/2" x 1/4"	2'-11"	NONE	4'-6" x 1'-10"	20"	7'-3"
Deckhouses on Flush Deck Ships ...								

Particulars of Closing Appliances (state if capable of being manipulated from both sides).

Poop Bulkhead	S.S. BOLTED PLATE BOLTS 4 1/4" CENTRES. HOUSE STEEL DOORS MANIPULATED BOTH SIDES	S.S. RUBBER JOINTED STEEL DOOR MANIPULATED FROM BOTH SIDES.
Raised Quarter Deck Bulkhead		
Bridge, After Bulkhead	2 STEEL DOORS IN UPPER AND LOWER HALVES. MANIPULATED FROM BOTH SIDES.	
Bridge, Forward Bulkhead	2 STEEL DOORS IN UPPER AND LOWER HALVES. MANIPULATED FROM BOTH SIDES.	
Forecastle Bulkhead	STEEL DOORS TO SIDE HOUSES. WOOD DOOR TO FORECASTLE. ALL MANIPULATED FROM BOTH SIDES.	
Exposed Machinery Casings on Freeboard or Raised Quarter Decks	STEEL DOORS TO BOILER ROOM CASING. MANIPULATED FROM ONE SIDE	
Exposed Machinery Casings on Superstructure Decks		
Machinery Casings within Superstructures not fitted with Class I Closing Appliances	STEEL DOORS TO ENGINE ROOM CASING. MANIPULATED FROM BOTH SIDES.	
Deckhouses on Flush Deck Ships	NOTE ALL THE ABOVE DOORS ARE HINGED.	

PARTICULARS OF PROTECTION TO OPENINGS, ETC.

The following diagrams should be used to indicate the positions of cargo and coaling hatchways, gangway, cargo and coaling ports, ventilators, companionways, etc., which would affect the seaworthiness of the ship:

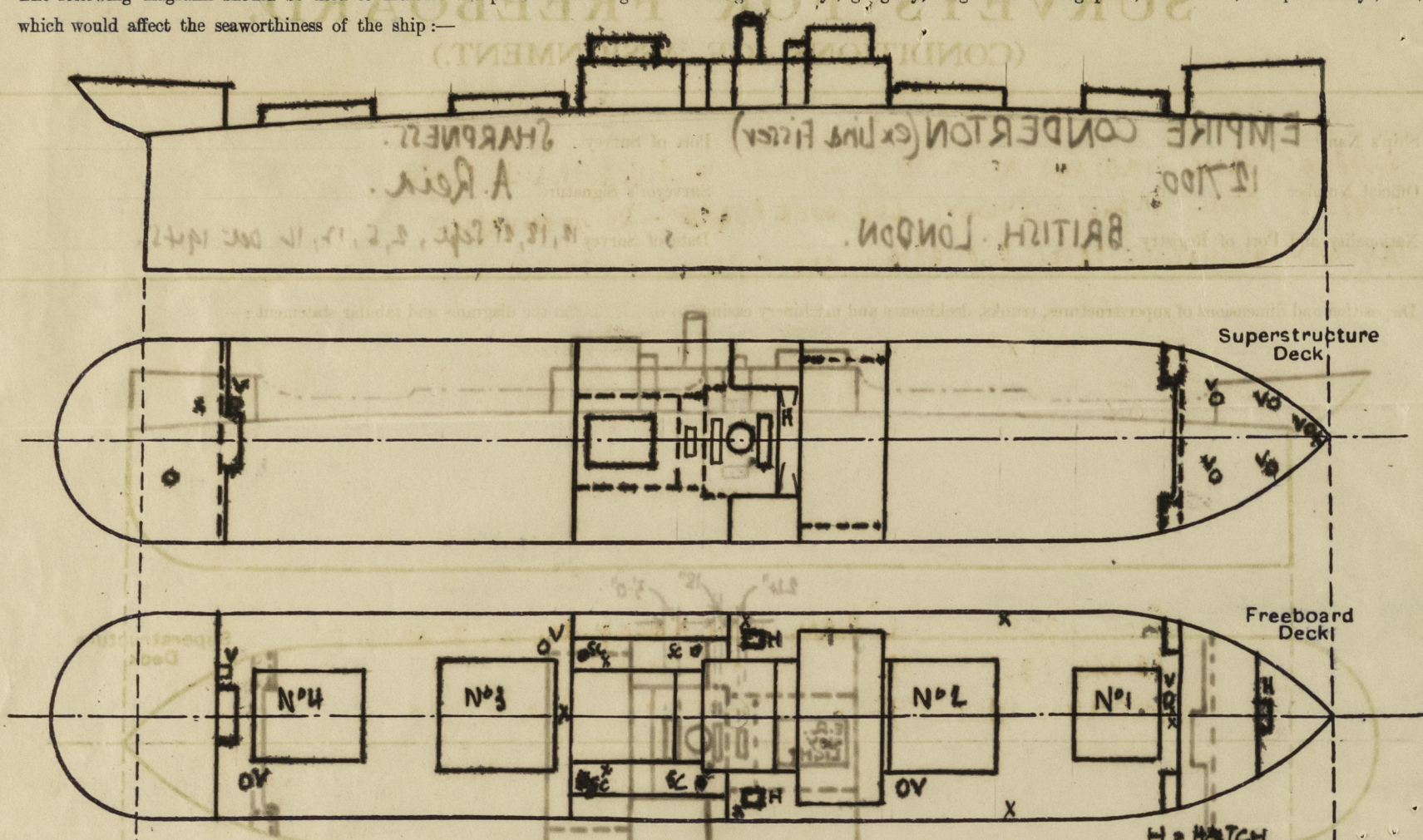

H = HATCH
V = VENTILATOR
X = AIRPIPE
O = OUTFLOW

Particulars of fiddle, funnel and ventilator coamings, engine room skylight and other openings in machinery casing tops and their means of closing:
Fiddle, funnel and ventilator coamings of steel. Fiddle covers of steel.
Fiddle covers on off side of funnel fitted with hinges. Fiddle covers forward of funnel not fitted with hinges.
Engine room skylight: fitted with hinges, steel flaps, secured from inside. Flaps fitted with glass lights about 10" in diameter.
See list of repairs

Particulars of Flush Bunker Scuttles:

None

Particulars of Companionways:

None

Particulars of Ventilators in exposed positions on freeboard and superstructure decks:

ON FORECASTLE 2-1/2" HIGH, 6" DIA, 1/4" THICK STEEL COAMING. NO WOOD PLUGS OR CANVAS COVERS PROVIDED.
ON FREEBOARD DECK, FORWARD AND AFTER WELLS 2-1/2" HIGH, 6" DIA, 1/4" THICK STEEL COAMING, PROVIDED WITH WOOD PLUGS AND CANVAS COVERS.
AFT END OF AFTER WELL PORT SIDE, STEEL COAMING, APPROX 12" x 8" CARRIED UP TO LEVEL OF POOP DECK AND THEN FITTED WITH CIRCULAR COAMING ABOUT 10" DIA 15" HIGH ABOVE POOP DECK. NO WOOD PLUG OR CANVAS COVER PROVIDED.
ON POOP 1-1/2" HIGH, 5" DIA, 1/4" THICK STEEL COAMING. NO WOOD PLUG OR CANVAS COVER PROVIDED.
VENTILATORS ON BRIDGE (CAIRNG TOP) LEAD TO MACHINERY SPACE. NO WOOD PLUGS OR CANVAS COVERS.

Particulars of Air Pipes in exposed positions on freeboard, raised quarter, or superstructure decks:

ON FORECASTLE 2-0" HIGH, PROTECTED BY BREAST HOOK.
FORD WELLS 2-0" HIGH AND 4-0" HIGH.
INSIDE BRIDGE 2-0" HIGH.
AFT WELL 1-0" HIGH.
ON POOP 1-0" HIGH.
NOTE ALL THE ABOVE DECKS ARE HINGED.

Particulars of Gangway Cargo and Coaling Ports:

Particulars of Scuppers and Sanitary Discharge Pipes:

SCUPPERS FROM FORWARD AND AFTER WELLS - HOLES IN SHEER PLATE.
SCUPPERS FROM BRIDGE ALLEYSWAYS LEAD OVER ROADS - NO JUNCTIONS.
SANITARY DISCHARGES FROM POOL, BRIDGE, AND FORECASTLE, FITTED WITH STOPVALVES.

Particulars of Side Scuttles:

POOP DECK 12" DIA WITH HINGED METAL BELLIGHTS.
BRIDGE DECK 12" DIA WITH HINGED METAL BELLIGHTS.
FORECASTLE DECK 12" DIA WITH HINGED METAL BELLIGHTS.
See list of repairs

Vertical distance of Sill of lowest Side Scuttle above top of keel:

None below mainmast deck.

Particulars of Guard Rails:

On forecastle 4' high.
On bridge 4' high, also of boats 4' high.
On fore and aft deck between 4' and 5' high.
On poop 4' high and 4' high 3' 6" high.

Particulars of Gangways, Lifelines, etc.:

No fittings for lifelines in forward and after wells.

Particulars of Freeing Arrangements.

	Length of Bulwark	Height of Bulwark	Size of Freeing Ports	Number each side	Area each side	Rule area each side
After Well	72'-9"	3'-0" MIN	19" x 6 1/2"	1 + 1/2	229.8 sq ft	22
Forward Well	89'-8"	3'-0" MIN	22" x 15"	1 + 1/2	201.3 sq ft	20

State position of each freeing port: After Well: SEE SKETCH. HEIGHT ABOVE DECK: 1, 1 1/2, 1 1/2, 1 1/2.
(F. and A. position and height above deck edge) Forward Well: " " " " 4, 5, 5, 5, 16.

State whether the freeing ports are fitted with shutters, bars, or rails, and give particulars of such: NO 1, CLEAR OPENING. NO 2, 3, 4, 5, 6, 7, 8, 9, 10, 11, 12, 13, 14, 15, 16, 17, 18, 19, 20, 21, 22, 23, 24, 25, 26, 27, 28, 29, 30, 31, 32, 33, 34, 35, 36, 37, 38, 39, 40, 41, 42, 43, 44, 45, 46, 47, 48, 49, 50, 51, 52, 53, 54, 55, 56, 57, 58, 59, 60, 61, 62, 63, 64, 65, 66, 67, 68, 69, 70, 71, 72, 73, 74, 75, 76, 77, 78, 79, 80, 81, 82, 83, 84, 85, 86, 87, 88, 89, 90, 91, 92, 93, 94, 95, 96, 97, 98, 99, 100. NO 1, CLEAR OPENING. NO 2, 3, 4, 5, 6, 7, 8, 9, 10, 11, 12, 13, 14, 15, 16, 17, 18, 19, 20, 21, 22, 23, 24, 25, 26, 27, 28, 29, 30, 31, 32, 33, 34, 35, 36, 37, 38, 39, 40, 41, 42, 43, 44, 45, 46, 47, 48, 49, 50, 51, 52, 53, 54, 55, 56, 57, 58, 59, 60, 61, 62, 63, 64, 65, 66, 67, 68, 69, 70, 71, 72, 73, 74, 75, 76, 77, 78, 79, 80, 81, 82, 83, 84, 85, 86, 87, 88, 89, 90, 91, 92, 93, 94, 95, 96, 97, 98, 99, 100. NO 1, CLEAR OPENING. NO 2, 3, 4, 5, 6, 7, 8, 9, 10, 11, 12, 13, 14, 15, 16, 17, 18, 19, 20, 21, 22, 23, 24, 25, 26, 27, 28, 29, 30, 31, 32, 33, 34, 35, 36, 37, 38, 39, 40, 41, 42, 43, 44, 45, 46, 47, 48, 49, 50, 51, 52, 53, 54, 55, 56, 57, 58, 59, 60, 61, 62, 63, 64, 65, 66, 67, 68, 69, 70, 71, 72, 73, 74, 75, 76, 77, 78, 79, 80, 81, 82, 83, 84, 85, 86, 87, 88, 89, 90, 91, 92, 93, 94, 95, 96, 97, 98, 99, 100.

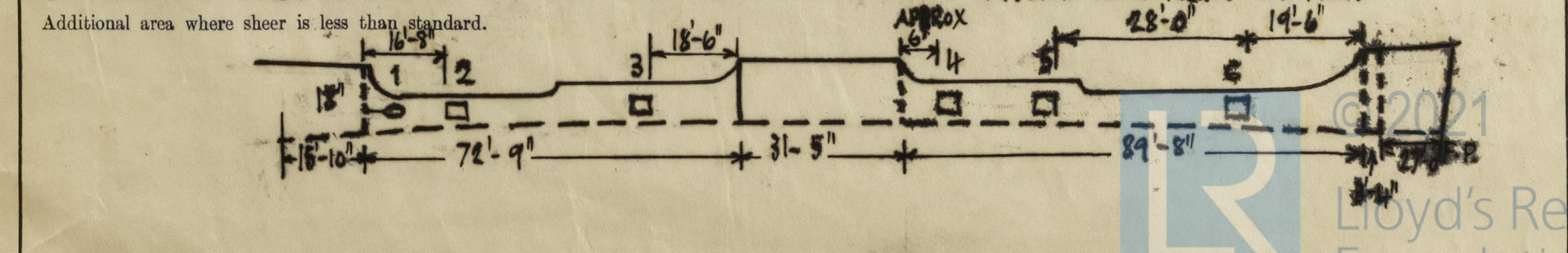

Empire Conderton.

PARTICULARS OF PROTECTION TO OPENINGS, ETC.

HATCHWAYS ON FREEBOARD AND SUPERSTRUCTURE DECKS.									
FREEBOARD DECK					CASING				
Description of Hatchway	No 1	No 2	No 3	No 4	BUNKER p. and s.	IN FOCSLE To PEAK STEVE	BUNKER TOP		
Dimensions of Hatchway	19'-2" x 15'-11"	21'-11" x 17'-11"	22'-11" x 17'-11"	22'-11" x 15'-11"	3'-9" x 2'-5"	2'-0" x 2'-6"	4'-0" x 16'-0"		
COAMINGS	Height above Deck	30"	30"	30"	18"	5 1/2" B.A.	2'-7"		
	Thickness	3/8" APPROX	3/8" APPROX	3/8" APPROX	5/16"	5/16"	5/16"		
	Sides	6 1/2" B.A.	6 1/2" B.A.	6 1/2" B.A.					
	Stiffeners	NONE	NONE	NONE					
HATCH BEAMS	Number	3	4	4	4				
	Spacing	UNIFORM	UNIFORM	UNIFORM	UNIFORM				
	Scantling and Sketch	19" x 30" 15 1/2" x 30" 3 1/2" and 3" x 3" x 3/8"	18" x 30" 14 1/2" x 30" 3 1/2" and 4" x 3" x 3/8"	21 1/2" x 30" 17 1/2" and 16" 4" x 3" x 3/8"	19 1/2" x 30" 16" x 30" 3 1/2" and 3" x 3" x 3/8"	NONE	NONE	NONE	
	Bearing Surface	3"	3"	3"	3"				
FORE AND AFTERS	Number								
	Spacing								
	Unsupported Lengths								
	Scantling and Sketch	NONE	NONE	NONE	NONE	NONE	NONE		
HATCH COVERS	Material	W.P.	W.P.	W.P.	W.P.	W.P.	W.P.		
	Thickness	2 1/2" MIN	2 1/2" MIN	2 1/2" MIN	2 1/2" MIN	2 1/2"	2 1/2"		
	How fitted	F. & A.	F. & A.	F. & A.	F. & A.	ATHWART	F. & A.		
	Bearing Surface	3" MIN	3" MIN	3" MIN	3" MIN	1 3/4"	3"		
Spacing of Cleats	24"	24"	24"	24"	18"	NONE	2'-1"		
Number of Tarpaulins	2	2	2	2	2	NONE	2		

*Are wood fore and afters steel shod at all bearing surfaces? ☒

Are battens and wedges efficient and in good condition? ~~A NUMBER OF BATTENS TO BE MADE GOOD~~ ☒ ~~WEDGES TO BE SEEN~~ ☒ ALL GOOD

Are tarpaulins in good condition and in accordance with rule requirements? ~~TO BE SEEN~~ ☒ GOOD

Are lashings provided in accordance with rule requirements? ~~LOCKING BARS FITTED~~ ☒ BUT SOME MISSING ☒

Particulars of any special features:—

This vessel is of the Ayre-Ballard system of construction and was originally classed +100A1 (steel). For particulars of construction see Midship Section and Profile.

The freeboards at present marked on the ship's sides have been checked and found to agree with those given on the Rpt. 11b.

(~~SEE ALSO LIST OF REPAIRS AND RENEWALS, HEREWITH.~~) ☒ ALL DEALT WITH

Endorsement at first survey and at surveys for renewal of Certificate:—

The fittings and appliances are in accordance with the particulars shown on this form (or as now modified) and are in good condition.

