

## LLOYD'S REGISTER OF SHIPPING

UNITED WITH THE BRITISH CORPORATION REGISTER

22 SEP 1954

## ALTERATIONS TO CONDITIONS OF ASSIGNMENT OF LOADLINES

Ship's Name "CARDICIAN" ex "SILVERTEAK"

Official No. 2963-G.

Port of Registry PANAMA

This ship has been under survey at LIVERPOOL

on 23rd AUGUST to 3rd SEPTEMBER, 1954 and the following alterations to the conditions of assignment of loadlines have now been effected/

TRIMMING HATCHES have been arranged on the 2nd Deck (Fbd Dk) in Nos 1, 2 & 5 Tween Decks clear of main hatch openings.  
12 @ 24" x 30", 9 x .50 bulb plate coaming, 2 1/2' W.P. covers with 3" bearing surface. 2 cleats fitted each side. One rat panel.

VENTILATORS 4 @ 27" dia ventilators removed from abreast No 4 Hatch on Shelter Deck and doublers fitted over openings. The trunks were removed from the tween decks leaving a 9 1/2" coaming on 2nd deck. Openings closed by wood covers and one rat panel with efficient battening arrangements. ✓

NO 4 HATCH ON 2ND DECK

Fore and Aft girders removed and 5 hatch beams fitted spaced 5'-4" apart.

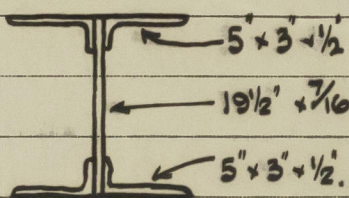

W. S. Turnbull  
7.9.54.

Plans with class reports sighted.

W. S. Turnbull

9 OCT 1954

A copy of this Report has been placed on board.