



# S. S. "EMPIRE CRANMER"

## DECK, TANK TOP & SIDE GIRDERS

416'-0" L.B.P. x 59'-7" Br. Mid. x 37'-4" D. Mid. U.D.K. / 28'-7" D. Mid. 2nd D.K.  
Class B.S.K. with freeboard with scantlings as per B.O.T. reqs for a draft of 26'-10" Mid.  
Scale 1/8" = 1' 0"

17 MAR 1942

### UPPER DECK

### UPPER DECK



### SECOND DECK

### STEEL PLAT BETWEEN UPPER & SECOND DECKS



### SECOND DECK

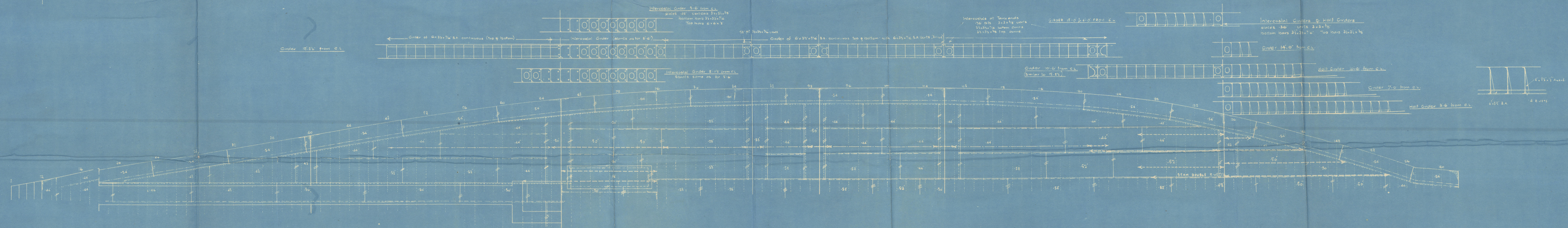

No 610

16495  
14.3.42

THOMPSON'S NO 610  
"EMPIRE CRAWMER"

"AS FITTED" DECKS

ALSO FOR "EMPIRE LAWRENCE" SHIP NO 609

002550-002558-0217



© 2020

Lloyd's Register  
Foundation

3

Hecks. [AS BUILT]

J. L. Thompson & Sons

Nº. 610 [ALSO FOR  
Nº. 609]

17. 2. 42.

Arietta ex Thraiki

ex EMPIRE CRANMER.



© 2020

Lloyd's Register  
Foundation

002550-002558-0217