

Lloyd's Register of Shipping. 26 JAN 1942

Ship's Name *Barnalea*Official No. *132028*

Memorandum of alterations reported since ship was surveyed for assignment of Load Lines

in

alteration of crews accommodation from lower forecastle space to existing open forecastle.

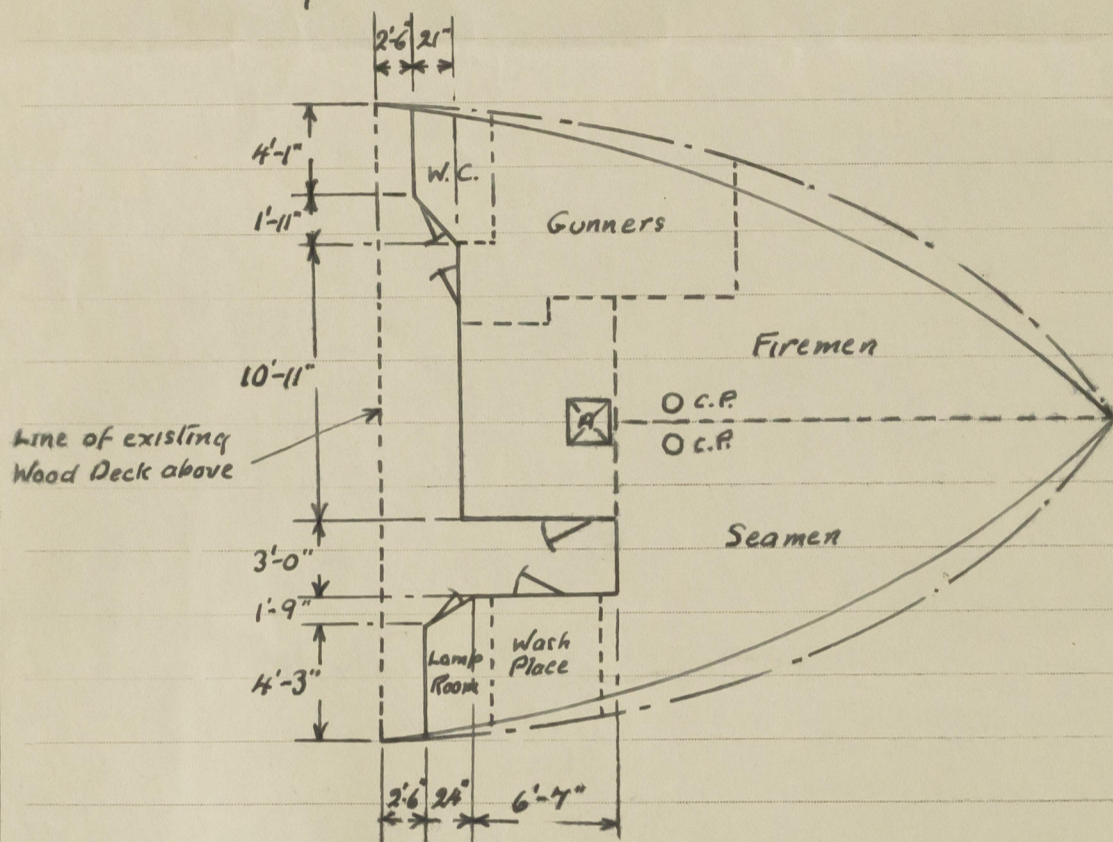

The existing companionway hatch to fore peak space dispensed with & openings in upper deck plated over. ✓

Steel bulkhead erected across existing open forecastle (see above sketch), coaming & plating 25", stiffeners 2½" x 2½" x 26" spaced 30" apart, openings, three at 5'-0" x 1'-9" closed by steel doors operated from both sides, two at 5'-0" x 2'-0" closed by solid wood doors 1½" thick operated from both sides, height of sills 18", height of casing 7'-1" ✓

Four of the existing sidelights in the lower forecastle space dispensed with & openings in shell permanently closed with riveted steel plates, three additional sidelights with hinged deadlights fitted in forecastle, port side, & two, starboard side. ✓

Two additional 6" ventilators & three 5" fitted on forecastle deck leading to new accommodation below, coamings 36" high to Tackle thickness, wood plugs & canvas covers provided. ✓

A 2'-0" x 2'-0" flush hatch marked "A" has been fitted to the upper deck leading to the space below, now converted to a store space & the new chain locker strongly constructed of wood has been fitted in this space.

A copy of the above memorandum has been placed on board the vessel. ✓

R. Muntton.

Belfast. January 1942.