

SS N° 787<sup>M</sup>

# MIDSHIP SECTION

SCALE: 1/2" = 1 FOOT.

DIMENSIONS: 270' 0" B.P. x 37' 0" M.D. x 18' 6" M.D. TO MAIN DECK.

CLASS B.S. \*

DRAFT: APPROX. 17' 0"

## PROPORTIONS.

DEPTH TO BREADTH	$\frac{18.5}{37}$	=	.50.
LENGTH TO DEPTH (MAIN D <sup>W</sup> )	$\frac{270}{18.5}$	=	14.6.
" (POOP D <sup>W</sup> )	$\frac{28}{26}$	=	10.4.

$$\frac{270 \times 37 \times 26 \times 78}{100} = 1947.$$

$$\frac{100 \times 37 \times 7.5 \times 50}{100} = 169$$

$$\frac{2116}{100}$$

30 SEP. 1929

Approved J.B.  
S.P. 26

## FRAMING

FRAMES 3 TO 7 5'-3" x 36" O.A. TO POOP DECK CUT & BRACKETED AT W.T. PLAT. REV. FR. 3'-3" x 36" FR. 4 TO 8 LOWER TO MAIN DECK.  
 9 TO 11 5'-3" x 36" O.A. TO POOP DECK. REV. FR. 3'-3" x 36" TO LOWER DECK AT PRO. 9 L.I. AND TO MAIN DECK AT PRO. 10 & 12.  
 13 TO 42 5'-3" x 36" O.A. ALTERNATELY TO MAIN DECK POOP DECK WITH INTERMEDIATE FR. MAIN TO POOP DECK 5'-3" x 36" SCARPHED 12".  
 REV. FR. 13 TO 42 3'-3" x 36" TO LOWER DECK MAIN DECK AT HATCH END BEAMS C.F. 14 V.  
 FRAMES 44 TO 53 7'-5" x 36" B.A. TO MAIN DECK.  
 54 TO 75 9'-3" x 48" B.A. TO MAIN DECK.  
 44 TO 87 5'-3" x 36" O.A. TO MAIN DECK POOP DECK ALTERNATELY SCARPHED 15" TO MAIN FR. WITH 3'-3" x 36" BETWEEN.  
 MAIN DECK DECK DECK ALTERNATELY SCARPHED 12" TO MAIN FR. INTERMEDIATE STIFFENER BETWEEN POOP DECK DECK.  
 3'-3" x 36" STIFF. AT 5'-3" x 36" O.A. CARRIED UP TO POOP DECK AT FORE END OF POOP. REV. FR. FROM FR. 27 TO 28 TO LOWER DECK 5'-3" x 36".  
 FRAMES 88 TO 112 5'-3" x 36" O.A. TO MAIN DECK WITH REV. FR. 3'-3" x 36" TO LOWER DECK TO MAIN DECK AT HATCH END BEAMS EXCEPT FR. 106.  
 113 TO 126 5'-3" x 36" O.A. TO FORECASTLE DECK WITH REV. FR. 3'-3" x 36" TO LOWER DECK.  
 127 TO 130 5'-3" x 36" O.A. TO FORECASTLE DECK CUT & BRACKETED AT W.T. PLAT. WITH REV. FR. 3'-3" x 36" TO LOWER DECK.  
 131 TO 134 5'-3" x 36" O.A. TO FORECASTLE DECK CUT & BRACKETED AT W.T. PLAT. WITH REV. FR. 3'-3" x 36" TO LOWER DECK.  
 135 TO 138 5'-3" x 36" O.A. TO FORECASTLE DECK CUT & BRACKETED AT W.T. PLAT. WITH REV. FR. 3'-3" x 36" TO LOWER DECK.  
 139 TO 142 5'-3" x 36" O.A. TO FORECASTLE DECK CUT & BRACKETED AT W.T. PLAT. WITH REV. FR. 3'-3" x 36" TO LOWER DECK.  
 143 TO 146 5'-3" x 36" O.A. TO FORECASTLE DECK CUT & BRACKETED AT W.T. PLAT. WITH REV. FR. 3'-3" x 36" TO LOWER DECK.  
 147 TO 150 5'-3" x 36" O.A. TO FORECASTLE DECK CUT & BRACKETED AT W.T. PLAT. WITH REV. FR. 3'-3" x 36" TO LOWER DECK.  
 151 TO 154 5'-3" x 36" O.A. TO FORECASTLE DECK CUT & BRACKETED AT W.T. PLAT. WITH REV. FR. 3'-3" x 36" TO LOWER DECK.  
 155 TO 158 5'-3" x 36" O.A. TO FORECASTLE DECK CUT & BRACKETED AT W.T. PLAT. WITH REV. FR. 3'-3" x 36" TO LOWER DECK.  
 159 TO 162 5'-3" x 36" O.A. TO FORECASTLE DECK CUT & BRACKETED AT W.T. PLAT. WITH REV. FR. 3'-3" x 36" TO LOWER DECK.  
 163 TO 166 5'-3" x 36" O.A. TO FORECASTLE DECK CUT & BRACKETED AT W.T. PLAT. WITH REV. FR. 3'-3" x 36" TO LOWER DECK.  
 167 TO 170 5'-3" x 36" O.A. TO FORECASTLE DECK CUT & BRACKETED AT W.T. PLAT. WITH REV. FR. 3'-3" x 36" TO LOWER DECK.  
 171 TO 174 5'-3" x 36" O.A. TO FORECASTLE DECK CUT & BRACKETED AT W.T. PLAT. WITH REV. FR. 3'-3" x 36" TO LOWER DECK.  
 175 TO 178 5'-3" x 36" O.A. TO FORECASTLE DECK CUT & BRACKETED AT W.T. PLAT. WITH REV. FR. 3'-3" x 36" TO LOWER DECK.  
 179 TO 182 5'-3" x 36" O.A. TO FORECASTLE DECK CUT & BRACKETED AT W.T. PLAT. WITH REV. FR. 3'-3" x 36" TO LOWER DECK.  
 183 TO 186 5'-3" x 36" O.A. TO FORECASTLE DECK CUT & BRACKETED AT W.T. PLAT. WITH REV. FR. 3'-3" x 36" TO LOWER DECK.  
 187 TO 190 5'-3" x 36" O.A. TO FORECASTLE DECK CUT & BRACKETED AT W.T. PLAT. WITH REV. FR. 3'-3" x 36" TO LOWER DECK.  
 191 TO 194 5'-3" x 36" O.A. TO FORECASTLE DECK CUT & BRACKETED AT W.T. PLAT. WITH REV. FR. 3'-3" x 36" TO LOWER DECK.  
 195 TO 198 5'-3" x 36" O.A. TO FORECASTLE DECK CUT & BRACKETED AT W.T. PLAT. WITH REV. FR. 3'-3" x 36" TO LOWER DECK.  
 199 TO 202 5'-3" x 36" O.A. TO FORECASTLE DECK CUT & BRACKETED AT W.T. PLAT. WITH REV. FR. 3'-3" x 36" TO LOWER DECK.  
 203 TO 206 5'-3" x 36" O.A. TO FORECASTLE DECK CUT & BRACKETED AT W.T. PLAT. WITH REV. FR. 3'-3" x 36" TO LOWER DECK.  
 207 TO 210 5'-3" x 36" O.A. TO FORECASTLE DECK CUT & BRACKETED AT W.T. PLAT. WITH REV. FR. 3'-3" x 36" TO LOWER DECK.  
 211 TO 214 5'-3" x 36" O.A. TO FORECASTLE DECK CUT & BRACKETED AT W.T. PLAT. WITH REV. FR. 3'-3" x 36" TO LOWER DECK.  
 215 TO 218 5'-3" x 36" O.A. TO FORECASTLE DECK CUT & BRACKETED AT W.T. PLAT. WITH REV. FR. 3'-3" x 36" TO LOWER DECK.  
 219 TO 222 5'-3" x 36" O.A. TO FORECASTLE DECK CUT & BRACKETED AT W.T. PLAT. WITH REV. FR. 3'-3" x 36" TO LOWER DECK.  
 223 TO 226 5'-3" x 36" O.A. TO FORECASTLE DECK CUT & BRACKETED AT W.T. PLAT. WITH REV. FR. 3'-3" x 36" TO LOWER DECK.  
 227 TO 230 5'-3" x 36" O.A. TO FORECASTLE DECK CUT & BRACKETED AT W.T. PLAT. WITH REV. FR. 3'-3" x 36" TO LOWER DECK.  
 231 TO 234 5'-3" x 36" O.A. TO FORECASTLE DECK CUT & BRACKETED AT W.T. PLAT. WITH REV. FR. 3'-3" x 36" TO LOWER DECK.  
 235 TO 238 5'-3" x 36" O.A. TO FORECASTLE DECK CUT & BRACKETED AT W.T. PLAT. WITH REV. FR. 3'-3" x 36" TO LOWER DECK.  
 239 TO 242 5'-3" x 36" O.A. TO FORECASTLE DECK CUT & BRACKETED AT W.T. PLAT. WITH REV. FR. 3'-3" x 36" TO LOWER DECK.  
 243 TO 246 5'-3" x 36" O.A. TO FORECASTLE DECK CUT & BRACKETED AT W.T. PLAT. WITH REV. FR. 3'-3" x 36" TO LOWER DECK.  
 247 TO 250 5'-3" x 36" O.A. TO FORECASTLE DECK CUT & BRACKETED AT W.T. PLAT. WITH REV. FR. 3'-3" x 36" TO LOWER DECK.  
 251 TO 254 5'-3" x 36" O.A. TO FORECASTLE DECK CUT & BRACKETED AT W.T. PLAT. WITH REV. FR. 3'-3" x 36" TO LOWER DECK.  
 255 TO 258 5'-3" x 36" O.A. TO FORECASTLE DECK CUT & BRACKETED AT W.T. PLAT. WITH REV. FR. 3'-3" x 36" TO LOWER DECK.  
 259 TO 262 5'-3" x 36" O.A. TO FORECASTLE DECK CUT & BRACKETED AT W.T. PLAT. WITH REV. FR. 3'-3" x 36" TO LOWER DECK.  
 263 TO 266 5'-3" x 36" O.A. TO FORECASTLE DECK CUT & BRACKETED AT W.T. PLAT. WITH REV. FR. 3'-3" x 36" TO LOWER DECK.  
 267 TO 270 5'-3" x 36" O.A. TO FORECASTLE DECK CUT & BRACKETED AT W.T. PLAT. WITH REV. FR. 3'-3" x 36" TO LOWER DECK.

## FORGINGS

STEM: 7' 6" x 6" PROP. POST. RUDDER FRAME 7' 6" x 6" INCLUDES 10% INCREASE AS PER SPEC.  
 RUDDER: PLANS OF RUDDER & STERN FRAME WILL BE SUBMITTED.

## EQUIPMENT

UNDER DECK	270' x 37' x 18' 6" = 1205
POOP & BRIDGE	176' 6" x 37' x 7' 5" = 246
FORECASTLE	43' x 37' x 7' 5" = 150
UPPER BRIDGE	100' x 36' x 7' 5" = 200
STEERING GEAR HOUSE	26' x 14' x 7' 5" = 11
BRIDGE HOUSE	18' 5" x 20' 5" x 7' 5" = 200
	1634

## EQUIPMENT

2 DOWN ANCHORS EACH 31 CWT. STOCKED ✓  
 1 30' 4" ✓  
 1 STREAM 8' 2" INCLUDING STOCK ✓  
 240 FATHOMS 1 1/2" STUD CHAIN CABLE ✓  
 75 3 1/2" S.W.R. IN LIEU OF STREAM CHAIN ✓  
 100 4" S.W.R. ✓  
 2 @ 30' 2 1/2" S.W.R. ✓  
 2 @ 90' 6" HAWSE ✓  
 2 @ 90' 5" WARPS ✓

## RIVETING

PLATE PLATE KEEL BUTTS 3R FOR 1/2" 3R TO 2R WHERE UNDER 1/2" AT ENDS.  
 CENTRE GIRDER 2R 3R IN B.S.  
 TANK TOP CE STRAKE 2R 3R IN B.S.  
 PLATING 1R 2R IN B.S.  
 MARGIN PLATE 2R ✓  
 SHELL STRAKES ✓  
 A.B.C.D.E.F. BUTTS 3R FOR 1/2" 2R AT ENDS.  
 F.W. WELLS BUTTS 4R FOR 1/2" 3R AT ENDS.  
 G 3R FOR 1/2" 2R AT ENDS.  
 H.E.J. 2R 3R FOR 1/2" 1R AT ENDS.  
 P.B.E. DECK STRINGER BUTTS 2R 3R FOR 1/2" 1R AT ENDS.  
 MAIN DECK STRINGER 2R 3R FOR 1/2" 1R AT ENDS.  
 LOWER 2R ✓  
 P.B.E. DECK PLATING 2R 3R FOR 1/2" 1R AT ENDS.  
 MAIN 2R 3R FOR 1/2" 1R AT ENDS. 3R AHEAD HATCH.

## SPACING OF RIVETS

SIDE FRAMES TO SHELL SPACED 7 DIAS. APART C.F. TO C.F.  
 IN AFT PEAK C.F. FROM KEEL TO ABOVE LOAD LINE FOR 40' 0" AFT OF STEM SPACED 5/2 DIAS. C.F. TO C.F.  
 DOUBLE BOTTOM FRAMES TO SHELL 7 DIAS. 5/2 DIAS. FOR 40' 0" AFT OF STEM.  
 TANK TOP TO REV FRAMES 7 DIAS. 5/2 DIAS. IN ENGINE SPACE 1/2 DIAS. IN ENGINE SPACE C.F. TO THRUST SEAT.  
 ALT ✓  
 SIDE FRAMES TO REVERSE FRAMES 7 ✓  
 END FRAMES 7 ✓  
 REV 7 ✓  
 BOTTOM FRAMES TO FLOORS 7 ✓  
 NO. OF RIVETS IN EACH ROW OF SHELL LANDING, 6 1/2 RIVETS, 5 1/2 RIVETS, INCLUDING RIVETS IN FRAMES.

BOAT DECK  
 STRINGER PLATE 36" x 3/4"  
 ANGLE 3" x 3/4" x 30" V. 1/2" B.S.  
 DECK SHEATHED WITH 1/2" S.P.

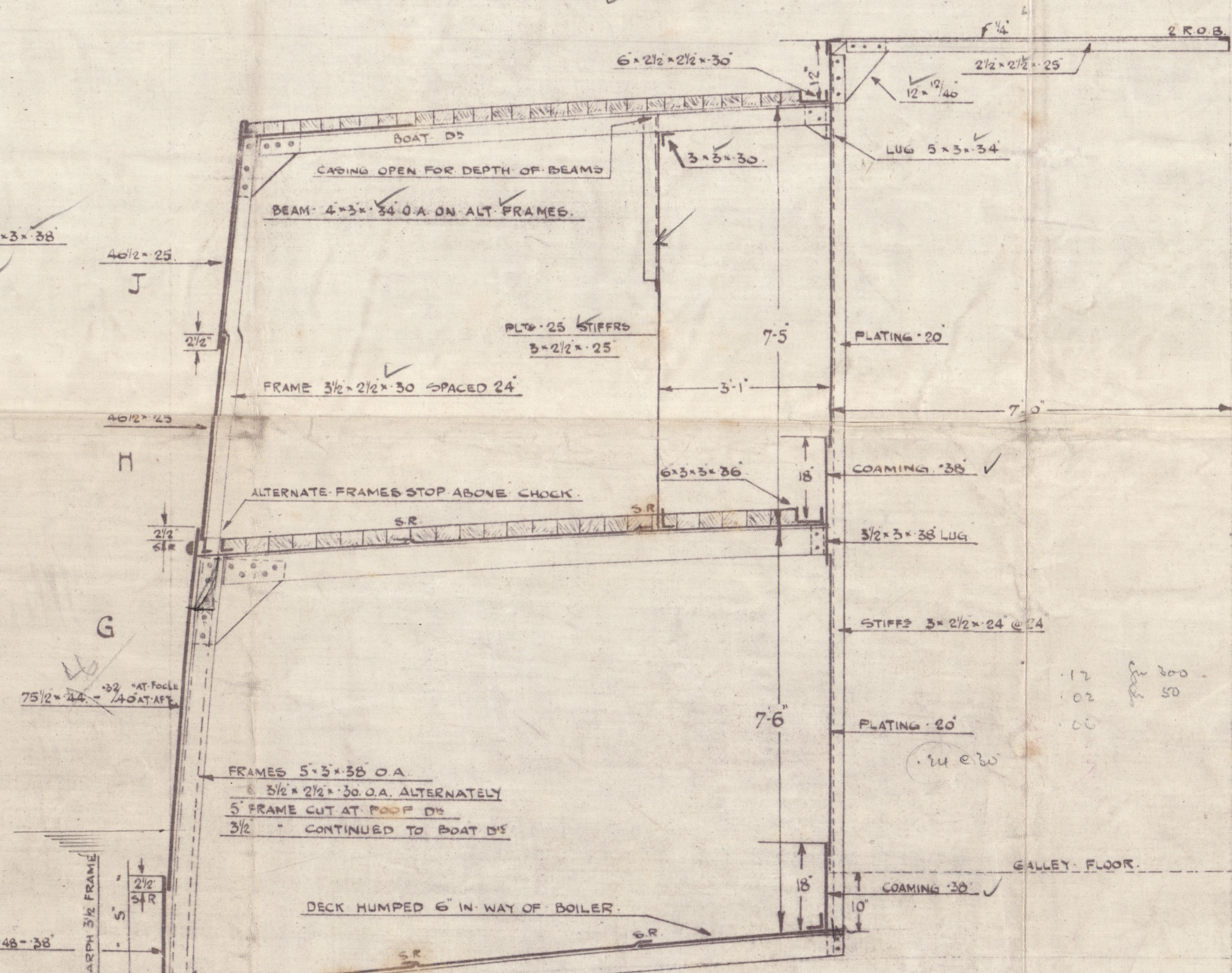

DOUBLE BOTTOM  
 CENTRE GIRDER: 42" x 42" x 30" 48" x 42" x 30" 54" x 42" x 30" 60" x 42" x 30" 66" x 42" x 30" 72" x 42" x 30" 78" x 42" x 30" 84" x 42" x 30" 90" x 42" x 30" 96" x 42" x 30" 102" x 42" x 30" 108" x 42" x 30" 114" x 42" x 30" 120" x 42" x 30" 126" x 42" x 30" 132" x 42" x 30" 138" x 42" x 30" 144" x 42" x 30" 150" x 42" x 30" 156" x 42" x 30" 162" x 42" x 30" 168" x 42" x 30" 174" x 42" x 30" 180" x 42" x 30" 186" x 42" x 30" 192" x 42" x 30" 198" x 42" x 30" 204" x 42" x 30" 210" x 42" x 30" 216" x 42" x 30" 222" x 42" x 30" 228" x 42" x 30" 234" x 42" x 30" 240" x 42" x 30" 246" x 42" x 30" 252" x 42" x 30" 258" x 42" x 30" 264" x 42" x 30" 270" x 42" x 30" 276" x 42" x 30" 282" x 42" x 30" 288" x 42" x 30" 294" x 42" x 30" 300" x 42" x 30" 306" x 42" x 30" 312" x 42" x 30" 318" x 42" x 30" 324" x 42" x 30" 330" x 42" x 30" 336" x 42" x 30" 342" x 42" x 30" 348" x 42" x 30" 354" x 42" x 30" 360" x 42" x 30" 366" x 42" x 30" 372" x 42" x 30" 378" x 42" x 30" 384" x 42" x 30" 390" x 42" x 30" 396" x 42" x 30" 402" x 42" x 30" 408" x 42" x 30" 414" x 42" x 30" 420" x 42" x 30" 426" x 42" x 30" 432" x 42" x 30" 438" x 42" x 30" 444" x 42" x 30" 450" x 42" x 30" 456" x 42" x 30" 462" x 42" x 30" 468" x 42" x 30" 474" x 42" x 30" 480" x 42" x 30" 486" x 42" x 30" 492" x 42" x 30" 498" x 42" x 30" 504" x 42" x 30" 510" x 42" x 30" 516" x 42" x 30" 522" x 42" x 30" 528" x 42" x 30" 534" x 42" x 30" 540" x 42" x 30" 546" x 42" x 30" 552" x 42" x 30" 558" x 42" x 30" 564" x 42" x 30" 570" x 42" x 30" 576" x 42" x 30" 582" x 42" x 30" 588" x 42" x 30" 594" x 42" x 30" 600" x 42" x 30" 606" x 42" x 30" 612" x 42" x 30" 618" x 42" x 30" 624" x 42" x 30" 630" x 42" x 30" 636" x 42" x 30" 642" x 42" x 30" 648" x 42" x 30" 654" x 42" x 30" 660" x 42" x 30" 666" x 42" x 30" 672" x 42" x 30" 678" x 42" x 30" 684" x 42" x 30" 690" x 42" x 30" 696" x 42" x 30" 702" x 42" x 30" 708" x 42" x 30" 714" x 42" x 30" 720" x 42" x 30" 726" x 42" x 30" 732" x 42" x 30" 738" x 42" x 30" 744" x 42" x 30" 750" x 42" x 30" 756" x 42" x 30" 762" x 42" x 30" 768" x 42" x 30" 774" x 42" x 30" 780" x 42" x 30" 786" x 42" x 30" 792" x 42" x 30" 798" x 42" x 30" 804" x 42" x 30" 810" x 42" x 30" 816" x 42" x 30" 822" x 42" x 30" 828" x 42" x 30" 834" x 42" x 30" 840" x 42" x 30" 846" x 42" x 30" 852" x 42" x 30" 858" x 42" x 30" 864" x 42" x 30" 870" x 42" x 30" 876" x 42" x 30" 882" x 42" x 30" 888" x 42" x 30" 894" x 42" x 30" 900" x 42" x 30" 906" x 42" x 30" 912" x 42" x 30" 918" x 42" x 30" 924" x 42" x 30" 930" x 42" x 30" 936" x 42" x 30" 942" x 42" x 30" 948" x 42" x 30" 954" x 42" x 30" 960" x 42" x 30" 966" x 42" x 30" 972" x 42" x 30" 978" x 42" x 30" 984" x 42" x 30" 990" x 42" x 30" 996" x 42" x 30" 1002" x 42" x 30" 1008" x 42" x 30" 1014" x 42" x 30" 1020" x 42" x 30" 1026" x 42" x 30" 1032" x 42" x 30" 1038" x 42" x 30" 1044" x 42" x 30" 1050" x 42" x 30" 1056" x 42" x 30" 1062" x 42" x 30" 1068" x 42" x 30" 1074" x 42" x 30" 1080" x 42" x 30" 1086" x 42" x 30" 1092" x 42" x 30" 1098" x 42" x 30" 1104" x 42" x 30" 1110" x 42" x 30" 1116" x 42" x 30" 1122" x 42" x 30" 1128" x 42" x 30" 1134" x 42" x 30" 1140" x 42" x 30" 1146" x 42" x 30" 1152" x 42" x 30" 1158" x 42" x 30" 1164" x 42" x 30" 1170" x 42" x 30" 1176" x 42" x 30" 1182" x 42" x 30" 1188" x 42" x 30" 1194" x 42" x 30" 1200" x 42" x 30" 1206" x 42" x 30" 1212" x 42" x 30" 1218" x 42" x 30" 1224" x 42" x 30" 1230" x 42" x 30" 1236" x 42" x 30" 1242" x 42" x 30" 1248" x 42" x 30" 1254" x 42" x 30" 1260" x 42" x 30" 1266" x 42" x 30" 1272" x 42" x 30" 1278" x 42" x 30" 1284" x 42" x 30" 1290" x 42" x 30" 1296" x 42" x 30" 1302" x 42" x 30" 1308" x 42" x 30" 1314" x 42" x 30" 1320" x 42" x 30" 1326" x 42" x 30" 1332" x 42" x 30" 1338" x 42" x 30" 1344" x 42" x 30" 1350" x 42" x 30" 1356" x 42" x 30" 1362" x 42" x 30" 1368" x 42" x 30" 1374" x 42" x 30" 1380" x 42" x 30" 1386" x 42" x 30" 1392" x 42" x 30" 1398" x 42" x 30" 1404" x 42" x 30" 1410" x 42" x 30" 1416" x 42" x 30" 1422" x 42" x 30" 1428" x 42" x 30" 1434" x 42" x 30" 1440" x 42" x 30" 1446" x 42" x 30" 1452" x 42" x 30" 1458" x 42" x 30" 1464" x 42" x 30" 1470" x 42" x 30" 1476" x 42" x 30" 1482" x 42" x 30" 1488" x 42" x 30" 1494" x 42" x 30" 1500" x 42" x 30" 1506" x 42" x 30" 1512" x 42" x 30" 1518" x 42" x 30" 1524" x 42" x 30" 1530" x 42" x 30" 1536" x 42" x 30" 1542" x 42" x 30" 1548" x 42" x 30" 1554" x 42" x 30" 1560" x 42" x 30" 1566" x 42" x 30" 1572" x 42" x 30" 1578" x 42" x 30" 1584" x 42" x 30" 1590" x 42" x 30" 1596" x 42" x 30" 1602" x 42" x 30" 1608" x 42" x 30" 1614" x 42" x 30" 1620" x 42" x 30" 1626" x 42" x 30" 1632" x 42" x 30" 1638" x 42" x 30" 1644" x 42" x 30" 1650" x 42" x 30" 1656" x 42" x 30" 1662" x 42" x 30" 1668" x 42" x 30" 1674" x 42" x 30" 1680" x 42" x 30" 1686" x 42" x 30" 1692" x 42" x 30" 1698" x 42" x 30" 1704" x 42" x 30" 1710" x 42" x 30" 1716" x 42" x 30" 1722" x 42" x 30" 1728" x 42" x 30" 1734" x 42" x 30" 1740" x 42" x 30" 1746" x 42" x 30" 1752" x 42" x 30" 1758" x 42" x 30" 1764" x 42" x 30" 1770" x 42" x 30" 1776" x 42" x 30" 1782" x 42" x 30" 1788" x 42" x 30" 1794" x 42" x 30" 1800" x 42" x 30" 1806" x 42" x 30" 1812" x 42" x 30" 1818" x 42" x 30" 1824" x 42" x 30" 1830" x 42" x 30" 1836" x 42" x 30" 1842" x 42" x 30" 1848" x 42" x 30" 1854" x 42" x 30" 1860" x 42" x 30" 1866" x 42" x 30" 1872" x 42" x 30" 1878" x 42" x 30" 1884" x 42" x 30" 1890" x 42" x 30" 1896" x 42" x 30" 1902" x 42" x 30" 1908" x 42" x 30" 1914" x 42" x 30" 1920" x 42" x 30" 1926" x 42" x 30" 1932" x 42" x 30" 1938" x 42" x 30" 1944" x 42" x 30" 1950" x 42" x 30" 1956" x 42" x 30" 1962" x 42" x 30" 1968" x 42" x 30" 1974" x 42" x 30" 1980" x 42" x 30" 1986" x 42" x 30" 1992" x 42" x 30" 1998" x 42" x 30" 2004" x 42" x 30" 2010" x 42" x 30" 2016" x 42" x 30" 2022" x 42" x 30" 2028" x 42" x 30" 2034" x 42" x 30" 2040" x 42" x 30" 2046" x 42" x 30" 2052" x 42" x 30" 2058" x 42" x 30" 2064" x 42" x 30" 2070" x 42" x 30" 2076" x 42" x 30" 2082" x 42" x 30" 2088" x 42" x 30" 2094" x 42" x 30" 2100" x 42" x 30" 2106" x 42" x 30" 2112" x 42" x 30" 2118" x 42" x 30" 2124" x 42" x 30" 2130" x 42" x 30" 2136" x 42" x 30" 2142" x 42" x 30" 2148" x 42" x 30" 2154" x 42" x 30" 2160" x 42" x 30" 2166" x 42" x 30" 2172" x 42" x 30" 2178" x 42" x 30" 2184" x 42" x 30" 2190" x 42" x 30" 2196" x 42" x 30" 2202" x 42" x 30" 2208" x 42" x 30" 2214" x 42" x 30" 2220" x 42" x 30" 2226" x 42" x 30" 2232" x 42" x 30" 2238" x 42" x 30" 2244" x 42" x 30" 2250" x 42" x 30" 2256" x 42" x 30" 2262" x 42" x 30" 2268" x 42" x 30" 2274" x 42" x 30" 2280" x 42" x 30" 2286" x 42" x 30" 2292" x 42" x 30" 2298" x 42" x 30" 2304" x 42" x 30" 2310" x 42" x 30" 2316" x 42" x 30" 2322" x 42" x 30" 2328" x 42" x 30" 2334" x 42" x 30" 2340" x 42" x 30" 2346" x 42" x 30" 2352" x 42" x 30" 2358" x 42" x 30" 2364" x 42" x 30" 2370" x 42" x 30" 2376" x 42" x 30" 2382" x 42" x 30" 2388" x 42" x 30" 2394" x 42" x 30" 2400" x 42" x 30" 2406" x 42" x 30" 2412" x 42" x 30" 2418" x 42" x 30" 2424" x 42" x 30" 2430" x 42" x 30" 2436" x 42" x 30" 2442" x 42" x 30" 2448" x 42" x 30" 2454" x 42" x 30" 2460" x 42" x 30" 2466" x 42" x 30" 2472" x 42" x 30" 2478" x 42" x 30" 2484" x 42" x 30" 2490" x 42" x 30" 2496" x 42" x 30" 2502" x 42" x 30" 2508" x 42" x 30" 2514" x 42" x 30" 2520" x 42" x 30" 2526" x 42" x 30" 2532" x 42" x 30" 2538" x 42" x 30" 2544" x 42" x 30" 2550" x 42" x 30" 2556" x 42" x 30" 2562" x 42" x 30" 2568" x 42" x 30" 2574" x 42" x 30" 2580" x 42" x 30" 2586" x 42" x 30" 2592" x 42" x 30" 2598" x 42" x 30" 2604" x 42" x 30" 2610" x 42" x 30" 2616" x 42" x 30" 2622" x 42" x 30" 2628" x 42" x 30" 2634" x 42" x 30" 2640" x 42" x 30"



1  
Midship Section.

D & W. Henderson & Co.

484<sup>m</sup>

Brookman 1 - 10 - 26.

<sup>EX</sup>  
2/5 Pelebrooke

3/5. <sup>EX</sup> "Eddystone"

RECORDS DEPT.  
LONDON.

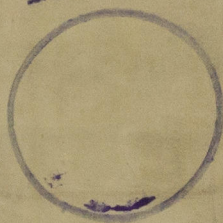

© 2020

Lloyd's Register  
Foundation

002471-002476-0057