

Lloyd's Register of Shipping.

SURVEYS FOR FREEBOARD.

(CONDITIONS OF ASSIGNMENT.)

ANASTASIA

Ship's Name **"JACQUES-MARIE" (EX. "HARALD")**Port of Survey **ANTWERP.**

Official Number

Surveyor's Signature *Aluavor*

Nationality and Port of Registry

**GREEK PIRAEUS
BELGIAN - ANTWERP.**

Date of Survey

7th JUNE 1948.

Disposition and dimensions of superstructures, trunks, deckhouses and machinery casings to be inserted in the diagrams and tabular statement:

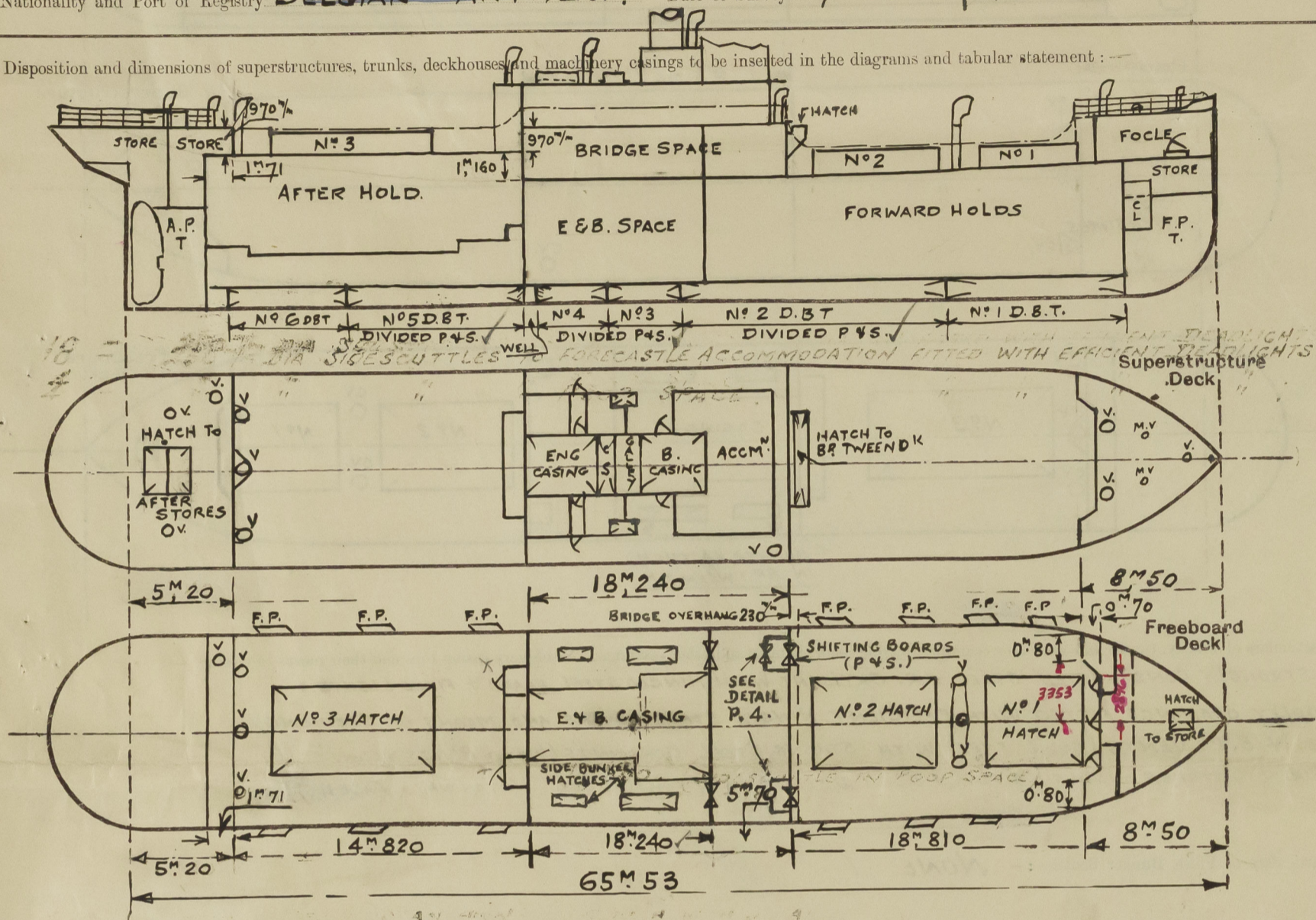

Particulars of Superstructures, Trunks, Casings, Deckhouses.

	Coaming	Plating	Stiffeners	Spacing	End Attachments of Stiffeners	Size of Openings	Height of Sills	Height of Casings
Poop Bulkhead ...	7 1/2"	7 1/2"	80 x 65 x 8 o.a.	750"	NONE.	NO OPENINGS.	✓	9'7 1/2" ABOVE Q.R. DECK.
Raised Quarter Deck Bulkhead ...	7 1/2"	7 1/2"	80 x 65 x 8 o.a.	750"	"	2 @ 500 x 500" (I.P. & 1 STB)	✓	9'7 1/2" ABOVE Q.R. DECK
Bridge, After Bulkhead ...	10"	8"	160" 120 x 70 x 10" 100 x 70 x 10"	700"	BRACKETS TOP & BOTTOM	2 @ 1" 250 x 900"	530"	2'130
Bridge, Forward Bulkhead ...	10"	7"	80 x 60 x 9 1/2" o.a. WITH DIV. BHDS	670"	NO ATTACHMENTS	1" 40 x 600"	500"	2'270
Forecastle Bulkhead ...	✓	✓	✓	✓	✓	✓	✓	✓
Trunk, Aft ...	✓	✓	✓	✓	✓	✓	✓	✓
Trunk, Forward ...	✓	✓	✓	✓	✓	✓	✓	✓
Exposed Machinery Casings on Freeboard or Raised Quarter Decks ...	✓	✓	✓	✓	✓	✓	✓	✓
Exposed Machinery Casings on Superstructure Decks ...	7"	7"	90 x 60 x 7 1/2" o.a.	760"	BRACKETED AT TOP ONLY.	✓	450"	2'750
Machinery Casings within Superstructures not fitted with Class I Closing Appliances ...	11"	7"	90 x 60 x 7 1/2" o.a.	760"	NONE	NONE	✓	2'130
Deckhouses on Flush Deck Ships ...	✓	✓	✓	✓	✓	✓	✓	✓

Particulars of Closing Appliances (state if capable of being manipulated from both sides).

Poop Bulkhead ...	NO OPENINGS.
Raised Quarter Deck Bulkhead ...	W.T. STEEL PLATE COVER WITH SECURING BOLTS THROUGH BULKHEAD PLATING.
Bridge, After Bulkhead ...	✓
Bridge, Forward Bulkhead ...	STORM BOARDS IN CHANNELS RIVETED TO BULKHEAD
Forecastle Bulkhead ...	HINGED STEEL DOORS CAPABLE OF BEING MANIPULATED FROM BOTH SIDES.
Exposed Machinery Casings on Freeboard or Raised Quarter Decks ...	✓
Exposed Machinery Casings on Superstructure Decks ...	HINGED STEEL DOORS CAPABLE OF BEING MANIPULATED FROM BOTH SIDES.
Machinery Casings within Superstructures not fitted with Class I Closing Appliances ...	NO OPENINGS.
Deckhouses on Flush Deck Ships ...	✓

PARTICULARS OF PROTECTION TO OPENINGS, ETC.

The following diagrams should be used to indicate the positions of cargo and coaling hatchways, gangway, cargo and coaling ports, ventilators, companionways, etc., which would affect the seaworthiness of the ship:—

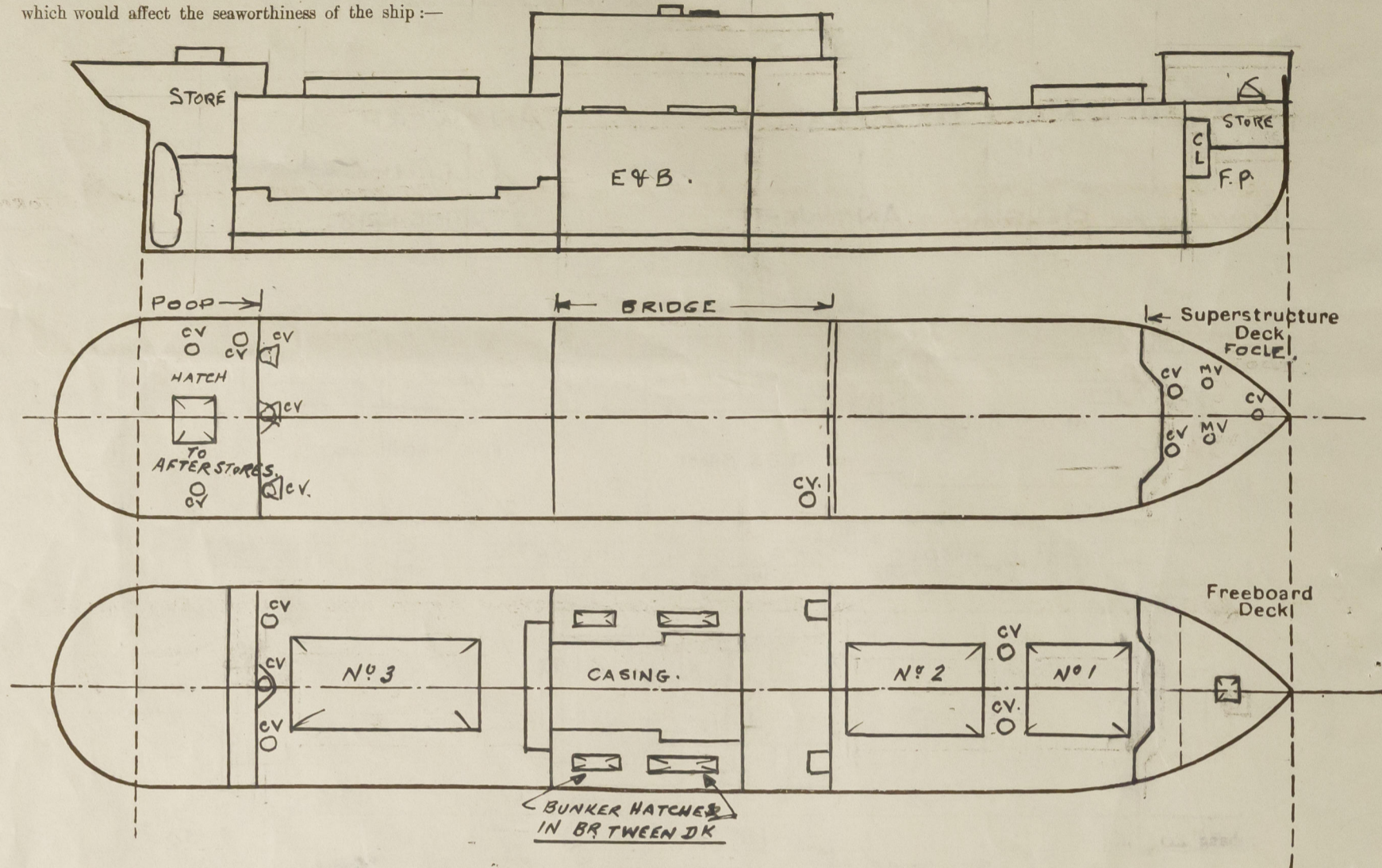

Particulars of fiddley, funnel and ventilator coamings, engine room skylight and other openings in machinery casing tops and their means of closing :—

A STRONGLY CONSTRUCTED STEEL E.R. SKYLIGHT WITH HINGED STEEL FLAPS & FIXED LIGHTS.

FIDDLEY OPENINGS FITTED WITH EFFICIENT HINGED STEEL COVERS AND MEANS OF SECURING.

E.R. & B.R. VENTS (COWL TYPE) WITH STRONG STEEL COAMINGS (WOOD PLUGS & COVERS)

BUNKER HATCHES ON CASING TOP & BOAT DK (FOR PARTICULARS SEE "HATCHWAYS" PAGE 4.)

Particulars of Flush Bunker Scuttles:— *NONE*

Particulars of Companionways:— *NONE*

Particulars of Ventilators in exposed positions on freeboard and superstructure decks :—

ON FORECASTLE JK. 2 M.V.^S TO ACCOMM^N, 230^m/m DIA WITH W.T. SCREW-DOWN STEEL COVERS.

" " " I C.V. TO PEAK STORE; 230' " COAMING 9' x 500' HIGH, WITH WOOD PLUG & CANVAS COVERS.

" " " 2. CV^S TO N°1 CARGO HOLD 450% DIA, " 107% x 750% " " " " " "

ON MAIN DK (FORD WELL) 2 CV'S TO " " 450³/₄ " " 10¹/₄ x 3¹/₄ 45 " " " " 4 " "

ON BRIDGE JK 1 C.V. TO BR TWEEN JK 400% " " 7 1/2 x 500% " " " " 4 " "

ON Q^R DECK 2 CV'S TO AFT CARGO HOLD 350 7/8 " " 10 7/8 x 24 7/8 " " " " " " " " " " " "

" " " 1 C.V. TO TUNNEL RECESS. 350 7/8 " 10 7/8 x 2 1/3 " " " " " " " " " "

ON POOP DECK I. C.V. TO AFTER STORE SPACE 275⁷/₈ " 9⁷/₈ x 830⁷/₈ " " " " & " "

" " " 2 C.V.³ To " " " 275% " 9% x 850% " " " 4 " "

ALL VENT COAMINGS ABOVE 910 7/8 HIGH ARE ADEQUATELY SUPPORTED. ✓

Particulars of Air Pipes in exposed positions on freeboard, raised quarter, or superstructure decks :—

1 AIR PIPE ON FORE DECK, TO F.P.T. 60 7/8 DIA - 300 7/8 ABOVE DK

2 AIRPIPES " " " " NO 1 D.B. TANK 50" DIA. - 500' ABOVE DK ✓

AIRPIPES ON MAIN DECK FORWARD TO D.B. TANKS 50" $\frac{1}{4}$ " DIA - 950" $\frac{1}{4}$ " ABOVE DECK ✓

" " BRIDGE " / To " " 50^m " - 900^m " "

" " RD QR DECK / " " " " 50^m/_m " 950^m/_m " " ✓

1 AIRPIPE ON POOP DECK TO AFTER PEAK TANK 55 7/8 " 550 7/8 " • ✓

ALL AIRPIPES FITTED WITH WOOD PLUGS. ✓

Particulars of Gangway Cargo and Coaling Ports :—

NONE. ✓

Jacques-Marie.

Particulars of Scuppers and Sanitary Discharge Pipes :—

ALL SCUPPERS & DISCHARGES LED OVERBOARD FROM SPACES ABOVE MAIN DECK FITTED WITH STORM VALVES AS PER RULE REQUIREMENTS.

Particulars of Side Scuttles:—

Particulars of Side Scuttles:—
10 - 2507mm DIA SIDESCUTTLES TO FORECASTLE ACCOMMODATION FITTED WITH EFFICIENT DEADLIGHTS. ✓

4 " " " " POOP SPACE. " " " " . ✓

Vertical distance of Sill of lowest Side Scuttle above top of keel 7^m.300. (SIDESCUTTLE IN POOP SPACE) ✓

Particulars of Guard Rails :—

ON FORE DECK - STANCHIONS 1' 100 HIGH WITH 3 RAILS. ✓

ON POOP DECK - " 1^M 20 " " 3 RAILS.

Particulars of Gangways, Lifelines, etc.:—

PROVISION MADE FOR RIGGING LIFELINES.

Particulars of Freeing Arrangements.						
	Length of Bulwark	Height of Bulwark	Size of Freeing Ports	Number each side	Area each side	Rule area each side!
After Well (RR DK) ...	14 ^m 820 ✓	1 ^m 220	800 ^m × 400 ^m	3.	0 ^m 960	1056 M ²
Forward Well (MAIN DK)	18 ^m 810.	1 ^m 220	800 ^m × 400 ^m	4.	1 ^m 28	1178 M ²
<p>State position of each freeing port { After Well :— } SEE DIAGRAM (PAGE 1)</p> <p>(F. and A. position and height above deck edge) { Forward Well :— } 250^m ABOVE DECK EDGE.</p> <p>State whether the freeing ports are fitted with shutters, bars, or rails, and give particulars of such :— 6^m STEEL SHUTTERS (HINGED)</p> <p>Additional area where sheer is less than standard.</p>						

PARTICULARS OF PROTECTION TO OPENINGS, ETC.

HATCHWAYS ON FREEBOARD AND SUPERSTRUCTURE DECK.									
Description of Hatchway	No 1 CARGO HATCH	No 2 CARGO HATCH	No 3 CARGO HATCH	BUNKER HATCHES IN BR. TW. DK. (P.V.S.)	HATCH TO BUNKER STORE ON POOP DK. (P.V.S.)	HATCH TO BUNKER STORE ON FORD STORE. (P.V.S.)	HATCH TO BUNKER STORE ON FORD STORE. (P.V.S.)	HATCH TO BUNKER STORE ON FORD STORE. (P.V.S.)	HATCH TO BUNKER STORE ON FORD STORE. (P.V.S.)
Dimensions of Hatchway	5,130 X 4,870	7,980 X 4,870	7,980 X 4,870	3,125 X 500	600 X 2,130	1,800 X 900	1,800 X 1,800	500 X 500	900 X 258
COAMINGS	Height above Deck	960	950	850	750	230	870	750	360
	Thickness	12	12	12	12	9	9	9	7
	Stiffeners	PLATE 220 X 9	AS NO. 1	AS NO. 1	75 X 75 X 9	9	9	9	7
	Brackets, Stays	80 X 75 T. BAR	DO	DO	✓	NONE	NONE	NONE	NONE
HATCH BEAMS	Number	2	2	2	NONE	NONE	1 (BND)	NONE	NONE
	Spacing	2,565	2,66	2,66	NONE	NONE	900	NONE	NONE
	Scantling and Sketch	7" 90 X 90 X 9 7/8	DO	DO	(DK BEAMS CONTINUOUS IN WAY OF OPENINGS)	NONE	75 X 75 X 8	NONE	NONE
	Bearing Surface	45	75	75	75	75	75	75	75
FORE AND AFTERS	Number	2	2	2	NONE	NONE	NONE	NONE	NONE
	Spacing	1,623	1,623	1,623	NONE	NONE	NONE	NONE	NONE
	Unsupported Lengths	2,565	2,66	2,66	NONE	NONE	NONE	NONE	NONE
	Scantling* and Sketch	7" 70 X 70 X 10 7/8	DO	DO	NONE	NONE	NONE	NONE	NONE
HATCH COVERS	Material	WOOD	WOOD	WOOD	WOOD	WOOD	WOOD	WOOD	WOOD
	Thickness	75	75	75	75	75	75	75	75
	How fitted	ATHWART	ATHWART	ATHWART	ATHWART	ATHWART	ATHWART	ATHWART	ATHWART
	Bearing Surface	80	80	80	75	75	75	75	75
Spacing of Cleats	600	600	600	NONE	600	600	600	NONE	600
Number of Tarpaulins	TWO	TWO	TWO	NONE	TWO	TWO	TWO	NONE	TWO

*Are wood fore and afters steel shod at all bearing surfaces? (STEEL FORE & AFTERS.)
 Are battens and wedges efficient and in good condition? YES.
 Are tarpaulins in good condition and in accordance with rule requirements? YES.
 Are lashings provided in accordance with rule requirements? YES.

Particulars of any special features:—

TIMBER DECK CARGOES. (SPECIAL REQUIREMENTS)

DOUBLE BOTTOM TANKS NOS 2, 3, 4 & 5 (WITHIN MIDSHIP 1/2 LENGTH) SUBDIVIDED LONGITUDINALLY AS PER REGULATIONS.

STEERING RODS AND GEARING ADEQUATELY PROTECTED FROM DAMAGE BY CARGO.

ANGLE SOCKETS FOR UPRIGHTS ATTACHED TO MAIN & R. Q. R. DECK STRINGER PLATE, SPACING DOES NOT EXCEED 10'-0"

STRONG STEEL HOOD OVER QUADRANT & HAND STEERING GEAR ON POOP DECK

BULWARKS, STEEL 7" THICK X 22 HIGH WITH 165" B.A. RAIL & STIFFERS 140" X 8 BULB PLATE

RING BOLTS FOR SECURING DECK CARGO WIRES, RIVETED TO STRINGER PLATE SPACED NOT MORE THAN 10'-0" APART AND 5'-0" FROM SUPERSTRUCTURE BULKHEADS

Reinforced

Endorsement at first survey and at surveys for renewal of Certificate:—

The fittings and appliances are in accordance with the particulars shown on this form (or as now modified) and are in good condition.

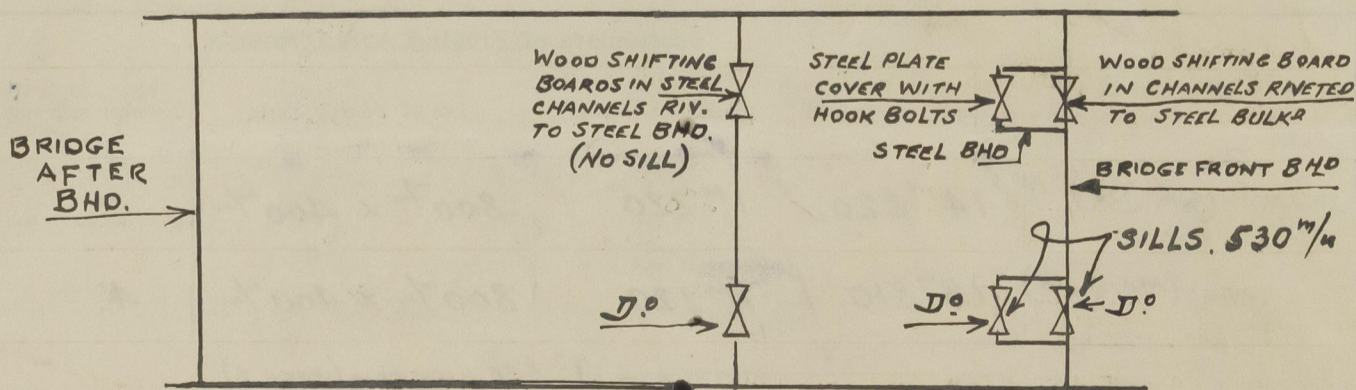

DETAIL SHOWING OPENINGS IN BRIDGE SPACE



© 2020

Lloyd's Register
Foundation