

2- NOV 1951

Rpt. C. 11 (Contd.)

Index No. ....

## Lloyd's Register of Shipping.

Ship's Name

"ELIAN HILL"

Official No. 132894

Memorandum of alterations reported since ship was surveyed for assignment of Load Lines in \_\_\_\_\_

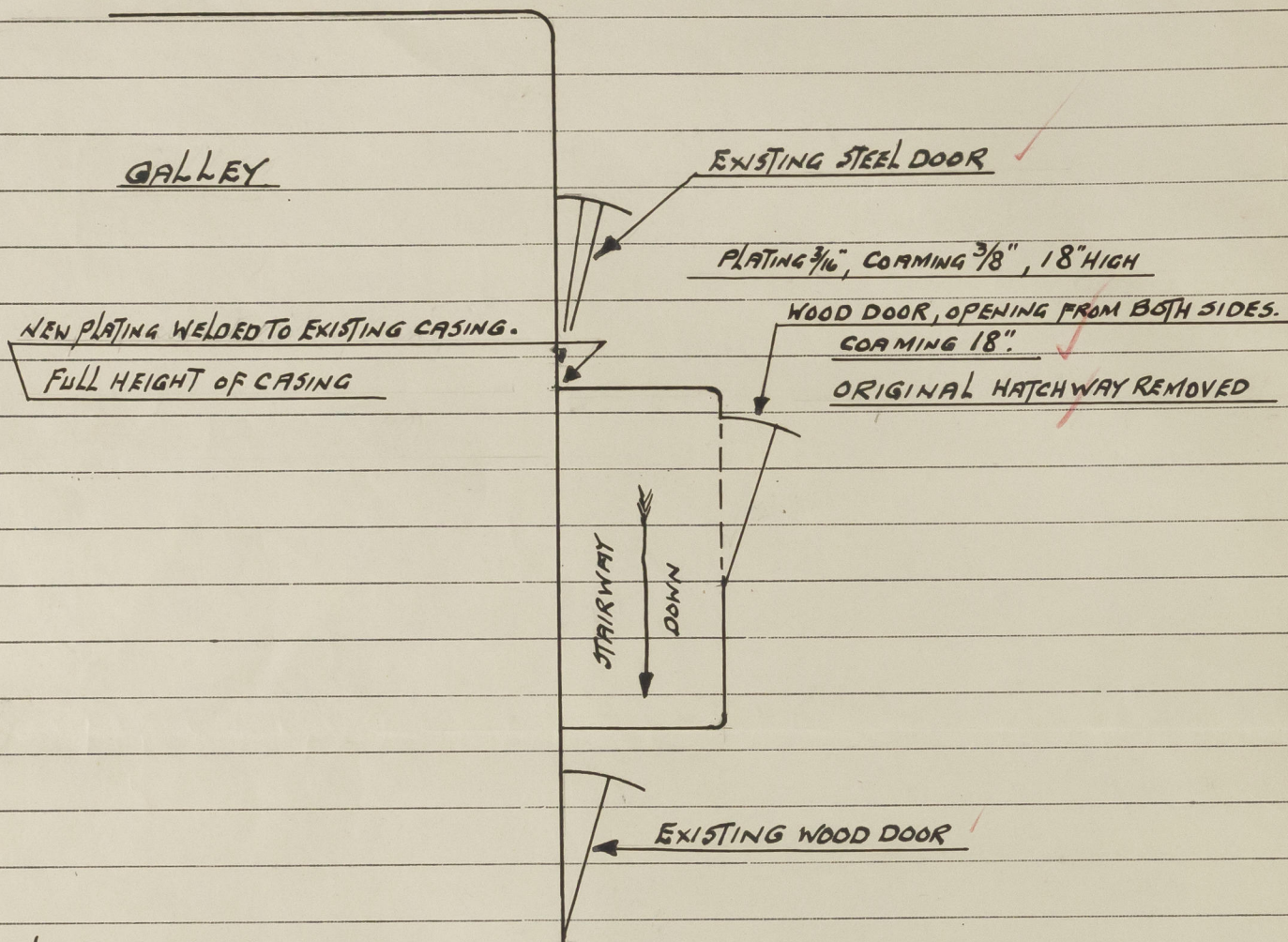
COMPANIONWAY TO CREWS QUARTERS AFTCREW'S ACCOMM<sup>Y</sup> AFT:-

PORT LIGHTS:- 1. P. I. S 10" DIA, BRASS FRAMES & DEADLIGHTS; FIXED LIGHTS, GLASS 1" THICK.

1 1/2" DIA SCUPPER LED TO ENA RM BILGES, WITH LEVER WEIGHTED COCK

VENTILATORS:- 30 6" DIA, COAMING 36" HIGH, 3/16" THICK (1. P, 1. S, 1 AFT) ON R Q D; WITH WOOD PLUGS & CANVAS COVERS

CREW'S ACCOMM<sup>Y</sup> FOR<sup>D</sup>

1 1/2" SCUPPER FROM WASHPLACE (P), WITH BRASS N. R. V ON SHIP'S SIDE.

G.H.W.  
6- NOV '951

W. G. H.

© 2020

Lloyd's Register

002385-002400-0055