

# Lloyd's Register of Shipping.

## SURVEYS FOR FREEBOARD.

### (CONDITIONS OF ASSIGNMENT.)

Ship's Name *m/v Sagona*Port of Survey *Rotterdam*

Official Number

Surveyor's Signature *John J. H. J.*Nationality and Port of Registry *Liamsand*Dates of Survey *25/10, 30/10, 3/11, 6/11 1939.*

Disposition and dimensions of superstructures, trunks, deckhouses and machinery casings to be inserted in the diagrams and tabular statement:—

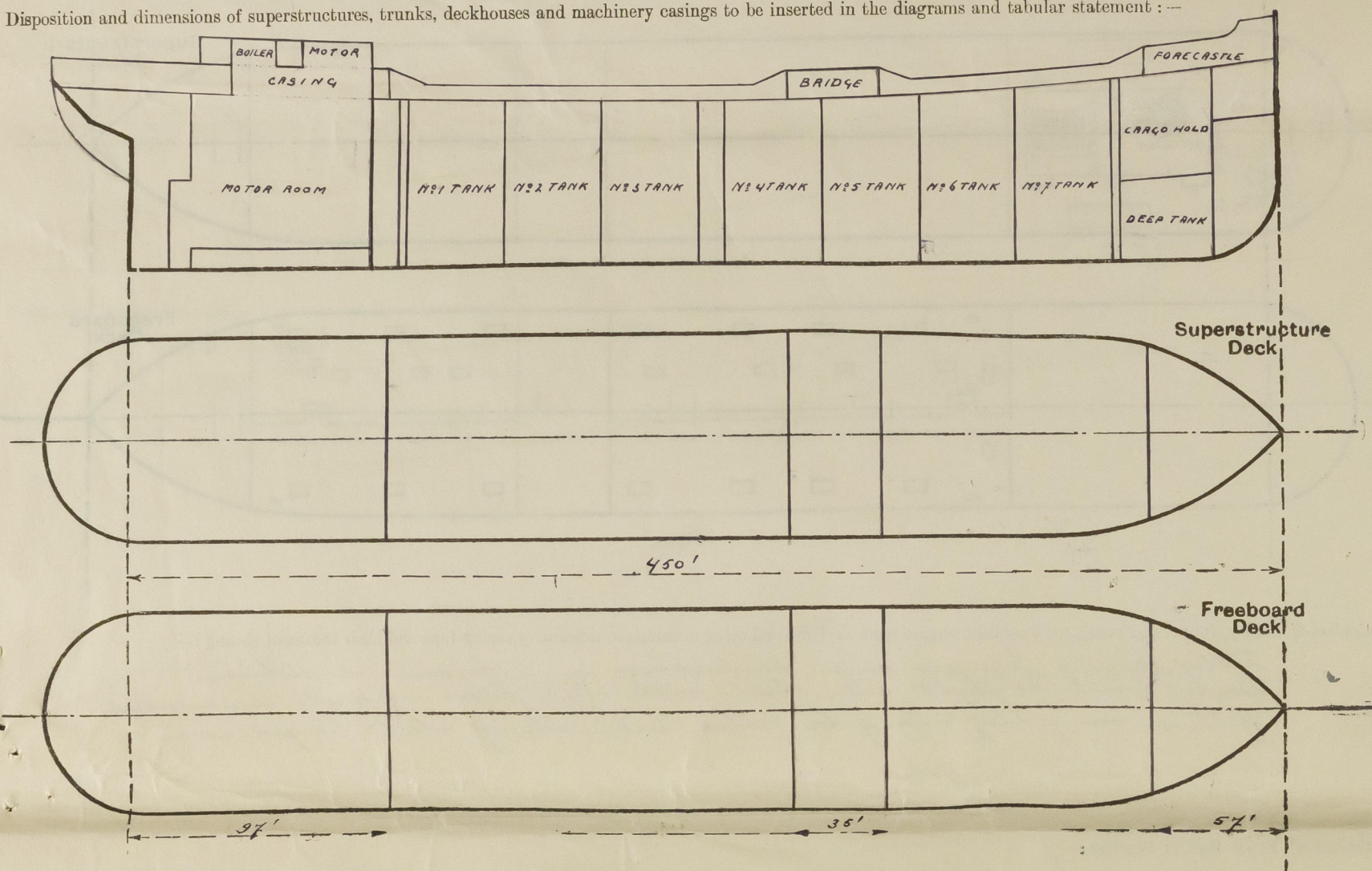

	Coaming	Plating	Stiffeners	Spacing	End Attachments of Stiffeners	Size of Openings	Height of Sills	Height of Casings
Poop Bulkhead ... ..	48" x 1/2"	1/2"	2 in. 9 room cas. bllk. 2' 10" x 3 1/2" x 1/2"	23"	brackets top and bottom	4' 10" x 2' 2"	18"	7' 6"
Raised Quarter Deck Bulkhead ...	—	—	—	—	—	—	—	—
Bridge, After Bulkhead ... ..	48" x 1/2"	1/2"	4 6 3/4 x 3" x 1/2"	29"	attached to top deck beams at top lugs at bottom	4' 6" x 3"	21"	7' 6"
Bridge, Forward Bulkhead ... ..	48" x 1/2"	1/2"	2 9 x 3 1/2 x 1/2"	29"	bracket at top lugs at bottom	4' 6" x 3"	21"	7' 6"
Fore-castle Bulkhead ... ..	48" x 1/2"	1/2"	4 6" x 3 1/2" x 1/2"	27"	none	4' 6" x 3"	22"	7' 6"
Trunk, Aft ... ..	—	—	—	—	—	—	—	—
Trunk, Forward ... ..	—	—	—	—	—	—	—	—
Exposed Machinery Casings on Free-board or Raised Quarter Decks ...	—	—	—	—	—	—	—	—
Exposed Machinery Casings on Super-structure Decks ... ..	3/8"	3/8"	4 5" x 3" x 3/8"	30"	bracket top	5' 4" x 2' 3"	15"	7' 6"
Machinery Casings within Superstructures not fitted with Class I Closing Appliances ... ..	—	—	—	—	—	—	—	—
Deckhouses on Flush Deck Ships ...	—	—	—	—	—	—	—	—

## Particulars of Closing Appliances (state if capable of being manipulated from both sides).

Poop Bulkhead ... ..	Hinged steel doors (watertight) operated from both sides ✓
Raised Quarter Deck Bulkhead ...	—
Bridge, After Bulkhead ... ..	no means of closing to the openings ✓
Bridge, Forward Bulkhead ... ..	Hinged steel doors (watertight) operated from both sides.
Fore-castle Bulkhead ... ..	1 opening closed by bolted steel plate. 1 opening no closing app.
Exposed Machinery Casings on Free-board or Raised Quarter Decks ...	—
Exposed Machinery Casings on Super-structure Decks ... ..	Hinged steel doors operated from both sides. ✓
Machinery Casings within Superstructures not fitted with Class I Closing Appliances ... ..	—
Deckhouses on Flush Deck Ships ...	—



## PARTICULARS OF PROTECTION TO OPENINGS, ETC.

The following diagrams should be used to indicate the positions of cargo and coaling hatchways, gangway, cargo and coaling ports, ventilators, companionways, etc., which would affect the seaworthiness of the ship:—

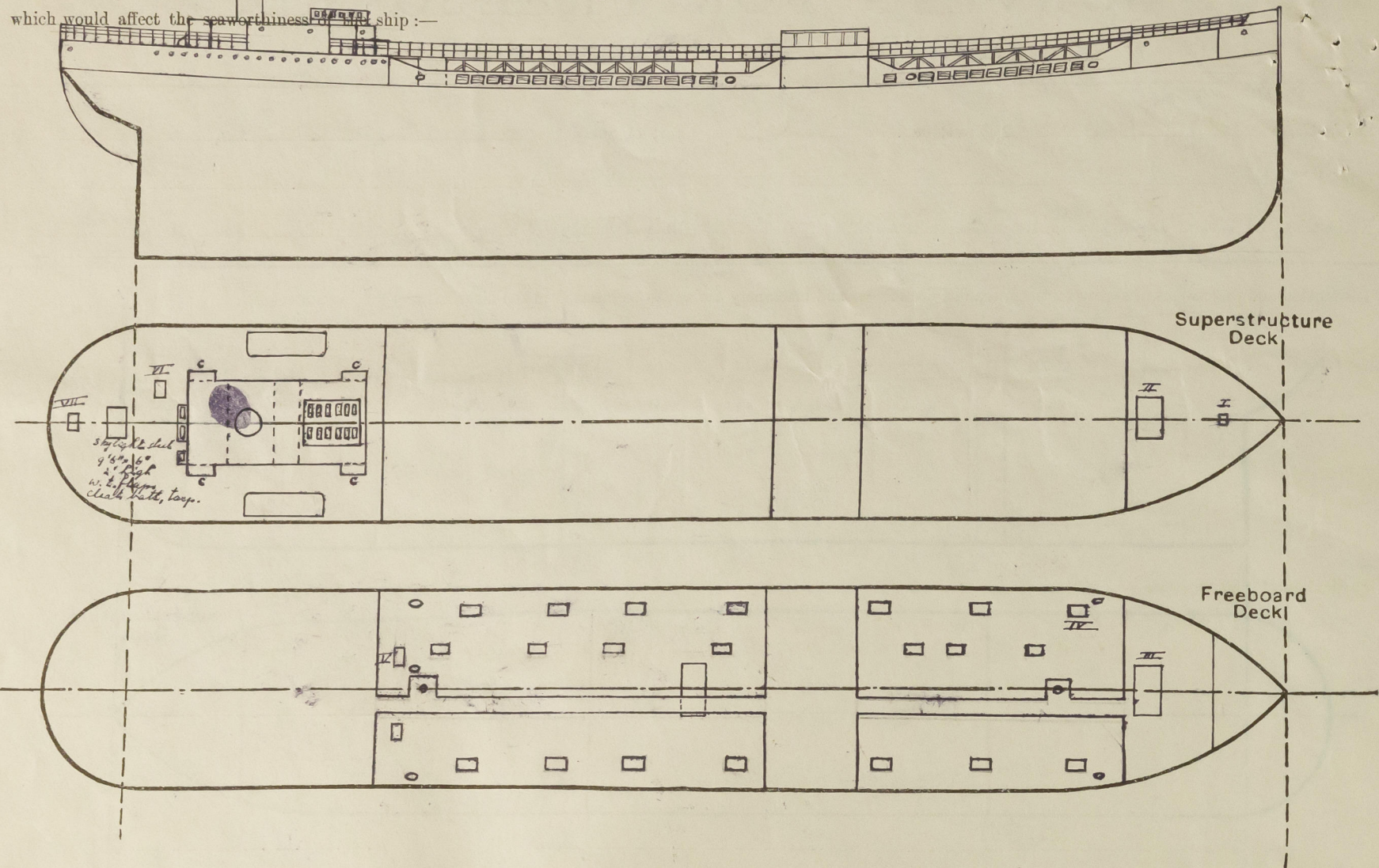

Particulars of fiddley, funnel and ventilator coamings, engine room skylight and other openings in machinery casing tops and their means of closing :—

Fidley casing, funnel and ventilators in efficient condition.  
Motor room skylight all steel with steel flaps strongly constructed.  
Gratings on fidley casing top fitted with strong steel hinged cover.

Particulars of Flush Bunker Scuttles:—

none fitted

Particulars of Companionways :—

On forward deck in afterwell one steel companion way leading to main pumproom, 16' x 8' x 7' 6" high, plating 30, stiffeners 4 x 3 x 1/8, spacing 5' x 3", with 18", but height w.t. door to operate from outside only (skylight 6' x 5" with w.t. flap & toggle) ✓

4 companions (or Sketched marked C) connected to corners of motor using 1 x 4 pop. deck, leading to big accommodations, each 6'6" x 3'3" x 7'6" high, opening 5'4" x 2", with 15" wood door, operated from both sides.

Particulars of Ventilators in exposed positions on freeboard and superstructure decks :—

4 mushroom vents (screw down type) on top companion on poop 4" x 12" high ✓  
 4 vents on boiler casing 28" x 7 1/2" high approx ✓  
 3 vents on motor room ceiling 28" x 7 1/2" ✓  
 8 vents on poop deck 10" x 12" high, leading to spaces below ✓  
 4 goose-neck vents on poop deck 26" x 15" high, leading to workplace in poop. ✓  
 2 vents on pump room (leading waste) ✓  
 3 goose-neck vents on bridgedeck 6" x 15" high, leading to stores below. ✓  
 2 vents on present deck 15" x 3", with w.c. screw down stool covers, leading to hold ✓  
 3 vents " " 12" x 3", " " " ✓  
 1 vent on " " 8" x 3", leading to store above forecast tank ✓  
 2 vents " " 5" x 12" leading to forecast space ✓  
 1 vent on cofferdam aft 15" x 3" leading w.c. screw down stool cover. ✓  
 2 " " 9" x 3", " " " ✓  
 2 " " ford 13" x 3", " " " ✓  
 2 " " 9" x 3", " " " ✓

wood plugs + canvas  
cones fitted (see Lou Tunney's  
letter 1/12/39)

Particulars of Air Pipes in exposed positions on freeboard, raised quarter, or superstructure decks :—

[illegible]

wood plugs & saws cones  
fitted (see Edw. Lumsden letter 1/18/34)

Particulars of Gangway Cargo and Coaling Ports:—

none fitted ✓

Saguna.

Particulars of Scuppers and Sanitary Discharge Pipes :—

Forewell 2 scuppers, afterwell 2 scuppers cut through stringer edge. ✓  
Sanitary discharges of bridge and poop spaces are all above the grubbed deck and  
fitted with automatic non return valves in the poop space. ✓

Particulars of Side Scuttles:—

Side scuttles in forecabin and poop are of substantial construction and fitted with permanently attached deadlight.

Vertical distance of Sill of lowest Side Scuttle above top of keel

Particulars of Guard Rails :—

on fence and prop railing with 5 rods 3' 7" high, spaced 4' apart  
on bridge bulwark efficiently constructed 3' 7" high, standards 1 5/8" x 3 1/2" x .44, 6' apart  
in fore and aft well steel bulwarks 3' 7" high, supports of bulkheads every 6'

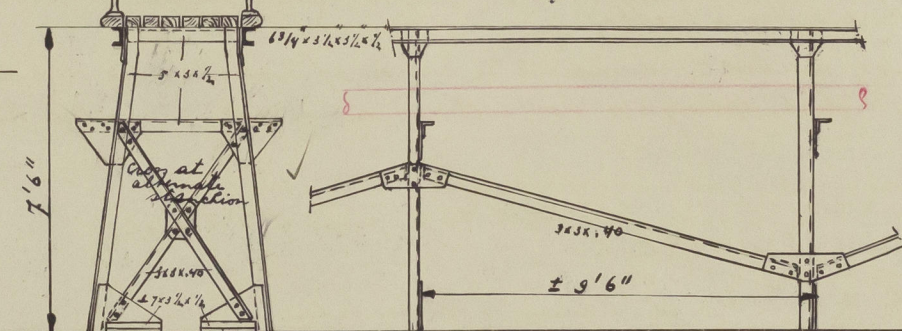

Particulars of Gangways, Lifelines, etc. :—

Particulars of Freeing Arrangements.

	Length of Bulwark	Height of Bulwark	Size of Freeing Ports	Number each side	Area each side	Rule area each side
After Well ... ..	155' 4" 131.73	3' 4"	average area 7.6 sq ft	18	136 sq ft	
Forward Well ... ..	101' 4" 103.40	3' 4"	average area 8.2 sq ft	11	90 sq ft	

State position of each freeing port	...	...	{ After Well :- { Forward Wel
(F. and A. position and height above deck edge)			

State whether the freeing ports are fitted with shutters, bars, or grates, and give particulars of such:— *bars 1" in thickness*

Additional area where sheer is less than standard.

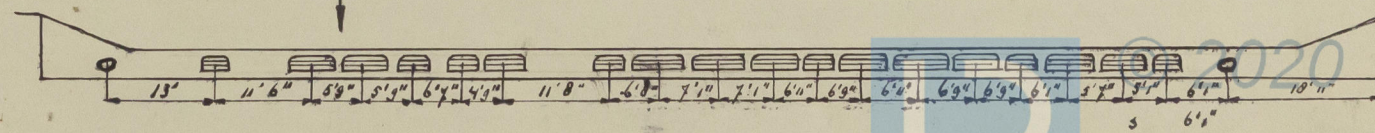



PARTICULARS OF PROTECTION TO OPENINGS, ETC.

HATCHWAYS ON FREEBOARD AND SUPERSTRUCTURE DECKS.											
			I	II	III	IV	V	VI	VII		
Description of Hatchway ... ..			forepeak	forecastle	main deck	cargo tanks	bunker	roop	roop		
Dimensions of Hatchway ... ..			2' x 2' 4"	14' x 10' 6"	12' x 9'	6' x 3' 6"	3' 9" x 2' 6"	3' 8" x 2' 8"	3' 6" x 2' 10"		
COAMINGS	{	Height above Deck ... ..	2' ✓	3' ✓	10" ✓	35" ✓	2' 9" ✓	2' ✓	2' ✓		
		Thickness ... ..	{	Sides ... ..	3/8" ✓	1/2" ✓	1/2" ✓	1/2" ✓	3/8" ✓	3/8" ✓	
				Ends ... ..	3/8" ✓	1/2" ✓	1/2" ✓	1/2" ✓	3/8" ✓	3/8" ✓	
		Stiffeners ... ..	—	—	—	—	—	—	—	—	
		Brackets, Stays ... ..	—	—	—	—	—	—	—	—	
HATCH BEAMS	{	Number ... ..		1							
		Spacing ... ..		—							
		Scantling and Sketch ... ..									
		Bearing Surface ... ..		3" ✓							
FORE AND AFTERS	{	Number ... ..									
		Spacing ... ..									
		Unsupported Lengths ... ..									
		Scantling* and Sketch ... ..									
		Bearing Surface ... ..									
HATCH COVERS	{	Material ... ..	steel	pine	steel	steel	steel	pine	steel		
		Thickness ... ..	1/2" ✓	3" ✓	1/2" ✓	3/16" ✓	3/16" ✓	2 1/2" ✓	3/8" ✓		
		How fitted ... ..	with	F 4 A ✓	bolted	hinged	hinged	tharship	—		
		Bearing Surface ... ..	4 toggles	3" ✓	3" ✓	15' 1/8" toggles	11 1/8" toggles	3" ✓	—		
Spacing of Cleats ... ..				23" ✓				15" ✓	4 toggles ✓		
Number of Tarpaulins ... ..				3 ✓				2 ✓			
<p>*Are wood fore and afters steel shod at all bearing surfaces ?</p> <p>Are battens and wedges efficient and in good condition ?</p> <p>Are tarpaulins in good condition and in accordance with rule requirements ?</p> <p>Are lashings provided in accordance with rule requirements ?</p>											

Particulars of any special features :—

Endorsement at first survey and at surveys for renewal of Certificate :—

The fittings and appliances are in accordance with the particulars shown on this form (or as now modified) and are in good condition.





Disposition and dimensions of superstructures, trunks, deckhouses and machinery casings to be inserted in the diagrams and tabular statement : —

