

PROFILE OF A FREIGHT STEAMER.  
TO CLASS LLOYD'S 100 A.I. SINGLE DECK STEEL.

DIMENSIONS.  
LENGTH BETWEEN PERP.<sup>s</sup> 235'-0"  
LENGTH AS PER RULE. 235'-0"  
BREADTH " 37'-6"  
DEPTH MOULDED 18'-7"

SCALE 1/8" = 1 FOOT.

masts, masts, and windlass  
supplied by Kockums Satisfaction

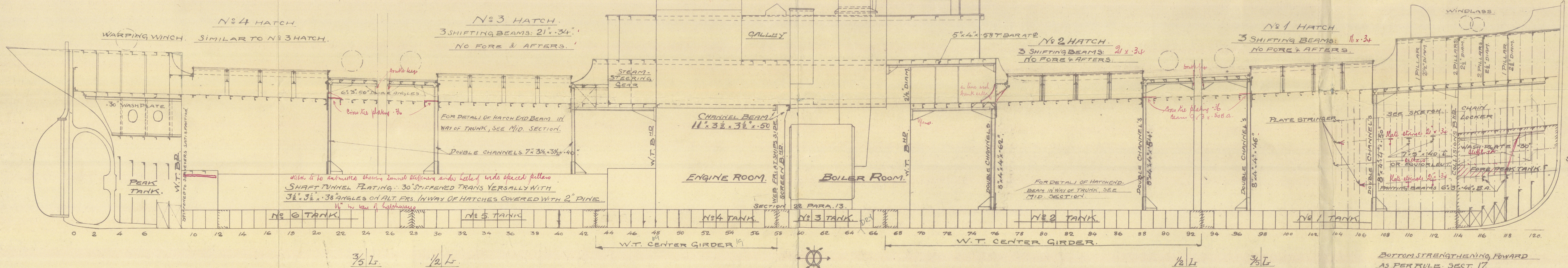

BOW STRENGTHENING.  
FROM STEM TO FR. 104 INTERMEDIATE  
FRAMES TO BE FITTED EXTENDING DOWN  
TO TOP OF MARGIN BRACKETS BESIDES SHELL.  
STRAKES GUN AT L.W.L. BEING INCREASED  
TO 79" AND 60" RESP. STRAKES BELOW 44".

BOTTOM STRENGTHENING FORWARD  
AS PER RULE SECT. 17

1.8.13  
20.8.13

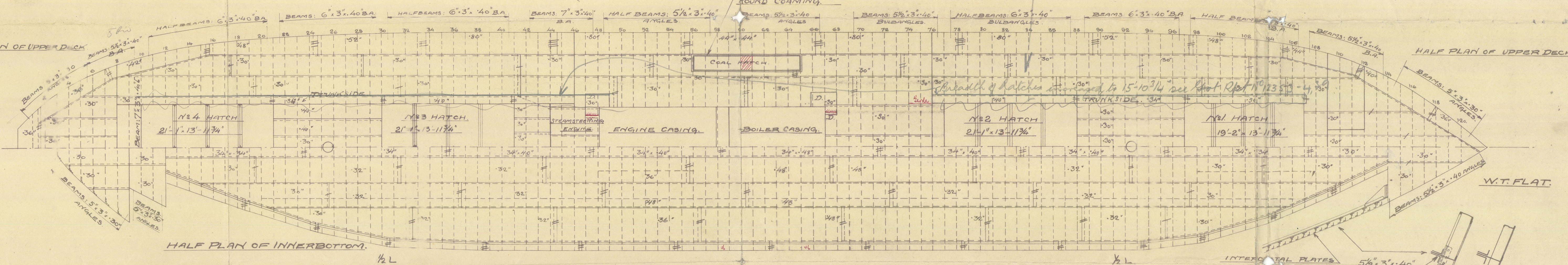
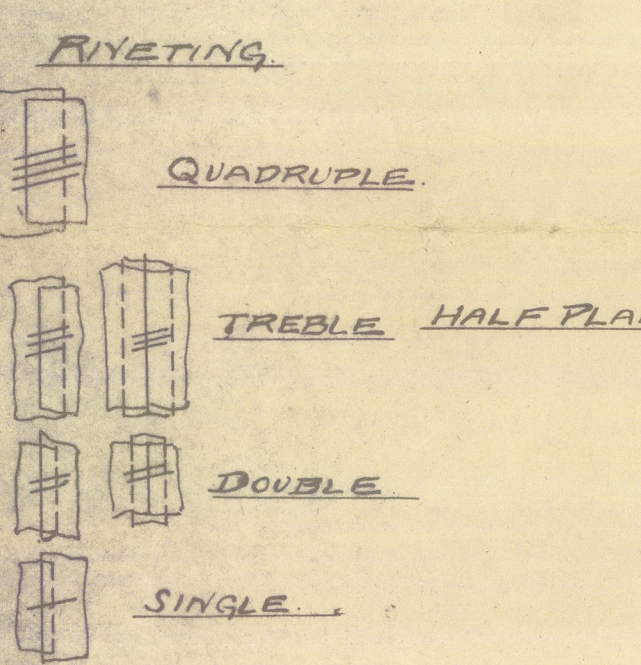
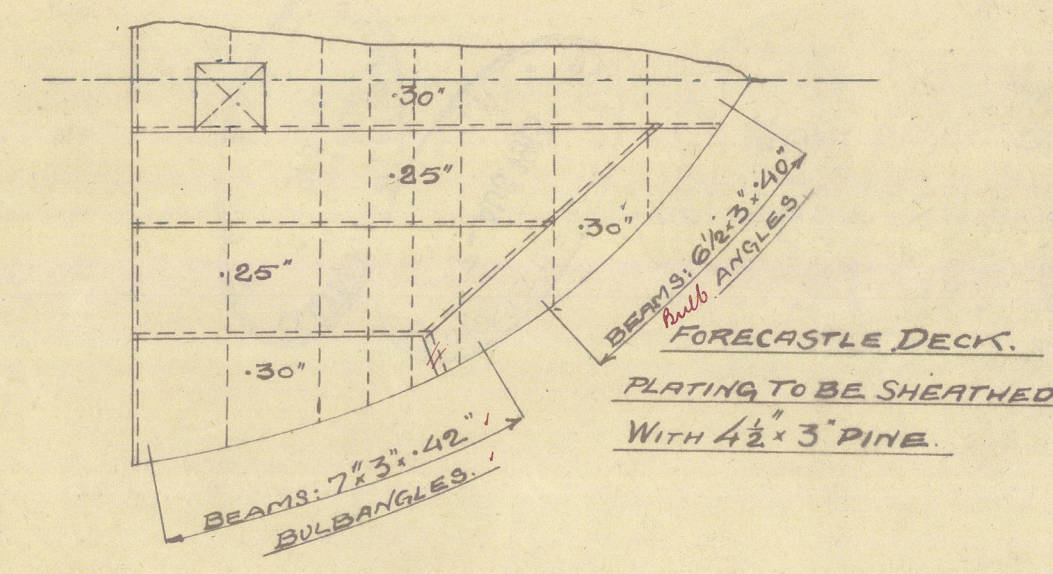
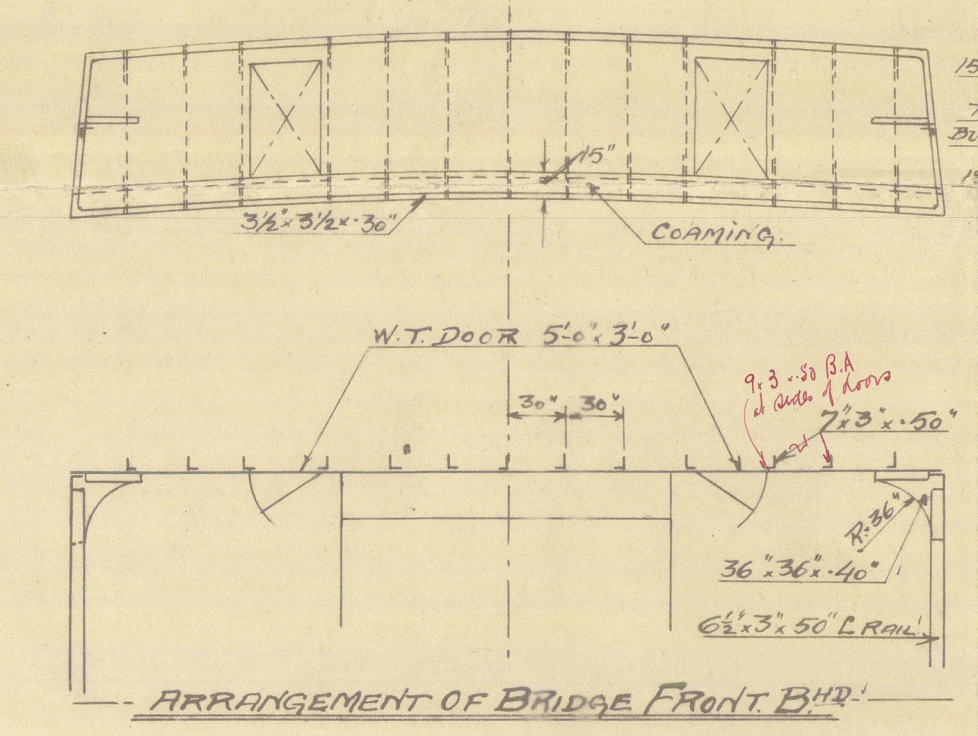
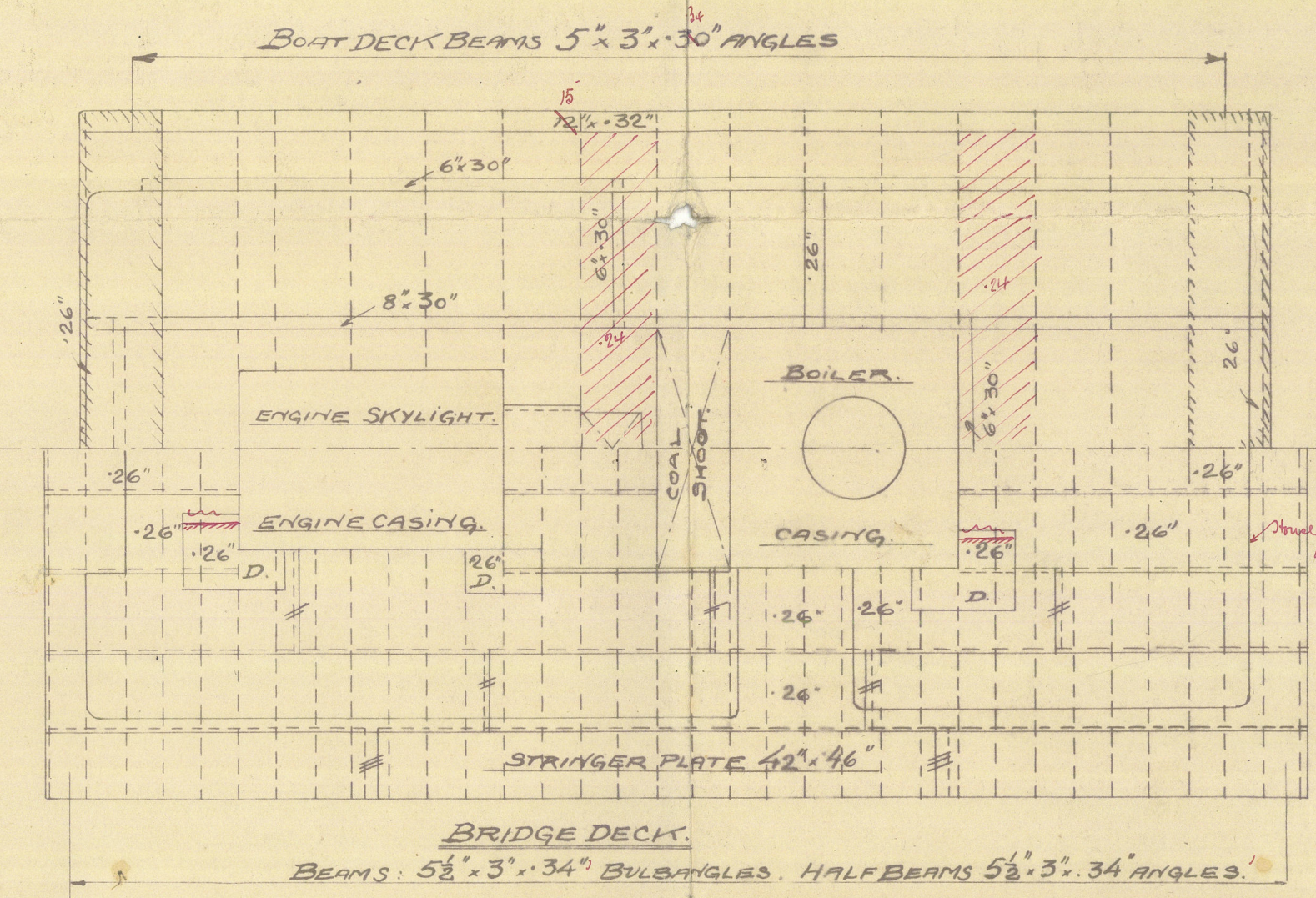
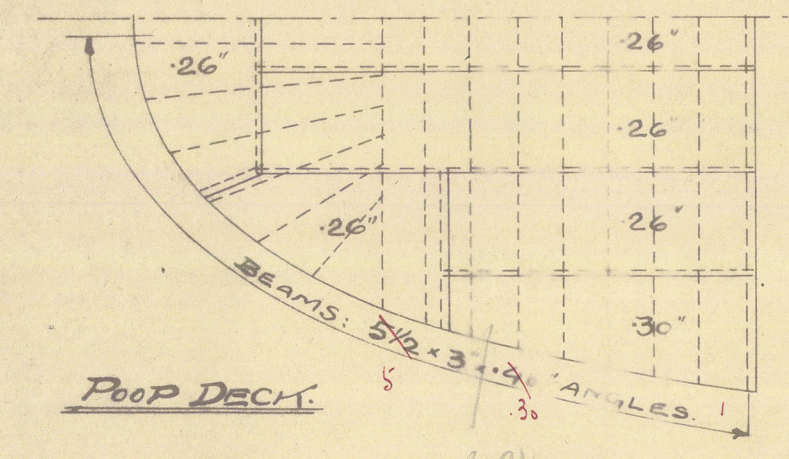

STRENGTHENING OF SHELL PLATING  
IN WAY OF LONG BRIDGE.

ARRANGEMENT AT BREAKS  
TO SURVEYORS SATISFACTION.  
STRINGER ANGLE NOT TO BE CUT AT BREAK  
BRACKET

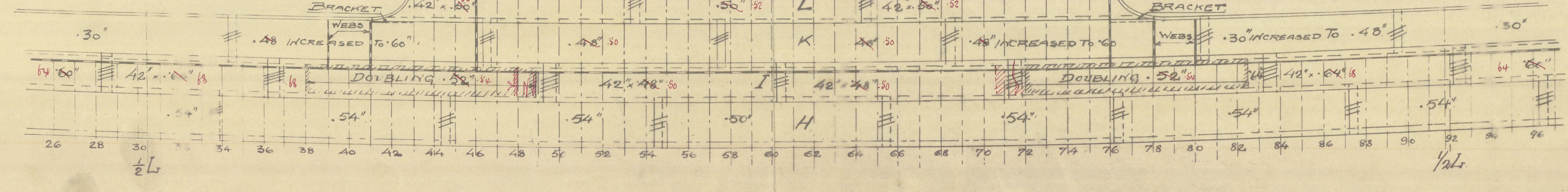

1.8.13

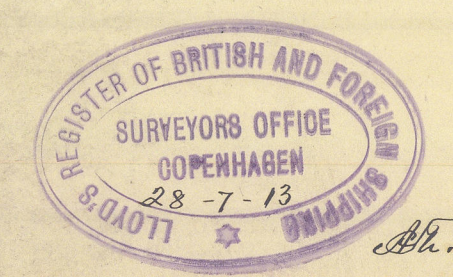

S.S. 118.  
LLOYD'S PROFIL

SKALA 1/96 & 1/24.

RIT. KOP. OR. GOK.

KOCKUMS MEK. VERKSTADS A.B.  
MALMO

Lloyd's Register  
F.A. 118/10



Kockum's Mak. Værkstad's

W.B.

Malmö

Newbuilding No 118.

Longitudinal Section. Oscar

S.S. Johan - Same

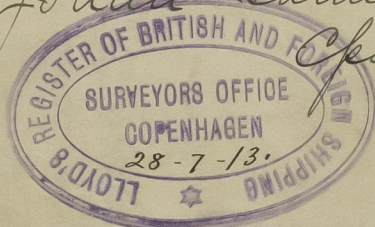

Cpu 4276

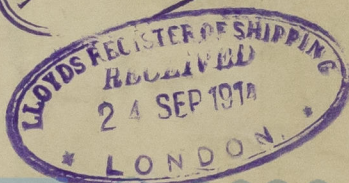

© 2020

002320-002329-0132  
Lloyd's Register  
Foundation