

Rpt. No. 2107.

29 DEC 1942

Lloyd's Register of Shipping.

6853

SURVEYS FOR FREEBOARD.

(CONDITIONS OF ASSIGNMENT.)

Ship's Name **S/S "ODDEVOLD"** Port of Survey **Lönsborg.**
 Official Number **4611** Surveyor's Signature **A. Börning**
 Nationality and Port of Registry **Swedish, Stockholm.** Date of Survey **14th Oct. 1942**

Disposition and dimensions of superstructures, trunks, deckhouses and machinery casings to be inserted in the diagrams and tabular statement.

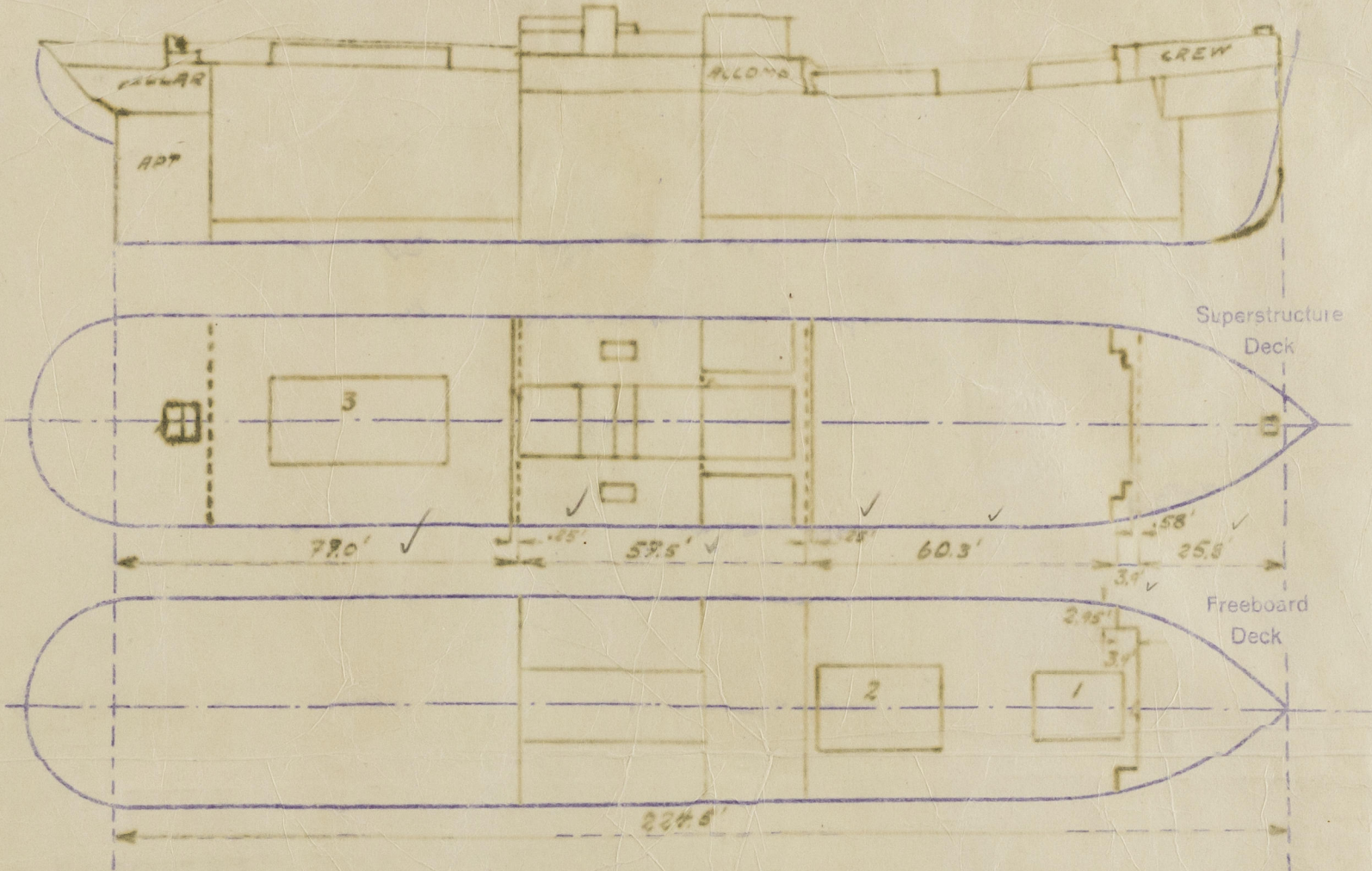

Particulars of Superstructures, Trunks, Casings, Deckhouses.

	Coaming	Plating	Stiffeners	Spacing	End Attachments of Stiffeners	Size of Openings	Height of Sills	Weight of Casings
Prop Bulkhead								
Raised Quarter Deck Bulkhead								
Bridge, After Bulkhead								
Bridge, Forward Bulkhead								
Forecastle Bulkhead						54" x 25"	25"	✓
Trunk, Aft								
Trunk, Forward								
Exposed Machinery Casings on Freeboard or Raised Quarter Decks								
Exposed Machinery Casings on Superstructure Decks								
Machinery Casings within Superstructures not fitted with Class I Closing Appliances								
Deckhouses on Aft Deck ships								

Particulars of Closing Appliances (state if capable of being manipulated from both sides).

Prop Bulkhead	
Raised Quarter Deck Bulkhead	
Bridge, After Bulkhead	
Bridge, Forward Bulkhead	
Forecastle Bulkhead	
Trunk, Aft	
Trunk, Forward	
Exposed Machinery Casings on Freeboard or Raised Quarter Decks	
Exposed Machinery Casings on Superstructure Decks	
Machinery Casings within Superstructures not fitted with Class I Closing Appliances	
Deckhouses on Aft Deck ships	

Hinged steel door, capable of being manipulated from both sides. ✓



© 2021

Lloyd's Register Foundation

00229-002318-0039

29 DEC 1942

PARTICULARS OF PROTECTION TO OPENINGS, ETC.

Matchways on Freeboard and Superstructure Decks.		No. 1	No. 2	No. 3	Forecastle.
Description of Hatchway					
Dimensions of Hatchway				34 1/2' x 16'	700 = 450 mm.
COAMINGS	Height above Deck			800 mm.	
	Thickness			11 mm.	
	Ends			11 mm.	
	Sides			11 mm.	
	S stiffeners	180 = 90 x 11 L	2	→ 200 = 75 x 12 L	
	Brackets, Stays	1		3	
HATCH BEAMS	Number			47	
	Spacing			5'	
	Scantling and Sketch			70 x 90 x 11 L	
	Bearing Surface			370 x 10 pl.	
				190 x 16 pl.	
				3"	
FORE AND AFTERS	Number				
	Spacing				
	Unsupported Lengths				
	Scantling and Sketch				
	Bearing Surface				
HATCH COVERS	Material			Wood	Steel
	Thickness			2 1/2"	Hinged
	How fitted			F. & A.	W.T.
	Bearing Surface			3"	corr.
Spacing of Cleats				24"	
Number of Taraulins				2	
<p>*) Are wood fore and afters steel shod at all bearing surfaces?</p> <p>Are tarpaulins in good condition and in accordance with rule requirements?</p> <p>Are battens and wedges efficient and in good condition?</p> <p>Are lashings provided in accordance with rule requirements?</p>					

Particulars of any special features:—

Endorsement at first surveys and at surveys for renewal of Certificate:—

The fittings and appliances are in accordance with the particulars shown on this form (or as now modified) and are in good condition.



© 2021

Lloyd's Register Foundation