

Lloyd's Register of British & Foreign Shipping.

SURVEYS FOR FREEBOARD.-STEAM SHIPS.

15,839
28075
OCT. 27 1920

PARTICULARS RELATING TO ALL STEAM SHIPS EITHER FLUSH DECKED, OR WITH TOP GALLANT FORECASTLES, SHORT POOPS AND BRIDGE HOUSES DISCONNECTED, OR WITH TOP GALLANT FORECASTLES HAVING LONG POOPS, OR RAISED QUARTER DECKS CONNECTED WITH BRIDGE HOUSES, OR OTHERWISE.

Port of Survey *Louth*
Date of Survey *6th October 1920*
Name of Surveyor *J. J. Henderson*

Ship's Name. *ARDENZA*
Port of Registry and Nationality. *Louth British*
Official Number. *142025*
Gross Tonnage. *933.31*
Date of Build. *1920*
Particulars of Classification. *+100 H1 Contemplated*

Registered dimensions from Ship's Register.	LENGTH.	BREADTH.	DEPTH.	UNDER DECK TONNAGE.
	<i>210.00</i>	<i>31.7</i>	<i>12.33</i>	<i>639.98</i>
Length on LOADLINE.	<i>210.0</i>	Frame Depth <i>57</i> Rule <i>3 1/2</i> <i>2 1/2</i> <i>42</i>	Ceiling <i>22</i> Sheer <i>+58</i> <i>To inner bottom 12.46</i>	Peak <i>Included in tonnage</i> Tanks <i>Under floor in way of bridge</i> <i>-44.00 tons</i>
CORRECTED DIMENSIONS.	<i>210.0</i>	<i>31.28</i>	<i>12.97</i> <i>13.04</i>	<i>625.98</i>

Co-efficient of fineness..... *.738* *.742*
Any modification necessary { *.02 CDB*
[Para. 4 (a) to (e)]*
Co-efficient as corrected *.718* *.72*

Sheer { Stem *60* } *102 ÷ 2 = 51* Mean
at { Sternpost *42* }
Sheer at 1/2 of the length from { Stem *35* } *60 ÷ 2 = 30* Mean
{ Sternpost *25* }
Gradual mean Sheer *allowed* *52.76 ÷ 55 = 54.54*
Standard mean Sheer [Table, Para. 18] *31.00* Correction
Difference..... *21.44 ÷ 4 = 5.44*
§ If limited as Para. 18 (f)..... *- 5 1/2*

Rise in Sheer { At front of bridge house..... ✓
from amidships {
[Para. 18 (e)] { At after end of forecastle ✓

Fall in Sheer {
Para. 18 (d) } *÷ 2 =* ✓
Length uncovered Correction

ALLOWANCE FOR DECK ERECTIONS :-

Freeboard, Table C..... *0.6*
Correction for Length, if required (Para. 12, 13, and 14) ✓
Freeboard by Table A, corrected for sheer, and for length, if required (Para. 12, 13, and 14) *1.10*
Difference *1.4*
Percentage as below..... *51.17*
- 8.17
Correction for R. Q. Dk. if engine and boiler openings not covered by bridge house (Para. 11) *+1*
Allowance for Deck Erections *- 4 1/4*

	Length.	Length allowed.	Height.
Forecastle.....	<i>26.75</i>	<i>26.75</i>	<i>7.0</i>
Bridge House	✓		
+ Raised Qr. Dk.....	<i>114.91</i>	<i>114.91</i>	<i>3.9</i>
Poop.....	✓		
Total	<i>141.66</i>	<i>141.66</i>	
Length of Ship	<i>210.0</i>	<i>210.0</i>	<i>= .674</i>
Corresponding percentage { <i>51.1</i> (Para. 11, 12, 13, or 14) } <i>51.62</i> %			

FREEBOARD recommended amidships from centre of Disc to top of Statutory Deck Line, Wood (Iron) Deck :-
Fresh Water Line above centre of Disc
Indian Summer Line " " "
Winter Line below " "
Winter North Atlantic Line " " "

Moulded Depth as measured. *14.52*
14.534

NOTE. - If the depth is measured when vessel is afloat, the details of measurement should be reported.

CORRECTION FOR LENGTH.

Length of Ship on Loadline..... *210.0*
Length in Table *173.45*
Difference *36.25*
Correction for 10ft., Table A. *1.0* Table C.
× Difference divided by 10 *3.6* (if required.)
If 1/10ths length covered divide by 2 *+ 1 3/4*

CORRECTION FOR IRON DECK.

Proportion covered, if less than 1/10ths length covered *.674* + *large hatchway with raised winch platform between*
Thickness of usual wood deck, less stringer *3*
- 3

CORRECTION FOR ROUND OF BEAM.

Breadth at Gunwale amidships. *31.3*
Round of Beam *8*
Normal round..... *1/8*
Difference *8 ÷ 2 = 4*
Proportion of Deck uncovered (Para. 19) ✓

NOTE. - The round of beam should be reported on the full breadth of vessel at the gunwale.

Freeboard, Table A *2.3 1/2*
Correction for Sheer *- 5 1/2*
1.10
Correction for Length *+ 1 3/4*
1.11 3/4
Allowance for Deck Erections *- 4 1/4*
1.4 1/2
Correction for Round of Beam..... ✓
Correction for fall in Sheer (if any)..... ✓
Correction for Iron Deck (if required) *- 3*
1.1 1/2
Additions for non-compliance with provisions of Para. 11 (d) and (e) ‡
Other Corrections (if any) *Height of R.O.D. 3.9*
4.10 1/2

Winter Freeboard *4.10 1/2*
Summer Freeboard *4.8 1/2*
Indian Summer Freeboard ✓
N. A. Winter Freeboard ✓
Correction necessary because clearside amidships, measured in accordance with the Statute is not taken at the intersection of the ~~wood~~ iron deck with side. *1 1/2*

Winter Freeboard from deck line *5.0*
Summer " " " *4.10*
Indian Summer " " " ✓
N. A. Winter " " " ✓
" " " " " *4.10*
" " " " " *3 1/2*

* If the frames, skin planking, or ceiling are of unusual thickness the breadth of vessel to inside of ceiling should be reported if possible.
† In vessels requiring an allowance for deck erections under Para. 11 where the sheer drops abaft amidships the height of the R. Q. D. is to be taken from the level of the top of the amidship beam.
‡ In flush-decked vessels the total standard mean sheer means the sheer measured at the stem and sternpost. In vessels having poops and forecastles, it means the sheer measured at points distant one eighth of the vessel's length from stem and sternpost.

† State dimensions of freeing port area on back of this form.
‡ The Surveyor should state whether the fall in sheer as reported is measured relatively to the straight line of keel or to the water line. If measured relatively to water line the vessel's draft at time of survey should be reported. If measured relatively to keel, the vessel's draft at time of survey should be reported.

RECEIVED 20 MAY 1924

(P.T.O.)

Do all the Frames extend to the top height in the Poop? *Yes* Raised Quarter Deck? *Yes* Bridge House? *Yes* Forecastle? *Yes*
 To what height do the Reverse Frames extend? *Bulk and framing*
 Has the Poop or Raised Quarter Deck an efficient Iron Bulkhead at the fore end? *Yes*
 Give particulars of the means for closing the openings in Bulkhead *none*
 Is the Poop or Raised Quarter Deck connected with the Bridge House? *Yes* Has the Bridge House an efficient Bulkhead at the fore end? *Yes*
 Give particulars of the means for closing the openings in Bulkhead *Yes*
 What is the thickness of the Bridge Front plating? *Yes* and Coaming plate? *Yes*
 Give scantlings and spacing of the Stiffeners *Yes*
 Are bracket plates fitted at each end of the Stiffeners? *Yes* Are hor'l. brackets fitted connecting Bridge Bulk'd. with Bulwarks? *Yes*
 Has the Bridge House an efficient Iron Bulkhead at the after end? *Yes*
 How are the openings closed? *Yes*
 Is the Forecastle at least as high as the main or top-gallant rail? *Yes* Has the Forecastle an efficient Iron or Wood Bulk'd. at after end? *Yes*
 Are the Engine and Boiler openings covered by a Bridge, Poop, Raised Quarter Deck, or enclosed by a Strong Iron or Steel Deckhouse? *Raised Quarter Deck - this coming*
 If the openings are not so protected are the exposed parts of the Casings efficiently constructed? *Yes*
 Give thickness of plating; scantlings and spacing of Stiffeners *Yes*
 What is the height of the exposed Casings? *Yes* Are suitable means provided for closing all openings in them in bad weather? *Yes*
 Are the Weather Deck Hatchways efficiently constructed and at least equal to the requirements of Section 28 of the Rules for 1904-5? Give particulars below:— *Yes*

Position and Size.	No. 1. 22'6" x 14'6" x 19'6"		No. 2. 25'3" x 20'0"		No. 3. 24'4 1/2" x 17'9" x 19'6"					
Item.	Ship.	Rule.	Ship.	Rule.	Ship.	Rule.	Ship.	Rule.	Ship.	Rule.
COAMING.										
Height above top of DECK	4'8"	2'4"								
Thickness { Sides.....	.44	.44	} do							
Ends.....	.44	.44								
WEATHER DECK WEB PLATES.										
Number	Four	A 19x36 4x3x4 1/2	2 @ 2 @	A 20x36	Four	(A) 18x36 4x3x4 1/2				
Section and Scantlings	JL JL JL JL	B 18x36 4x3x4 1/2	JL JL	(4) 4x3x4 1/2	JL JL JL JL	B 18x36 "				
Material	Steel	C 17x32 4x3x4 1/2	JL JL	B 20x36	Steel	C 17x36 "				
		D 16x32 4x3x4 1/2	Steel	(4) 4x3x4 1/2		D 16x36 "				
* FORE AND AFTERS.				none						
Number										
Section and Scantlings										
Material										
HATCHES Thickness	2 1/2"			do						
Remarks.....	White Pine									

* When the Fore and Afters are of wood the depth should be stated from the underside of the hatches.

(If the sill of the lowest side scuttle will be less than 6 inches above the Indian Summer Load Line if assigned under the tables, state vertical distance from top of deck at side amidships to lower edge of lowest side scuttle.)

The following information is to be given in all Cases of vessels dealt with under Paras. 11, 12 (under 15 feet Moulded depth) and under Shelter Deck Rules.
 What is the thickness of the Bridge Sheerstrake? _____ Strake between Main and Bridge Sheerstrakes? _____

Delete the words { The Crew ~~are~~, are not, berthed in the bridge house.
 that do not apply { The arrangements to enable them to get backwards and forwards from their quarters are, ~~are not~~ satisfactory.

Length of Bulwarks in well *69.4 68.4*

Area of Freeing Ports required by Para. 11 (e) each side of vessel = *13.80* Sq. ft.

Ft. Tenths. Ft. Tenths. No. } Freeing Ports (each side of vessel) = *14.62* Sq. ft.
 $3.25 \times 1.5 \times 3$

Total deficiency or excess = *.94 82* Sq. ft.

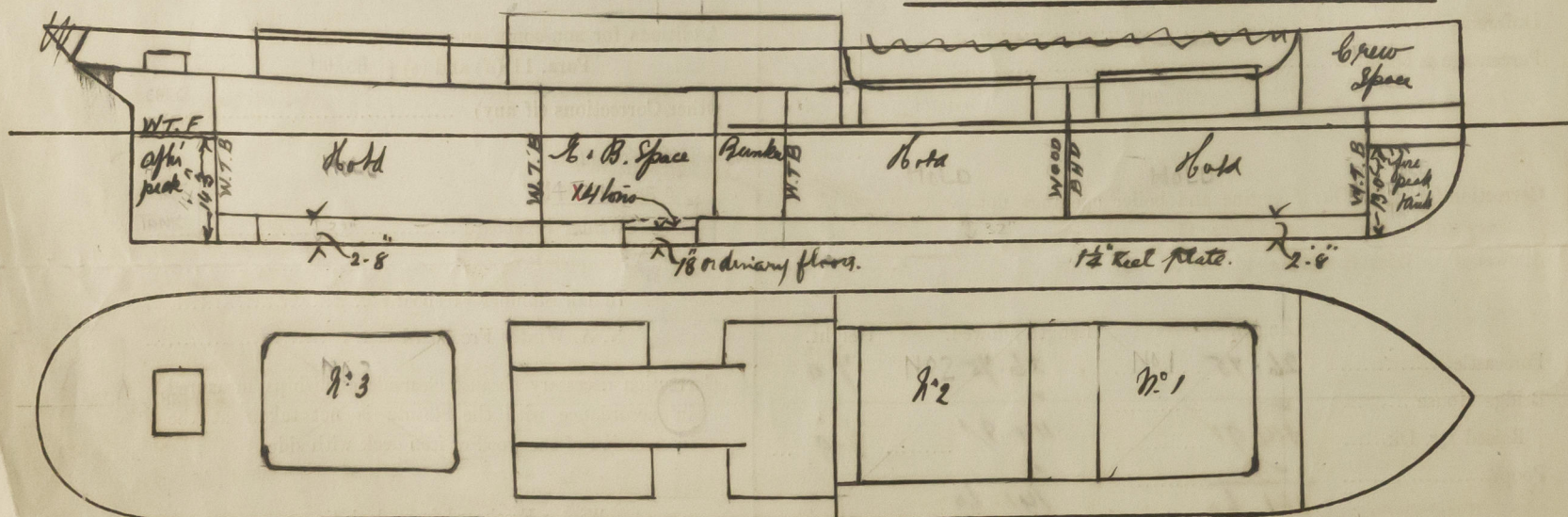

Show hereon line of Floors or Tank Top with position of any Breaks in same; also height of Peak Tank tops, &c., &c.

State any special features in the construction of the Vessel *Freeboard request form forwarded to London on the 24th June 1919. Facilities fitted for the crew to get to & from their quarters without descending into the well. Plan of Midship Section Profile herewith enclosed for reference. Please see letter 26/8/19.*

Owners

Address

Fee £ *2 : 2 : 0*

Received by me



© 2020

Lloyd's Register Foundation