

27 OCT 1951

Lloyd's Register of Shipping.

Ship's Name "ASK"

Official No. ✓

Memorandum of alterations reported since ship was surveyed for assignment of Load Lines in 1932. Index No. 25329.

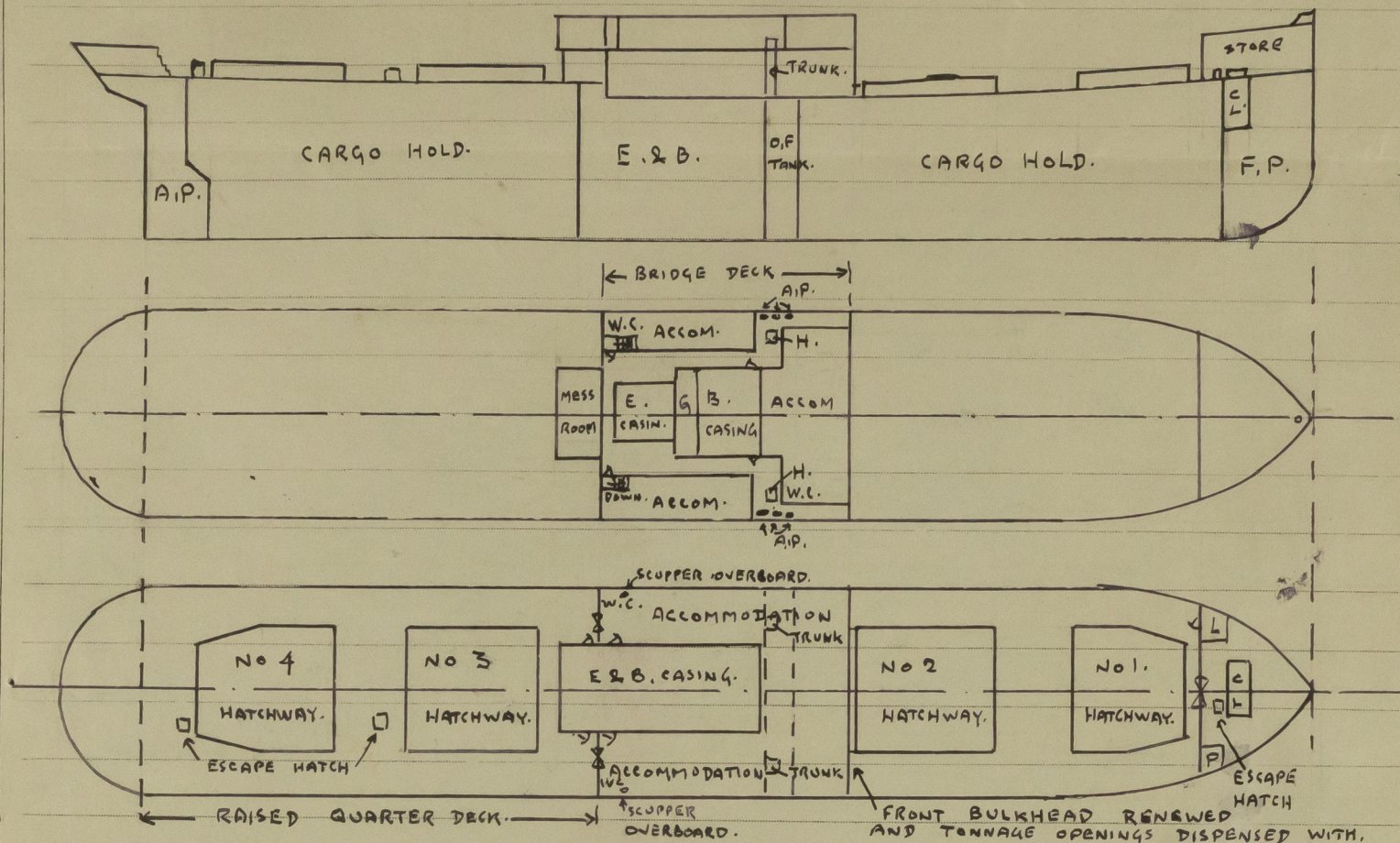

amidships removed and 3/4" thick deck covering fitted.

Tonnage opening in Forecastle bulkhead altered. Opening now 4'-1" x 5'-0" Sill 15". Channels fitted full height of opening for 3" shifting boards.

Escape hatch inside forecastle from hold 23 1/2" x 19" x .30" x 24" high.

--- aft of No 4 Hatchway and between Hatchways Nos 3 & 4 are 23 1/2" x 17 1/4" and 23" x 22" x .36" x 24" high. All fitted strong W.T. cover fitted with butterfly nuts.

There is only one 1 3/4" scupper pipe port and starboard side from washroom on upper deck inside bridge draining ~~overboard. 20" below foreboard deck. No valve fitted.~~ ^{TO E.B. BILGE WITH LEVER WEIGHTED COCK AT LOWER END.}

One 16" dia. scuttle fitted in way of portable plate over opening in aft end bulkhead of bridge. Cast iron deadlight fitted.

Openings in bridge front bulkhead plated over.

Hatch to O.F. deep tank fitted on bridge deck 19 1/4" x 24 1/2" x .40" x 24" high with strong W.T. steel cover fastened with 8 butterfly nuts.

Air pipes on bridge deck Port and Starboard

O.F. deep tank: - 3" gooseneck 24" above deck. and 3" gooseneck 6'-3" above deck.

Settling tank: - 3" gooseneck 28" above deck. Wire gauze ^{K CANVAS COVERS} fitted.

For opening in way of aft end bulkhead of bridge see my report No 2506 dated 30th. August 1935.

Bergen

25th. October 1951

S. A. Bide.