

25329

Port of Survey *Dublin*  
Date of Survey *31.7.17 + 10.9.1917*  
Name of Surveyor *N.B. Forster*

Port of Registry and Nationality.	Official Number.	Gross Tonnage.	Date of Build.	Particulars of Classification.
<i>London British</i>	<i>140414</i>	<i>1536</i>	<i>1917</i>	<i>100 A.1. </i>

Moulded Depth as measured.....  $20^{\circ}-6\frac{1}{4}$

$21-3\frac{1}{4}$

$2-10\frac{1}{2}$

---

$18-4\frac{3}{4}$

NOTE. — If the depth is measured when vessel is afloat, the details of measurement should be reported.

CORRECTION FOR LENGTH.	
Length of Ship on Loadline.....	240.05
Length in Table .....	246.25
Difference .....	6.2
Correction for 10ft., Table A. ....	1.2
× Difference divided by 10 .....	.744
If $\frac{1}{10}$ ths length covered divide by 2	$-\frac{3}{4}$

CORRECTION FOR IRON DECK.

Proportion covered, if less than $\frac{7}{8}$ th length covered .....	.692
Thickness of usual wood deck, less stringer .....	$3\frac{1}{2}$
<i>Large hatchways</i>	<i>3 39</i>
	<i>- 3\frac{1}{2}</i>

CORRECTION FOR ROUND OF BEAM.		NOTE. — The round of beam should be reported on the full breadth of vessel at the gunwale.
Breadth at Gunwale amidships.....	35.35'	
Round of Beam .....	9"	
Normal round.....	8.84	
Difference .....	16 ÷ 2 = .....	08
Proportion of Deck uncovered (Para. 19) .....	308	

Freeboard, Table A .....	3 .. $11\frac{3}{4}$
Correction for Sheer .....	<u>- <math>2\frac{1}{2}</math></u>
	3 .. $9\frac{1}{4}$
Correction for Length .....	<u>- <math>\frac{3}{4}</math></u>
	3 .. $8\frac{1}{2}$
Allowance for Deck Erections .....	<u>- <math>8\frac{3}{4}</math></u>
	2 .. $11\frac{3}{4}$
Correction for Round of Beam..... ✓	
Correction for fall in Sheer (if any)..... ✓	
Correction for Iron Deck (if required) .....	<u>- <math>3\frac{1}{2}</math></u>
	2 .. $8\frac{1}{4}$
Additions for non-compliance with provisions of { Para. 11 (d) and (e) ‡ ..... }	
Other Corrections (if any) .....	

Winter Freeboard .....	2 ..	8 $\frac{1}{4}$ ✓
Summer Freeboard .....	2 ..	5 ✓
Indian Summer Freeboard .....		✓
N. A. Winter Freeboard .....		✓

Correction necessary because clearside amidships, measured }  
in accordance with the Statute is not taken at the }  
intersection of the ~~wood~~ or iron deck with side. } 1 $\frac{1}{2}$

[illegible]

The Surveyor should state whether the fall in sheer as reported is measured relatively to the straight line of keel or to the water line. If measured relatively to water line the vessel's draft at time of survey, and also the usual load draft forward and aft should be reported.

2m, 1, 14 T.

002215-002221-0016

MARKING FORM  
18 NOV 1927  
RECEIVED

MARKING REPORT  
RECEIVED 5.11.19.

© 2020

measured relatively to the straight line, and the vessel's draft at time of measurement is reported.



Do all the Frames extend to the top height in the Peep? yes Raised Quarter Deck? yes Bridge House? yes Forecastle? yes  
 To what height do the Reverse Frames extend? across top of floors only  
 Has the Peep Raised Quarter Deck an efficient Iron Bulkhead at the fore end? yes  
 Give particulars of the means for closing the openings in Bulkhead none  
 Is the Peep Raised Quarter Deck connected with the Bridge House? yes Has the Bridge House an efficient Bulkhead at the fore end? yes  
 Give particulars of the means for closing the openings in Bulkhead Two openings 4'-6" x 3'-6" wide, closed with 9" x 2 1/2" planks and bolted plate cover  
 What is the thickness of the Bridge Front plating? 32 and Coaming plate? 36 Bulb Angles  
 Give scantlings and spacing of the Stiffeners 6" x 3" x 44 Bulb Angles spaced 30" apart, and 7" x 3" x 50 at inside of openings  
 Are bracket plates fitted at each end of the Stiffeners? yes Are hor'l. brackets fitted connecting Bridge Bulk'd. with Bulwarks? yes  
 Has the Bridge House an efficient Iron Bulkhead at the after end? yes  
 How are the openings closed? none  
 Is the Forecastle at least as high as the main or top-gallant rail? 7'-0" high Has the Forecastle an efficient Iron or Wood Bulk'd. at after end? yes  
 Are the Engine and Boiler openings covered by a Bridge, Peep yes or enclosed by a Strong Iron or Steel Deckhouse?  
 If the openings are not so protected are the exposed parts of the Casings efficiently constructed? yes  
 Give thickness of plating; scantlings and spacing of Stiffeners  
 What is the height of the exposed Casings? 7'-0" above bridge Are suitable means provided for closing all openings in them in bad weather? yes  
 Are the Weather Deck Hatchways efficiently constructed and at least equal to the requirements of Section 28 of the Rules for 1904-5? Give particulars below:— yes

Position and Size.		No 1. 22'-6" x 18'-0" to 24'-6"		No 2. 28'-0" x 25'-0"		No 3. 27'-0" x 25'-0"		No 4. 29'-3" x 24'-0" to 18'-9"		Bunker Hatch 4'-6" x 13'-0"	
Item.		Ship.	Rule.	Ship.	Rule.	Ship.	Rule.	Ship.	Rule.	Ship.	Rule.
COAMING	Height above top of DECK	3'-6"	2'-6"	3'-6"	2'-6"	3'-6"	2'-0"	3'-6"	2'-0"	2'-0"	
	Thickness { Sides.....	44"	44"	48"	48"	48"	48"	46"	46"	375"	
	Ends.....	40"	40"	40"	40"	40"	40"	40"	40"	375"	
SHIFTING BEAMS OR WEB PLATES.	Number.....	Three	Three	Four	Four	Four	Four	Five	Five	None	
	Section and Scantlings.....	I 27" x 40"	I 27" x 40"	I 32" x 40"	I 32" x 40"	I 32" x 40"	I 32" x 40"	I 30" x 40"	I 30" x 40"	None	
	Material.....	4" x 3" x 40 angles Steel	4" x 3" x 40 angles Steel	4" x 3" x 40 angles Steel	4" x 3" x 40 angles Steel	4" x 3" x 40 angles Steel	4" x 3" x 40 angles Steel	4" x 3" x 40 angles Steel	4" x 3" x 40 angles Steel		
* FORE AND AFTERS.	Number.....	None		None		None		None		None	
	Section and Scantlings.....										
	Material.....			Hatch covers fitted fore and aft							
HATCHES Thickness.....		3" W.P.	3"	3" W.P.	3"	3" W.P.	3"	3" W.P.	3"	3" W.P.	3"
Remarks.....											

\* When the Fore and Afters are of wood the depth should be stated from the underside of the hatches.  
 (If the sill of the lowest side scuttle will be less than 6 inches above the Indian Summer Load Line if assigned under the tables, state vertical distance from top of deck at side amidships to lower edge of lowest side scuttle.)

The following information is to be given in all Cases of vessels dealt with under Paras. 11, 12 (under 15 feet Moulded depth) and under Shelter Deck Rules.  
 What is the thickness of the Bridge Sheerstrake? \_\_\_\_\_ Strake between Main and Bridge Sheerstrakes? \_\_\_\_\_

Delete the words { The Crew are, ~~not~~, berthed in the bridge house.  
 that do not apply { The arrangements to enable them to get backwards and forwards from their quarters are, ~~not~~ satisfactory.

Length of Bulwarks in well 72'-0"  
 Area of Freeing Ports required by Para. 11 (e) each side of vessel = 14.40 Sq. ft.  
 Ft. Tenths.    Ft. Tenths.    No.    }  
3.25    x    1.50    x    3    }    Freeing Ports (each side of vessel) = 14.625 Sq. ft.

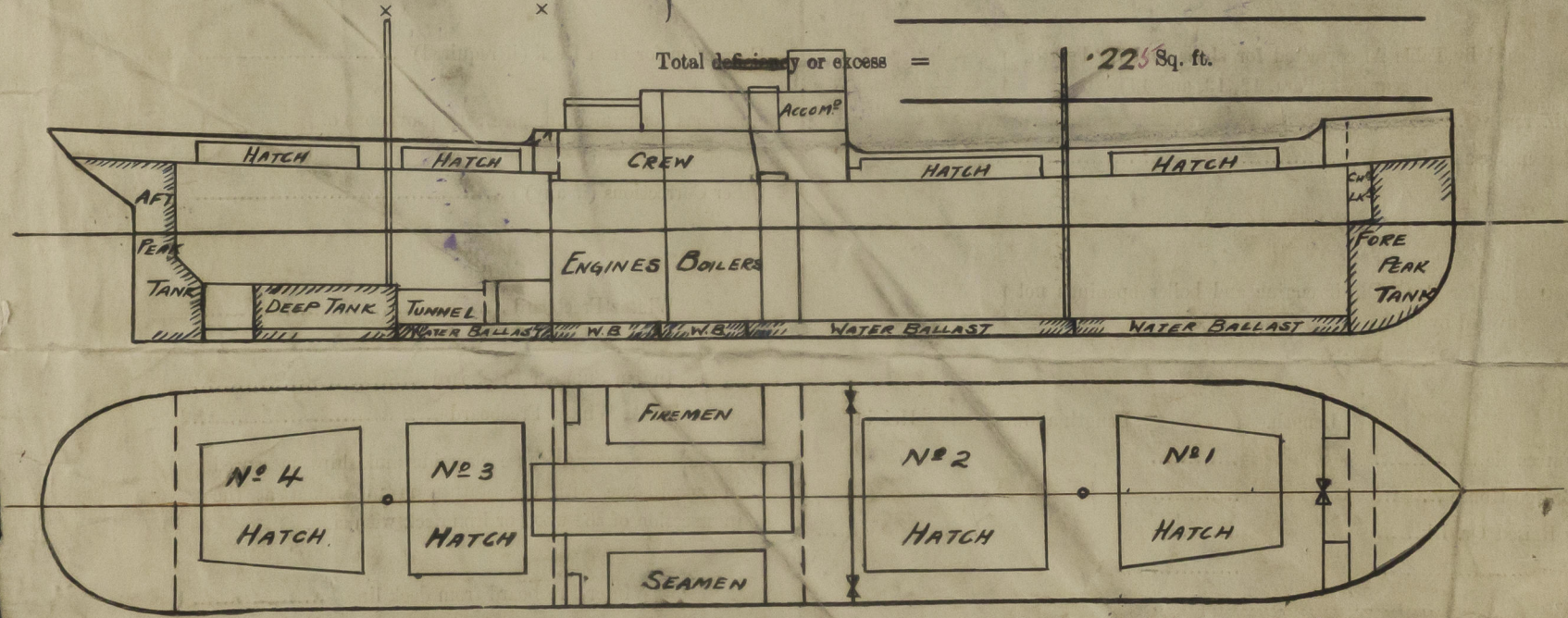

Show hereon line of Floors or Tank Top with position of any Breaks in same; also height of Peak Tank tops, &c., &c.

te any special features in the construction of the Vessel None

*Re under deck tonnage*  
*Deephore engine 1000 h.p. 327 and 1000 h.p. 327*

Address \_\_\_\_\_  
 Received by me \_\_\_\_\_