

11.2.10
29.4.10

PROFILE AND DECK PLAN.

No 266 SHIP.

DIMENSIONS 108'24" + 12'0" MT.

CLASS 100 A.I. LLOYDS FOR TOWING PURPOSES.

SCALE 1/4" = 1 FOOT.

P. RENNINGSON & SONS
DRAWN
9.2.10
2236.
SHEDDARD
SOUTH SHIELDS

RECEIVED
10 FEB 1910
LLOYD'S REGISTER

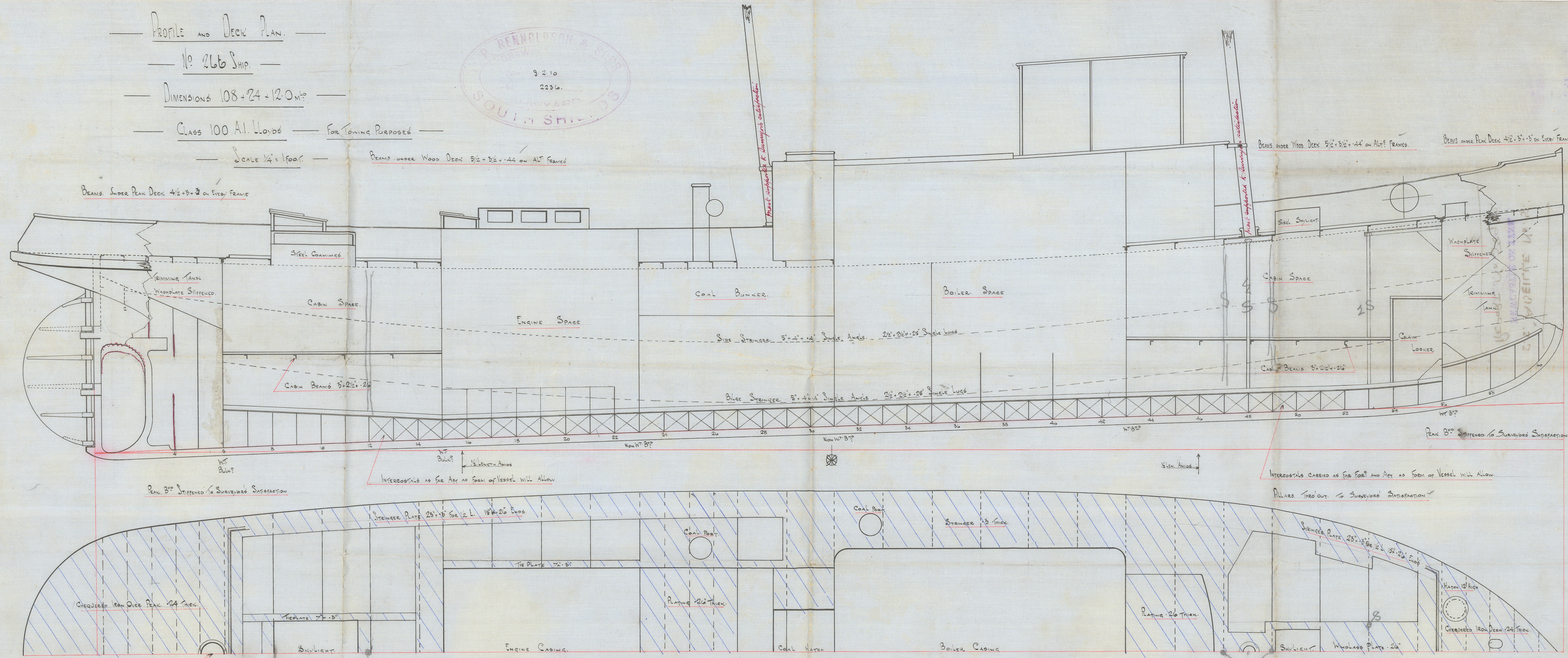

No 266
P. RENNINGSON & SONS
PROF. P.

PROFILE

J.P. RENNOLDSON & SONS

Nº 266.

S.S. ABELLE No. 5

NEWCASTLE ON TYNE

REPORT No. 58982

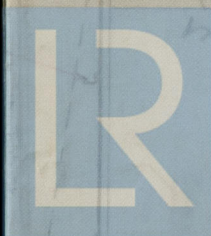

© 2020

Lloyd's Register
Foundation

002206-002214-0115