

Lloyd's Register of Shipping.
SURVEYS FOR FREEBOARD.
(CONDITIONS OF ASSIGNMENT.)

Ship's Name "CRESCENT PARK" Port of Survey PICTOU, N. S., CANADA
Official Number 174157 Surveyor's Signature [Signature]
Nationality and Port of Registry CANADIAN, MONTREAL Date of Survey During construction.

Disposition and dimensions of superstructures, trunks, deckhouses and machinery casings to be inserted in the diagrams and tabular statement :-

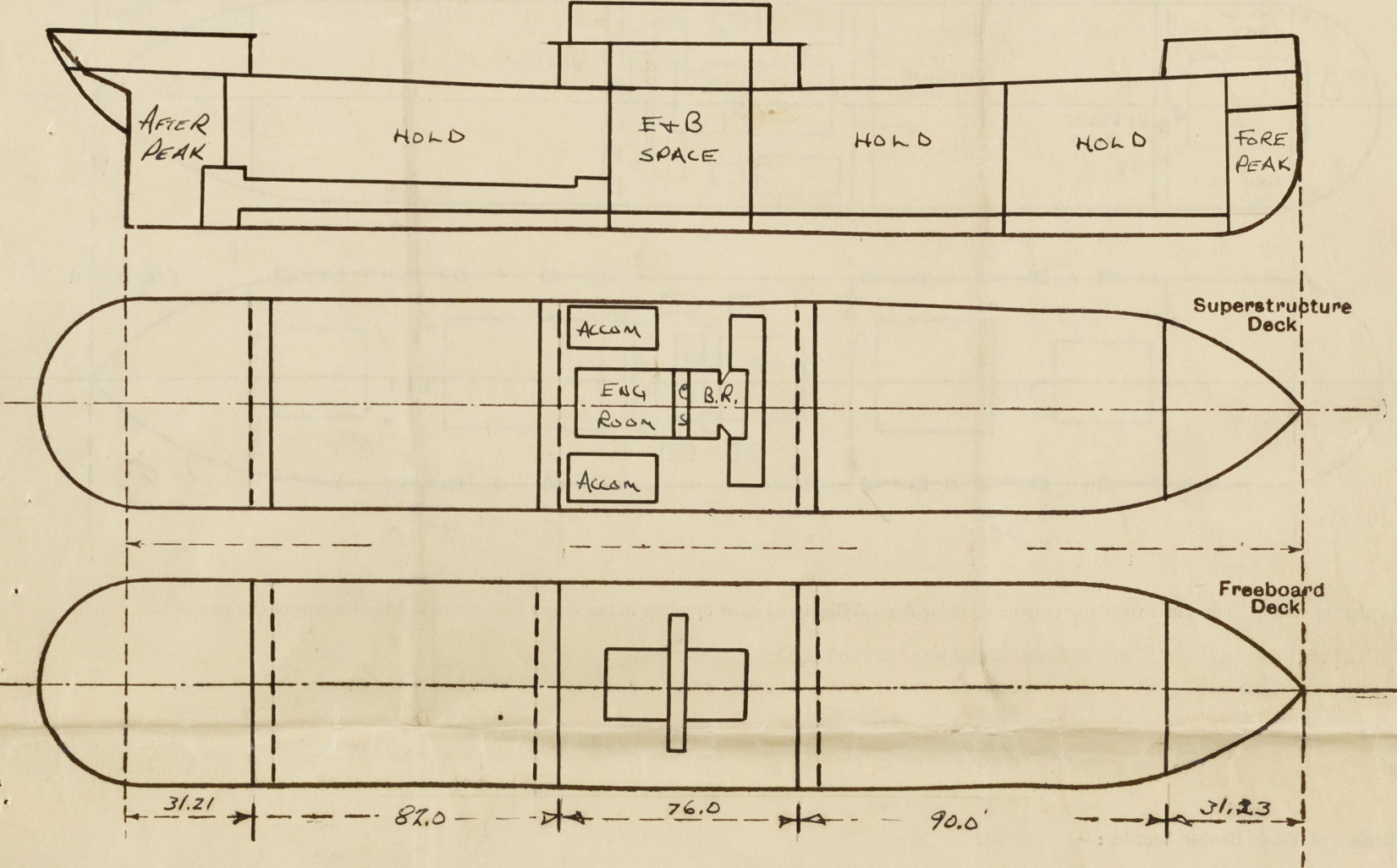

Particulars of Superstructures, Trunks, Casings, Deckhouses.								
	Coaming	Plating	Stiffeners	Spacing	End Attachments of Stiffeners	Size of Openings	Height of Sills	Height of Casings
Poop Bulkhead	--	.33	5 x 3 x 3/8	Not exceed- ing 30"	Lugs top and bot.	None	--	7' 6"
Raised Quarter Deck Bulkhead ...			4x2 1/2 x 5/16 OA & Div. Bhd.	Average 2' 4 1/2"	Ends of stiffers takes rivet in boundary angle	5'0"x 2'6" 4'1" x 3'1"	18	9' 0"
Bridge, After Bulkhead	--	.24-.30	8 x 3 1/2 x .35 BA	do	Lugs top and bot.	4'9 1/2"x 2'10 1/2"	18	9' 0"
Bridge, Forward Bulkhead	--	.39	4 x 3x5/16 OA and Div. Bhd.	2'3" to 3'6"	Ends of stiffers rivet in boundary angle.	5'1"x 3'1" 4'0"x 2'0"	18	7' 0"
Forecastle Bulkhead	--	.27						
Trunk, Aft								
Trunk, Forward								
Exposed Machinery Casings on Freeboard or Raised Quarter Decks ...			None					
Exposed Machinery Casings on Superstructure Decks	18" x .34"	.30	3 x 2 1/2 x 5/16 OA	2'0"	Bkt. at top	5'0"x 2'0"	18	7' 4"
Machinery Casings within Superstructures not fitted with Class I Closing Appliances	18" x .30	.25	- do -	- do -	Two rivets through Dk. Beams	- do -	- do -	9' 0"
Deckhouses on Flush Deck Ships ...								

Particulars of Closing Appliances (state if capable of being manipulated from both sides).	
Poop Bulkhead	No openings
Raised Quarter Deck Bulkhead ...	
Bridge, After Bulkhead	Portable steel plates with hook bolts and hinged steel doors, manipulated from both sides.
Bridge, Forward Bulkhead	Hinged steel W.T. doors manipulated from both sides.
Forecastle Bulkhead	Portable steel plates with hook bolts and hinged steel doors, manipulated from both sides.
Exposed Machinery Casings on Freeboard or Raised Quarter Decks ...	None
Exposed Machinery Casings on Superstructure Decks	Hinged steel doors, manipulated from both sides.
Machinery Casings within Superstructures not fitted with Class I Closing Appliances	Hinged steel doors, manipulated from both sides.
Deckhouses on Flush Deck Ships ...	

Crescent Park.

The image contains three hand-drawn technical diagrams of a ship's hull and deck layout, oriented vertically.

- Top Diagram (Hull Profile):** Shows the side profile of the ship's hull. It is divided into sections labeled **N° 4**, **N° 3**, **N° 2**, **N° 1**, and **N° A**. A **HATCH** is indicated at the stern. The bow is labeled **WT. HATCH**. Small circles labeled **se** and **su** are marked along the hull.
- Middle Diagram (Superstructure Deck):** Shows the layout of the Superstructure Deck. It includes labels for **WT. HATCH**, **SNY**, **DERRICK POST**, **F.R.**, **B.R.**, and **DERRICK POSTS**. The deck is divided into sections by dashed lines.
- Bottom Diagram (Freeboard Deck):** Shows the layout of the Freeboard Deck. It includes labels for **SE**, **CH**, **F.R.**, **B**, **R**, **A**, and **V**. The deck is divided into sections by dashed lines.

Fidley, Punnel and Ventilator Coamings efficiently constructed. ✓
Engine Room Skylight constructed of steel with hinged steel covers operated from inside of casing. ✓
Fidley openings closed by hinged steel covers. ✓

Entrance to crews quarters on poop deck - openings in deck house port and stbd. steel door 5' 0" x 1' 11", sill 18 $\frac{1}{2}$ " above deck. Door manipulated from both sides.

Upper Deck - 4 @ 15" dia. Coam. 36" x .36" to Holds. ✓
1 @ 15" " " 11' 6" x .36" to holds stayed to Bridge End. ✓

Poop Deck - 1 @ 15" dia. Coam. 30" x .36" to Holds. ✓
2 @ 8" " " 32" x .31 " " " ✓
8 @ 8" x 4 S.N.V. " 30" to Opening to Crew's Accommodation. ✓

Bridge Deck - 3 Derrick Posts with M. V. on top. ✓
3 @ 12" dia. Coam. 30" x .34" - To tunnel and Bridge Space. ✓
2 @ 6" " " 30" x .29" - To air space on No. 2 Hold After End. ✓

F'to'scle Deck 1 Derrick Post with M.V. on top - To hold. ✓
1 @ 6" dia. Coam. 36" x .29 - To F. P. Store. ✓
3 @ 8" x 4" S.N.V. 36" to Opening - to F'to'scle. ✓

(Closing appliances for Coamings - wood plugs and canvas covers) ✓

<u>Upper Deck</u>	-	1 P & S - 3-1/2" dia.	-	36"	above deck to	D. B. Tank.	✓
		1 P & S - 2-1/2" "	-	36"	" "	D.B. Tank.	✓
<u>F'o'r'scle Deck-</u>	1	@ - 3-1/2" "	-	24"	" "	Forepeak	✓
	1	@ - 4" "	-	18"	" "	D. B. Tank	✓
<u>Bridge Deck</u>	-	1 P & S - 3" "	-	18"	" "	Dry Tank	✓
		2 P & S - 2-1/2" "	-	18"	" "	E. R. Tank	✓
		1 P & S - 3-1/2" "	-	18"	" "	D. B. Tank	✓
<u>Poop Deck</u>	-	1 @ - 4" "	-	18"	" "	After Peak	✓
		1 @ - 3" "	-	18"	" "	Rudder Trunk.	✓

Wood plugs & Canvas covers
provided for all air-pipes.
(See Mr. 16943.)

4 - Scupper on exposed part of freeboard deck out through deck stringer angle, port and stbd. ✓
 2 - 3" dia. Pipe Scupper fitted on Freeboard Deck at Bridge Ends, led through ships side below Freeboard Deck P & S. ✓
 1 - 2" " " " " " from Refrig. Room " " with Storm Valve (SS) ✓
 1 - 2" " " " " " from Magazine in Poop " " with Storm Valve P & S. ✓
 2 - 1½" " Scupper fitted on Freeboard Deck in Bridge Space, led to Bilges with cock and weighted handle, P & S. ✓

Poop Space: 12" dia. side scuttles fitted with hinged deadlights efficiently constructed. ✓

Pop Deck:	2	rows of rails, stanchions	3' 0" high,	spaced about	4' 6" apart.	✓
Bridge Deck:	3	" " "	3' 9" "	" " "	4' 9" "	✓
Flood Deck:	2	" " "	3' 0" "	" " "	4' 9" "	✓

Fittings provided at ends of poop, bridge and forecastle decks for rigging life lines. ✓

Particulars of Freeing Arrangements.						
	Length of Bulwark	Height of Bulwark	Size of Freeing Ports	Number each side	Area each side	Rule area each side
After Well	82' 0"	5' 0"	1 @ 12'0" x 8-1/2 1 @ 13'10" x 8-1/2 1 @ 11'9" x 8-1/2	3	26.68 ϕ	16.4 ϕ
Forward Well	90'-0"	5'-0"	1 @ 11'7" x 8-1/2" 1 @ 11'9" x 8-1/2 1 @ 11'10"x 8-1/2	3	25.00 ϕ	18.0 ϕ

State position of each freeing port

(F. and A. position and height above deck edge)

{ After Well: ———— } HEIGHT ABOVE
FRONT | 4'-1" 16'-0" 16'-0" DECK 7 1/8"
Forward Well: BRIDGE
FRONT | 10'-0" 16'-2" 16'-2"

State whether the freeing ports are fitted with shutters, bars, or rails, and give particulars of such:— NONE

Additional area where sheer is less than standard.

002165-002173-0151 $\frac{2}{5}$

PARTICULARS OF PROTECTION TO OPENINGS, ETC.

HATCHWAYS ON FREEBOARD AND SUPERSTRUCTURE DECKS.											
FREEBOARD DECK											
Description of Hatchway	No. 1 & 4	No. 2 & 3	No. 2A	Access to Inside Holds	F'w'scle Bridge	Inside No. 2 A	Coaling Hatchway on Poop	Hatchway on Casing Top			
Dimensions of Hatchway	22'0"x22'0"	34'0"x24'0"	8'0"x24'0"	42'6"x2'6"	4'0"x3'0"	6'0"x3'0"	5'10"x16'0"	12'0"x3'0"	3'0"x3'0"	12'6"	
COAMINGS	Height above Deck ... 31-1/2	31-1/2	9"x3 1/2"x44 BA	31"	9"x3 1/2"x	9"x3 1/2"x	31	31	18	8 x 3 1/2 x	
	Thickness Sides50	.50		.44	.44 BA	.44	.44	.44	.38	.34 BA	
	Thickness Ends ...										
	Stiffeners Bulb Angle ... 9x3 1/2 x .45	9x3 1/2 x .45					7x3x.38 on For. End	3x3x3/8 Vertical			
	Brackets, Stays ... 2"dia. 3 P&S	2"dia. 3 P&S									
HATCH BEAMS	Number ... 5	6	1								
	Spacing ... 5' 4"	4' 10 1/4"	4' 0"								
	Scantling and Sketch ... Pl. 20"x.35	Pl. 20"x.38	Pl. 17x.35	None	None	None	None	None	None	None	
	5x3 1/2 x .50 → 4 Angles	4 Angles	4 Angles								
	Bearing Surface ... 4	4	4-3/8								
FORE AND AFTERS	Number ...			None							
	Spacing ...										
	Unsupported Lengths ...										
	Scantling and Sketch ...										
	Bearing Surface ...										
HATCH COVERS	Material ... W.P.	W.P.	W.P.	W.P.	W.P.	W.P.	W.P.	W.P.	Hinged steel W.T. cover and fastening	W.P.	
	Thickness ... 2-1/2	2-1/2	2-1/2	2-1/2	2-1/2	2-1/2	3"	2-1/2		2-1/2	
	How fitted ... F & A	F & A	F & A	-	-	-	F & A			F & A	
	Bearing Surface ... 5"x 4"	5"x 4"	5" x 3"	2-1/2	2-1/2	2-1/2	3"	2-1/2		3"	
Spacing of Cleats	23-1/2	23-1/2	21	24 x 19	19	21	19	22	-	20	
Number of Tarpaulins	3	3	1	3	1	1	3	3	-	3	
<p>*Are wood fore and afters steel shod at all bearing surfaces? No fore and afters. ✓</p> <p>Are battens and wedges efficient and in good condition? Yes ✓</p> <p>Are tarpaulins in good condition and in accordance with rule requirements? Yes ✓</p> <p>Are lashings provided in accordance with rule requirements? Ring bolts fitted on side coamings of exposed cargo hatches. ✓</p>											

Particulars of any special features:—

Timber Load Line:

F'w'scle - length 21.23 ft. Height 7' 0" Poop Height 7' 9" with Deckhouse enclosing Steering Engine.

Machinery casing on Freeboard Deck inside Bridge Space - height 9' 0".

Double Bottom Tanks fitted within half length of vessel have centre girder unpierced except in way of dry tank under boilers where centre girder has limber holes.

Bulwark fitted in after and forward wells with top rail and stays to deck; freeing ports provided, sockets for uprights provided on Upper Deck and Bulwark Rail in accordance with load line rules, eye plates provided for lashings and rivetted to sheerstrake in accordance with load line rule Clause 91.

Alternate steering arrangement by blocks and wires. ✓

Endorsement at first survey and at surveys for renewal of Certificate:—

The fittings and appliances are in accordance with the particulars shown on this form (or as now modified) and are in good condition.



© 2020

Lloyd's Register Foundation